

**BUS BAR DETAIL**

Note: 1 - .25" x 4" Per 1KA

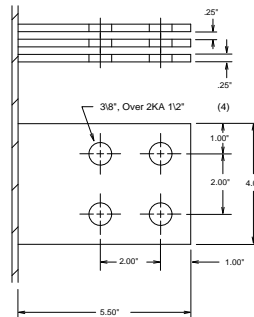

POLY	A	B	C	Control	D	E
#5	44.75"	26.50"	23.50"	SCR	26.00"	19.00"
#6	48.75"	32.50"	25.50"	Tap, V.T.	17.00"	15.00"

**ULTIMATIC**

RECTIFIER POWER SUPPLY BY: ALDONEX

SCALE	NONE	APPROVED BY:	DRAWN BY
DATE	9-8-97		J.M.
<b>POLY #5 and #6</b>			
BELLWOOD, ILL. U.S.A.			DRAWING # 5135