

※To prevent irregular winding of the wire rope around the drum, keep the fleet angle 2 degrees or less.

Please install the pulley 1800mm or more away from the drum on the center line of the drum.

※The value of specified "Wire Rope Tension" on this drawing is for the standard layer or less.

The value of the "Wire Rope Tension" must be decreased accordance with the ratio of the actual winding layers, if it exceeded.

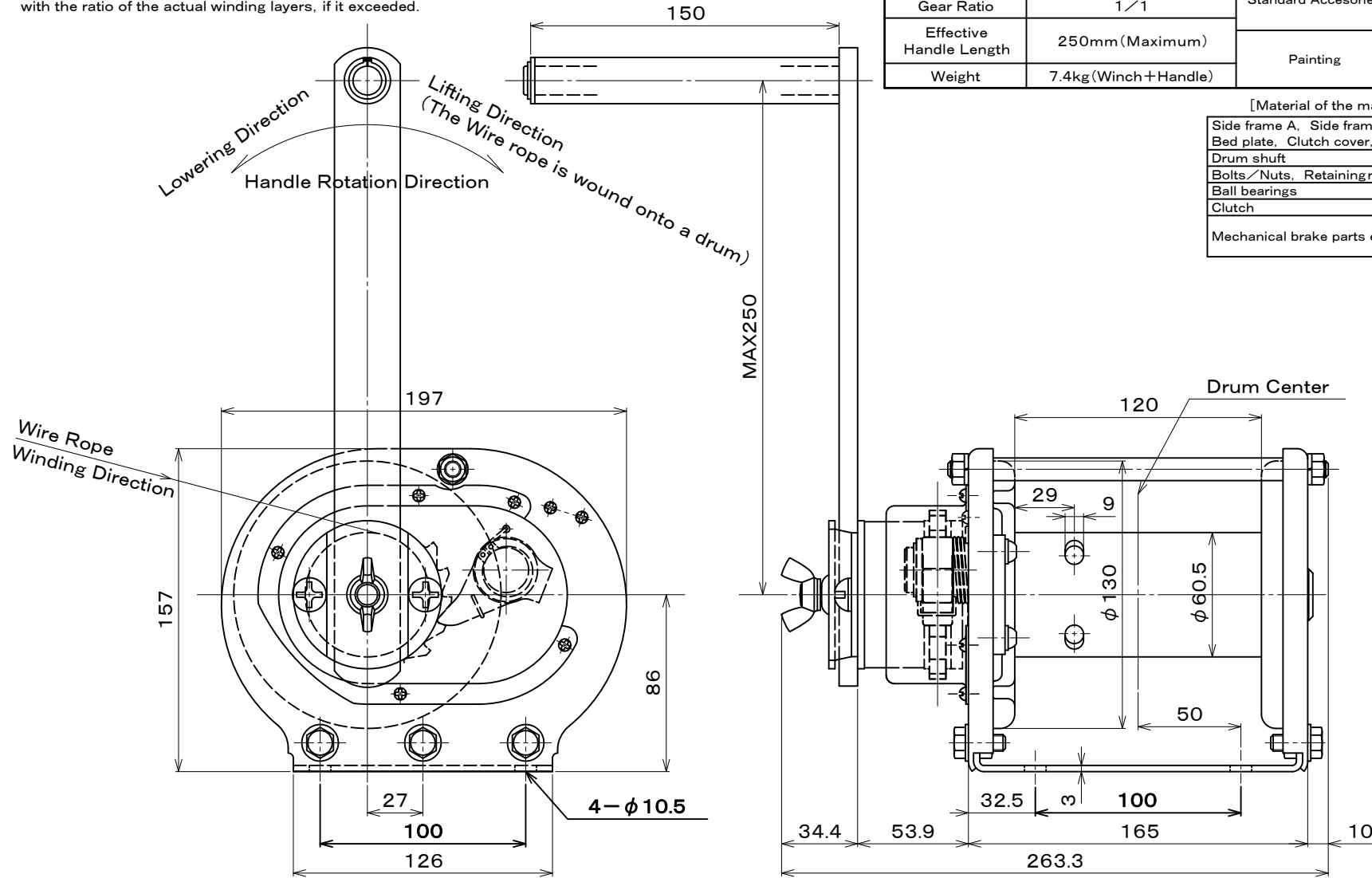

Specifications				(The wire rope composition is a manufacturer recommendation.)	
Load Rating	980N (= 100kgf)	Handle Force	Handle Length	Number of Wire Rope Winding Layer	
Wire Rope Tension	4th Layer (Standard Layer)		250mm	Wire Rope Tension	1st Layer 143N (= 14.6kgf)
Drum Capacity	Wire Rope 6-Layer Windings φ 5mm (6 × 19) × 35m	Standard Accessories	980N	4th Layer 208N (= 21.2kgf)	
Gear Ratio	1/1			One Handle	
Effective Handle Length	250mm (Maximum)	Painting	One Hex Wrench for Anchoring the Wire Rope		
Weight	7.4kg (Winch + Handle)				

[Material of the main part of the winch]

Side frame A, Side frame B, Drum, Bed plate, Clutch cover, Handle arm	SUS304
Drum shaft	SUS304
Bolts/Nuts, Retaining rings, Springs, etc.	SUS304
Ball bearings	SUS440C
Clutch	CAC403
Mechanical brake parts except clutch	SUS303 SUS304 SUS420J2

△ x			図面番号 / DRAWING No.	改訂番号 / REVISION No.	お客様 / CUSTOMER	符号 / MARK	項目 / PARTICULARS	材料 / MATERIAL	数量 / QTY	単体合計 / PER ONE TOTAL	備考 / REMARKS
△ x			ESB1SI-160520-01E	00						重量(kg) / WEIGHT	
△ x			承認 / APPROVED	検図 / CHECKED	作成 / DRAWN	図面名 / TITLE	投影法 / PROJECTION METHOD	MAXPULL MACHINERY & ENGINEERING CO. LTD.			
△ x			設計部 '16.05.20 米澤	設計部 '16.05.20 松嶺	設計部 '16.05.20 武松	MAXPULL STAINLESS STEEL WINCH (ELECTROPOLISHING) STOPPER ARMLESS ROTATING MODEL ESB-1-SI	第三角法 THIRD ANGLE PROJECTION	マックスプル工業株式会社			
改訂 / REVISION							尺度 / SCALE	台数 / QTY			