

Batch



UNITED STATES  
DEPARTMENT OF THE INTERIOR  
FISH AND WILDLIFE SERVICE

Suite 322  
315 South Allen Street  
State College, Pennsylvania 16801

June 16, 1987

Source:

Batch

Mr. Jim Pabody  
U.S. Army Corps of Engineers  
Cleveland Projects Office  
Foot East 9 Street  
Cleveland OH 44114

Dear Mr. Pabody:

Enclosed is a draft wetland map of the Robert Brace site in Waterford Township, Erie County, Pennsylvania. The map shows the extent of high quality wetlands affected by the unauthorized work. Approximately 200 acres of wetlands could be affected by the project.

We have also enclosed three aerial photographs of the site for your use. We would like to receive copies of your most recent aerial photographs of the site. We can prepare a revised map to show the extent of the recent work once we receive them.

We understand that the Buffalo staff has been severely cut and that this is the peak workload season for you, however, we urge you to move forward with this case as rapidly as possible. As we stated in our letter of May 11, 1987, we consider this to be one of the most significant 404 violations that we have seen in recent years. A rapid resolution of this case would be in the best interest of Mr. Brace and all the involved agencies.

If we can be of any assistance, please contact Mr. David Putnam of my staff.

Sincerely,

  
David J. Putnam  
Acting Field Supervisor

Enclosures

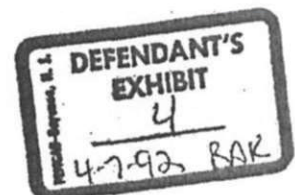
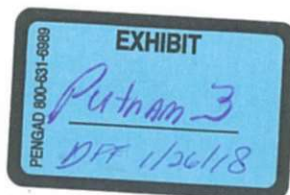

U

0413

CD-FRC0013908

U 0414

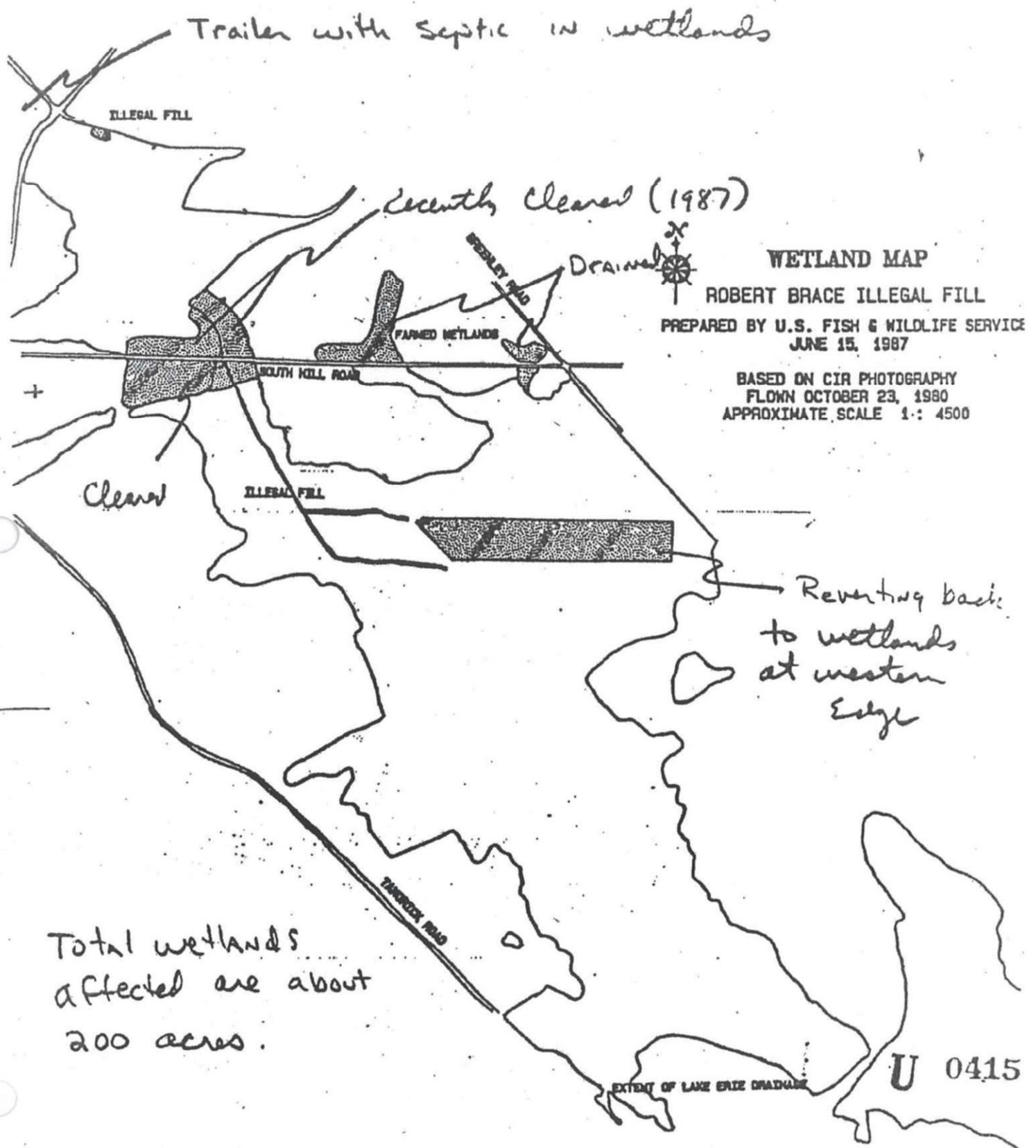

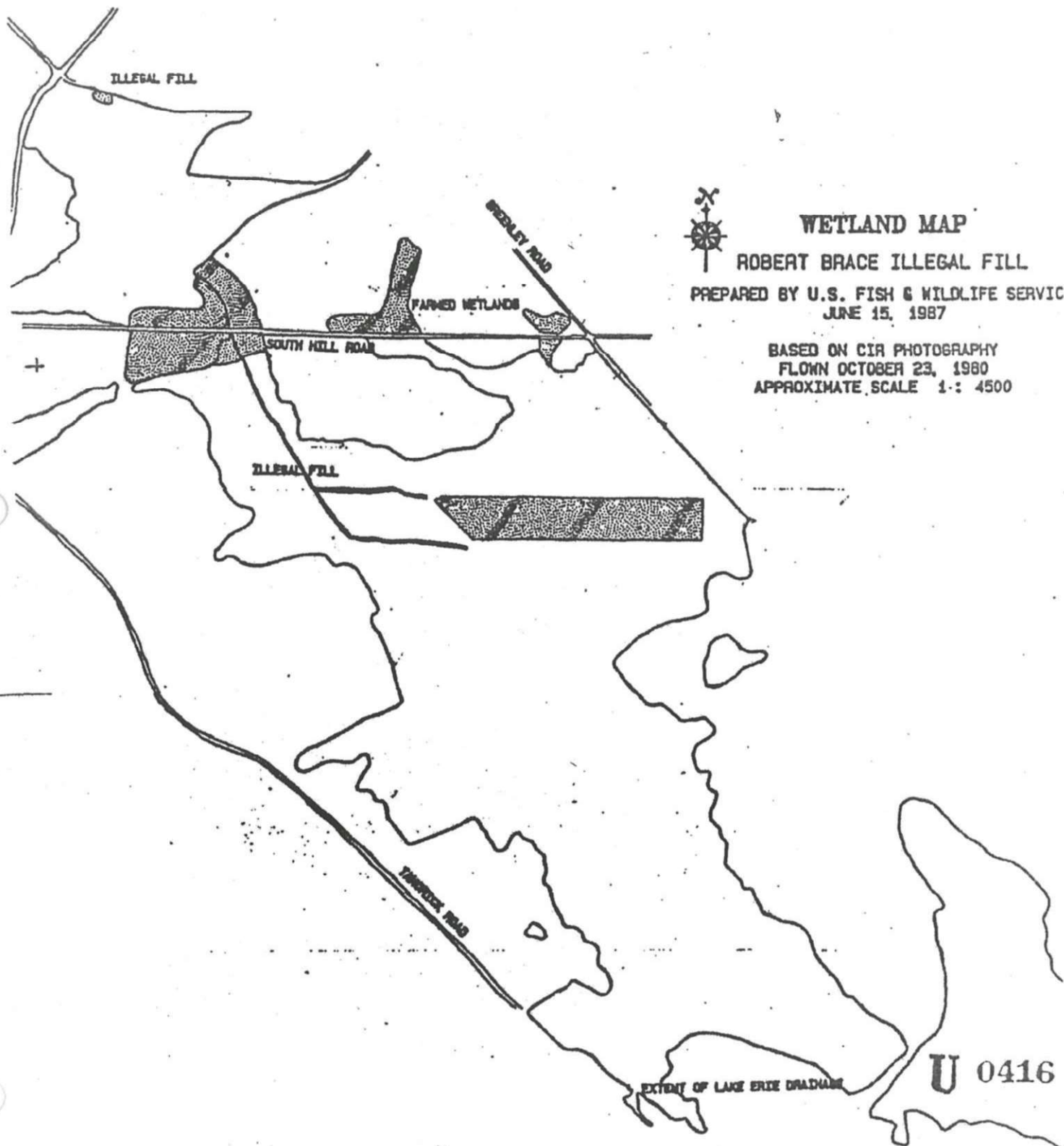



CD-FRC0013127

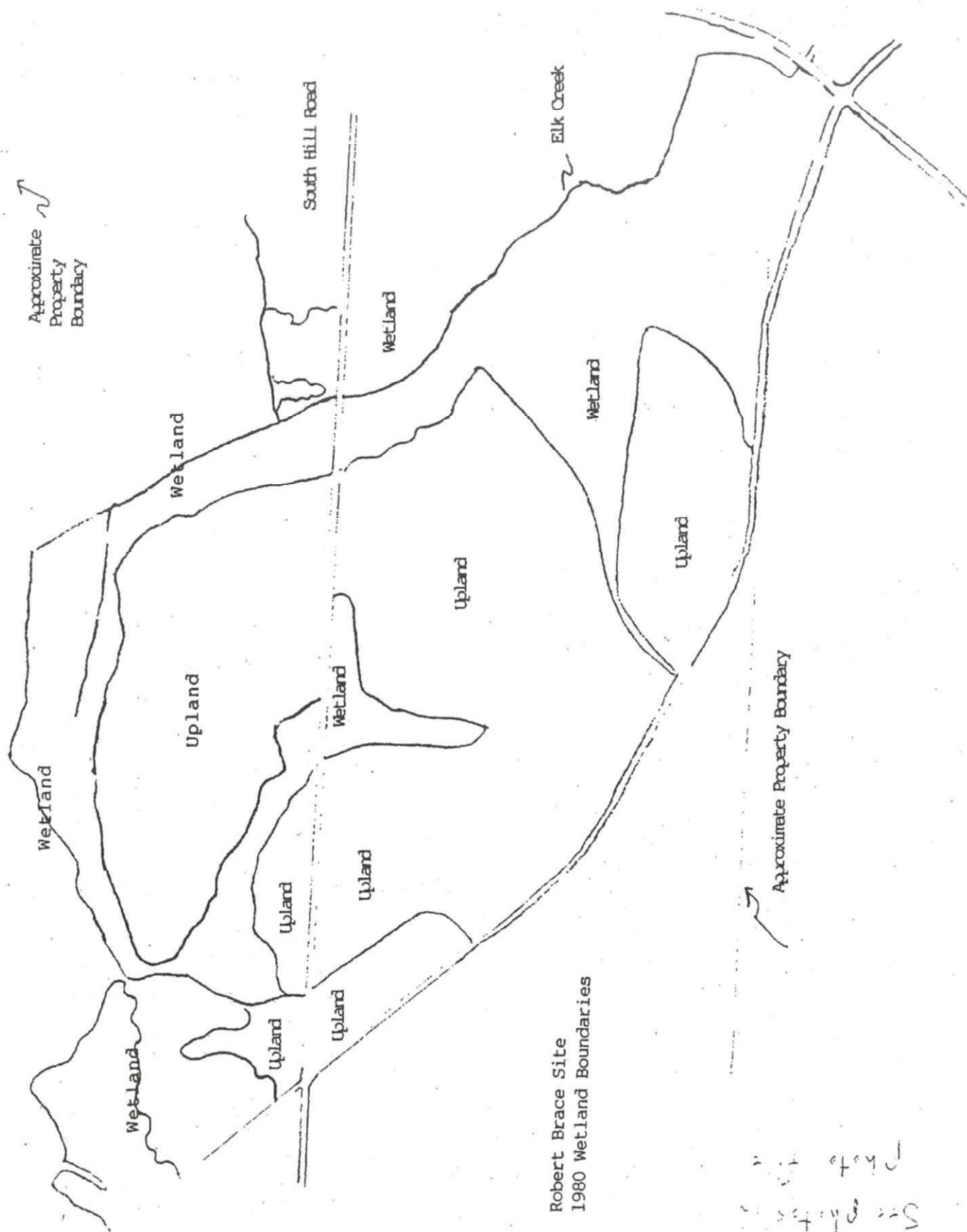

Robert Brace Site  
1980 Wetland Boundaries

See photos  
Photo 10

3-370  
(5/75)