

**Models: BC-280-PP, BC-ENC-PP, BC-280-PVDF, BC-ENC-PVDF, BC2-280-PP, BC2-ENC-PP, BC2-280-PVDF, BC2-ENC-PVDF, BC-A1-PP, BC-A1-PVDF, BC2-A1-PP & BC2-A1-PVDF**

**Turbine Low Viscosity Batch Control System Spare Parts Lists**

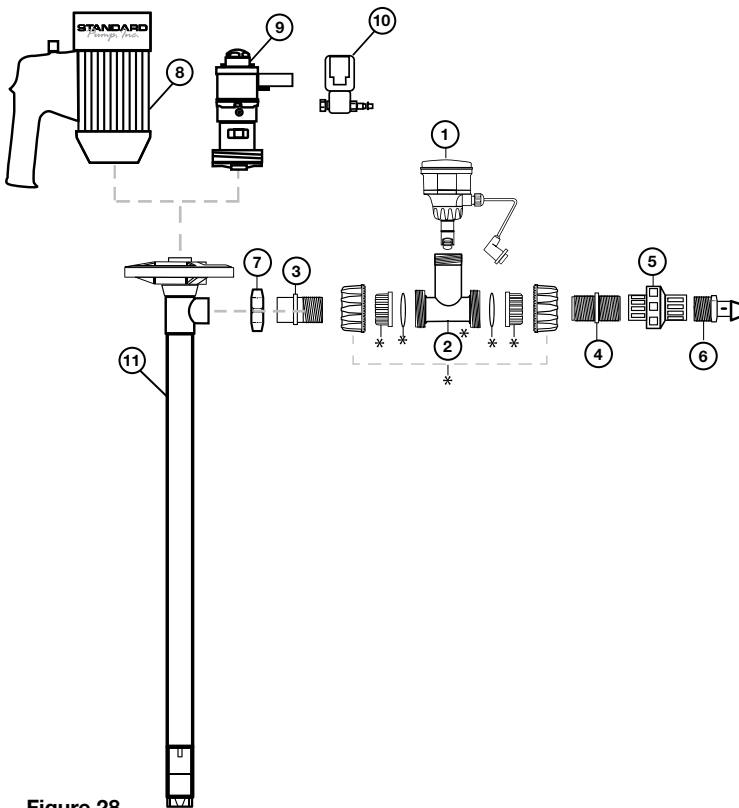

Figure 28

**Batch Control System** See Figure 28

Ref. #	Description	P/N for Electric BCS	P/N for Air BCS	Qty
1	Batch Control Module, 110-120V / 220-240V (Cable Connection Included)	F101	-	1
	Batch Control Module, 110-120V (Power Cord Included)		F102	1
	Batch Control Module, 220-240V (Power Cord Included)		F102	1
<b>Polypropylene</b>				
-	1" PP T Assembly (Includes Items 2-7)	TEBPPFC	TEBPPFC	1
2	1" PP T with FNPT Ends*	TEB010VT	TEB010VT	1
3	1" PP MNPT Pump Outlet Fitting	US61652	US61652	1
4	1" PP MNPT Nipple	NIP100-SH	NIP100-SH	1
5	1" PP Check Valve	US61655	US61655	1
6	1" PP MNPT Hose Barb Fitting	US61659	US61659	1
7	PP Wing Nut	1106	1106	1
<b>PVDF</b>				
-	1" PVDF T Assembly (Includes Items 2-7)	TEKPVDFFC	TEKPVDFFC	1
2	1" PVDF T with FNPT Ends*	TEK010VT	TEK010VT	1
3	1" PVDF MNPT Pump Outlet Fitting	US61661	US61661	1
4	1" PVDF MNPT Nipple	4884-020	4884-020	1
5	1" PVDF Check Valve	US61664	US61664	1
6	1" PVDF MNPT Hose Barb Fitting	US61665	US61665	1
7	PVDF Wing Nut	4106	4106	1
<b>Electric Motors</b>				
8	Open Drip Proof (IP44) 110-120V/1/50-60Hz with BCS Port	SP-280P-BC	-	1
	Open Drip Proof (IP44) 220-240V/1/50-60Hz with BCS Port	SP-280P-2-BC	-	1
	Refer to Page 14 for Spare Parts			
	TEFC (IP54) 110-120V/1/50-60Hz with BCS Port	SP-ENC-BC	-	1
	TEFC (IP54) 220-240V/1/50-60Hz with BCS Port	SP-ENC-2-BC	-	1
	Refer to Page 14 for Spare Parts			
<b>Air Motor &amp; Solenoid</b>				
9	Air Motor, 1/2 HP (370 W)	-	SP-A1	1
	Refer to Page 15 For Spare Parts			
10	Solenoid Valve Kit, SS316			1
	110-120V	-	0021SS	1
	220-240V	-	0021SS-2	1
<b>Pump Tubes</b>				
11	Polypropylene Drum Pump Tube	See Page 16	See Page 16	1
	PVDF Drum Pump Tube			

\* Items marked with an asterisk belong to the same assembly.

**Models: BC-280-PP, BC-ENC-PP, BC-280-PVDF, BC-ENC-PVDF,  
BC2-280-PP, BC2-ENC-PP, BC2-280-PVDF, BC2-ENC-PVDF,  
BC-A1-PP, BC-A1-PVDF, BC2-A1-PP & BC2-A1-PVDF**

**Air Motor Spare Parts Lists**

**SP-A1** See Figure 31

Ref. #	Description	P/N for SP-A1	Qty
1	Muffler	SAF350	1
2*	Gasket	SAC229	1
3	Dead end cap	SAC228A	1
4*	Bearing	SAG549	2
5	Dead end plate	SAC617	1
6*	Gasket	SAC527	2
7	Body	SAE899	1
8	Drive end plate	SAC616	1
9*	Shaft seal	SAC190A	1
10*	Vane	SAE893	4
11	Dowel pin	SD324A	4
12	Impeller	SAE896	1
13	Repair kit*	SK285	1
	Includes item numbers		1
	2, 4, 6, 9 and 10		1
14	A1 adapter	9007	1

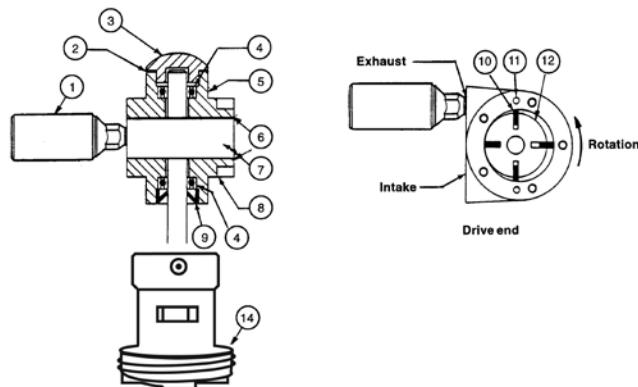

Figure 31 – SP-A1