

PREMIUM LIST

(UNBENCHED)

(FOR GOLDEN RETRIEVERS ONLY)

EVENT #s 2018461403,
2018461401, 2018461405,
2018461404, 2018461402
& 2018461406

**2 INDEPENDENT SPECIALTY SHOWS w/ SWEEPSTAKES,
VETERAN SWEEPSTAKES, 2 OBEDIENCE TRIALS,
2 JUNIOR SHOWMANSHIP COMPETITIONS, 2 RALLY TRIALS
& 2 FOUR-TO-SIX MONTH BEGINNER PUPPY COMPETITIONS**



NORTHERN FLYWAY GOLDEN RETRIEVER CLUB OF WISCONSIN

(Licensed by the American Kennel Club)

Held at the

WINNEGAMIE DOG CLUB TRAINING CENTER

2043 Manitowoc Road, MENASHA, WI 54952

SATURDAY, APRIL 28, 2018

SUNDAY, APRIL 29, 2018

NEW EXHIBITOR - BRIEFING

NEW EXHIBITOR, ANY EXHIBITOR

Please come to Show Secretary Table between 7:30 A.M. - 8:00 A.M. each day.

THESE SHOWS WILL BE HELD INDOORS

ENTRIES CLOSE at the Office of Roy Jones Dog Shows, Inc., WEDNESDAY NOON (EDT), APRIL 11, 2018, AFTER WHICH TIME ENTRIES WILL NOT BE ACCEPTED, CANCELLED, ALTERED, OR SUBSTITUTED, EXCEPT AS PROVIDED FOR IN CHAPTER 11, SECTION 6 OF THE DOG SHOW RULES OR CHAPTER 1, SECTION 16 OF THE OBEDIENCE REGULATIONS OR CHAPTER 1, SECTION 13 OF THE RALLY REGULATIONS. Obedience & Rally transfers will be allowed for each Trial per AKC Regulations.

A Refund of all but \$10.00 of the entry fee will be refunded for bitches entered in Obedience and/or Rally that come in season after the entries close. A Veterinarian's certificate must be presented to the Show Secretary no later than 1/2 hour prior to the start of the 1st class in the trial.

MAIL ENTRIES WITH FEES TO ROY JONES DOG SHOWS, INC., PO BOX 828, AUBURN, IN 46706 OR FAX ENTRIES WITH A SIGNED COVER LETTER GIVING ROY JONES DOG SHOWS, INC. AUTHORIZATION TO USE YOUR VISA, MASTERCARD, DISCOVER OR AMERICAN EXPRESS TO 260-925-1146. OR ENTER ON-LINE AT www.royjonesdogshows.com



American Kennel Club

CERTIFICATION Permission has been granted by the American Kennel Club for the holding of this event under the American Kennel Club rules and regulations.

GINA M. DINARDO, Executive Secretary

SHOW SECRETARY

Deb Krebsbach, C/O Roy Jones Dog Shows, Inc., PO Box 828, Auburn, IN 46706
260-925-0525 or www.royjonesdogshows.com

SHOW HOUR EACH DAY • 6:30 A.M. to 5:00 P.M. - CDT

Dogs are not required to be at the show until scheduled time of judging. All dogs not needed for further judging will be excused.
SHOW LOCATION IS AVAILABLE FRIDAY, APRIL 27, 2018 AT 3:00 P.M. - 5:00 P.M.

ENTRY FEES

NOTE: ENTRY FEES MUST BE RECEIVED FOR EACH ENTRY FOR EACH EVENT! IF FEES ARE RECEIVED FOR ONLY ONE EVENT, ONLY THE FIRST EVENT WILL BE PROCESSED!

Fees include the 50¢ AKC Recording Fee and the \$3.00 AKC Event Service Fee on the first entry of a dog and a \$3.00 AKC Event Service Fee for each additional entry of the same dog in the regular and non-regular recordable single entry classes, or the \$3.50 AKC Recording Fee on each entry of a dog in Rally and a \$3.00 for each additional entry of the same dog, or the \$2.00 AKC Event Service Fee on each entry in Four-To-Six Month Beginner Puppy. (There is no recording fee or event service fee for junior showmanship, sweepstakes, futurities, brace/team, multi-dog classes, or special attractions.)

First Class in which a dog is entered (excluding Puppies, Bred-by-Exhibitor & Non-Regular Classes)	\$30.00
Each Additional Class for the same dog	\$20.00
Puppy Classes as a First Entry	\$20.00
Bred-By-Exhibitor Classes as a First Entry	\$20.00
Conformation Veteran Class as a First or Additional Entry	\$20.00
Hunting Retriever Class as a First or Additional Entry	\$20.00
Stud Dog Class (Get Must be entered in a Regular or Non-Regular Class)	\$20.00
Brood Bitch Class (Produce Must be entered in a Regular or Non-Regular Class)	\$20.00
Sweepstakes (Must be entered in a Regular Class)	\$20.00
Veteran Sweepstakes (Need not be entered in a Regular Class)	\$20.00
Junior Showmanship Only	\$10.00
Junior Showmanship as an Additional Class	\$5.00
Obedience Only	\$30.00
Obedience as an Additional Class	\$20.00
Veteran Obedience Class	\$20.00
Rally Only	\$30.00
Rally as an Additional Class	\$20.00
Four-To-Six Month Beginner Puppy	\$20.00
Catalogs at the show site (limited number available)	\$ 5.00

ENTRIES CLOSE at the Office of Roy Jones Dog Shows, Inc., WEDNESDAY NOON (EDT), APRIL 11, 2018, after which time entries will not be accepted, cancelled, altered or substituted, except as provided for in Chapter 11, Section 6 of the Dog Show Rules or Chapter 1, Section 16 of the Obedience Regulations or Chapter 1, Section 13 or the Rally Regulations.

MAKE CHECKS and Money Orders payable to Roy Jones Dog Shows, Inc. (Returned Check Charge \$40.00). All Checks Must Have Show(s) & Breed(s) entered written on the face. **THIRD PARTY CHECKS WILL NOT BE ACCEPTED!**

ALL ENTRIES MUST BE SUBMITTED ON OFFICIAL AKC ENTRY FORMS, ONE DOG PER ENTRY FORM. Photocopies of front & back will be accepted only if legible, and official AKC size.

MAIL ENTRIES with Fees to ROY JONES DOG SHOWS, INC., P.O. BOX 828, AUBURN, IN 46706.

ENTRIES WILL NOT BE ACCEPTED WITHOUT SIGNATURE, FEES AND BACK ON ENTRY FORM WITH AGREEMENT, NOR WILL CREDIT CARDS BE ACCEPTED FOR MAIL-IN ENTRIES.

All entries must be submitted with checks drawn on U. S. Institutions OR with International Money Orders in U. S. Funds.

EXHIBITORS PLEASE NOTE

Exhibitors should follow their Veterinarians' recommendation to assure their dogs are free of internal and external parasites, any communicable diseases, and have appropriate vaccinations.

"Dogs found in an unsafe environment, distress or harm's way (for example: left unattended on a grooming table in a noose not attached to a safety release clip; left in a vehicle without proper ventilation) will be removed to safety. Exposing a dog to an unsafe environment, distress or harm's way is considered mistreatment."

No dogs that are disqualified for aggression will be allowed to enter these Shows, nor be allowed to be on the grounds. In addition, no aggression reinstatement procedures will be performed at these Shows.



NORTHERN FLYWAY GOLDEN RETRIEVER CLUB OF WISCONSIN OFFICERS

PRESIDENT Rick Krumenauer
VICE PRESIDENT Suze Walker
TREASURER Mary Ellen Hardin
SECRETARY Deborah Jo Krebsbach
 N26 W27037 Prospect Ave., Pewaukee, WI 53072 • 262-691-3192 • highfieldgoldens@gmail.com

BOARD OF DIRECTORS

Field - Sue Fecht Christopher Heckel
 Agility - Sionag Black Dana Bourassa
 Obedience - Leslie Tenor Karen Smith
 Conformation - Maureen Shaughnessy DVM Mary Strange, Jr.

SHOW COMMITTEE

Deborah Jo Krebsbach, Show Chairperson & Show Secretary
 N26 W27037 Prospect Ave., Pewaukee, WI 53072
 262-691-3192 • highfieldgoldens@gmail.com
 Leslie Tenor, Obedience & Rally Chairperson, 318 W Pine St., Denmark, WI 54208
 920-680-5402 • ltenor@aol.com
 And All the Officers of the Club

TROPHIES Cindy Pischke
CHIEF RING STEWARD Susan Rezy
HOSPITALITY Suze Walker
VENDORS Diane Henning • dh4gold@aol.com
GROUNDS/RV PARKING Rick Krumenauer • 920-527-8094 • decorahgoldens@sbcglobal.net
The Northern Flyway Golden Retriever Club of Wisconsin retains all rights to photograph or videotape by any means, and televise or reproduce this event in any way, now and in the future.

The Show Chairperson/Show Secretary & Hospitality Chairperson will not show their dogs in Breed Classes at these Shows.

VETERINARIAN (Will be on Call)

Fox Valley Animal Referral Center
 4706 New Horizons Blvd.
 Appleton, WI 54914
 920-993-9193



PHOTOGRAPHER

Cima Photography
 1287 Valley Road, Oshkosh, WI 54904
 920-233-8128
 cima@charter.net

(Only the Official Photographer may take win pictures.)

DIRECTIONS TO EMERGENCY VETERINARIAN: Take Manitowoc Road to Oneida. Turn RIGHT onto Oneida to Hwy 441. Turn LEFT to Hwy 441 West. Take Hwy 441 to Hwy 41 North. Follow Hwy 41 North to the Hwy BB (Prospect Ave) exit. Referral Center on the left. **Fox Valley Animal Referral Center, 4706 New Horizons Blvd., Appleton, WI 54914 • 920-993-9193**

JUDGES

* Indicates Provisional Judge Assignment

SATURDAY, APRIL 28, 2018

ALL REGULAR, NON-REGULAR, INTERSEX, *JUNIOR SHOWMANSHIP CLASSES & FOUR-TO-SIX MONTH BEGINNER PUPPY COMPETITION

Mr. Ken Matthews, 2718 Cedarwood Ave, Bellingham, WA 98225-1409

ALL SWEEPSTAKES & VETERANS SWEEPSTAKES

Ms. Cynthia Williamson, 3911 Grimm Road, Jarrettsville, MD 21084

ALL OBEDIENCE & RALLY CLASSES

Mrs. Suzanne M. Mayborne, 12900 Murphy Road, Winnebago, IL 61088-9373

SUNDAY, APRIL 29, 2018

ALL REGULAR, NON-REGULAR CLASSES, INTERSEX & FOUR-TO-SIX MONTH BEGINNER PUPPY COMPETITION

Ms. Judy Taylor, 1227 Roseville Road RR 2 Cambridge, Onatrio Canada, N1R 5S3

JUNIOR SHOWMANSHIP CLASSES

Dr. Jerry Sulewski, W1597 Town Road, De Pere, WI 54115-8432

ALL SWEEPSTAKES & VETERANS SWEEPSTAKES

Mrs. Karen Arbutnot, 422 Summer Fair Ct, Lake Saint Louis, MO 63367

ALL OBEDIENCE & RALLY CLASSES

Mrs. Suzanne M. Mayborne, 12900 Murphy Road, Winnebago, IL 61088-9373

ACCOMMODATIONS

Hotel policies may change toward dogs, please verify current policies when making reservations. Hotels listed are Pet Friendly

LA QUINTA INNS & SUITES 920-734-7777
 3800 W College Ave., Appleton, WI 54914

COUNTRY INN & SUITES 920-830-3240
 355 Fox River Dr., Appleton, WI 54913

COMFORT SUITES - Appleton Airport 920-730-3800
 3809 W Wisconsin Ave., Appleton, WI 54914

SUPER 8 - Appleton 920-731-0880
 3624 W College Ave., Appleton, WI 54914

RV PARKING

Contact Grounds Chair Rick Krumenauer at 920-527-8094 or decorahgoldens@sbcglobal.net

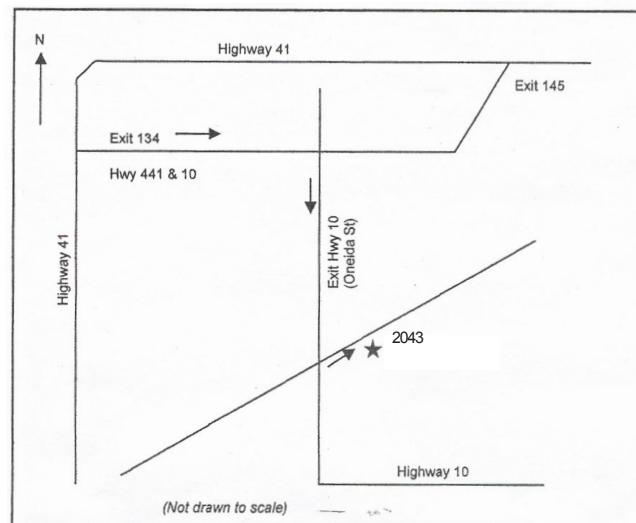

DIRECTIONS TO SHOW SITE

FROM THE NORTH OR SOUTH-Take Hwy 41, to Hwy 441 (also Hwy 10 East). Exit off Hwy 441 onto Hwy 10 East. Turn East (left) onto Manitowoc Road. The Winnebago Dog Club Training Center is on the South (right) side of the road.

****See judging program for any possible changes in directions due to potential road construction in April.****

EXHIBITORS PLEASE NOTE

- **ADMISSION & PARKING ARE FREE.**
- SHOW SITE IS AVAILABLE AT 3:00 PM - 5:00 PM ON FRIDAY, APRIL 27, 2018.
- NO DOGS MAY BE LEFT in building overnight.
- NO SMOKING INSIDE THE BUILDING.
- RESTROOMS ARE INDOORS AND HANDICAPPED ACCESSIBLE.
- NO SHOWER facilities are available.
- GROOMING AREA WILL BE AVAILABLE.
- NO EXERCISE PENS OR MATS will be allowed in the grooming areas.
- GROOMING will be in designated areas only. To ensure enough room for all exhibitors wishing to groom, please stack crates when possible. Space will be on a first-come, first-served basis and no space can be roped off or held with empty crates. One grooming table permitted for up to and including two entries. No exhibitor may use more than three grooming tables.
- PLEASE TURN OFF CELL PHONES/MOBILE DEVICES before entering the ring.
- Free early bird coffee & donuts available from 7:00 A.M. - 9:30 A.M. both days.
- Delicious plate lunch available at a very reasonable cost both days from 11:00 A.M. - 1:30 P.M.
- Only AKC eligible dogs are allowed on the show grounds.

FOUR-TO-SIX MONTH BEGINNER PUPPY COMPETITION**SATURDAY, APRIL 28, 2018 EVENT # 2018461405****& SUNDAY, APRIL 29, 2018 EVENT # 2018461406****Judged By:****Saturday - Mr. Ken Matthews ~ Sunday - Ms. Judy Taylor**

The Four-To-Six Month Beginner Puppy Competition shall be for Golden Retrievers that are four months of age and over but under six months on the day of the event. Classes will not be divided by sex in this competition. AKC registration number or an AKC litter number will be required for entries of an AKC recognized breed as listed in Chapter 3, Section 1 of the *Rules Applying to Dog Shows*.

- A Foreign born dog may enter this class if they are registered in the country of origin.
- All entrants are to be vaccinated (including rabies) in accordance with their veterinarian's protocol.
- Dogs that are owned or co-owned by a professional handler may compete in this class, but must be handled by a non-professional handler. *Professional handlers are defined as any person who belongs or has belonged to a professional handlers' organization, distributed rate cards, or otherwise advertised or represented themselves as handling dogs for pay within the last five years. Dogs may not be exhibited by current assistants and household members of a professional handler.*
- Exhibitors should open their dog's mouth for examination. If the judge finds it necessary to open the mouth they should disinfect their hands prior to examining other dogs.
- Male puppies without 2 fully descended testicles need not be disqualified or excused but the judge's book must describe the condition and Certificate of Merit points must be withheld.
- Dogs with breed standard disqualifications should not be excused but may not receive placements. However, dogs with age related disqualifications such as color (as related to age), height, teeth etc. are permitted to receive awards in the 4-6 Month Beginner Puppy classes.
- Dogs must be excused for attacking a person or other dogs.
- No dog is to be judged if it is brought into the ring bandaged, taped, glued or stitched anywhere including ears or tail. These dogs must be excused from judging but, at the judge's discretion, may return to be judged after the tape or bandage is removed.

Dealing with Misconduct will be applicable to any person and dog entered at this competition. All applicable rules found in Rules Applying to Dog Shows will govern the conduct of this competition unless these regulations state otherwise.

Entries Close at the office of Roy Jones Dog Shows, Inc., WEDNESDAY NOON (EDT), APRIL 11, 2018.

SATURDAY, APRIL 28, 2018 PRIZES & RIBBONS

BEST FOUR-TO-SIX MONTH BEGINNER PUPPY IN BREED-Rosette & Fleece Crate Mat offered by Cima Photography and Golden Retrievers.

BEST OF OPPOSITE SEX TO BEST FOUR-TO-SIX MONTH BEGINNER PUPPY IN BREED-Rosette offered by Northern Flyway Golden Retriever Club.

SUNDAY, APRIL 29, 2018 PRIZES & RIBBONS

BEST FOUR-TO-SIX MONTH BEGINNER PUPPY IN BREED-Rosette & NFGRC Logo Garment Bag offered by Northern Flyway GRC.

BEST OF OPPOSITE SEX TO BEST FOUR-TO-SIX MONTH BEGINNER PUPPY IN BREED-Rosette offered by Northern Flyway Golden Retriever Club.

FOUR-TO-SIX MONTH BEGINNER PUPPY JUDGING: Judging for the Four-to-Six Month Beginner Puppy will be held before judging of the regular classes.

DON'T FORGET TO CHECK THE FOUR-TO-SIX MONTH BEGINNER PUPPY BOX ON THE ENTRY FORM IF ENTERING THIS COMPETITION.

THE RIBBON PRIZES WILL BE AS FOLLOWS:

First Prize	Blue Ribbon	Third Prize	Yellow Ribbon
Second Prize	Red Ribbon	Fourth Prize	White Ribbon
Winners			Purple Rosette
Reserve Winners			Purple & White Rosette
Best of Winners			Blue & White Rosette
Best of Breed			Purple & Gold Rosette
Best of Opposite Sex to Best of Breed			Red & White Rosette
Select			Light Blue & White Rosette

OBEDIENCE & RALLY CLASSES

Highest Scoring Dog In Regular Classes	Blue & Gold Rosette
Highest Combined Score In Open B & Utility Classes	Blue & Green Rosette
Highest Combined Score In Advanced B & Excellent B Classes	Blue & Green Rosette
Highest Triple Qualifying Score	Blue & Red Rosette
Qualifying Score	Dk.Green Ribbon

NON-REGULAR, JUNIOR SHOWMANSHIP & SWEEPSTAKES CLASSES

First Prize	Rose Ribbon	Third Prize	Light Green Ribbon
Second Prize	Brown Ribbon	Fourth Prize	Gray Ribbon
Award of Merit			Green & White Rosette
Best Junior Handler			Rose & Green Rosette
Best in Sweepstakes			Pink & Green Rosette
Best of Opposite Sex to Best in Sweepstakes			Lavender Rosette
Best in Veteran Sweepstakes			Pink & Green Rosette
Best of Opposite Sex to Best in Veteran Sweepstakes			Lavender Rosette
Best Four-To-Six Month Puppy			Orange Rosette
Best of Opposite Sex to Best Four-To-Six Month Beginner Puppy			Lavender Rosette

CLASSIFICATION

Puppy, Dogs, 6 mos. & under 9 mos.	Puppy, Bitches, 6 mos. & under 9 mos.
Puppy Dogs, 9 mos. & under 12 mos.	Puppy Bitches, 9 mos. & under 12 mos.
12 mos. & under 18 mos., Dogs	12 mos. & under 18 mos., Bitches
Amateur-Owner-Handler, Dogs	Amateur-Owner-Handler, Bitches
Bred by Exhibitor, Dogs	Bred by Exhibitor, Bitches
American-bred, Dogs	American-bred, Bitches
Open, Dogs	Open, Bitches
Winners, Dog	Winners, Bitch

PLEASE NOTE THAT NOVICE CLASS IS NOT BEING OFFERED AT THESE SHOWS

NON-REGULAR CLASSES INVOLVING SINGLE DOG ENTRIES**VETERAN DOG CLASS VETERAN BITCH CLASS**

8 yrs. & under 10 yrs.

10 yrs. & older

Open to all Dogs who are 8 yrs. of age & older.

Neutered Dogs & Spayed Bitches may be entered

HUNTING RETRIEVER DOG CLASS HUNTING RETRIEVER BITCH CLASS

Any Dog or Bitch that has earned a Junior Hunter title or higher under AKC rules.

Winners of the above Non-Regular Classes, if otherwise undefeated, are eligible to compete for Best of Breed.

BEST OF BREED COMPETITION**AWARD OF MERIT**

Awarded at Judges discretion to maximum of 10% competing in Best of Breed Competition.

NON-REGULAR CLASSES INVOLVING MULTIPLE DOG ENTRIES

At the judge's decision in the Stud Dog & Brood Bitch Classes will be based on the merits of more than one dog or bitch, none of the dogs or bitches making up the entry judged first in the class will be eligible for Best of Breed by virtue of having won these classes.

Stud Dog Class-For Stud Dogs and two of their Get. Stud dogs entered in the Stud Dog Class must be shown in the ring with their Get. Only the Get will be judged, based on the merits of the Get. The Get **MUST** be entered in one of the Regular, Non-Regular or Best of Breed Classes. The Stud Dog Dog may be Neutered if it is the only class entered. The Stud Dog shall be considered as one entry and requires one entry fee, this being the regular fee plus the additional class if Stud Dog is entered in another class.

Brood Bitch Class-Same as Stud Dog Class except substitute "Brood Bitch" for "Stud Dog" and "Produce" for "Get". The Brood Bitch may be spayed.



OBEDIENCE CLASSES

REGULAR CLASSES

NOVICE A CLASS NOVICE B CLASS OPEN A CLASS OPEN B CLASS

UTILITY A CLASS UTILITY B CLASS

OPTIONAL TITLING CLASSES

BEGINNER NOVICE A CLASS BEGINNER NOVICE B CLASS

GRADUATE NOVICE CLASS GRADUATE OPEN CLASS

NON-REGULAR CLASSES

VETERANS CLASS

VETERANS CLASS-For Dogs and Bitches 8 years of age or older.

JUNIOR SHOWMANSHIP COMPETITION

Junior Handlers who win a third Novice Class with competition, if a win in Novice leads to a Best Junior with competition present it will count as one win towards moving to Open, after the closing of entries for a show are required to transfer their entry from the Novice Class to the Open Class by notifying the Superintendent/ Show Secretary at least one-half hour prior to the scheduled start of Junior Showmanship judging at the show. NOVICE CLASS-For boys and girls who are at least 9 years old and under 18 years old on the day of the show and who at the time entries close have not won three (3) first place awards, with competition present, in a Novice Class at a licensed or member show.

OPEN CLASS-For boys and girls who are at least 9 years old and under 18 years old on the day of the show, and who have won three first place awards in a Novice Class with competition present, in a Novice Class at a licensed or member show.

MASTER CLASS- This class will be for boys and girls who are at least 9 years old and under 18 years old on the day of the show, and who have won the 10 first place wins in an Open class with competition. The calendar for this class will be consistent with the eligibility dates for the AKC National Championship. All Juniors meeting the criteria for this class are required to enter the Master Class and must change their entry the day of the show if entries have already closed. Once the eligibility time frame for that year has passed all participants return to the Open Class to complete for the following year.

RALLY CLASSES • Use Rally Box on Entry Form

NOVICE A CLASS NOVICE B CLASS INTERMEDIATE CLASS

(Jump Height is REQUIRED for the Classes listed below)

ADVANCED A CLASS ADVANCED B CLASS

EXCELLENT A CLASS EXCELLENT B CLASS MASTER CLASS

RALLY RING SIZE 40'x50'

SATURDAY, APRIL 28, 2018 BREED PRIZES

The following Prizes are generously offered by the Northern Flyway Golden Retriever Club of Wisconsin, Inc., unless otherwise specified.

Rosettes are offered for Best of Breed, Best of Opposite Sex to Best of Breed, Best of Winners, Select Dog, Select Bitch, Winners Dog, Reserve Winners Dog, Winners Bitch, Reserve Winners Bitch & Award of Merit.

BEST OF BREED-Fleece Crate Mat offered by Mary Strange, Jr., Brae Lea Golden Retrievers.

BEST OF BREED-Rosette offered by Dr. Maureen Shaughnessy, Kamaglo Golden Retrievers.

BEST OF OPPOSITE SEX TO BEST OF BREED-Fleece Crate Mat offered by Mary Strange, Jr., Brae Lea Golden Retrievers.

BEST OF OPPOSITE SEX TO BEST OF BREED-Rosette offered by an Anonymous Benefactor.

WINNERS DOG-Fleece Crate Mat offered by Cima Photography and Golden Retrievers.

WINNERS BITCH-Fleece Crate Mat offered by Cima Photography and Golden Retrievers.

FIRST IN EACH REGULAR & NON-REGULAR CLASS-“Duck” Handsoap Pump offered by Deb & Tom Krebsbach, Judy Rathbun, Cathi Kanouse and Cindy Pischke.

SUNDAY, APRIL 29, 2018 BREED PRIZES

The following Prizes are generously offered by the Northern Flyway Golden Retriever Club of Wisconsin, Inc., unless otherwise specified.

Rosettes are offered for Best of Breed, Best of Opposite Sex to Best of Breed, Best of Winners, Select Dog, Select Bitch, Winners Dog, Reserve Winners Dog, Reserve Winners Bitch & Award of Merit.

BEST OF BREED-Paw Print Embroidered Duffel offered In Memory of Mrs. Mary A. Strange, Sr.

BEST OF BREED-Rosette offered by Dr. Maureen Shaughnessy, Kamaglo Golden Retrievers.

BEST OF OPPOSITE SEX TO BEST OF BREED-Paw Print Embroidered Duffel offered by Rick and Amy Krumenaur, Decorah Golden Retrievers.

BEST OF OPPOSITE SEX TO BEST OF BREED-Rosette offered by an Anonymous Benefactor.

WINNERS DOG-Paw Print Embroidered Duffel offered by Marilyn Hartman, Landican Golden Retrievers.

WINNERS BITCH-Paw Print Embroidered Duffel offered by Pat Vanden Heuvel, Woodwing Golden Retrievers.

FIRST IN EACH REGULAR & NON-REGULAR CLASS-NFGRC Logo Garment Bag.

SATURDAY, APRIL 28, 2018 & SUNDAY, APRIL 29, 2018

SWEEPSTAKES Summary & Requirements

The Sweepstakes is open to any purebred Golden Retriever 6 mos. of age and under 18 mos. of age on the day of the show, and **MUST be entered** in any of the Regular Classes at the Specialty Show at which these Sweepstakes are held. Champions of record are not eligible. The handler of a Sweepstakes exhibit must be limited to the owner, co-owner, breeder or member of their immediate family as they are listed on file with the AKC as of the closing date for the show for which the Sweepstakes entry is being made. Entry in the Sweepstakes must be made at the same time and on the same entry form as entry into regular classes, by indicating in the box for "Additional Classes" your entry in the Sweepstakes and age division.

SWEEPSTAKES CLASSIFICATIONS

Puppy Dogs, 6 mos. & under 9 mos. Puppy Bitches, 6 mos. & under 9 mos.
Puppy Dogs, 9 mos. & under 12 mos. Puppy Bitches, 9 mos. & under 12 mos.
Dogs, 12 mos. & under 15 mos. Bitches, 12 mos. & under 15 mos.
Dogs, 15 mos. & under 18 mos. Bitches, 15 mos. & under 18 mos.

BEST IN SWEEPSTAKES • BEST OF OPPOSITE SEX TO BEST IN SWEEPSTAKES

SWEEPSTAKES PRIZE MONIES

35% of total entry fee is to be retained to cover expenses.
BEST IN SWEEPSTAKES 20% of total entry fees
BEST OF OPPOSITE SEX TO BEST IN SWEEPSTAKES 15% of total entry fees
FIRST PLACE IN EACH CLASS 15%
SECOND PLACE IN EACH CLASS 7.5%
THIRD PLACE IN EACH CLASS 5%
FOURTH PLACE IN EACH CLASS 2.5%

SWEEPSTAKES PRIZES

3-streamer Rosettes are offered for Best In Sweepstakes & Best of Opposite Sex to Best In Sweepstakes by the Northern Flyway Golden Retriever Club of Wisconsin.

SATURDAY, APRIL 28, 2018 & SUNDAY, APRIL 29, 2018

VETERAN SWEEPSTAKES Summary & Requirements

The Veteran Sweepstakes is open to any purebred Golden Retriever over 8 years of age on the day of the show which is individually registered with the AKC. Entrants **NEED NOT** be entered in any other class. Champions of record and spayed or neutered Golden Retrievers are eligible. The handler of a Veteran Sweepstakes exhibit must be limited to the owner, co-owner, breeder or member of their immediate family as they are listed on file with the AKC as of the closing date for the show for which the Veteran Sweepstakes entry is being made. To avoid confusion, or question, please include a photocopy of the registration certificate with the entry for a co-owned exhibit. Entry in the Veteran Sweepstakes must be made by indicating in the box for "Additional Classes" your entry into the Veteran Sweepstakes and age division.

VETERAN SWEEPSTAKES CLASSIFICATIONS

Dogs, 8 yrs. & under 10 yrs. Bitches, 8 yrs. & under 10 yrs.
Dogs, 10 yrs. & Over Bitches, 10 yrs. & Over

BEST IN VETERAN SWEEPSTAKES • BEST OF OPPOSITE SEX TO BEST IN VETERAN SWEEPSTAKES

VETERAN SWEEPSTAKES PRIZE MONIES

35% of total entry fee is to be retained to cover expenses.
BEST IN VETERAN SWEEPSTAKES 20% of total entry fees
BEST OF OPPOSITE SEX TO BEST IN VETERAN SWEEPSTAKES 15% of total entry fees
FIRST PLACE IN EACH CLASS 15%
SECOND PLACE IN EACH CLASS 7.5%
THIRD PLACE IN EACH CLASS 5%
FOURTH PLACE IN EACH CLASS 2.5%

VETERAN SWEEPSTAKES PRIZES

3-streamer Rosettes are offered for Best In Veteran Sweepstakes & Best of Opposite Sex to Best In Veteran Sweepstakes by the Northern Flyway Golden Retriever Club of Wisconsin.

SATURDAY, APRIL 28, 2018 JUNIOR SHOWMANSHIP COMPETITION PRIZES

BEST JUNIOR HANDLER-3-streamer Rosette offered by the Northern Flyway Golden Retriever Club of Wisconsin, Inc.

BEST JUNIOR HANDLER-Fleece Crate Mat offered by Cima Photography and Golden Retrievers.

SUNDAY, APRIL 29, 2018 JUNIOR SHOWMANSHIP COMPETITION PRIZES

BEST JUNIOR HANDLER-3-streamer Rosette offered by the Northern Flyway Golden Retriever Club of Wisconsin, Inc.

BEST JUNIOR HANDLER-NFGRC Logo Travel Kit offered by Marilyn Hartman, Landican Sporting Dogs.



SATURDAY, APRIL 28, 2018 & SUNDAY, APRIL 29, 2018 OBEDIENCE TRIAL

'Dog' means either sex.

Qualifying Scores will be Required For All Prizes In Regular or Optional Titling Classes. A Qualifying Score will not be required to earn Ribbons or Prizes in the Non-Regular Classes.

Scores from the Optional Titling & Non-Regular Classes are not eligible for Highest Scoring Dog in the Regular Classes.

Northern Flyway Golden Retriever Club of Wisconsin, Inc., offers Dark Green Qualifying Score Ribbon to each dog receiving a Qualifying Score.

Transfers will be allowed for each Trial per AKC Regulations.

SATURDAY, APRIL 28, 2018**HIGHEST SCORING DOG IN REGULAR CLASSES**

FLEECE CRATE MAT offered by *Cima Photography and Golden Retrievers* and **BLUE & GOLD ROSETTE** offered by *Judy Rathbun, Northwind Golden Retrievers*
HIGHEST COMBINED SCORE IN OPEN B & UTILITY CLASSES

FLEECE CRATE MAT offered by *Cima Photography and Golden Retrievers* and **BLUE & GREEN ROSETTE** offered by *Lori Waltonen, Absolut Golden Retrievers*

CLASS PRIZES

FIRST IN EACH REGULAR & NON-REGULAR CLASSES-“Duck” Handsoap Pump offered by Deb & Tom Krebsbach, Judy Rathbun, Cathi Kanouse and Cindy Pischke.

SPECIAL PRIZES

HIGHEST SCORING CHAMPION IN TRIAL-Rosette offered by Deb Zierler, Harvestime Kennels.
HIGHEST SCORING FIELD DOG IN TRIAL-Rosette offered by Gail Kuklinski, Wildwing Golden.
HIGHEST SCORING AGILITY DOG IN TRIAL-Rosette offered by Deb Seline, Pemberley Kennels.
HIGHEST SCORING TRACKING DOG IN TRIAL-Rosette offered In Memory of Jim Hardin.
HIGHEST SCORING SENIOR HANDLER IN TRIAL-Rosette offered In Memory of Shirley Custer.
HIGHEST SCORING JUNIOR HANDLER IN TRIAL-Rosette offered In Memory of Boots Shepherd.

SUNDAY, APRIL 29, 2018**HIGHEST SCORING DOG IN REGULAR CLASSES**

PAW PRINT EMBROIDERED DUFFLE offered by *Randy & Leslie Tenor* and **BLUE & GOLD ROSETTE** offered by *Diana McClain, Highland Golden Retrievers*
HIGHEST COMBINED SCORE IN OPEN B & UTILITY CLASSES

PAW PRINT EMBROIDERED DUFFLE offered by *Dr. Don and Carol Van Beek* and **BLUE & GREEN ROSETTE** offered by *Sue Fecht*

CLASS PRIZES

The following Prizes are generously offered by the Northern Flyway Golden Retriever Club of Wisconsin, Inc, unless otherwise specified.

FIRST IN EACH REGULAR & NON-REGULAR CLASSES- NFGRC Logo Water Bottle.

SPECIAL PRIZES

HIGHEST SCORING CHAMPION IN TRIAL-Rosette offered by Deb Zierler, Harvestime Kennels.
HIGHEST SCORING FIELD DOG IN TRIAL-Rosette offered by Cathi Kanouse.
HIGHEST SCORING AGILITY DOG IN TRIAL-Rosette offered by Cathy Elmer, Snowden Golden Retrievers.
HIGHEST SCORING TRACKING DOG IN TRIAL-Rosette offered by Barb Grishaber.
HIGHEST SCORING SENIOR HANDLER IN TRIAL-Rosette offered In Memory of Shirley Custer.
HIGHEST SCORING JUNIOR HANDLER IN TRIAL-Rosette offered In Memory of Boots Shepherd.

A Refund of all but \$10.00 of the entry fee will be refunded for bitches entered in Obedience/Rally that come in season after the entries close. A Veterinarian's certificate must be presented to the Show Secretary no later than 1/2 hour prior to the start of the 1st class in the trial.

SATURDAY, APRIL 28, 2018 & SUNDAY, APRIL 29, 2018 RALLY TRIAL

'Dog' means either sex. **Qualifying Score Required For All Prizes In Regular Classes.**

Northern Flyway Golden Retriever Club of Wisconsin, Inc., offers

Dark Green Qualifying Score Ribbon to each dog receiving a Qualifying Score.

Transfers will be allowed for each Trial per AKC Regulations.

SATURDAY, APRIL 28, 2018**HIGHEST COMBINED SCORE IN ADVANCED B & EXCELLENT B CLASSES**

BLUE & GOLD ROSETTE offered by *Marilyn Hartman, Landican Sporting Dogs*

HIGHEST SCORING TRIPLE QUALIFYING SCORE

BLUE & RED ROSETTE offered by *Terre Radtke*

CLASS PRIZES

FIRST IN EACH REGULAR CLASS-“Duck” Handsoap Pump offered by Deb & Tom Krebsbach, Judy Rathbun, Cathi Kanouse and Cindy Pischke.

SUNDAY, APRIL 29, 2018**HIGHEST COMBINED SCORE IN ADVANCED B & EXCELLENT B CLASSES**

BLUE & GOLD ROSETTE offered by *Marilyn Hartman, Landican Sporting Dogs*

HIGHEST SCORING TRIPLE QUALIFYING SCORE

BLUE & RED ROSETTE offered by *Terre Radtke*

CLASS PRIZES

FIRST IN EACH REGULAR CLASS-NFGRC Logo Water Bottle offered by the Northern Flyway Golden Retriever Club of Wisconsin, Inc.

NOTICE TO EXHIBITORS

A RECORDING FEE of 50¢, and a \$3.00 AKC Event Service Fee will be required for each dog entered at any Licensed or Member Club Show, Obedience Trial or Tracking Test. If a dog is entered in more than one class in the show, a \$3.00 AKC Event Service Fee for each additional entry of the same dog in the regular and non-regular recordable single entry classes will be collected. (There is no recording fee or event service fee for junior showmanship, sweepstakes, futurities, brace/team, multi-dog classes, or special attractions.) (American Kennel Club Rule, Chapter 11, Section 2, American Kennel Club Obedience Regulation, Chapter 1, Section 9 & Tracking Regulation, Chapter 1, Section 5). Rally Trial or Agility Trial will have a \$3.50 AKC Recording Fee on the first entry & \$3.00 additional entry of same dog will be required for each entry. (American Kennel Club Rally Regulation, Chapter 1, Section 5 & Agility Trial Regulation, Chapter 1, Section 27) These Fees are to be collected by the Show-Giving Club and paid to the American Kennel Club.

IF, BECAUSE OF RIOTS, CIVIL DISTURBANCES, OR OTHER ACTS BEYOND THE CONTROL OF THE MANAGEMENT IT IS IMPOSSIBLE TO OPEN OR TO COMPLETE THIS SHOW, NO REFUND OF ENTRY FEE WILL BE MADE. THE WELL BEING OF THE DOGS, EXHIBITORS AND SPECTATORS IS OF PARAMOUNT IMPORTANCE, AND IN THE EVENT IT IS NECESSARY TO CANCEL OR STOP THE EVENT BEFORE COMPLETION, NO REFUND OF ENTRY FEE WILL BE MADE. ENTRY FEES shall not be refunded in the event that a dog is absent, disqualified, excused by Veterinarian or Judge or barred from competition by action of Show Committee. We will make every effort to find duplicate entries, but if entry is processed, NO REFUND SHALL BE MADE.

THE OWNER OR HANDLER of each dog is solely responsible for having it ready at ringside when its class is to be judged. The Show-Giving Club and Superintendent/Event Secretary have no obligation or responsibility for providing service through a public address system, or stewards or runners for the purpose of locating dogs that are not brought into the ring when required.

ALL EXHIBITORS ARE RESPONSIBLE FOR CLEANING UP AFTER THEMSELVES AND THEIR DOGS!

ENTRY FORM changes, additions, corrections and cancellations MUST be received in writing or by telegram prior to the closing of entries, and MUST INCLUDE AKC NUMBER AND BREED OF DOG. Those received by telephone are NOT acceptable. SUBSTITUTIONS REQUIRE A NEW COMPLETED ENTRY FORM.

CANCELLATIONS MUST BE LEGIBLE AND MUST INCLUDE AKC NUMBER OR NO REFUND WILL BE ISSUED!! A \$2.00 ADMINISTRATIVE/PROCESSING FEE PER ENTRY WILL BE DEDUCTED.

NOTE: TO FIND OUT ABOUT ANY AKC EVENT CANCELLATIONS CALL THE AKC EVENT CANCELLATION HOTLINE (877) 252-3229.

NO ENTRY shall be made and no entry shall be accepted which specifies any condition as to its acceptance.

NO ENTRY WILL BE ACCEPTED IN THE OFFICE OF ROY JONES DOG SHOWS, INC./SLEEPER, SUPT. IF IT IS RECEIVED AFTER 12:00 NOON ON THE PUBLISHED DAY OF CLOSING. ANY ENTRY RECEIVED AFTER 12:00 NOON ON THE PUBLISHED DAY OF CLOSING WILL BE RETURNED.

DUE TO THE LARGE VOLUME OF ENTRIES COMING IN AT THE LAST MINUTE, ANY ENTRY MISSING CRUCIAL INFORMATION OR ANY FAX ENTRY MISSING AUTHORIZATION FOR US TO USE YOUR CREDIT CARD FOR ENTRY FEES AND FAX FEES, MAY NOT BE CONTACTED AND WILL NOT BE PROCESSED.

ENTRIES WILL BE ACKNOWLEDGED AFTER ENTRIES CLOSE with Ident. Card and Judging Program. Should such acknowledgment not be received by the exhibitor within a reasonable time, please notify Roy Jones Dog Shows at 260-925-0525. The person accompanying the dog must show identification before the dog will be received.

THE SHOW-GIVING CLUB, the Show Superintendent/Event Secretary, their Agents, employees, etc., assume no responsibility for any loss, damage, or injury sustained by the exhibitors, handlers, or to any of their dogs or property, and further assume no responsibility for injury to children not under the control of their parents or guardians.

ANYONE SMOKING IN THE RINGS will be responsible for any damage done to matting due to extinguishing smoking materials on them!

ONE CHECK IS SUFFICIENT for all entries enclosed. ALL CHECKS must have Show(s) & Breed(s) entered written on the face.

EACH DOG MUST BE ENTERED ON A SEPARATE ENTRY FORM.

ONLY DOGS THAT ARE AKC ELIGIBLE ARE ALLOWED ON THE SHOW GROUNDS.

PLEASE NOTE ALL CHANGES IN INFORMATION on the entry form, otherwise they will not be made.

ALL VIDEOTAPING, PHOTOGRAPHY OR ANY REPRODUCTION OF ANY MEANS during the Show requires Club permission.

ANY ENTRIES received with post-dated checks will be returned. THIRD PARTY CHECKS WILL NOT BE ACCEPTED!

PLEASE REMEMBER TO TURN OFF CELL PHONES AND/OR PAGERS BEFORE ENTERING RINGS.

STREET ADDRESS-FOR OVERNIGHT PRIVATE CARRIERS ONLY-1105 W. AUBURN DR., AUBURN, IN 46706.

Roy Jones Dog Shows, Inc., Email Address: rjds@royjonesdogshows.com

Designated ramp breeds may be examined on the ground or on a ramp during breed judging according to the sole discretion of the judge & not the exhibitor. The entire entry in that breed is to be examined on the ground or on a ramp. Approved ramp breeds: (WHERE APPLICABLE)

Lagotti Romagnoli, American Water Spaniels, Boykin Spaniels, Clumber Spaniels, English Springer Spaniels, Field Spaniels, Sussex Spaniels*, Welsh Springer Spaniels, Basset Hounds*, Cirneci dell' Etna, Whippets, American Staffordshire Terriers, Irish Terriers, Kerry Blue Terriers, Soft Coated Wheaten Terriers, Staffordshire Bull Terriers, Bulldogs*, Chinese Shar-Pei*, Chow Chows*, Finish Spitz, Keeshonden, Norwegian Buhunds, Finnish Lapphunds, Polish Lowland Sheepdogs, Spanish Water Dogs & Norrbottenspets (misc).

*By Board approved policy Sussex Spaniels, Basset Hounds, Bulldogs, Chinese Shar-Pei & Chow Chows must be judged on the ramp in all conformation competition associated with AKC conformation dog shows or at which AKC conformation titles may be earned.

A judge requesting the use of a ramp must give reasonable notice to the Show Superintendent/Event Secretary prior to judging. AKC approval is not required. This policy extends to Junior Showmanship, the 4-6 Month Beginner Puppy Competition, the AKC National Owner Handled Series (NOHS), and all other special attractions that offer Group and BIS competitions. The list of Table and Ramp breeds can be found on the AKC Website under Conformation Judges - Announcements. Emergencies In emergency situations, with the approval of the Show Chair, breeds customarily examined on the ground may be examined on a ramp, not on a table. An emergency is defined as a temporary condition that arose immediately prior to or at a dog show. Convalescence from a medical procedure, illness and recuperation from injuries are examples of conditions that are not emergencies. The emergency use of a ramp may be allowed on a day and may be extended to include a cluster as well as judging either a group and/or Best In Show.

(In all but emergency situations, the exhibitor has no recourse. In an emergency situation, where use of a ramp is not indicated in the premium list, an exhibitor has the option of withdrawing their entry and receiving a refund).

TEL-A-FORM ENTRIES/R.O.C., INC. for ROY JONES DOG SHOWS/SLEEPER • FAX RULES

\$5.00 per entry (subject to change) is added for FAX entries. Along with the front and the back of each entry form, we need a cover letter stating that you authorize Roy Jones Dog Shows, Inc. to use your Visa, MasterCard, Discover or American Express for the following entry fees and fax fees. Then you need to print the card number, expiration date, Cardholders name, address, daytime phone number. A written signature on the cover letter is required. This written authorization is required to process faxed entries. **CARDHOLDERS WHOSE CHARGES ARE DECLINED BY THE BANK CARD AUTHORIZATION CENTER WILL NOT BE PROCESSED. CREDIT CARD RE-PROCESSING FEE IS \$10.00.** ALL entries, cancellations, etc., received by fax require show, breed, and AKC number. ALL transactions involving cancellations, class changes, or transfers will be charged a minimum of \$2.00 per entry. FAX ENTRIES RECEIVED AFTER NOON ON DATE OF CLOSING/ILLEGIBLE ENTRIES WILL NOT BE PROCESSED, NOR WILL NOTIFICATION BE MADE. **OUR FAX NUMBER IS 260-925-1146.**

OFFICIAL AMERICAN KENNEL CLUB ENTRY FORM

2 INDEPENDENT SPECIALTY SHOWS w/ SWEEPSTAKES, VETERAN SWEEPSTAKES, 2 OBDIENCE TRIALS,
2 JUNIOR SHOWMANSHIP COMPETITIONS, 2 RALLY TRIALS & 2 FOUR-TO-SIX MONTH BEGINNER PUPPY
NORTHERN FLYWAY GOLDEN RETRIEVER CLUB OF WISCONSIN

- SATURDAY, APRIL 28, 2018 • Specialty Show w/ Sweepstakes, Obedience & Jr Showmanship EVENT # 2018461403
 SATURDAY, APRIL 28, 2018 • RALLY TRIAL - EVENT # 2018461401
 SATURDAY, APRIL 28, 2018 • 4-6 Month Beginner Puppy EVENT # 2018461405
 SUNDAY, APRIL 29, 2018 • Specialty Show w/ Sweepstakes Obedience & Jr Showmanship EVENT # 2018461404
 SUNDAY, APRIL 29, 2018 • RALLY TRIAL - EVENT # 2018461402
 SUNDAY, APRIL 29, 2018 • 4-6 Month Beginner Puppy EVENT # 2018461406

WINNEGAMIE DOG CLUB TRAINING CENTER, 2043 Manitowoc Road, MENASHA, WI 54952

CHECK THE BOX(ES) INDICATING WHICH DAY(S) YOU ARE ENTERING
ENTRY FORM MUST BE EXACTLY THE SAME FOR EACH DAY

ENTRY FEES: SEE PAGE 2 FOR FEES

ENTRIES CLOSE at the Office of Roy Jones Dog Shows, Inc., WEDNESDAY NOON (EDT), APRIL 11, 2018, after which time entries will not be accepted, cancelled, altered or substituted, except as provided for in Chapter 11, Section 6 of the Dog Show Rules or Chapter 1, Section 16 of the Obedience Regulations or Chapter 1, Section 13 or the Rally Regulations.

MAKE CHECKS and Money Orders payable to Roy Jones Dog Shows, Inc. (Returned Check Charge \$40.00). All Checks Must Have Show(s) & Breed(s) entered written on the face. THIRD PARTY CHECKS WILL NOT BE ACCEPTED!

ALL ENTRIES MUST BE SUBMITTED ON OFFICIAL AKC ENTRY FORMS, one dog per entry form. Photocopies of front & back will be accepted only if legible, and official AKC size.

MAIL ENTRIES with Fees to ROY JONES DOG SHOWS, INC., P.O. BOX 828, AUBURN, IN 46706.

ENTRIES WILL NOT BE ACCEPTED WITHOUT SIGNATURE, FEES AND BACK ON ENTRY FORM WITH AGREEMENT, NOR WILL CREDIT CARDS BE ACCEPTED FOR MAIL-IN ENTRIES.

ALL ENTRIES must be submitted with checks drawn on U.S. Institutions or with International Money Orders in U.S. Funds.

I have enclosed \$_____ for my total entry fees

IMPORTANT Read *Instructions* on reverse side carefully before filling out. Numbers in the boxes indicate sections of the instructions relevant to the information needed in that box (PLEASE PRINT). Next, be sure to *read* the Agreement and *sign* on the reverse. **No form will be processed without your signature!**

Breed ⁵ RETRIEVER(GOLDEN)	Variety ¹	Sex
--	----------------------	-----

Dog Show Class ^{2,3}	Class ³ Division (Weight, color, etc.)
-------------------------------	---

Additional Classes	Obedience Class (Jump Height)	Rally Class (Jump Height)	Junior Showmanship Class
--------------------	-------------------------------	---------------------------	--------------------------

Name of (See Back) Junior Handler (If Any)	Junior Handler Number
---	-----------------------

Full Name of Dog

<input type="checkbox"/> AKC® No. <input type="checkbox"/> PAL/ILP No. <input type="checkbox"/> Foreign Reg No.	Place of Birth (Enter Country below) <i>Do not print the country in catalog</i>	Date of Birth
---	--	---------------

Enter number here

Breeder

Sire

Dam

Actual Owner(s)⁴
(Please Print)

Owner's Address

City	State/Prov	Zip/Postal Code
------	------------	-----------------

Telephone #	Are you a new exhibitor? <input type="checkbox"/> Yes <input type="checkbox"/> No	Owner/Handler Eligible? <input type="checkbox"/> Yes <input type="checkbox"/> No
-------------	--	---

Email Address (An acknowledgement or receipt of entry may be sent to this email address)

Name of Agent at the Show (If any)

Be sure to read the Agreement and sign on the reverse. No form will be processed without your signature!

AKC Rules, Regulations, Policies and Guidelines are available on the American Kennel Club web site www.akc.org

AGREEMENT

I certify that I am the actual owner of the dog, or that I am the duly authorized agent of the actual owner whose name I have entered above. In consideration of the acceptance of this entry, I (we) agree to abide by the rules and regulations of The American Kennel Club in effect at the time of this event, and any additional rules and regulations appearing in the premium list of this event and entry form and any decision made in accord with them. I (we) agree that the club holding this event has the right to refuse this entry for cause which the club shall deem sufficient. I (we) certify and represent that the dog entered is not a hazard to persons or other dogs. In consideration of the acceptance of this entry and of the holding of this event and of the opportunity to have the dog judged and to win prizes, ribbons, or trophies, I (we) agree to hold the AKC, the event-giving club, their members, directors, governors, officers, agents, superintendents or event secretary and the owner and/or lessor of the premises and any provider of services that are necessary to hold this event and any employees or volunteers of the aforementioned parties, and any AKC approved judge, judging at this event, harmless from any claim for loss or injury which may be alleged to have been caused directly or indirectly to any person or thing by the act of this dog while in or about the event premises or grounds or near any entrance thereto, and I (we) personally assume all responsibility and liability for any such claim; and I (we) further agree to hold the aforementioned parties harmless from any claim for loss, injury or damage to this dog. Additionally, I (we) hereby assume the sole responsibility for and agree to indemnify, defend and save the aforementioned parties harmless from any and all loss and expense (including legal fees) by reason of the liability imposed by law upon any of the aforementioned parties for damage because of bodily injuries, including death at any time resulting therefrom, sustained by any person or persons, including myself (ourselves), or on account of damage to property, arising out of or in consequence of my (our) participation in this event, however such, injuries, death or property damage may be caused, and whether or not the same may have been caused or may be alleged to have been caused by the negligence of the aforementioned parties or any of their employees, agents, or any other person.

I (we) agree that the determination of whether the injury is serious shall be made by the event veterinarian and is binding on me (us). I (WE) AGREE THAT ANY CAUSE OF ACTION, CONTROVERSY OR CLAIM ARISING OUT OF OR RELATED TO THE ENTRY, EXHIBITION OR ATTENDANCE AT THE EVENT BETWEEN THE AKC AND THE EVENT-GIVING CLUB (UNLESS OTHERWISE STATED IN THIS PREMIUM LIST) AND MYSELF (OURSELVES) OR AS TO THE CONSTRUCTION, INTERPRETATION AND EFFECT OF THIS AGREEMENT SHALL BE SETTLED BY ARBITRATION PURSUANT TO THE APPLICABLE RULES OF THE AMERICAN ARBITRATION ASSOCIATION. HOWEVER, PRIOR TO ARBITRATION ALL APPLICABLE AKC BYLAWS, RULES, REGULATIONS AND PROCEDURES MUST FIRST BE FOLLOWED AS SET FORTH IN THE AKC CHARTER AND BYLAWS, RULES, REGULATIONS, PUBLISHED POLICIES AND GUIDELINES.

Signature of owner or his agent

duly authorized to make this entry:

Telephone	Email
-----------	-------

INSTRUCTIONS

1. (Variety) If you are entering a dog of breed in which there are varieties for show purposes, please designate the particular variety you are entering, i.e., Cocker Spaniel (solid color black, ASCOB, parti-color), Beagles (not exceeding 13 in., over 13 in. but not exceeding 15 in.), Dachshunds (longhaired, smooth, wirehaired), Collies (rough, smooth), Bull Terriers (colored, white), Manchester Terriers (standard, toy), Chihuahuas (smooth coat, long coat), English Toy Spaniels (King Charles and Ruby, Blenheim and Prince Charles), Poodles (toy, miniature, standard).

2. The following categories of dogs may be entered and shown in Best of Breed competition: Dogs that are Champions of Record and dogs which, according to their owners' records, have completed the requirements for a championship, but whose championships are unconfirmed. The showing of unconfirmed Champions in Best of Breed competition is limited to a period of 90 days from the date of the show where the dog completed the requirements for a championship.

3. (Event Class) Consult the classification in this premium list. If the event class in which you are entering your dog is divided, then, in addition to designating the class, specify the particular division of the class in which you are entering your dog, i.e. age division, color division, weight division.

4. A dog must be entered in the name of the person who actually owned it at the time entries for an event closed. If a registered dog has been acquired by a new owner it must be entered in the name of its new owner in any event for which entries closed after the date of acquisition, regardless of whether the new owner has received the registration certificate indicating that the dog is recorded in his/her name. State on entry form whether transfer application has been mailed to the AKC. (For complete rules, refer to Chapter 11, Section 3.)

5. Mixed Breed dogs entering classes for Agility, Obedience, and Rally trials should mark Breed as "All-American Dog/Mixed Breed." Sire and Dam information shall remain blank for mixed breed entrants.

JUNIOR SHOWMANSHIP

If this entry is for Junior Showmanship, please enter the following information.

AKC Junior Handler Number	Junior's Date of Birth
---------------------------	------------------------

The Junior Handler number MUST be included. Should you not have your Junior Handler number, it may be obtained from the American Kennel Club, phone (919) 233-9767.

Junior Handler's Address

City	State/Province	Zip/Postal Code	Country (if not USA)
------	----------------	-----------------	----------------------

By signing the entry form, I (we) certify that the Junior Showman does not now, and will not at any time, act as an agent/handler for pay while continuing to compete in Junior Showmanship.

■ If this Junior Handler is not the owner of the dog identified on the face of this form, what is the relationship of the Junior Handler to the Owner?

□ CHECK HERE IF THIS IS NEW OWNER(S) □ CHECK HERE IF THIS IS NEW ADDRESS