

# Oxbow West Mitigation Site

## Existing Conditions

May 2001

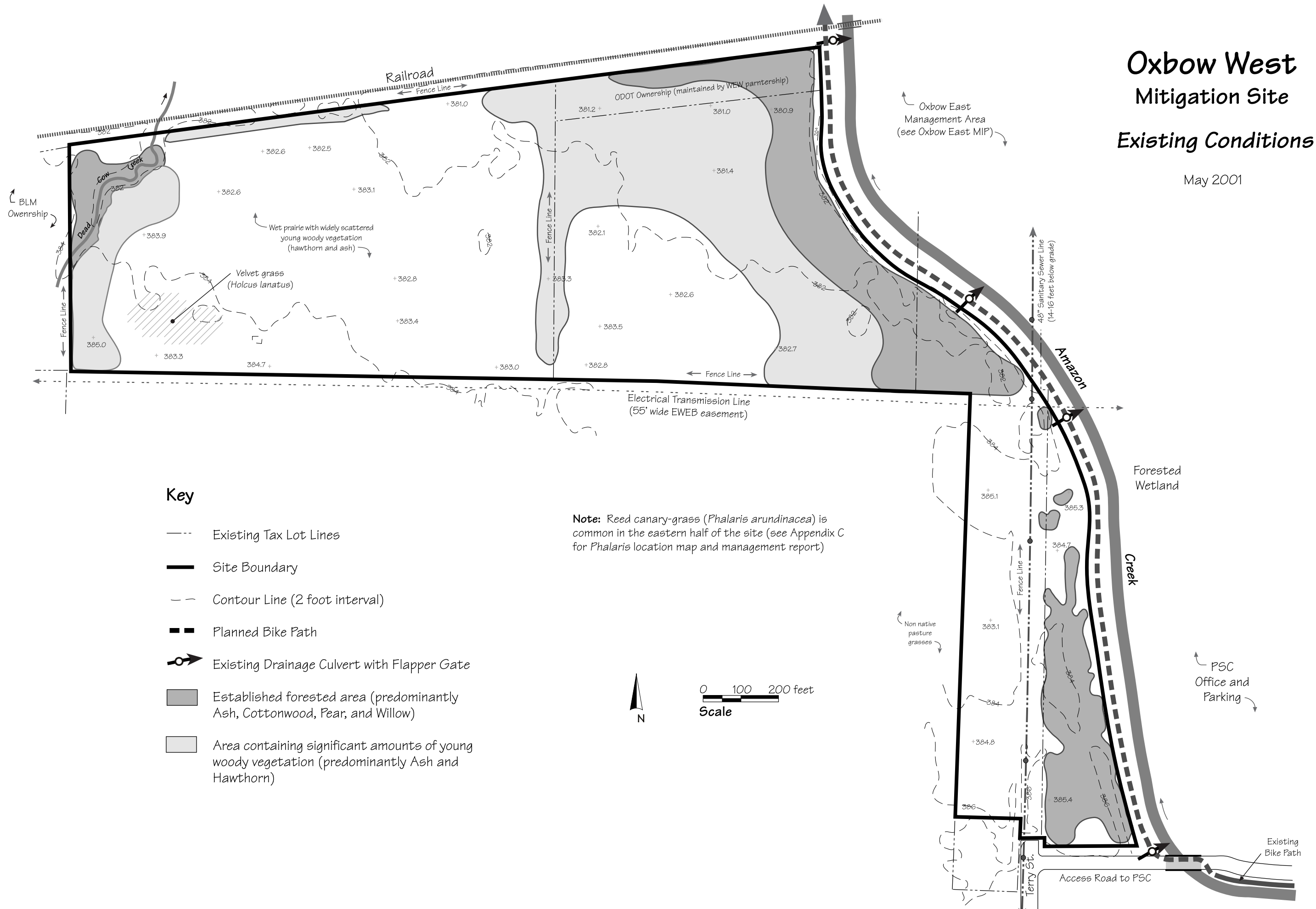

### Key

- Existing Tax Lot Lines
- Site Boundary
- - - Contour Line (2 foot interval)
- Planned Bike Path
- Existing Drainage Culvert with Flapper Gate
- Established forested area (predominantly Ash, Cottonwood, Pear, and Willow)
- Area containing significant amounts of young woody vegetation (predominantly Ash and Hawthorn)

**Note:** Reed canary-grass (*Phalaris arundinacea*) is common in the eastern half of the site (see Appendix C for *Phalaris* location map and management report)



0 100 200 feet  
Scale

# Oxbow West Mitigation Site

## Existing Surface Hydrology

June 1999

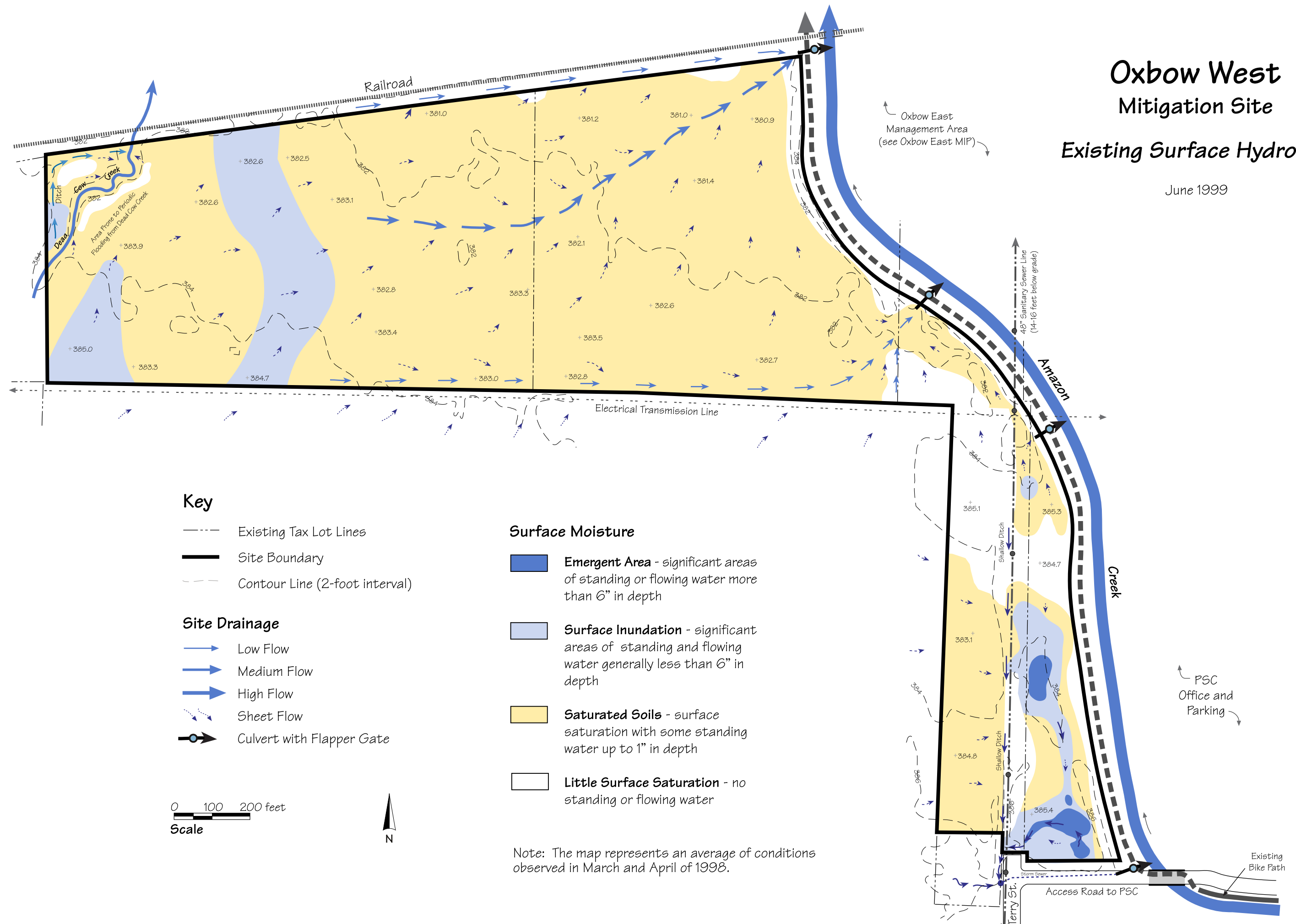

### Key

- Existing Tax Lot Lines
- Site Boundary
- Contour Line (2-foot interval)

### Site Drainage

- Low Flow
- Medium Flow
- High Flow
- Sheet Flow
- Culvert with Flapper Gate

### Surface Moisture

- Emergent Area** - significant areas of standing or flowing water more than 6" in depth
- Surface Inundation** - significant areas of standing and flowing water generally less than 6" in depth
- Saturated Soils** - surface saturation with some standing water up to 1" in depth
- Little Surface Saturation** - no standing or flowing water

Note: The map represents an average of conditions observed in March and April of 1998.

# Oxbow West Mitigation Site

## Existing Wetlands

August 1999

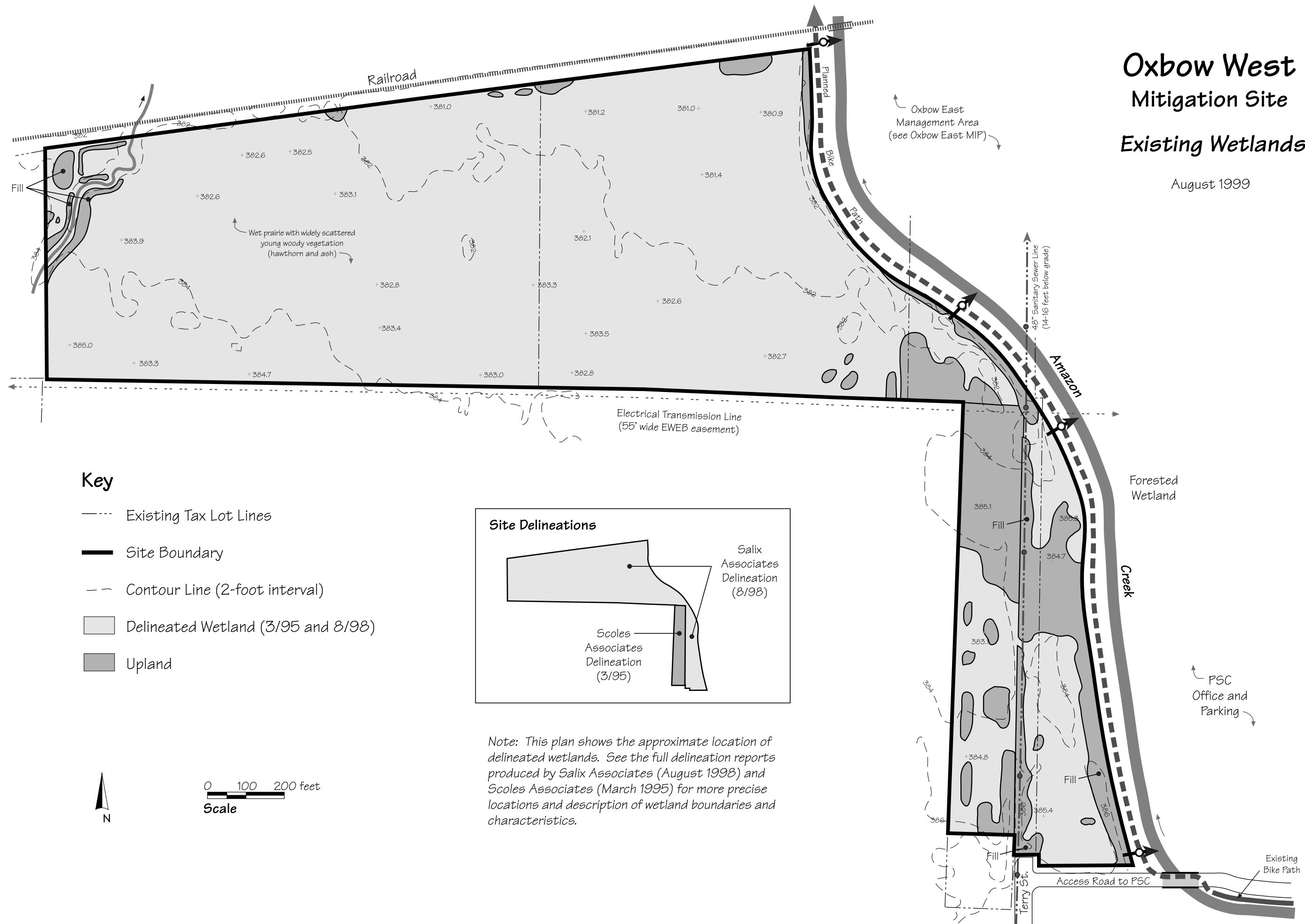

### Key

- Existing Tax Lot Lines
- Site Boundary
- - - Contour Line (2-foot interval)
- Delineated Wetland (3/95 and 8/98)
- Upland

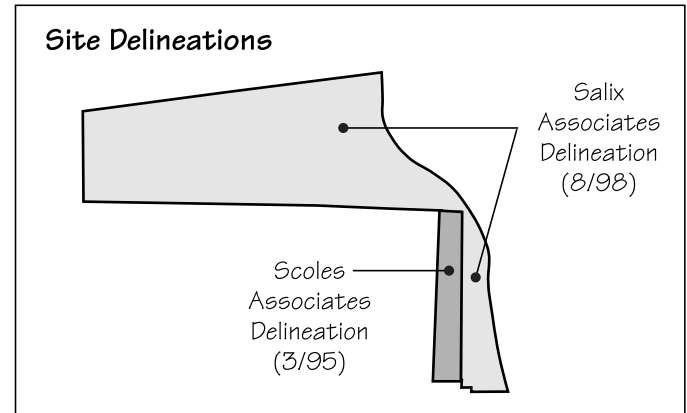

Note: This plan shows the approximate location of delineated wetlands. See the full delineation reports produced by Salix Associates (August 1998) and Scoles Associates (March 1995) for more precise locations and description of wetland boundaries and characteristics.

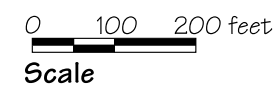

# Oxbow West Mitigation Site

## Proposed Action Plan

June 2001

