

WEST ELEVATION 1
A-4
 SCALE : 1/8" = 1' - 0"
 NOTE :
 FOR ADDITIONAL DETAILS ON EXTERIOR
 FINISHES SEE EAST AND SOUTH ELEVATIONS
 FIELD VERIFY LOCATION OF BUILDING ADDRESS

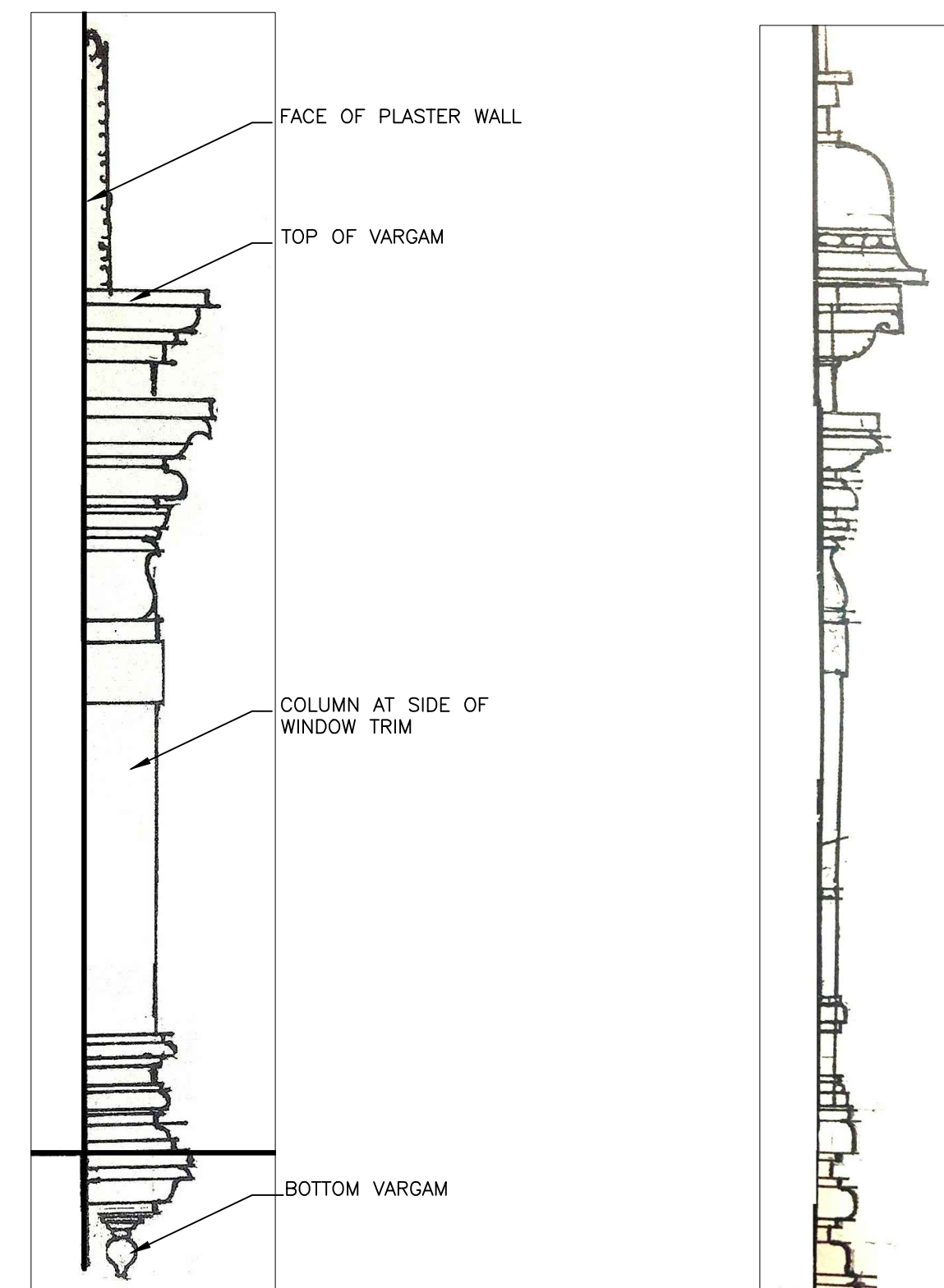

EXTERIOR WINDOW PROFILE 3
A-4
 SCALE : NTS

EXTERIOR WALL PROFILE 4
A-4
 SCALE : NTS

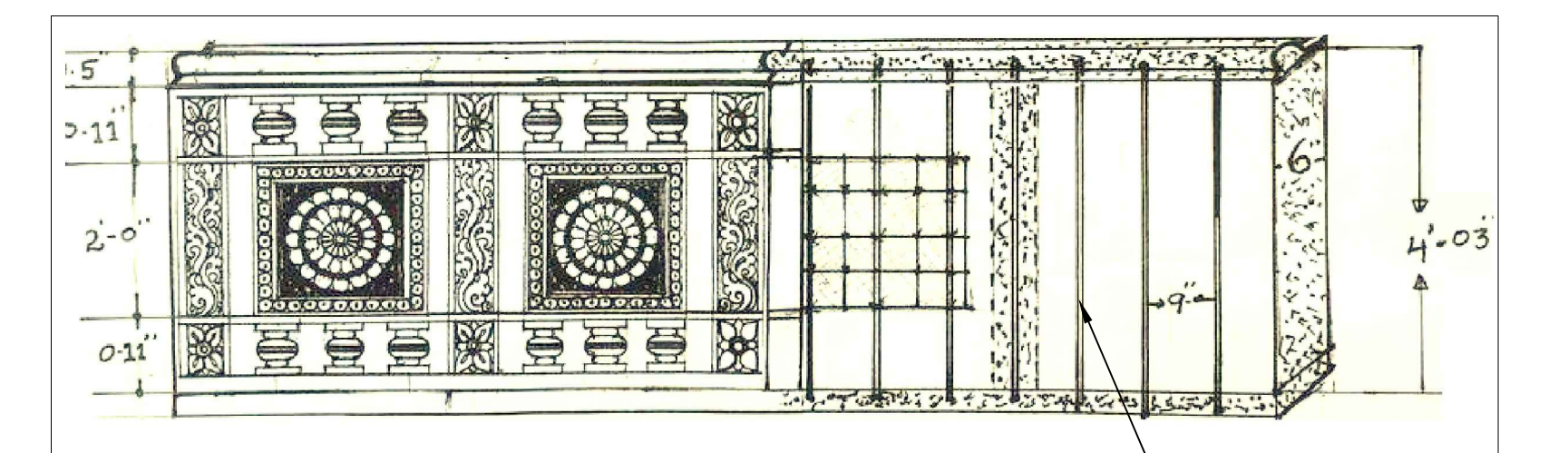

RAILING DETAIL 6
A-4
 SCALE : NTS

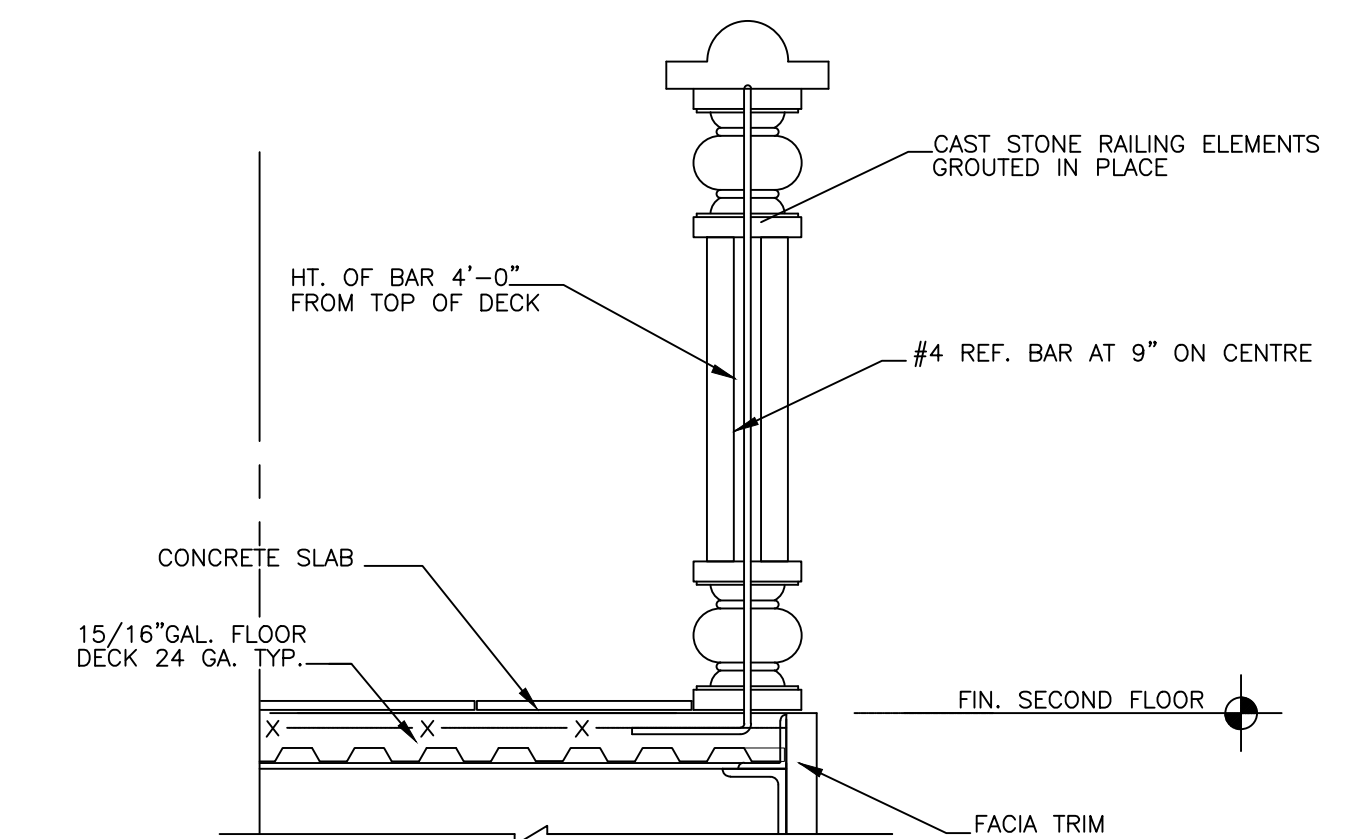

RAILING DETAIL 5
A-4
 SCALE : NTS
 NOTE : ALL RAILS TO MEET IBC CODE AND ALL REQUIRED LOCAL CODES.
 ALL OPENING IN SEE THRU RAILING CAN NOT EXCEED 3" OPENING.
 NOTE : #4 REINF. BAR AT 9" OC IN CONC SLAB

NOTE :
 ALL DECORATIVE CAST STONE BY OTHERS
 IN EXTERIOR CEMENT PLASTER WALL.

NOTE :
 THREE COAT TRADITIONAL CEMENT PLASTER (STUCCO)
 AND LATH ON ALL EXTERIOR WALLS UNO.
 OWNER'S OPTION TO USE EIFS IF APPROVED
 BY THE CITY OF ALLEN TX.



NORTH ELEVATION 2
A-4
 SCALE : 1/8" = 1' - 0"

NOTE :
 ALL COLUMNS, DOORS AND
 WINDOWS DECOR TO BE FINISHED
 IN TRUE GRC PAINTED WHITE

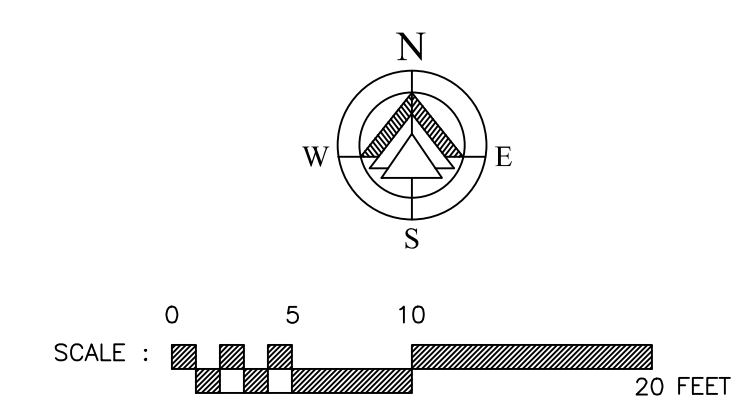

COPYRIGHT © 2014 BY SHASHI D. PATEL AIA. ALL RIGHTS RESERVED. REPRODUCTION IN PART OR WHOLE IS PROHIBITED WITHOUT A WRITTEN CONSENT FROM SHASHI D. PATEL AIA NCARB

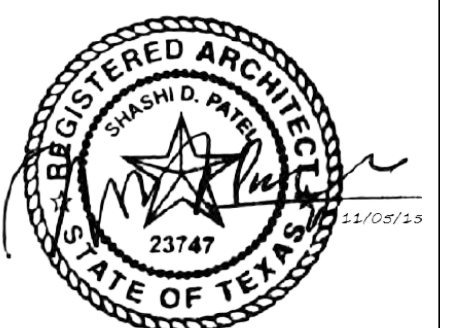

rev	
rev	△11-5-15 added building address
date	10-05-2015 released for const.
scale	AS NOTED
drawn by	CADD-SPA

SHASHI D. PATEL AIA NCARB
 ARCHITECTS AND PLANNERS
 442 EAST END AVE. STE-B. PITTSBURGH PA 15221

WEST AND SOUTH ELEVATION
 CONSTRUCTION DOCUMENT PHASE

RADHA KRISHNA TEMPLE
ALLEN TEXAS

dwg. 07162013 A-4
 no.