

**12IN RETAINING WALL**

PRODUCT NUMBER # 811



- Hard split showcases fractured rock and the veining and contrast of blended colors
- Rear lips ensure precise setback and eliminate the material and labor costs of connectors
- Hard split showcases fractured rock and the veining and contrast of blended colors
- Made of durable concrete that won't decay, distort, or attract pests. Iron oxide pigments won't fade with extended UV exposure

Choose the natural elegance and long-lasting beauty of a concrete garden wall block for your next landscape creation. The perfect complement to residential landscape design, these low-maintenance and easy-to-install stones are a beautiful solution for any project from garden beds and tree rings to curved walls and terraces. Environmentally friendly and attractive, these retaining walls flow naturally with your landscape's contours.

**STONE(S)**

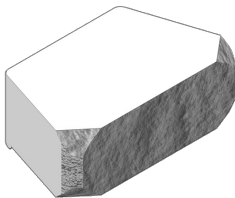

		Wall
<b>Height</b>	<i>in</i>	4
	<i>mm</i>	101.6
<b>Length</b>	<i>in</i>	6.75
	<i>mm</i>	171.5
<b>Width</b>	<i>in</i>	11.63
	<i>mm</i>	295.3
<b>Units</b>	<i>/pl</i>	144

**PALLET LAYOUT**

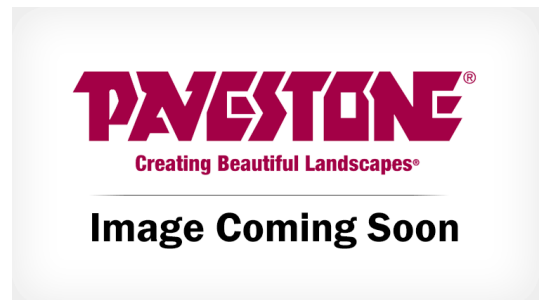

**NOTES**

Weights are approximate and do not include shipping pallet.

**PALLET SPECS**

<b>Pallet Weight</b>	3114 lbs
<b>Sq Ft/Pallet</b>	46.6 sq.ft.