

## // Retail Price List & Product Info Guide

**ALTA**  
WINDOW FASHIONS



**PORTER  
PRESTON**  
Quality Wholesale Window Coverings  
Contract • Hospitality • Residential

# WINDOW SHADINGS

Effective February 3, 2020

*design simplified™*

---

## TABLE OF CONTENTS

---

### Product Overview

- Features & Benefits ..... 2
- Collection Information (includes Light Control) ..... 3-4

### Pricing Groups

- Pricing Group 1 (Standard and Options). .... 5
- Pricing Group 2 (Standard and Options). .... 6
- Motorization Surcharges ..... 7

### Product Specifications

- Features & Options, Cord Loop Drop Chart ..... 8
- Mounting Requirements & Finished Dimensions ..... 9
- Options and Additional Notes ..... 10-12
- Simplicity Rechargeable Motorization: Overview ..... 13
- PowerWand Motorization: Overview. .... 14
- RemoteLift™ 2.0 Product Configuration Specifications. .... 15
- Standard Shading Operation. .... 16
- Retractable Cord and Cordless Shading Operation. .... 17
- Product Components – Standard ..... 18
- Product Components – Retractable Cord ..... 19
- Product Components – Cordless Lift ..... 20
- Product Components – Simplicity Rechargeable Motorization ..... 21
- Product Components – Powerwand™ Motorization ..... 22
- Product Components – Remotelift™ 2.0 ..... 23

### **Oversize Common Carrier Delivery**

All orders with any quantity of shades or blinds or any continuous valance 96" or more in width are considered oversize. Therefore, a net shipping charge of \$45 per oversized unit will be assessed.

Oversized orders that require expedited shipping will be quoted and charged accordingly.

Please see General Information for additional freight and shipping charge information.

## FEATURES & BENEFITS



- Three vane sizes complement any window, providing desired view through – available in 2", 2 1/2" and 3" for decorating flexibility.
- Available in translucent and light-dimming vane styles to provide varying degrees of light control.
- Filters out up to 88% of incoming harmful UV rays when open, and up to 99% when closed.
- Covers large window expanses with no visible internal lift cords to detract from their elegant appearance.
- When raised, they completely disappear into the headrail allowing more outside view.
- Standard cord loop, retractable cord control, cordless lift and battery-operated Simplicity Rechargeable, PowerWand, and RemoteLift 2.0 motorization options for operating convenience.
- Cordless lift, Simplicity Rechargeable, PowerWand, and battery-operated RemoteLift 2.0 motorization shades are certified Best for Kids.
- Fabric-covered headrail option for a soft look top to bottom.
- Limited Lifetime Warranty ensures your customers' satisfaction.



# COLLECTION INFORMATION

Family Name	Color Name	Family Code	Color #	Coordinating Hardware Color Number	Coordinating Hardware Color Name	Light Control	Price Group
<b>Classic</b> 2-1/2" Translucent N8	Applesauce	N8	226	551	Worn Leather	B	1
	Beige Glow	N8	203	320	Rich Cream	B	1
	Cashmere	N8	206	320	Rich Cream	B	1
	Cityscape	N8	238	426	Squirrel Gray	B	1
	Comfy Khakis	N8	199	180	Dove Gray	B	1
	Dried Basil	N8	065	426	Squirrel Gray	B	1
	Dusky View	N8	208	320	Rich Cream	B	1
	French Bread	N8	222	679	Buff Beige	B	1
	Mariner Blue	N8	224	469	Blue Creek	B	1
	Snow Cap	N8	201	661	White Tiara	B	1
	Sun Dream	N8	202	320	Rich Cream	B	1
<b>Coastal</b> 2" Translucent SL2	Foam	SL2	700	885	Flex White	B	1
	Mystery	SL2	761	426	Squirrel Gray	B	1
	Sand	SL2	701	320	Rich Cream	B	1
	Sculpting Clay	SL2	760	180	Dove Gray	B	1
	Seashell	SL2	703	679	Buff Beige	B	1
	Sunrise	SL2	702	320	Rich Cream	B	1
<b>Coastal</b> 3" Translucent SA3	Foam	SA3	700	885	Flex White	B	1
	Mystery	SA3	761	426	Squirrel Gray	B	1
	Sand	SA3	701	320	Rich Cream	B	1
	Sculpting Clay	SA3	760	180	Dove Gray	B	1
	Seashell	SA3	703	679	Buff Beige	B	1
	Sunrise	SA3	702	320	Rich Cream	B	1
<b>Passion</b> 2-1/2" Translucent P9	Classic Cream	P9	254	350	Vanilla	B	1
	Destiny's Dream	P9	253	661	White Tiara	B	1
	Heather White	P9	250	661	White Tiara	B	1
	Hint of Spice	P9	255	319	Earthen Beige	B	1
	Spiced Vinegar	P9	251	320	Rich Cream	B	1
	Touch of Beige	P9	252	320	Rich Cream	B	1
<b>Retreat</b> 2" Light Dimming SR2	Alpine	SR2	300	885	Flex White	C	2
	Antique	SR2	302	329	Summer Linen	C	2
	Faded Gray	SR2	331	551	Worn Leather	C	2
	Nickel	SR2	332	426	Squirrel Gray	C	2
	Sunset	SR2	301	320	Rich Cream	C	2
	Swiss Coffee	SR2	330	656	Golden Straw	C	2
<b>Retreat</b> 3" Light Dimming SR3	Alpine	SR3	300	885	Flex White	C	2
	Antique	SR3	302	329	Summer Linen	C	2
	Ash Gray	SR3	351	426	Squirrel Gray	C	2
	Cloud	SR3	309	320	Rich Cream	C	2
	Coffee Bean	SR3	308	849	Mocha	C	2
	Faded Gray	SR3	331	551	Worn Leather	C	2
	Nickel	SR3	332	426	Squirrel Gray	C	2
	Pebble	SR3	311	810	Mushroom	C	2
	Rock Garden	SR3	350	002	Alabaster	C	2
	Stone	SR3	310	656	Golden Straw	C	2
	Sunset	SR3	301	320	Rich Cream	C	2
	Swiss Coffee	SR3	330	656	Golden Straw	C	2
<b>Slub Style</b> 2-1/2" Translucent N10	Aloe Vera	N10	065	451	Lichen	B	1
	Chiffon	N10	213	320	Rich Cream	B	1
	Honey Roast	N10	222	679	Buff Beige	B	1
	Misty Seas	N10	238	426	Squirrel Gray	B	1
	Seashell	N10	204	320	Rich Cream	B	1
	Sugar Cane	N10	201	661	White Tiara	B	1
	Tea Time	N10	220	319	Earthen Beige	B	1
	Willow Herb	N10	226	551	Worn Leather	B	1

\* Light Dimming fabrics provide category C, opaque light control because even when the vanes are completely closed they DO NOT completely seal off all incoming light. See vane closure diagram on page 16 for a visual reference.

Note: Collections are presented alphabetically. Within each collection colors are also arranged alphabetically



## A. Glare Reducing

Softly filters light and reduces glare. Images, shapes and people can be seen clearly. Provides the least amount of light and shape screening.



## B. Filtering

Filters strong light. Images, shapes and people can be seen with some clarity. Provides a modest degree of light and shape screening.



## C. Shading

Significantly reduces light. Images, shapes and people cannot be seen clearly. Provides a moderate to strong degree of light and shape screening.



## D. Blocking

Dramatically reduces light. Images, shapes and people are not distinguishable. Provides privacy against most all direct light and shape screening (except minimal light that may seep through closed or overlapping opaque/blackout vanes).



## E. Blackout

Blocks out virtually all light (except light that may enter on the sides of the shade) for maximum privacy and darkness.



# COLLECTION INFORMATION

Family Name	Color Name	Family Code	Color #	Coordinating Hardware Color Number	Coordinating Hardware Color Name	Light Control	Price Group
<b>Soft Stripe</b> 2-1/2" Translucent N14	Banana Split	N14	205	350	Vanilla	B	1
	Crème Brûlée	N14	203	320	Rich Cream	B	1
	Ground Ginger	N14	226	551	Worn Leather	B	1
	Honey Butter	N14	222	679	Buff Beige	B	1
	Swan Song	N14	201	661	White Tiara	B	1
	Vanilla Milk Shake	N14	204	320	Rich Cream	B	1
<b>Solitude</b> 2-1/2" Light Dimming M16	Citron	M16	205	350	Vanilla	C	2
	Jute	M16	203	679	Buff Beige	C	2
	Parchment	M16	201	320	Rich Cream	C	2
	Soft Souffle	M16	204	551	Worn Leather	C	2
	Sunlit Crème	M16	202	320	Rich Cream	C	2
	Swan White	M16	200	661	White Tiara	C	2
<b>Sophisticate</b> 2" Translucent SS2	Applesauce	SS2	607	350	Vanilla	B	1
	Blue Wave	SS2	630	469	Blue Creek	B	1
	City Sidewalk	SS2	631	810	Mushroom	B	1
	Eggnog	SS2	605	320	Rich Cream	B	1
	Glacier	SS2	616	661	White Tiara	B	1
	Lily	SS2	601	885	Flex White	B	1
	Mist	SS2	602	661	White Tiara	B	1
	Moonlight	SS2	603	320	Rich Cream	B	1
	Natural Linen	SS2	619	002	Alabaster	B	1
	Opal	SS2	604	320	Rich Cream	B	1
	Pearl Grey	SS2	617	320	Rich Cream	B	1
	Pencil Sketch	SS2	632	426	Squirrel Gray	B	1
	Praline	SS2	609	350	Vanilla	B	1
	Sandstone	SS2	606	319	Earthen Beige	B	1
	Treasure Map	SS2	633	002	Alabaster	B	1
<b>Sophisticate</b> 3" Translucent SS3	Applesauce	SS3	607	350	Vanilla	B	1
	Blue Wave	SS3	630	469	Blue Creek	B	1
	City Sidewalk	SS3	631	810	Mushroom	B	1
	Eggnog	SS3	605	320	Rich Cream	B	1
	Glacier	SS3	616	661	White Tiara	B	1
	Lily	SS3	601	885	Flex White	B	1
	Mist	SS2	602	661	White Tiara	B	1
	Moonlight	SS3	603	320	Rich Cream	B	1
	Natural Linen	SS3	619	002	Alabaster	B	1
	Opal	SS3	604	320	Rich Cream	B	1
	Pearl Grey	SS3	617	320	Rich Cream	B	1
	Pencil Sketch	SS3	632	426	Squirrel Gray	B	1
	Praline	SS3	609	350	Vanilla	B	1
	Sandstone	SS3	606	319	Earthen Beige	B	1
	Treasure Map	SS3	633	002	Alabaster	B	1
<b>Villa</b> 2-1/2" Light Dimming N6	Castle Stone	N6	226	551	Worn Leather	C	2
	Coral	N6	202	320	Rich Cream	C	2
	Cotton	N6	201	885	Flex White	C	2
	Fawn	N6	203	320	Rich Cream	C	2
	Graphite	N6	238	426	Squirrel Gray	C	2
	Island Blue	N6	224	469	Blue Creek	C	2
	Spanish Olive	N6	065	451	Lichen	C	2
	White Sand	N6	213	885	Flex White	C	2

\* Light Dimming fabrics provide category C, opaque light control because even when the vanes are completely closed they DO NOT completely seal off all incoming light. See vane closure diagram on page 16 for a visual reference.

Note: Collections are presented alphabetically. Within each collection colors are also arranged alphabetically



## A. Glare Reducing

Softly filters light and reduces glare. Images, shapes and people can be seen clearly. Provides the least amount of light and shape screening.



## B. Filtering

Filters strong light. Images, shapes and people can be seen with some clarity. Provides a modest degree of light and shape screening.



## C. Shading

Significantly reduces light. Images, shapes and people cannot be seen clearly. Provides a moderate to strong degree of light and shape screening.



## D. Blocking

Dramatically reduces light. Images, shapes and people are not distinguishable. Provides privacy against most all direct light and shape screening (except minimal light that may seep through closed or overlapping opaque/blackout vanes).



## E. Blackout

Blocks out virtually all light (except light that may enter on the sides of the shade) for maximum privacy and darkness.

**2" Translucent**  
 Coastal (SL2)  
 Sophisticate (SS2)

**2 1/2" Translucent**  
 Classic (N8)  
 Passion (P9)  
 Slub Style (N10)  
 Soft Stripe (N14)

**3" Translucent**  
 Coastal (SA3)  
 Sophisticate (SS3)

## GROUP 1

WIDTH TO:	24"	30"	36"	42"	48"	54"	60"	66"	72"	76"	84"	90"	96"	102"	109"	120"
HEIGHT TO:																
36"	\$397	446	496	544	593	647	693	745	876	926	978	1029	1077	1144	1282	1399
42"	416	472	524	580	633	690	745	799	932	991	1045	1102	1154	1227	1372	1500
48"	443	498	559	615	675	735	798	859	994	1054	1112	1172	1234	1306	1462	1596
54"	459	523	585	653	718	782	848	922	1052	1116	1181	1248	1317	1398	1568	1712
60"	482	552	619	685	752	832	903	979	1108	1182	1252	1329	1404	1500	1685	1841
66"	504	578	651	722	799	880	962	1043	1168	1249	1331	1414	1496	1600	1807	1972
72"	524	605	682	760	845	932	1019	1104	1234	1319	1406	1496	1580	1694	1916	2091
78"	539	623	707	795	881	971	1061	1155	1290	1387	1476	1570	1657	1779	2014	2199
84"	562	651	737	834	926	1023	1122	1217	1357	1459	1556	1652	1747	1875	2125	2319
90"	584	675	771	872	971	1076	1177	1279	1423	1526	1632	1734	1835	1968	2231	2434
96"	609	705	801	911	1019	1123	1230	1337	1490	1600	1710	1816	1924	2067	2342	2556
102"	694	806	915	1034	1143	1247	1392	1529	1634	1745	1861	1964	2073	2205	2489	2716
108"	730	846	962	1087	1201	1314	1463	1612	1720	1838	1956	2070	2183	2321	2620	2862
114"	775	897	1022	1155	1280	1396	1555	1711	1828	1954	2073	2195	2315	2462	2776	3032
120"	834	962	1096	1237	1364	1496	1664	1830	1956	2090	2224	2350	2479	2636	2972	3245

### STANDARD FEATURES

- Headrail Size: 3-1/4" x 3-1/16"
- Snap-in Bracket Style
- Cord Tilt & Lift
- Color-Coordinated Hardware

### OPTIONS: EXTRA CHARGE

- Hardware Color Substitution Surcharge . . . . . **add \$22 per shading**
- Cordless Lift Surcharge . . . . . **add \$77 per shading**
- Retractable Cord Control Surcharge . . . . . **add \$68 per shading**
- Retractable Cord Two-on-One Headrail. . . . . **add \$135**
- Motorization. . . . . **see page 7**

### OPTIONS: NO CHARGE – SPECIFY ON ORDER

- Fabric-Covered Headrail
- Tilt Only Shadings 6" to 11-7/8" (standard only)
- Two-On-One Headrail – price as 2 separate shades (standard)
- Control Positions (R or L)
- Spacer Blocks
- Extension Brackets
- Hold-Down Brackets
- Back Cover for Inside or End Mounts
- Dust Cover for Outside Mounts

SIZE STANDARDS	Standard Loop	Retractable Cord
Minimum ordered width	12"	12"
Minimum ordered width – tilt only	6"	N/A
Maximum ordered width	120"	120"
Maximum ordered width end mount	48"	48"
Maximum ordered width – tilt only	11-7/8"	N/A
Minimum ordered height	16"	16"
Maximum ordered height – translucent	102" or 120"	102" or 120"

\* SA3 maximum ordered height is 102"

TWO-ON-ONE HEADRAIL	Standard Loop	Retractable Cord
Minimum ordered width	24"	24"
Maximum ordered width	144"	144"
Maximum height	120"	120"
Center gap	3/8"	3/8"

**Note:** Two-On-One Headrail option not available for end mount applications.

**Note:** Two-On-One Headrail option not available with Cordless Lift, RemoteLift 2.0, PowerWand, or Simplicity Motorization

POWERWAND™ UPGRADE	
Minimum ordered width	21"
Maximum ordered width	120"
Maximum ordered width end mount	48"
Minimum ordered height	12"
Maximum ordered height – Translucent	96"
<b>Maximum Square Feet - Translucent</b>	<b>60</b>

SIZE STANDARDS	Cordless Lift
Minimum ordered width	18"
Maximum ordered width	84"
Maximum ordered width end mount	N/A
Minimum ordered height	16"
Maximum ordered height – Translucent	84"

**Note:** Two-On-One Headrail option not available with cordless lift

**Note:** End Mount not available with cordless lift

REMOTELIFT 2.0 MOTORIZATION UPGRADE	
Minimum ordered width	12" or 20"
Maximum ordered width	120"
Maximum ordered width end mount	48"
Minimum ordered height	12"
Maximum ordered height – translucent	102" or 120"

\* SA3 maximum ordered height is 102"

\*\* Satellite Battery Pack or DC Power Supply = 12" min. Battery Wand = 20" min.

SIMPLICITY MOTORIZATION UPGRADE	
Minimum ordered width	21"
Maximum ordered width	120"
Maximum ordered width end mount	48"
Minimum ordered height	12"
Maximum ordered height – Translucent	96"
<b>Maximum Square Feet - Translucent</b>	<b>60</b>

**GROUP 2**
**2" Light Dimming  
Retreat (SR2)**
**2 1/2" Light Dimming  
Solitude (M16)  
Villa (N6)**
**3" Light Dimming  
Retreat (SR3)**

WIDTH TO:	24"	30"	36"	42"	48"	54"	60"	66"	72"	76"	84"	90"	96"	102"	109"	120"
<b>HEIGHT TO:</b>																
36"	\$437	490	546	602	654	712	763	821	959	1020	1076	1134	1186	1259	1413	1543
42"	459	522	578	638	699	760	821	880	1028	1089	1150	1211	1271	1348	1506	1645
48"	484	548	615	675	743	809	879	944	1089	1156	1223	1289	1355	1437	1611	1758
54"	506	576	647	719	784	859	933	1009	1155	1229	1297	1375	1454	1540	1731	1889
60"	529	605	681	755	832	913	998	1077	1218	1297	1380	1463	1548	1648	1853	2024
66"	553	631	718	798	880	968	1058	1148	1285	1376	1465	1555	1644	1760	1987	2170
72"	578	664	750	835	930	1028	1118	1212	1355	1454	1549	1644	1735	1863	2133	2327
78"	593	683	779	873	968	1073	1170	1272	1421	1521	1627	1727	1826	1958	2287	2497
84"	619	718	809	914	1022	1125	1235	1337	1496	1605	1711	1918	2004	2084	2453	2679
90"	644	743	845	957	1072	1182	1294	1403	1561	1678	1886	2002	2089	2218	2575	2810
96"	737	845	956	1075	1183	1290	1419	1547	1738	1848	1958	2069	2176	2327	2702	2950
102"	844	965	1089	1223	1328	1432	1607	1768	1908	2019	2132	2236	2346	2488	2868	3132

**STANDARD FEATURES**

- Headrail Size: 3-1/4" x 3-1/16"
- Snap-in Bracket Style
- Cord Tilt & Lift
- Color-Coordinated Hardware

**OPTIONS: EXTRA CHARGE**

- Hardware Color Substitution Surcharge . . . . . **add \$22 per shading**
- Cordless Lift Surcharge . . . . . **add \$77 per shading**
- Retractable Cord Control Surcharge . . . . . **add \$68 per shading**
- Retractable Cord Two-on-One Headrail. . . . . **add \$135**
- Motorization. . . . . **see page 7**

**OPTIONS: NO CHARGE – SPECIFY ON ORDER**

- Fabric-Covered Headrail
- Tilt Only Shadings 6" to 11-7/8" (standard only)
- Two-On-One Headrail – price as 2 separate shades (standard)
- Control Positions (R or L)
- Spacer Blocks
- Extension Brackets
- Hold-Down Brackets
- Back Cover for Inside or End Mounts
- Dust Cover for Outside Mounts

SIZE STANDARDS	Standard Loop	Retractable Cord
Minimum ordered width	12"	12"
Minimum ordered width – tilt only	6"	N/A
Maximum ordered width	120"	120"
Maximum ordered width end mount	48"	48"
Maximum ordered width – tilt only	11-7/8"	N/A
Minimum ordered height	16"	16"
Maximum ordered height – light dimming	102"	102"

SIZE STANDARDS	Cordless Lift
Minimum ordered width	18"
Maximum ordered width	84"
Maximum ordered width end mount	N/A
Minimum ordered height	16"
Maximum ordered height – light dimming	84"

**Note:** Two-On-One Headrail option not available with cordless lift

**Note:** End Mount not available with cordless lift

TWO-ON-ONE HEADRAIL	Standard Loop	Retractable Cord
Minimum ordered width	24"	24"
Maximum ordered width	144"	144"
Maximum height	102"	102"
Center gap	3/8"	3/8"

**Note:** Two-On-One Headrail option not available for end mount applications.

**Note:** Two-On-One Headrail option not available with Cordless Lift, RemoteLift 2.0, PowerWand, or Simplicity Motorization

REMOTELIFT 2.0 MOTORIZATION UPGRADE	
Minimum ordered width	12" or 20"***
Maximum ordered width	120"
Maximum ordered width end mount	48"
Minimum ordered height	12"
Maximum ordered height – light dimming	102"

\*\*\* Satellite Battery Pack or DC Power Supply = 12" min. Battery Wand = 20" min.

POWERWAND™ UPGRADE	
Minimum ordered width	21"
Maximum ordered width	120"
Maximum ordered width end mount	48"
Minimum ordered height	12"
Maximum ordered height - light dimming	84"
Maximum Square Feet - light dimming	50

SIMPLICITY MOTORIZATION UPGRADE	
Minimum ordered width	21"
Maximum ordered width	120"
Maximum ordered width end mount	48"
Minimum ordered height	12"
Maximum ordered height - light dimming	84"
Maximum Square Feet - light dimming	50



Motorization consists of a **motor, power source, and controller**. Be sure all of these elements are included when determining final price.

**SIMPLICITY RECHARGEABLE OPTIONS: EXTRA CHARGE – SPECIFY ON ORDER**  
**USE APPROPRIATE GRID FOR SHADE PRICE, THEN ADD EXTRA CHARGE(S) BELOW.**

- Simplicity Rechargeable Motor .....add \$281 per motor
  - 5 Channel Remote Control (Black Part #CS5138 or White Part #CS5138W) .....add \$41 each
  - Solar Panel (Part #CS52096 Solar Panel & mounting brackets) (Part #02-70-9021 Mounting bracket screws) .....add \$153 each
- PowerWand .....add \$113 each
- Plug-in Charger (Can be used for both Simplicity Rechargeable and PowerWand) (Part #CS5199) .....add \$31 each

**REMOTELIFT™ MOTORIZATION OPTIONS: EXTRA CHARGE – SPECIFY ON ORDER**

- Motorization .....add \$452 per shading
- Remote Control..... Part #2984495100 .....add \$54 each
- Wireless Wall Switch..... Part #2986350100 .....add \$75 each
- Satellite Battery Pack – select with wire length below..... Part #KIT2791
- Satellite Battery Pack – with 15" wire ..... Part #2989899000 .....add \$64 each
- Satellite Battery Pack – with 4' wire ..... Part #2989900000 .....add \$71 each
- Satellite Battery Pack – with 10' wire ..... Part #2989901000 .....add \$82 each
- Satellite Battery Pack – with 20' wire ..... Part #2989902000 .....add \$92 each
- DC Power Supply – select with wire length below..... Part #7806000000
- DC Power Supply – with 15" wire ..... Part #2989899000 .....add \$95 each
- DC Power Supply – with 4' wire ..... Part #2989900000 .....add \$96 each
- DC Power Supply – with 10' wire..... Part #2989901000 .....add \$100 each
- DC Power Supply – with 20' wire..... Part #2989902000 .....add \$104 each
- Daisy Chain Adapter – select with wire length below ..... Part #2989875000
- Daisy Chain Adapter – with 15" cable..... Part #2989899000 .....add \$45 each
- Daisy Chain Adapter – with 4' cable ..... Part #2989900000 .....add \$51 each
- Daisy Chain Adapter – with 10' cable ..... Part #2989901000 .....add \$56 each
- Daisy Chain Adapter – with 20' cable ..... Part #2989902000 .....add \$61 each

Notes: For surcharges on oversize common carrier delivery, express ship program, shipments to Hawaii, Alaska and Puerto Rico, see General Information Section

**MOMENTA APP BRIDGE KIT**

- Momenta App Bridge Kit (includes one Momenta Extender Kit) .....Part #2920072100 (must be submitted as part order) .....add \$128 NET Cost
- Momenta Extender Kit.....Part #2920075100 (must be submitted as part order) .....add \$47 NET Cost



**REMOTELIFT 2.0 ORDERING NOTES**

- Specify Inside (IB), outside (OB) or end (EB) mount.
- Specify if optional back cover is desired with inside (IB) mounts or end (EB) mounts.
- Specify if additional spacer blocks or extension brackets are needed for added clearance.
- Specify left- or right-side motor assembly.
- Specify number of remote control units (at least 1 required per order).
- If ordering satellite battery pack, specify wire length (15", 4', 10' or 20').
- If ordering DC power supply, specify wire length (15", 4', 10' or 20').
- Specify if daisy-chain cables are required to daisy-chain 2 or 3 shadings together (requires DC power supply). If ordering, specify wire length (15", 4', 10' or 20')

## PRODUCT SPECIFICATIONS

FEATURES	
# of fabric styles	12
# of Colors	105
Headrail size	3-1/4" X 3-1/16"
Bracket style	Snap-in
Cord loop tilt and lift	Yes, Standard
Raise, lower and tilt with one cord	Yes
Safety cord tensioner	Color Coordinated
Warranty	Lifetime Limited

OPTIONS - EXTRA CHARGE	
Fabric Covered Headrail	Yes
Hardware Color Substitution	Yes
Retractable Cord Control*	Yes
Cordless Lift <small>Not available as Two-on-One headrail</small>	Yes
PowerWand Motorization <small>Not available as Two-on-One headrail</small>	Yes
Simplicity Motorization <small>Not available as Two-on-One headrail</small>	Yes
RemoteLift 2.0 Motorization <small>Not available as Two-on-One headrail</small>	Yes
OPTIONS - NO CHARGE	
Tilt Only (available on standard loop control only)	Yes
Two-On-One Headrail Option <small>Not available with Cordless Lift, PowerWand, Simplicity Motorization or RemoteLift</small>	Yes
Control positions	Right or Left
<b>Control Positions</b> - PowerWand	Right or Left
<b>Wand Color</b> - PowerWand	White or Black
<b>Wand Length</b> - PowerWand	1 ft, 2 ft, 3ft, 4 ft, 5 ft
Spacer blocks	Yes
Extension brackets	Yes
Hold-down brackets	Yes
Back cover (Inside or End Mounts)	Yes
Dust cover (Outside Mounts)	Yes
Cord length (See Cord Loop Drop Chart)	Yes
Specialty shapes	No
Tile cut-out	No

\* Retractable cord length will be 40% of shading height.

## CORD LOOP DROP CHART

SHADING HEIGHT	CORD LOOP DROP
16" to 26-7/8"	1 ft. (white-only)
27" to 39-7/8"	2 ft.
40" to 59-7/8"	3 ft.
60" to 83-7/8"	4 ft.
84" to 107-7/8"	5 ft.
108" to 120"	6 ft. (white-only)

OPTIONAL CORD DROPS (White Cord Only)	
CORD DROP	INCREMENTS
6' – 12'	6" increments
12' – 16'	12" increments

Note: 18" white only cords available upon request

## MOUNTING REQUIREMENTS

INSIDE MOUNT	
Standard, Cordless, Retractable Cord, Simplicity Motorization, & PowerWand	
Minimum casement depth*	1"
Minimum casement depth*, fully recessed	3-3/8"
Minimum rear fabric clearance	1/8"

OUTSIDE MOUNT	
Standard, Cordless, Retractable Cord, Simplicity Motorization, & PowerWand	
Minimum mounting surface height	1"
Recommended width overlap per side	3"
Minimum rear fabric clearance	1/8"

END MOUNT	
Standard, Retractable Cord, Simplicity Motorization & PowerWand	
Minimum mounting surface depth*	1-1/4"

\* Add 1/4" to minimum depth dimensions if optional back cover is used for inside or end mounts.

INSIDE MOUNT - REMOTELIFT 2.0	Battery Wand	Sat. Bat. Pack
Minimum casement depth*	2"	1-1/4"
Minimum casement depth*, fully recessed	4"	3-1/2"
Minimum rear fabric clearance	1/8"	1/8"

OUTSIDE MOUNT - REMOTELIFT 2.0	Battery Wand **	Sat. Bat. Pack
Minimum mounting surface height	1"	1"
Recommended width overlap per side	3"	3"
Minimum rear fabric clearance	1/8"	1/8"

END MOUNT - REMOTELIFT 2.0	Battery Wand	Sat. Bat. Pack
Minimum mounting surface depth*	2-1/8"	1-1/2"

\* For inside and end mounts an optional back cover and back cover bracket may be ordered. The back cover bracket attaches to the installation brackets.

\*\* Requires 3/4" spacers per installation bracket (included), due to the added clearance required for the battery wand.

## FINISHED DIMENSIONS

Dimensions apply to standard loop control, cordless lift, retractable cord and motorization

NOTE: WIDTH AND HEIGHT MAY VARY  $\pm 1/8"$

INSIDE MOUNT – Standard Deductions	
Headrail unit	1/8" less than ordered width
Fabric width	1" less than ordered width
Fabric width - Cordless Lift	3/4" less than ordered width
Shading height	1/8" less than ordered height

OUTSIDE MOUNT – Standard Deductions	
Headrail unit	ordered width
Fabric width	3/4" less than ordered width
Fabric width - Cordless Lift	5/8" less than ordered width
Shading height	1/8" less than ordered height

END MOUNT – Standard Deductions (not available with Cordless Lift)	
Headrail unit	11/16" less than ordered width
Fabric width	1-1/2" less than ordered width
Shading height	1/8" less than ordered height

TWO-ON-ONE HEADRAIL (not available with Cordless Lift, RemoteLift 2.0, Simplicity Rechargeable, or PowerWand)	
Fabric width	1 1/4" less than ordered width
Gap between fabric panels	3/8"

FABRIC GAP – End Gap to Fabric (Gaps On Each Side)	
Control Side	5/8"
Idle Side	3/8"
Both Sides - Cordless Lift	3/8"



## OPTIONS

### RETRACTABLE CORD

Raise, lower and tilt shadings with one retractable cord. The cord length remains constant when shading is raised or lowered, making it ideal in homes with children or pets. Cord length will be 40% of the shading height and may be shortened for enhanced child safety.

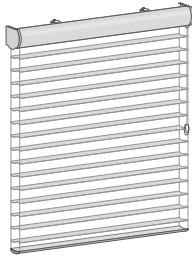

### TWO-ON-ONE HEADRAIL

Cover patio doors and other large expanses by placing two independently operated shades side-by-side on the same headrail. Note there will be a 3/8" light gap between the two shades, see minimum/maximum requirements under product specification section.

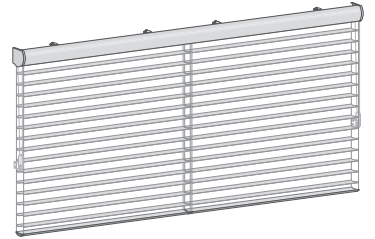

### CORDLESS LIFT

Raise, lower, and tilt shadings with cordless lift. A great choice for homes with children and pets, the lift, lower, and tilt mechanism are all controlled by the clear plastic handle attached to the bottomrail.



With your thumb on the front of the handle and fingers on the back, gently pull down to lower the shading. The hinged handle elegantly retracts when released. Continue pulling on the handle to lower the shadings and open the vanes.

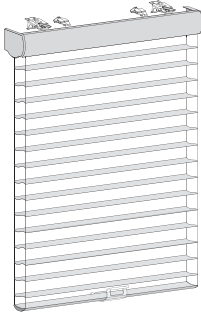

To close the vanes and raise the shades, gently pull down on the handle (about 1") and release. The vanes will close and then the shading will retract into the headrail.

### TILT ONLY SHADING

Ideal for sidelights or narrow windows.

- Shading cannot be raised, it can only be tilted open or closed.
- Hold down brackets are used to secure the bottomrail.

### FABRIC-COVERED HEADRAIL

Features a coordinating fabric wrapped onto the headrail to provide a soft fabric look from top to bottom. (See surcharge on pricing pages)



## OPTIONS

### OPTIONAL BACK COVER (INSIDE MOUNT)

Used with inside mounts to conceal the open rear side of the headrail for a more pleasing exterior look. Use of the back cover adds 1/4" to minimum inside mounting depths.

#### MINIMUM INSIDE MOUNTING DEPTH

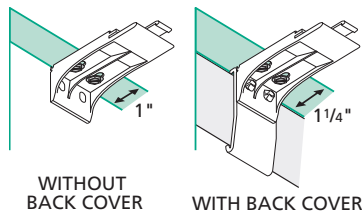

The back cover is secured in place by a back cover bracket attached to the installation bracket.

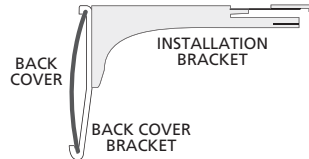

### OPTIONAL DUST COVER (OUTSIDE MOUNT)

Shields the fabric and internal headrail components from dirt, dust, and other contaminants.

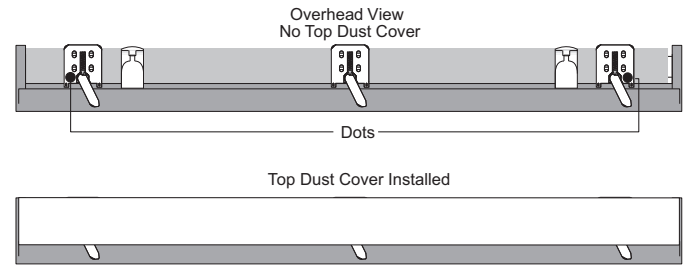

### SIDE-BY-SIDE VANE ALIGNMENT

When window shadings are installed side by side, vane alignment can be guaranteed within 1/4" only if:

- Shadings are ordered at the same time and in the identical style, color and height.
- Shadings that need to be aligned are specified on the order form (a note must be included in Special Instructions).
- Shadings exceeding combined width of 120" cannot be guaranteed

Note: Vane alignment cannot be guaranteed for Two-On-One Headrail and motorized shadings combined on the same order.

### BACK COVER BRACKET

When a back cover is used, attach back cover brackets to the installation brackets before mounting them. Remove the tab from the top of the back cover brackets and both tabs at the rear of the installation brackets.

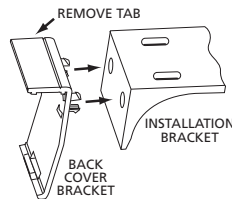

After mounting the installation brackets, install the back cover.

### ADJACENT SHADINGS

To span wide window openings, window shadings may be installed adjacently, so their headrails abut. The gap between the fabric panels of the adjacent shadings varies according to the control placement, as shown in the table below.

CONTROL PLACEMENT	
Adjacent (Abutting) Window Shadings	
Left/Right Shadings	Center Gap
Right/Right Controls	3/4"
Left/Left Controls	3/4"
Right/Left Controls	1-1/16"
Left/Right Controls	1/2"
Window shadings are not recommended for bay windows or butt-and-pass applications.	

## ADDITIONAL NOTES

### SHADING ADJUSTMENT

Shadings should wind evenly and not skew to one side.

A balance weight on the bottomrail can easily be adjusted if the fabric winds unevenly on the roll when the window shading is raised. Uneven winding can cause damage to the edge of the fabric.

- If skewing does occur:
  - Ensure headrail was installed level; shim if necessary.
  - To release, insert a flat blade screwdriver into the weight lock and turn clockwise.
  - Adjust placement of weight in bottomrail, 1" at a time, toward side where fabric is gathering.
  - Secure the weight locks in position by turning them counter clockwise, after making the adjustment.
  - Raise shade, then lower, if necessary, adjust again.

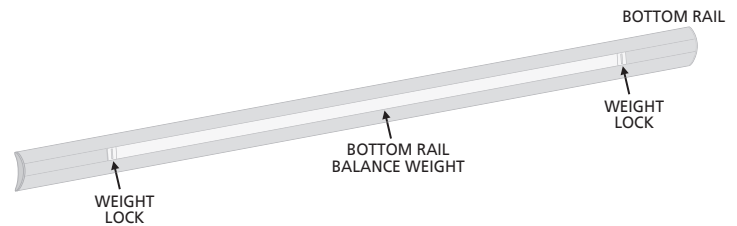

### SHADING INSTALLATION

To mount the shading, insert the top of the headrail into the brackets between the locking tab and the bracket flange. Push the headrail into the brackets until the locking tab clicks in place.

To remove the shading, lift the locking tab to release the headrail, rotate the headrail forward, and pull it straight out.

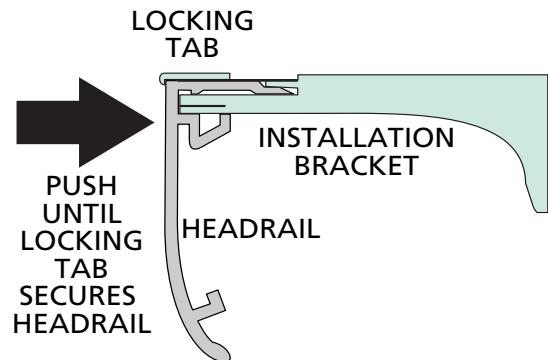

### MAGNETIC HOLD-DOWN BRACKETS

Magnetic hold-down brackets secure the bottom of the shading to prevent swaying. Available upon request. Standard on tilt-only shadings.

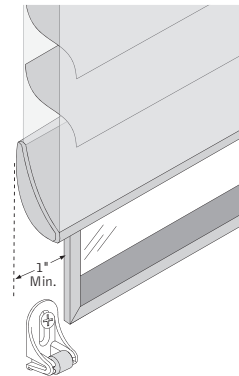



## SIMPLICITY RECHARGEABLE MOTORIZATION: OVERVIEW

### Simplicity Rechargeable

- The Rechargeable Simplicity motor program features an integrated rechargeable lithium ion battery in the motor casing and is fully concealed by the inner tube.
- Rechargeable battery is included with the motor. The average battery charge will last 6-12 months based on an average sized shade raised and lowered once per day. The life of the battery charge will vary based on the type of window covering selected, the size and weight of the window covering and the number of times the shade is operated on a daily basis. The battery can be recharged up to 500 times. It takes approximately 5 hours to recharge the motor when fully depleted.

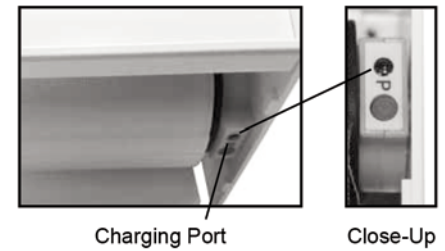

### Battery Charger

- An 8.4 Volt charger requires a standard power outlet to recharge the battery. The charger must be specified when ordering Simplicity Rechargeable Motorized shade option. The charger plugs into the charging port of the motor. The charger is black and comes with a 156" wire. The dimensions are 1" wide x 2-1/2" length x 1-3/4" deep. Sold separately.



### Solar Panel Recharge Option

- Plugs in to any Simplicity Rechargeable motorized shading (does not work with PowerWand). Provides constant trickle charge to 7.4v Li-ION Rechargeable battery packs. Does not require direct sunlight, but performs best in regular direct sunlight applications. Will prolong the life of the charge of the 7.4v rechargeable battery packs, and in some applications will maintain charge indefinitely.
- Life of charge is subject to application variables such as size and weight of shade, frequency of use, amount of direct sunlight exposure, etc.



### 5 Channel Remote

- The remote can operate up to five shadings simultaneously, individually or in groups. Remotes and holders are available in white or black. The remote comes with a holder which can be mounted to a wall for easy storage. The range of the remote is approximately 80 feet.



Please Note:

- Not all motors run at the same rate of speed.
- Simplicity motors have a "Favorites" position setting. To set a "Favorites" position, follow instructions provided in the installation instructions.

## POWERWAND MOTORIZATION: OVERVIEW

### PowerWand™ Motorization

- Shadings can be fabricated with the PowerWand Rechargeable Push Button Control option. The PowerWand Rechargeable option is an easy, cord free motorized operation for the budget savvy homeowner. PowerWand Rechargeable uses Simplicity motors and components.

### PowerWand Rechargeable Shades Operation

- Press the up or down button on the pendant to raise or lower the shading to your desired position. No programming is required with PowerWand as upper and lower limits are set at the factory. If desired, upper and lower limits can be adjusted in the field.
- Please refer to the installation instructions for instructions on resetting the upper and lower limits and setting a favorites position can be programmed on-site.

### PowerWand Appearance

- The PowerWand Rechargeable wand and pendant is attached to the head rail and requires no additional mounting.
- The wand and pendant hangs down the front of the shades from the head rail.
- Pendant is 2-1/2" long.
- The pendant does not need to be mounted to the wall to operate the shade.

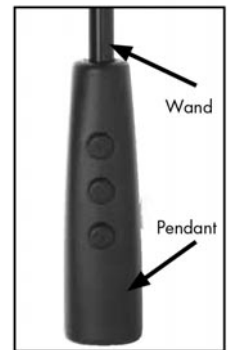

### PowerWand Options

- Wand is available in Black or White (there is no default).
- Wand is available in 1 foot increments from 1 to 5 feet (there is no default).
- Wand is available on the left or right side of shade (there is no default).



### PowerWand Battery Life

- The battery life will vary based on the type of window covering selected, the size and weight of the window covering and the number of times you operate the blind on a daily basis.

### Battery Charger

- 8.4 Volt charger requires a standard power outlet to recharge the battery. The charger must be specified when ordering the PowerWand motorization option. The charger plugs into the charger port on the side of the pendant. The charger is black and comes with a 156" wire. The dimensions are 1" wide x 2-1/2" length x 1-3/4" deep.



# REMOTELIFT™ 2.0 PRODUCT CONFIGURATION SPECIFICATIONS

RemoteLift 2.0 combines IR and RF wireless signals to control your window shadings. By using both line-of-sight (infrared technology) and "out-of-sight" (radio frequency technology), your customers achieve more operating flexibility. RemoteLift 2.0 operates one window at a time or a group of windows, even in multiple rooms.

- Quieter, more robust motor for raising, lowering and tilting shadings
- Ideal option for hard-to-reach windows behind furniture, above counters, in high foyers, etc.
- Enhanced safety in homes with children and pets
- State-of-the-art convenience; multiple options allow even further customization of window shadings
- Battery-powered system is easy to install and requires no additional wiring



## REMOTELIFT 2.0 SYSTEM OPTIONS

### BATTERY WAND

Battery wands are the standard power source whether inside (IB), outside (OB) or end (EB) mount, if applicable. Battery wands are mounted on the rear of the headrail. The redesigned battery wand will allow for batteries to be changed without removing the window covering from the window.

- 12 AA 1.5V alkaline batteries.
- Battery life exceeds one year, depending on usage.
- Replace batteries when the window covering(s) begin to operate slowly.



18V Battery Wand

### SATELLITE BATTERY PACK

The satellite battery pack is an optional power source. The battery pack connects to the same side of the headrail where the receiver eye or satellite eye is located. The satellite battery pack is the best choice when the window covering is mounted in a high window, restricting access to a battery wand.

- 18V satellite battery pack:
  - Available in 15", 4', 10' and 20' wire lengths.
  - 12 AA 1.5V alkaline batteries.
- Battery life is approximately one year, depending on usage.
- Replace batteries when the window covering(s) begin to operate slowly.
- Mounting options: top of headrail, next to molding or under the sill.
- Satellite battery pack cover can be painted.



18V Satellite Battery Pack

### DC POWER SUPPLY

The DC power supply is an optional power source. The DC power supply plugs into any standard household outlet.

- 18V DC power supply:
  - Available in 15", 4', 10' and 20' wire lengths.
- Eliminates need to change batteries.



18V DC Power Supply

## DAISY CHAIN

The optional Daisy Chain Adapter allows up to 3 shades to run off of one DC power supply. You must specify the cable wire length when order is placed.

Note: Keep in mind which side the sensor eye is positioned on each side when determining daisy-chain length.



Daisy-Chain Adapter/Connector



# STANDARD SHADING OPERATION

## STANDARD SHADING OPERATION

Shadings are operated using a continuous cord loop. As shown in the illustration below, from the fully raised position [1] pulling down on the rear half of the cord loop lowers the shading [2, 3]. After it is fully lowered, continuing to pull down on the cord pivots the bottomrail and opens the fabric vanes [4]. When the vanes are fully open [5], limit stops in the headrail prevent further movement in that direction.

With the fabric vanes fully open, pulling down on the front half of the cord loop first closes the vanes [6, 7] and then raises the window shading [8]. When it is fully raised [1], limit stops again halt shading movement, preventing the bottomrail from being retracted too far into the headrail.

## Light Control

With the shading in the fully lowered position, the continuous cord loop is used to adjust the fabric vanes from open to closed, and anywhere in between. Light control is at your customer's fingertips. (Note: The degree of maximum vane closure varies slightly from the top to the bottom of the shading.)

## Vane Opening

Vane opening is the amount of unobstructed visibility between fully open vanes when looking through the shading at eye level. Vane opening for shadings is 1" to 1-1/2" depending on vane size and opacity.

- 2" Light Dimming = 1"
- 2" and 2-1/2" Translucent, 2-1/2" Light Dimming = 1-1/4"
- 3" Translucent and Light Dimming = 1-1/2"

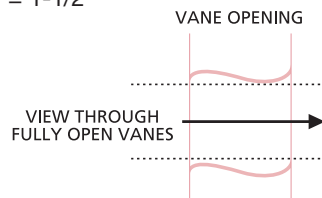

## Vane Closure

When the vanes of a window shading are closed, they overlap each other, blocking the view. However, the vanes do not contact each other along the full length of the shading – they do not form a perfect seal against light leakage. This is most visible toward the bottom of the shading.

Vane closure is

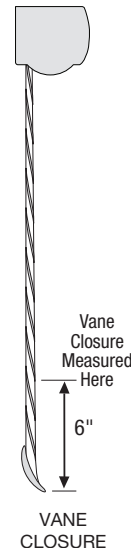

measured as the distance between the front and rear fabric facings 6" up from the lowest point of the bottomrail, with the shading fully lowered and the vanes closed, as illustrated here. Vane closure for all fabrics is 1".

**Note:** The degree of maximum vane closure varies slightly from top to bottom of the shading.

- Over-rotation can occur when the shading is completely lowered and vanes are opened. The bottom rail turns up to the inside of the opening when the vanes are in the horizontal position.

**Note:** Over-rotation is an inherent characteristic of Window Shadings. The amount of over-rotation may vary from shade to shade.

## PLEASE NOTE:

- Cord tensioner **MUST** be mounted to window casement or wall in order for the shade to operate.
- As with all textiles, Window Shading fabrics are subject to some variations. Slight wrinkles, puckering or bowing is inherent to textile products and should be considered normal, acceptable quality.

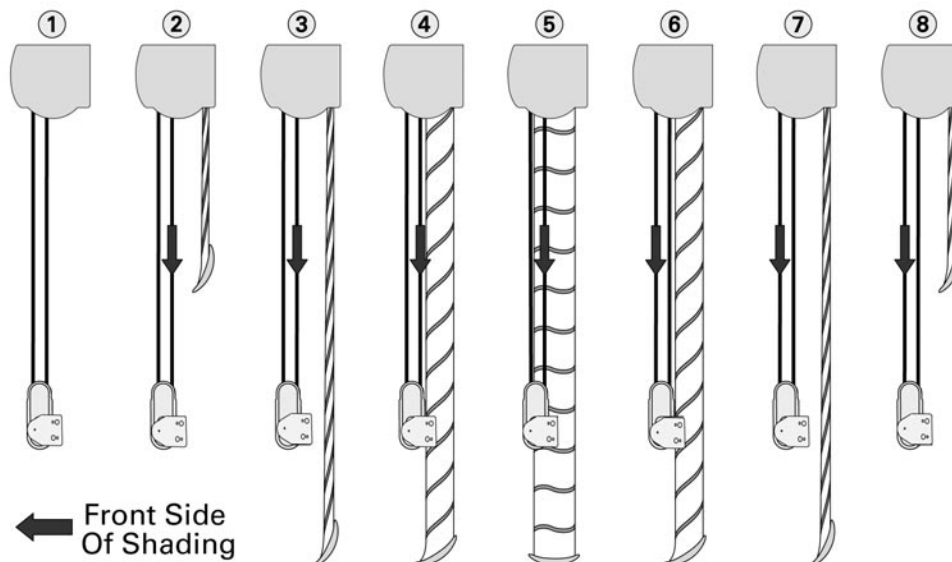

## OPERATION

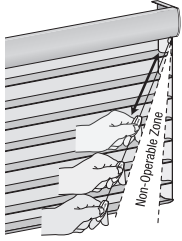

### RETRACTABLE CORD

#### To Lower the Shading

To lower shading and open vanes, pull cord toward the center and down in long even strokes.

Note: Allow cord to fully retract between each stroke.

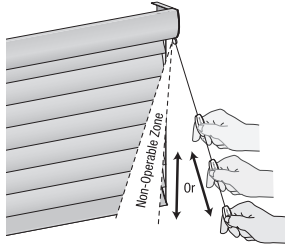

#### To Close and Raise the Shading

To close vanes and raise shading, pull cord straight down or down and slightly out using long even strokes.

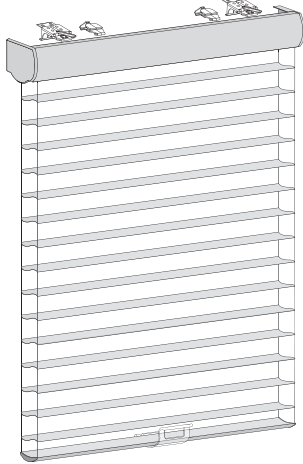

### CORDLESS LIFT

Raise, lower, and tilt shadings with cordless lift. A great choice for homes with children and pets, the lift, lower, and tilt mechanism are all controlled by the clear plastic handle attached to the bottomrail.

With your thumb on the front of the handle and fingers on the back, gently pull down to lower the shading. The hinged handle elegantly retracts when released. Continue pulling on the handle to lower the shadings and open the vanes.

To close the vanes and raise the shades, gently pull down on the handle (about 1") and release. The vanes will close and then the shading will retract into the headrail.



# PRODUCT COMPONENTS – STANDARD

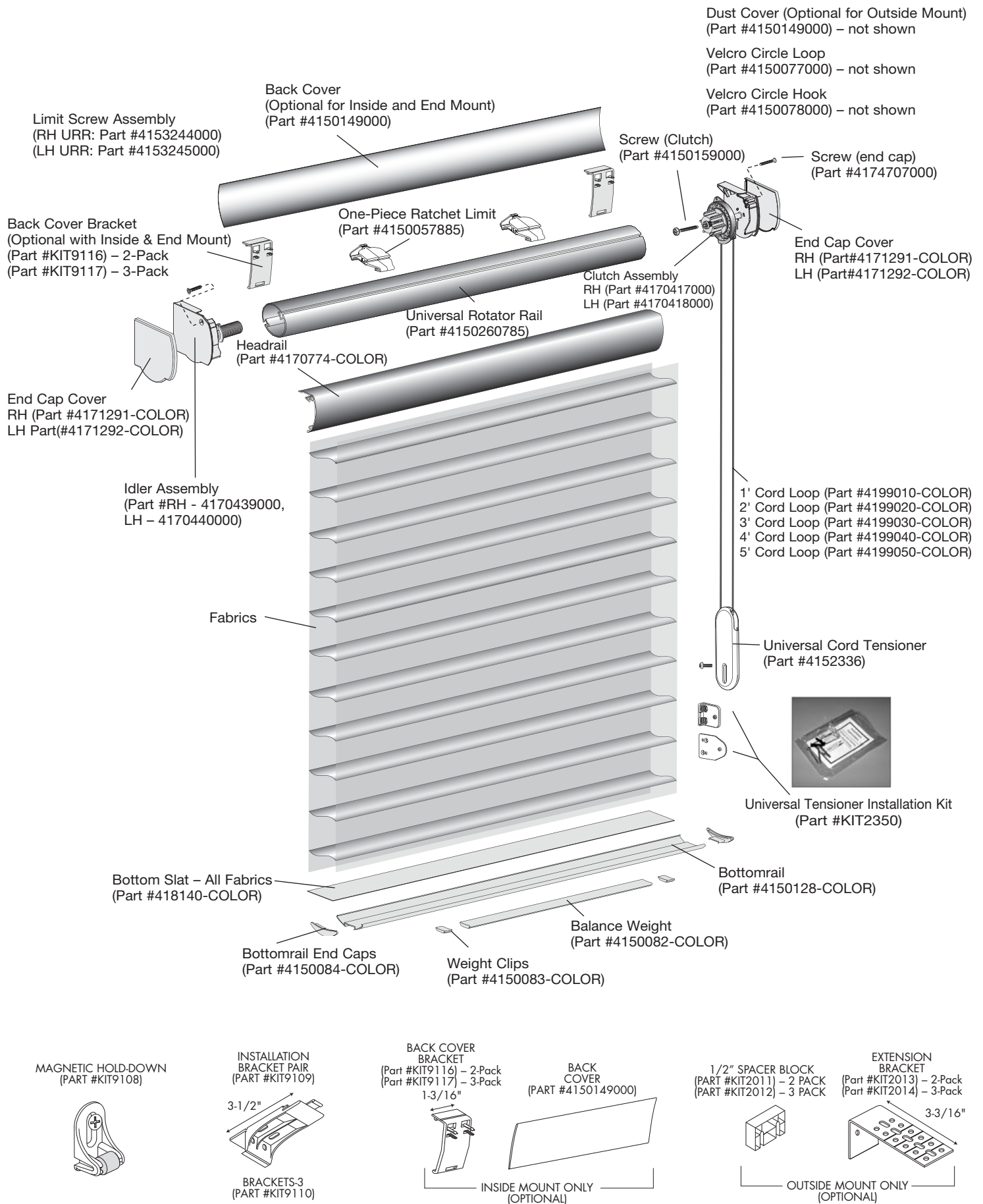

# PRODUCT COMPONENTS – RETRACTABLE CORD

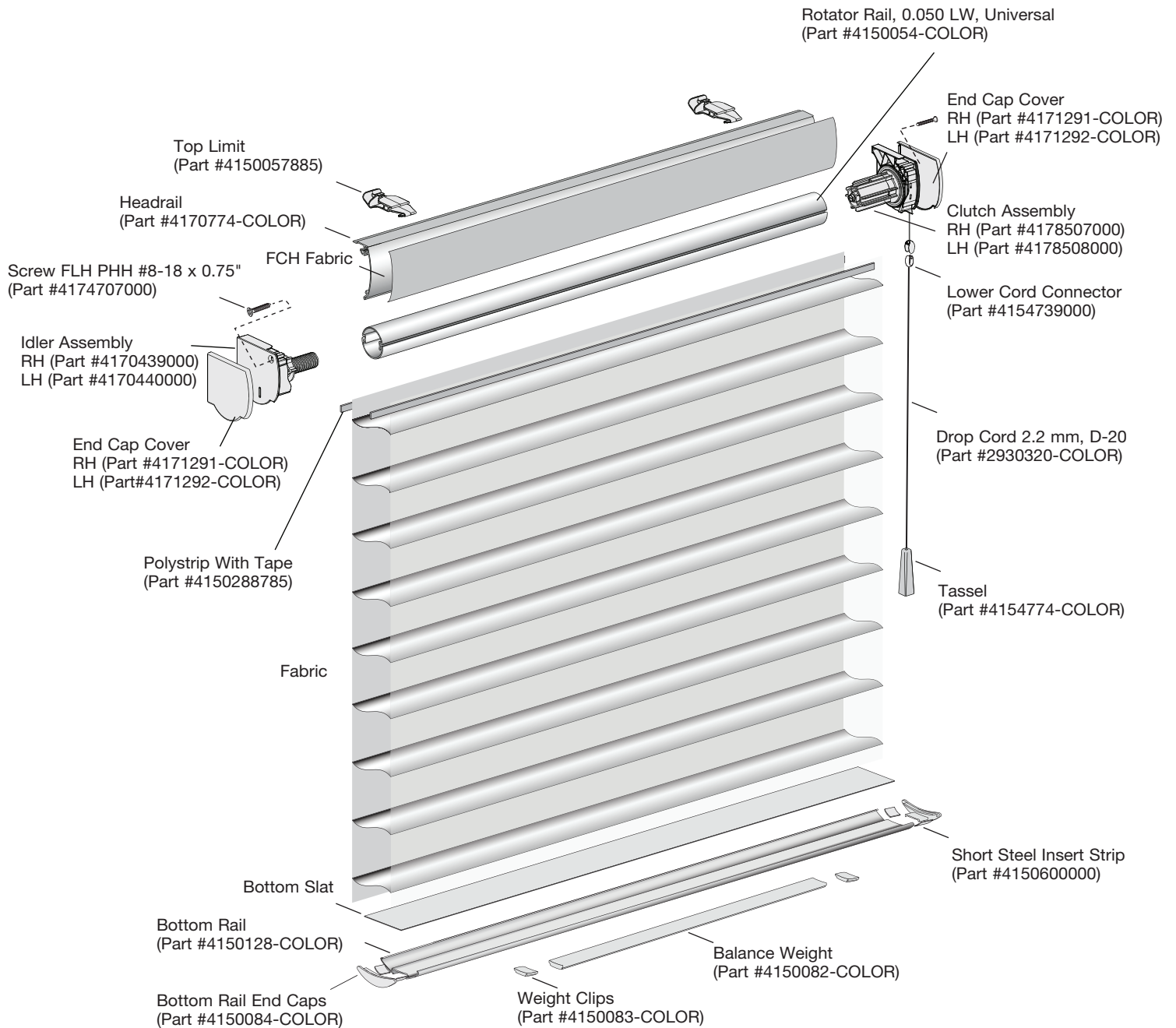

# PRODUCT COMPONENTS – CORDLESS LIFT

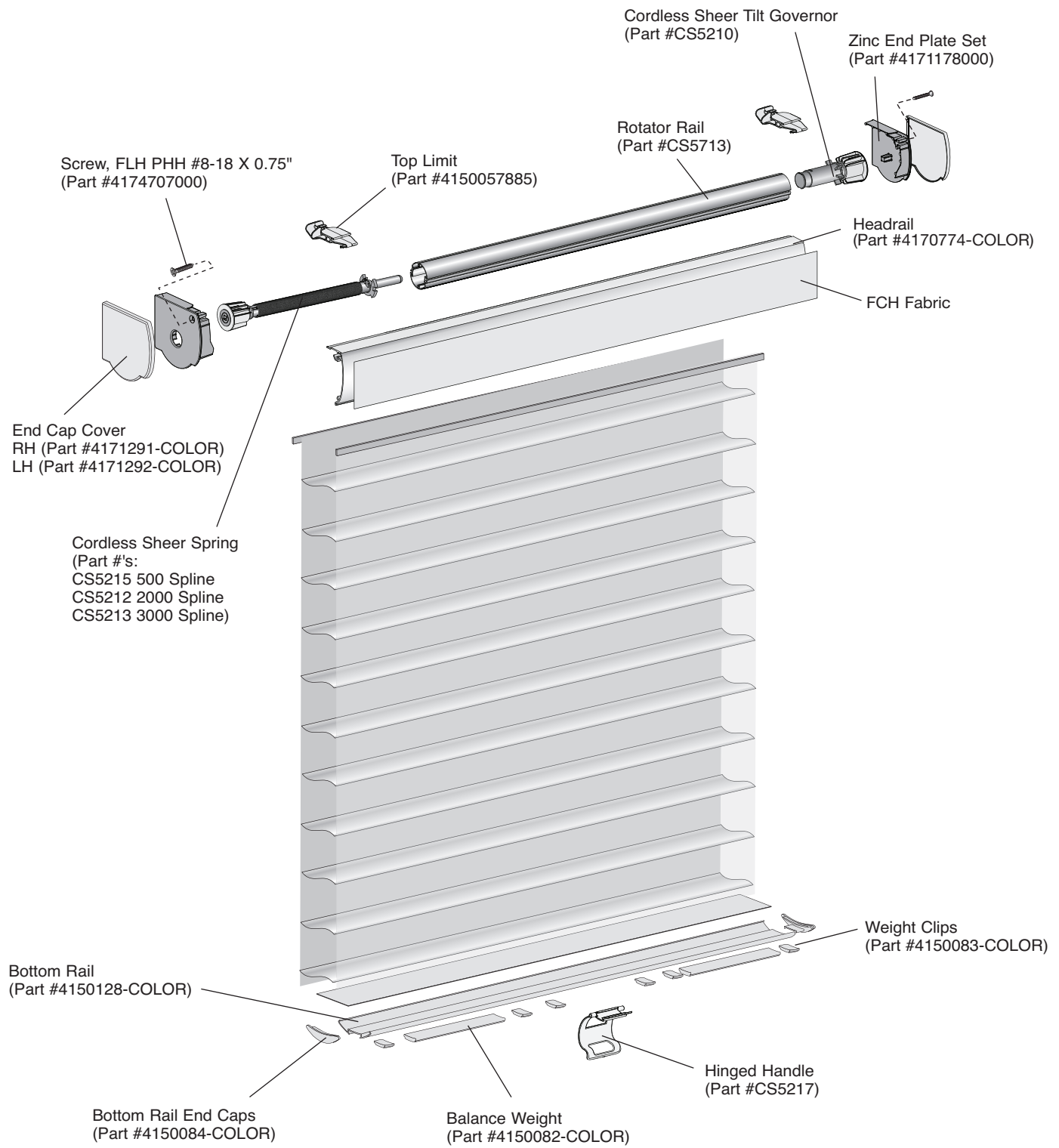

# PRODUCT COMPONENTS – SIMPLICITY RECHARGEABLE MOTORIZATION

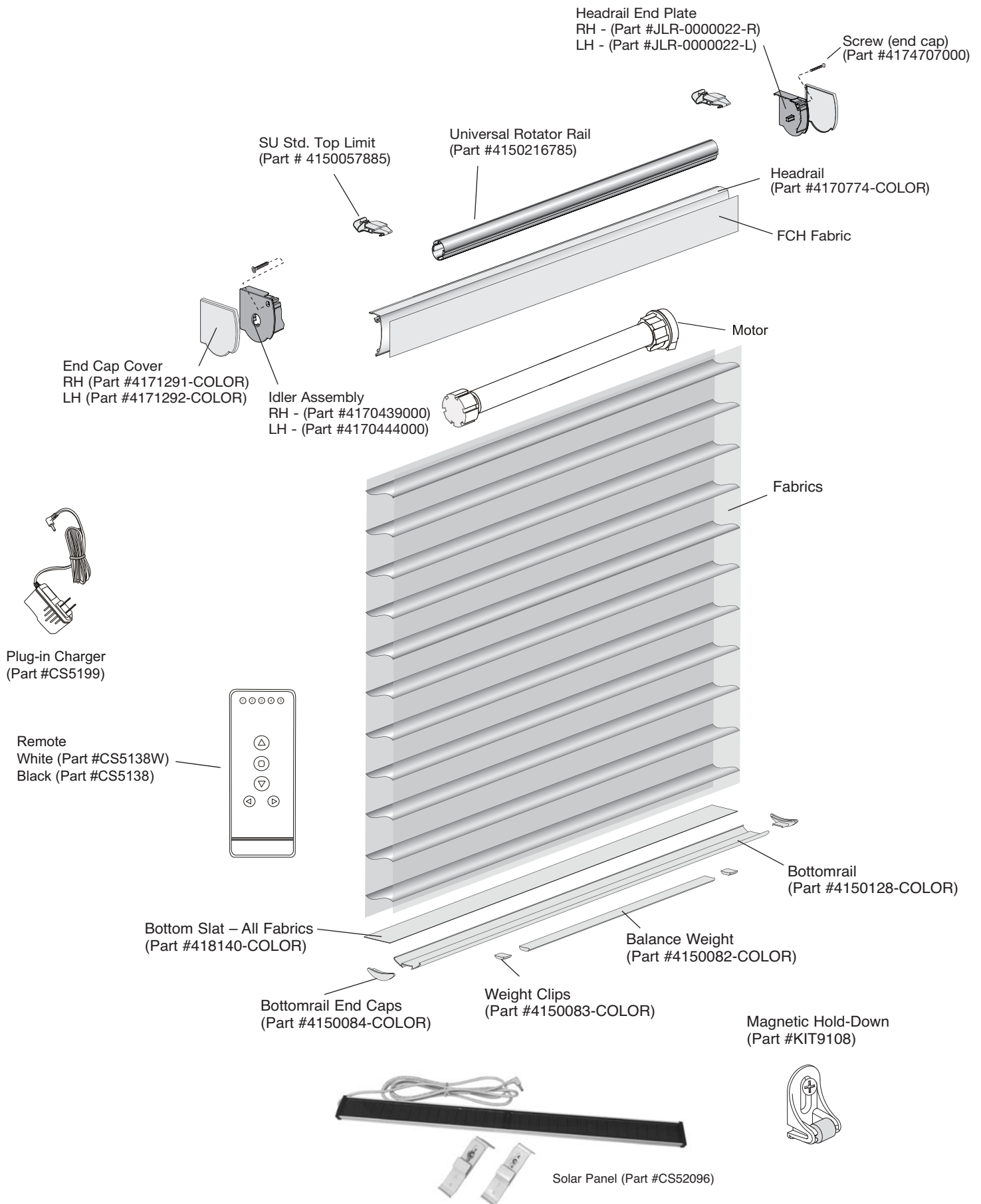



# PRODUCT COMPONENTS – POWERWAND MOTORIZATION

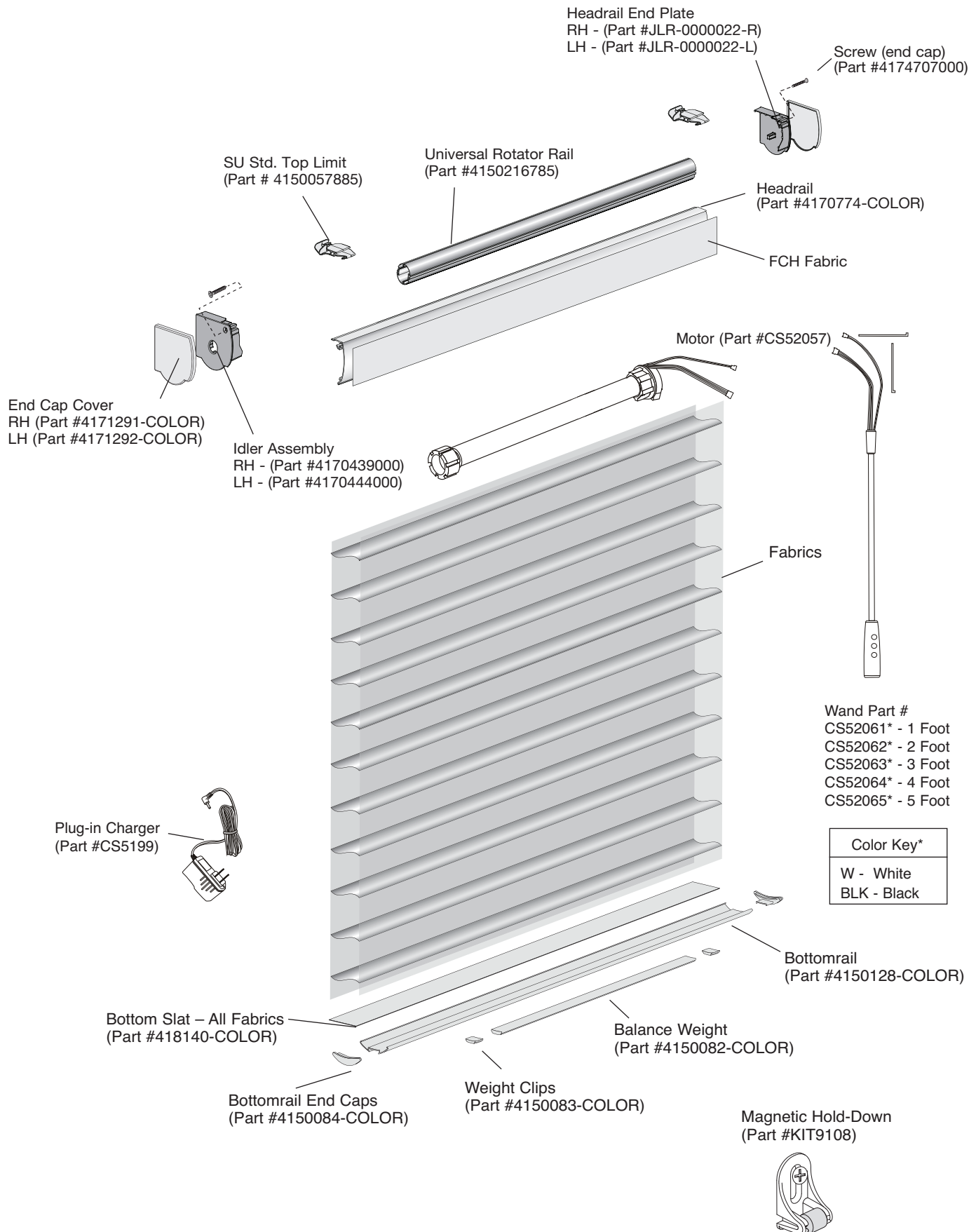

# PRODUCT COMPONENTS – REMOTELIFT™ 2.0

