

GENERAL NOTES

- 1. CONTRACTOR TO INSTALL SPIRAL DUCT IN OPEN AREAS AND TO BE MANUFACTURED IN A QUALIFIED METAL SHOP – SPLIT DUCTS ASSEMBLED ON SITE ARE NOT ALLOWED – USE REGISTERS THAT DISTRIBUTE AIR DIRECTLY FROM THE DUCT, GOOSENECK EXTENSIONS ARE NOT ALLOWED.
- 2. IF RESTROOM WALLS STOP SHORT OF THE EXISTING ROOF DECK, GENERAL CONTRACTOR MUST PROVIDE A GYPSUM BOARD CEILING AT 9'-0" A.F.F. OR HIGHER – SUSPENDED GYPSUM BOARD FRAMING SYSTEMS ARE NOT ALLOWED.
- 3. GENERAL CONTRACTOR TO INSTALL CEILING MOUNTED FIXTURES AS PER ELECTRICAL PLAN – FIELD VERIFY EXISTING CONDITIONS TO ENSURE MOUNTING ELEVATION WILL PROVIDE EVEN DISTRIBUTION OF LIGHTING WITHOUT INTERRUPTION AND SHADOWS FROM EXISTING STRUCTURAL ELEMENTS AND/OR PROPOSED DUCTWORK – COORDINATE AS REQUIRED – MINIMUM ELEVATION OF FIXTURES TO BE 10'-0" ABOVE FINISHED FLOOR.
- 4. PAINT ALL CONDUIT AND MATERIAL TO MATCH CEILING COLOR PRIOR TO INSTALLATION – THROUGHOUT
- 5. PROTECT/RELOCATE EXISTING EMERGENCY EXIT LIGHTING AS REQUIRED – REFER TO ELECTRICAL DRAWINGS
- 6. PAINT ALL EXPOSED CEILING (STRUCTURAL MEMBERS/ PIPES/ DUCTS, ETC) PL-10
- 7. CEILING WITH 'OPEN TO DECK' AREAS – PAINT FROM DECK DOWN WALL 2" BELOW LOWEST POINT – VERIFY WITH CORPORATE PRIOR TO PAINTING
- 8. WHEN A SPRINKLER SYSTEM IS PROVIDED, THE SPRINKLER HEADS SHALL BE CENTERED IN THE LAY-IN CEILING TILE, TYP.

REF. CEILING PLAN LEGEND

- 1 NEW 2'X2' SUSPENDED ACOUSTIC CEILING TILE
- 2 FEATURE WALL ASSEMBLY TO EXTEND TO UNDERSIDE OF EXISTING BAR JOIST
- 3 ANYTIME FITNESS BRANDED WALL – REFER TO SHEET A2.0
- 4 CENTER LIGHT ABOVE SHOWER AS SHOWN ON PLAN
- 5 CENTER LIGHT FIXTURE W/IN ROOM AS SHOWN ON PLAN
- 6 COMPASSO TRIM TO CONTINUE AT BACK OF RETAIL LOGO WALL
- 7 NEW CEILING GRID TO BE CENTERED IN ROOM AS SHOWN ON PLAN
- 8 NEW CEILING GRID START POINT

CEILING PLAN SYMBOLS

- 8'-0" TRACK W/4 L.E.D. HEADS, WHITE
- 2' X 2' L.E.D. FIXTURE
- 2 1/2" X 8' L.E.D. FIXTURE
- HAMPTON BAY INDUSTRIAL FAN – 60" MODEL #52860
- TROPOS AIR TITAN – 84" MODEL #88252+88282
- 7-5/8" X 48" SUSPENDED L.E.D. FIXTURE
- 7-5/8" X 48" CEILING-MOUNTED L.E.D. FIXTURE
- RECESSED L.E.D. DOWN LIGHT (DAMP RATED IN SHOWER)
- TELEVISION

ELECTRICAL NOTES

- 1. CONTRACTOR TO INSTALL OWNER SUPPLIED EMERGENCY 911 PHONE, INCLUDING CONNECTION TO LV/TELECOMMUNICATIONS SYSTEM AND/OR DEMARCATION POINT. VERIFY LOCATION WITH OWNER.
- 2. CONTRACTOR TO PROVIDE WIRING/CONNECTION FOR CABLE TELEVISION, TELEPHONE, AND DATA FROM THE DEMARCATION POINT(S) OF ORIGIN TO THE POINT(S) OF USE/TERMINATION. THIS INCLUDES, BUT IS NOT LIMITED TO, TELEPHONES AND COMPUTERS IN THE OFFICES, AND, IF APPLICABLE, THE "FITNESS ON REQUEST" SYSTEM. REFER TO ELECTRICAL DRAWINGS.
- 3. ALL TREADMILLS TO BE ON DEDICATED CIRCUITS, AND SHOWN AS THUS ON THE PANEL SCHEDULE. REFER TO ELECTRICAL DRAWINGS.
- 4. CEILING FAN CONTROLS NEED TO BE EITHER REMOTE CONTROLLED OR WIRED BACK TO A BREAKER AND ROOM SPECIFIC WALL SWITCH SO THEY CAN BE TURNED OFF FOR CLEANING.

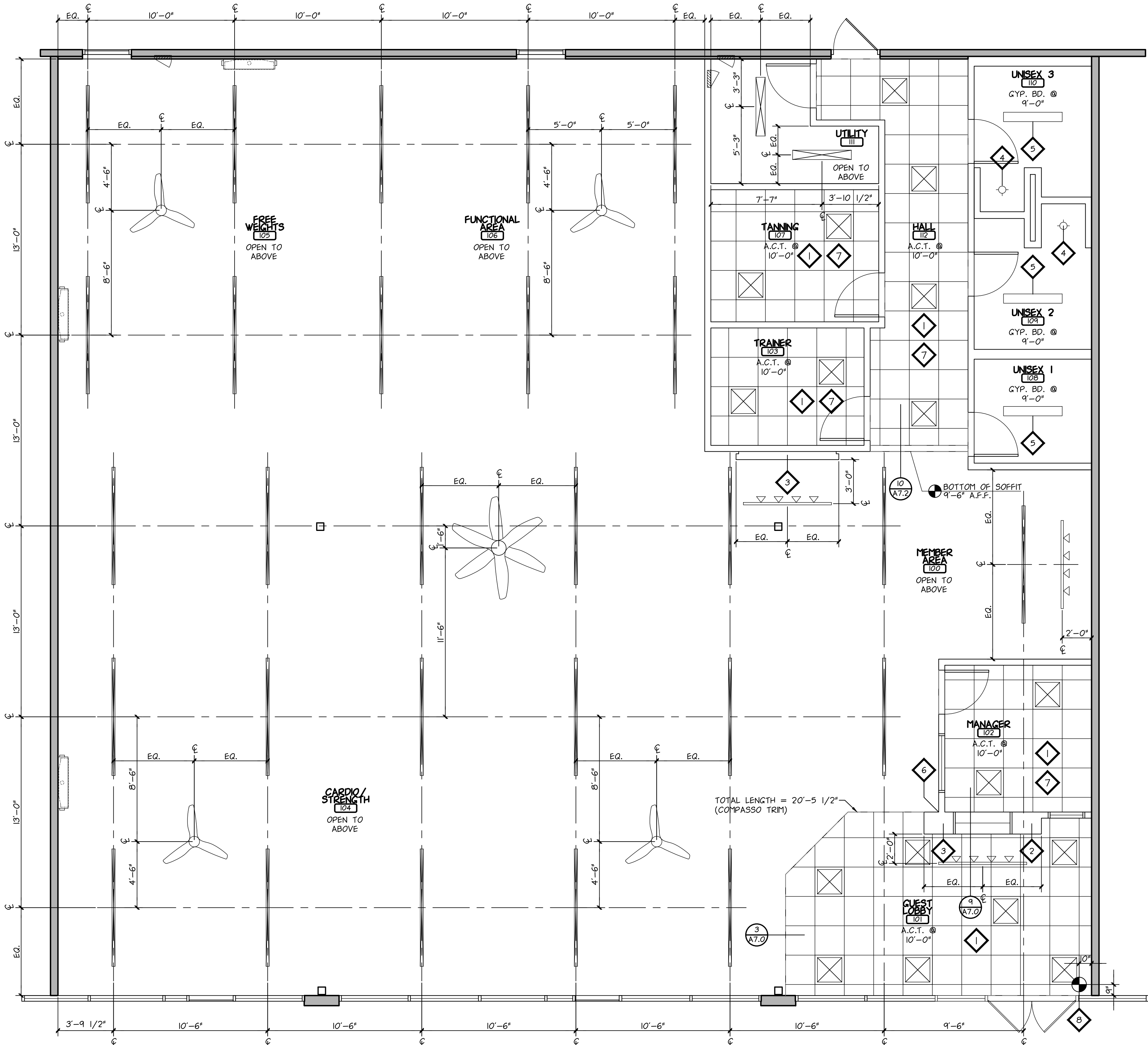

1  
A3.0

CEILING PLAN

1/4" = 1'-0"

© COPYRIGHT MICHAEL J. WILKUS ARCHITECT

CONSULTANT:



15 Ninth Avenue North, Hopkins, MN 55343  
Phone: 952.941.8860 / www.wilkusarch.com

CLIENT:



ANYTIME FITNESS, LLC  
12181 MARGO AVE SOUTH  
HASTINGS, MN 55033  
PHONE: (651) 438-5000

PROJECT INFORMATION:

**ANYTIME FITNESS**  
CROSS CREEK CENTER  
3601 W MAIN ST, SUITE 145  
DURANT, OK 74701

SEAL:

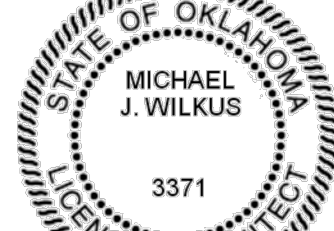

MICHAEL J. WILKUS, ARCHITECT  
LICENSE NUMBER: A3371  
EXPIRATION DATE: 06-30-17  
FIRM NUMBER: 2312339996  
EXPIRATION DATE: 06-30-17  
03-09-16  
DATE

PROJECT NO.: 2016-0166

DRAWN BY: DAA  
CHECKED BY: KMB

ISSUE: DATE:  
PERMIT SET 03-09-16

REVISION: DATE:

1	
2	
3	
4	
5	
6	
7	
8	
9	
10	

PROJECT LOCATION:

DURANT, OK

SHEET NUMBER / TITLE:

A3.0

CEILING PLAN