

# THE MICHAEL



ALABAMA BETTER BUILT HOMES, INC.  
 2203 HOWARD MURFEE BLVD.  
 PRATTVILLE, AL 36066  
 334-285-6380

\$  
 Subject To Change  
 Date: 1/2019  
 Initials: S.T.

2359 SQ FT LIVING  
 36 SQ FT PORCH  
 2395 SQ FT TOTAL

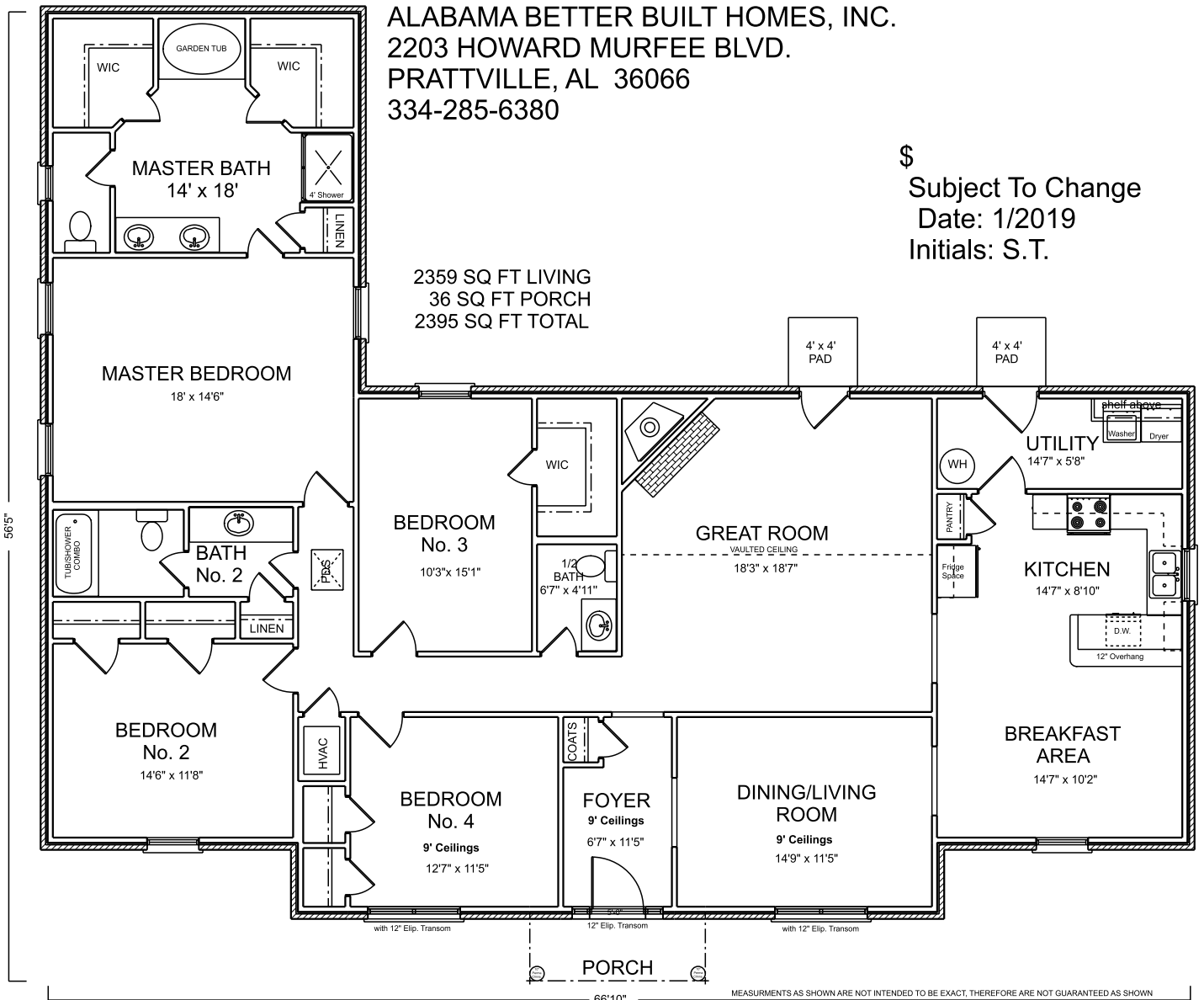

MEASUREMENTS AS SHOWN ARE NOT INTENDED TO BE EXACT, THEREFORE ARE NOT GUARANTEED AS SHOWN