

**PEARBLOSSOM SQUARE: 13120-B  
PEARBLOSSOM HIGHWAY  
FIRE DAMAGE RESTORATION FLOOR PLAN**

SCALE: 1" = 1/4"

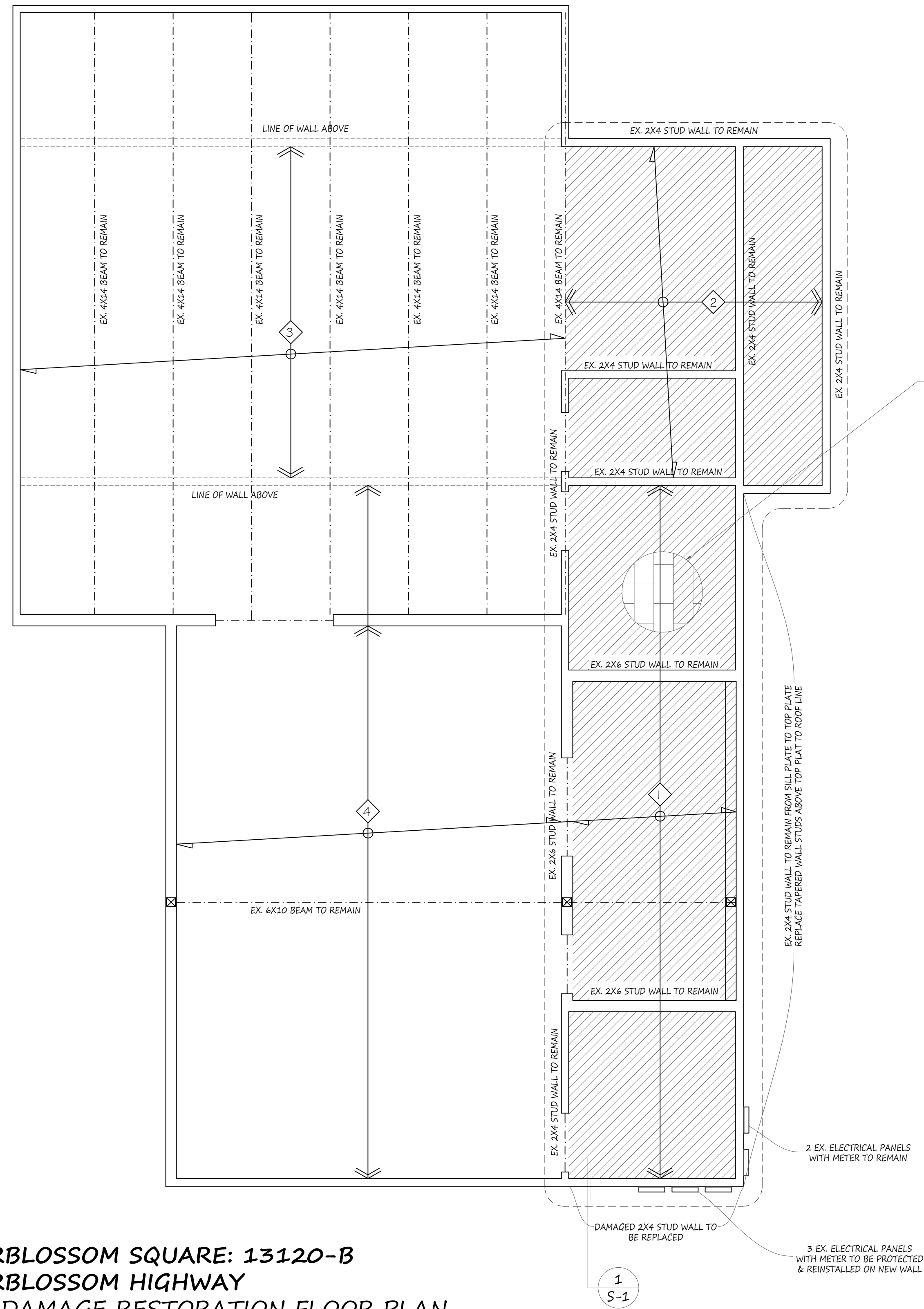

**IMPORTANT NOTICE**

NO DAMAGE WAS FOUND ON ALL FOUNDATION & CONCRETE SLAB.  
NO DAMAGE WAS OBSERVED IN SHEAR WALLS.  
NO CHANGES TO ALL LATERAL LOAD RESISTING SYSTEM.

REPLACE EX. DAMAGED PLYWOOD ROOF SHEATHING WITH 1/2" PLYWOOD CDX PANEL INDEX  $\frac{3}{8}$  WITH RADIANT BARRIER W 8d @ 6" O.C BOUNDARY & 12" O.C. FIELD

EX. 2X4 STUD WALL TO REMAIN FROM SILL PLATE TO TOP PLATE  
REPLACE DAMAGED WALL STUDS ABOVE TOP PLATE TO ROOF LINE

2 EX. ELECTRICAL PANELS WITH METER TO REMAIN

3 EX. ELECTRICAL PANELS WITH METER TO BE PROTECTED & REINSTALLED ON NEW WALL

1  
S-1

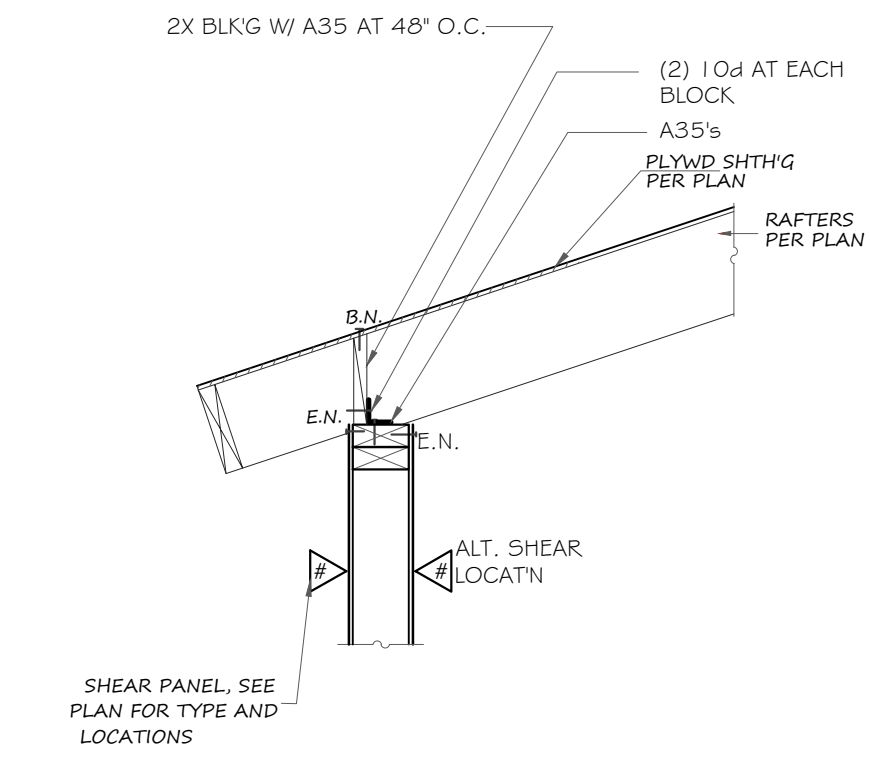

**DETAIL 1**  
**RAFTERS TO WALL CONNECTION**

**FRAMING LEGEND**

- |  |  |
|--|--|
|  | EX. DAMAGED 2 x 8 @ 24\" O.C. ROOF RAFTERS TO BE REPLACED BY 2x8 @ 24\" O.C. DFL#2 |
|  | EX. DAMAGED 2 x 6 @ 24\" O.C. ROOF RAFTERS TO BE REPLACED BY 2x6 @ 24\" O.C. DFL#2 |
|  | EX. 2 x ROOF RAFTERS @ 24\" O.C. TO REMAIN   |
|  | EX. 2x ROOF RAFTERS @ 24\" O.C. TO REMAIN  |

**MATERIAL SPECIFICATIONS:**

- DOUGLAS FIR-LARCH FRAMING WOOD: "DOC P5 20-05"
- WOOD STRUCTURAL PANELS: "DOC P9 1-07 OR DOC P5 2-04"
- NUMBER & SIZE OF WOOD FASTENERS SHALL NOT BE LESS THAN THAT SET FORTH IN R602.3 (1) THROUGH R602.3 (4).
- STRUCTURAL CONCRETE STRENGTH SHALL BE MINIMUM 2500 PSI

**EXISTING STRUCTURE NOTE:**

- ALL WORK SHALL BE IN ACCORDANCE WITH THE 2016 C.B.C. AND/OR LOCAL BUILDING CODES.
- CONTRACTOR SHALL CHECK ALL EXISTING STRUCTURAL WOOD MEMBERS (RAFTERS, JOIST, STUDS, BEAMS, POSTS, STRINGERS, ETC.). REMOVE ALL DETERIORATING WOOD MEMBERS AND REPLACE THEM WITH THE SAME OR BETTER SECTION PROPERTIES AND USING STRUCTURAL 1 GRADE LUMBER.
- ALL EXISTING FOOTINGS TO BE USED ONLY UNDER THE FOLLOWING CONDITION:  
THE EXISTING FOOTING HAS THE SAME SECTION AS THAT OF THE REQUIRED NEW FOOTING.
- IF (E) CONT. FTG DOES NOT OCCUR AS SHOWN ON PLAN, THEN UNDERPIN THE FTG S TO MATCH THE PROPOSED SECTION.

**IMPORTANT NOTICE**

DUE TO NATURE OF THIS JOB, THE DESIGN HAS BEEN ACHIEVED ACCORDING TO AVAILABLE INFORMATION. ANY DISCREPANCIES MUST BE REPORTED TO THE ENGINEER OF RECORD. (CONTRACTOR TO VERIFY)

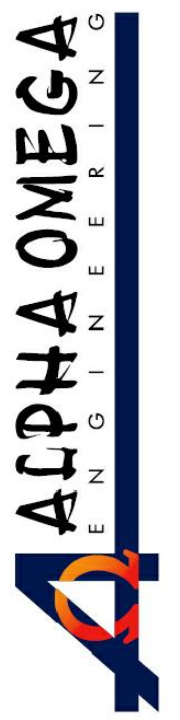

12940 EXCALIBUR DR. CORONA, CA 92880  
T: (909) 348-7295 FAX: (909) 348-7669  
e-mail: alomega@verizon.net

**PROJECT:**  
FIRE DAMAGE RESTORATION

**OWNER:**  
MR. PETER THOTTAM

**PROJECT LOCATION:**  
1.3120B PEARBLOSSOM HWY (1.3120-SUITE B PEARBLOSSOM, CA)

STAMP



REVISIONS

DATE: 11/05/17  
SCALE: 1" = 1/4"  
FILE NAME:  
PROJECT NUMBER:  
PROJECT MANAGER:  
DRAWN BY:

SHEET NUMBER

S-1

SHEET TITLE  
**STRUCTURAL RESTORATION PLAN**