

# Ashland

P U M P



Pumps for Municipal and Commercial Operations

# Ashland Pump

The Ashland Pump Company designs, manufactures, and distributes an extensive line of durable, dependable products for use in the Plumbing, Onsite Septic, Commercial, Industrial and Light Municipal markets. Ashland Pump manufactures a complete line of Grinder and Solids Handling pumps up to 20 HP along with a complete line of accessories. All of our products are manufactured in a CSA/CUS approved ISO9000 facility.

Ashland Pump products feature heavy-duty cast iron construction, professional duty ball bearing design and high efficiency, low amp draw continuous duty rated motors. The Ashland Pump offices and distribution facility are centrally located in Ashland, Ohio. The 130,000 sq. ft. facility includes offices, a state of the art test lab, assembly and distribution under one roof.



## State of the art test lab

- 1,800 square feet
- 17,000 Gallon test pit
- 2 ton free standing overhead crane
- Production and R&D functionality
- Certified and witness testing capabilities
- 100% production testing on 2HP and above
- Sized for future build-out to include 12"+ pumps
- Based on Hydraulic Institute standards



# Outstanding Construction

## HEAVY DUTY CAST IRON

rugged design, great heat dissipation

## OIL-FILLED CONTINUOUS DUTY MOTORS

higher efficiency, lower amp draw, long life

## DOUBLE BALL BEARING DESIGN

double row, angular contact lower bearing, low maintenance, longer mean time between repairs, handles radial and thrust loading

## APPLICATION SPECIFIC IMPELLERS

thermoplastic, brass and cast iron variations, vortex impellers reduce pump clogging, two-plane enclosed impellers provide better efficiency while remaining clog free, replaceable wear rings to restore original performance



## Sewage Pumps



## Grinder Pumps



## Solids Handling Pumps



# SEWAGE PUMPS

## Cast Iron Sewage Pump Models: SWF100 and SWF200

### Features

- Heavy duty cast iron construction
- Oil-filled continuous duty PSC motor (1Ph) and Induction motor (3Ph)
- Semi-open cast iron impeller
- 2" solids handling

### Specifications

#### Physical Data:

DISCHARGE SIZE	2" Flanged with 2" & 3" NPT Adapter
IMPELLER TYPE	Vortex - Cast Iron
CABLE LENGTH	20'

#### Liquid Handling:

SOLIDS SIZE	2"
MAXIMUM LIQUID TEMP.	104°F - Intermittent
ACCEPTABLE PH RANGE	6-8

#### Technical Data:

MOTOR HOUSING	Cast Iron
CASING	Cast Iron
IMPELLER	Cast Iron
MOTOR SHAFT	SS430
HARDWARE	SST
"O" RINGS	NBR
SEALS	Single Mechanical, Carbon Ceramic
UPPER BEARING	6203
LOWER BEARING	6203

#### Electrical Data:

R.P.M.	1750
MOTOR TYPE	PSC/Induction
GEN INSULATION CLASS	B
STATOR WINDING CLASS	B
MAXIMUM STATOR TEMP	130°C
VOLTAGE TOLERANCE	±10%
MOTOR PROTECTION	Thermally Protected
HP	1 (SWF100) and 2 (SWF200)
VOLTAGE	208/230/460
PHASE	1/3
SERVICE FACTOR	1

#### Dimensions:

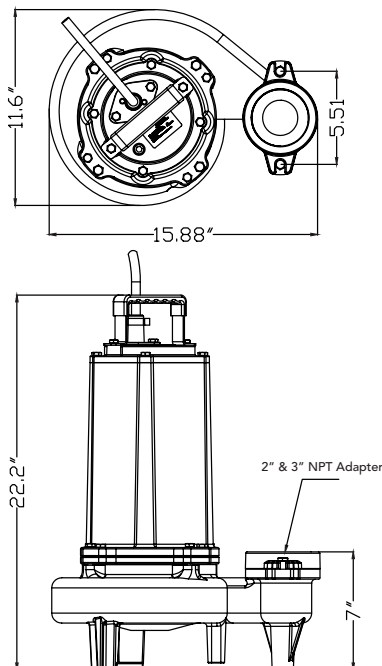

Performance Curve

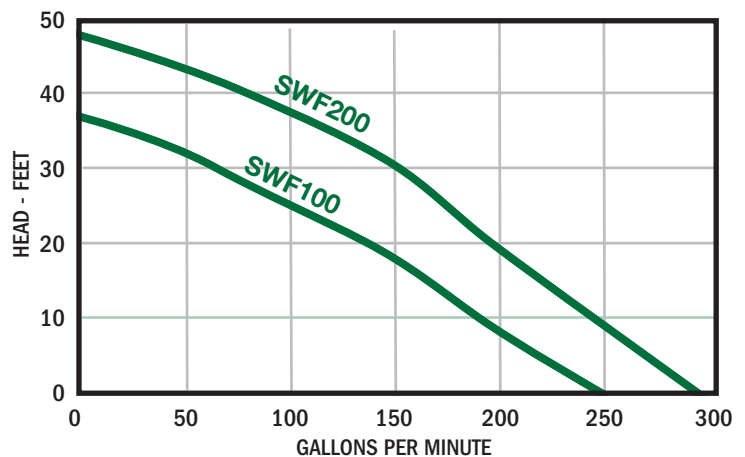

# SWF100 and SWF200 FEATURES

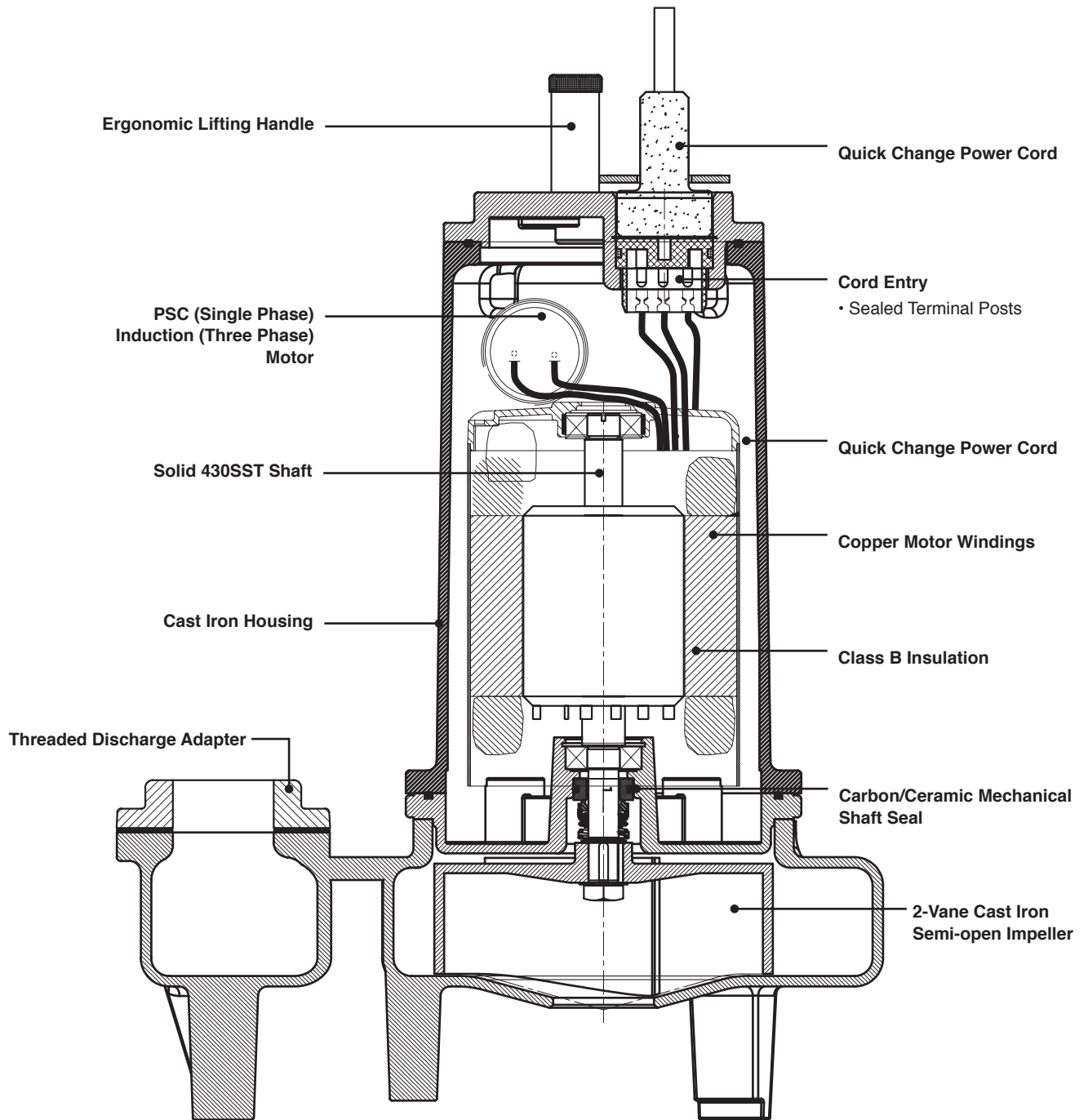

## Specifications

Model	HP	Hz	Volts/Ph	RPM	Full Load Amps	Nema Start Code	Cord Type	Cord Power Size	Cord O.D.
SWF100M2-20	1	60	230/1	1750	10.8	P	SOW	14AWG/3C	.55
SWF100M3-20	1	60	230/3	1750	8.0	P	SOW	16AWG/4C	.45
SWF100M4-20	1	60	460/3	1750	4.0	P	SOW	16AWG/4C	.45
SWF100M6-20	1	60	208/3	1750	8.5	P	SOW	16AWG/4C	.45
SWF200M2-20	2	60	230/1	1750	16.7	K	SOW	12AWG/3C	.62
SWF200M3-20	2	60	230/3	1750	11.0	L	SOW	14AWG/4C	.59
SWF200M4-20	2	60	460/3	1750	5.5	L	SOW	14AWG/4C	.59
SWF200M6-20	2	60	208/3	1750	11.5	L	SOW	14AWG/4C	.59

# SEWAGE PUMPS

Cast Iron Sewage Pump Models: SWH50, SWH100, SWH150 and SWH200

## Features

- Heavy duty cast iron construction
- Oil-filled continuous duty PSC motor (1Ph) and Induction motor (3Ph)
- Vortex cast iron impeller
- 3" Flanged discharge, 2" NPT adapter
- 2" solids handling

## Specifications

Physical Data:	
DISCHARGE SIZE	2" Flanged with 2" & 3" NPT Adapter
IMPELLER TYPE	Vortex - Cast Iron
CABLE LENGTH	20'
Liquid Handling:	
SOLIDS SIZE	2"
MAXIMUM LIQUID TEMP.	104°F - Intermittent
ACCEPTABLE PH RANGE	6-8 PH
Temperature:	
MAXIMUM STATOR	130°C
Technical Data:	
MOTOR HOUSING	Cast Iron
CASING	Cast Iron
IMPELLER	Cast Iron
MOTOR SHAFT	SS430
HARDWARE	SST
"O" RINGS	NBR
SEALS	Single Mechanical, Carbon Ceramic
UPPER BEARING	6203
LOWER BEARING	6203
Electrical Data:	
R.P.M.	3450
MOTOR TYPE	PSC/Induction
GEN INSULATION CLASS	B
STATOR WINDING CLASS	B
MAXIMUM STATOR TEMP	130°C
VOLTAGE TOLERANCE	±10%
MOTOR PROTECTION	Thermally Protected
HP	1/2 (SWH50) 1 (SWH100) 1-1/2 (SWH150) 2 (SWH200)
VOLTAGE	208/230/460
PHASE	1/3
SERVICE FACTOR	1
Dimensions:	

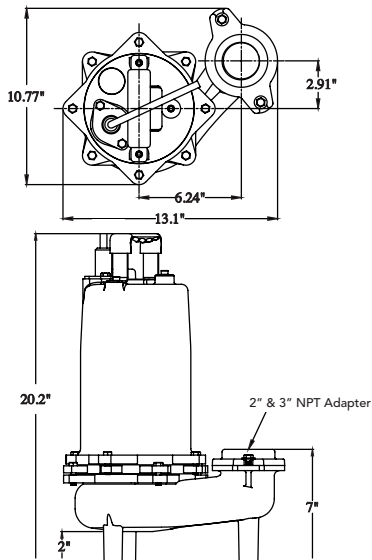

Performance Curve

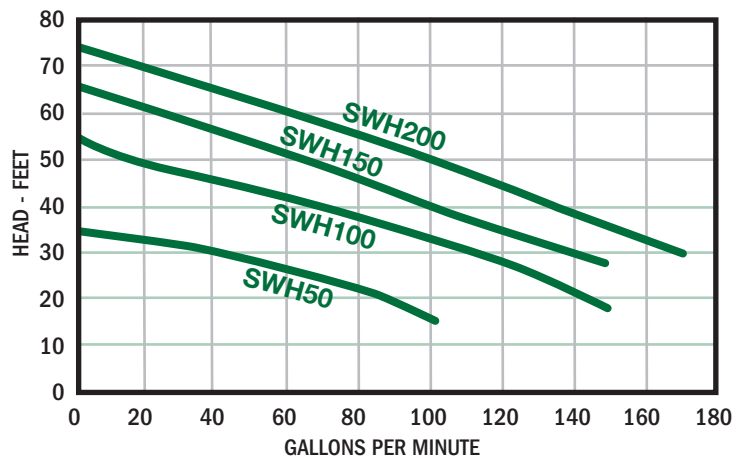

# SWH50, SWH100, SWH150 and SWH200 FEATURES

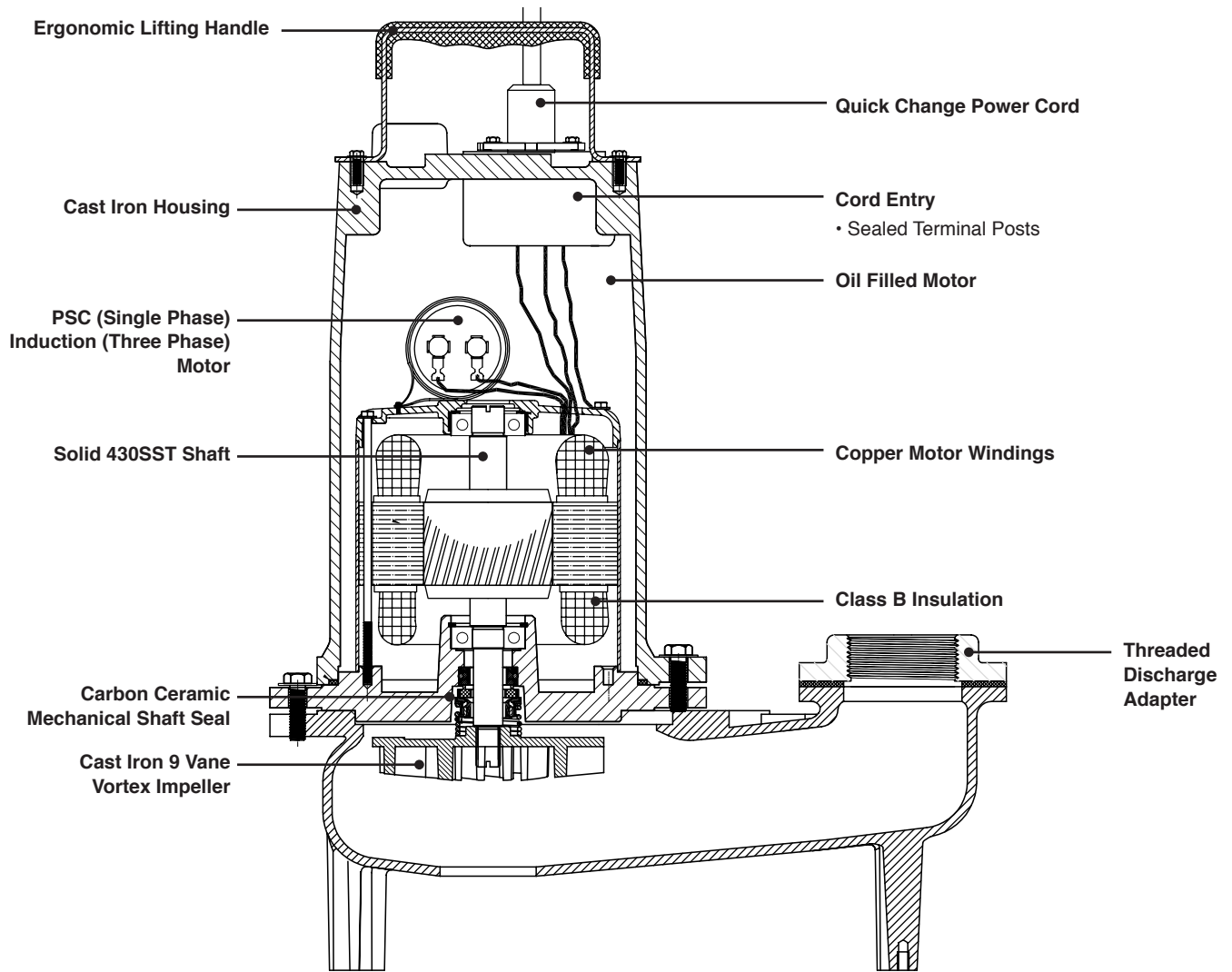

## Specifications

Model	HP	Hz	Volts/Ph	RPM	Full Load Amps	Cord Type	Cord Power Size	Cord O.D.
SWH50M1-20	1/2	60	115/1	3450	12.0	SOW	16AWG/3C	.430
SWH50M2-20	1/2	60	230/1	3450	6.0	SOW	16AWG/3C	.430
SWH50M3-20	1/2	60	230/3	3450	4	SOW	16AWG/4C	.460
SWH50M4-20	1/2	60	460/3	3450	2	SOW	16AWG/4C	.460
SWH50M5-20	1/2	60	208/1	3450	6.8	SOW	16AWG/3C	.430
SWH50M6-20	1/2	60	208/3	3450	4.2	SOW	16AWG/4C	.460
SWH100M2-20	1	60	230/1	3450	11	SOW	16AWG/3C	.430
SWH100M3-20	1	60	230/3	3450	6.6	SOW	16AWG/4C	.460
SWH100M4-20	1	60	460/3	3450	3.3	SOW	16AWG/4C	.460
SWH100M5-20	1	60	208/1	3450	12	SOW	16AWG/3C	.430
SWH100M6-20	1	60	208/3	3450	6.8	SOW	16AWG/4C	.460
SWH150M2-20	1-1/2	60	230/1	3450	13.8	SOW	14AWG/3C	.575
SWH150M3-20	1-1/2	60	230/3	3450	7.6	SOW	16AWG/4C	.460
SWH150M4-20	1-1/2	60	460/3	3450	3.8	SOW	16AWG/4C	.460
SWH150M5-20	1-1/2	60	208/1	3450	15	SOW	14AWG/3C	.575
SWH150M6-20	1-1/2	60	208/3	3450	7.8	SOW	16AWG/4C	.460
SWH200M2-20	2	60	230/1	3450	18	SOW	14AWG/3C	.575
SWH200M3-20	2	60	230/3	3450	9	SOW	16AWG/4C	.460
SWH200M4-20	2	60	460/3	3450	4.5	SOW	16AWG/4C	.460
SWH200M5-20	2	60	208/1	3450	20	SOW	12AWG/3C	.655
SWH200M6-20	2	60	208/3	3450	10.4	SOW	16AWG/4C	.460

# SEWAGE PUMPS

## Cast Iron Sewage Pump Models: SW300 and SW500

### Features

- Heavy duty cast iron construction
- Oil-filled continuous duty PSC motor (1Ph) and Induction motor (3Ph)
- Cast iron 2-vane semi-open impeller, 2-1/2" solids handling (SW300), 3" (SW500)

### Specifications

Physical Data:	
DISCHARGE SIZE	3" NPT
IMPELLER TYPE	2-Vane, Semi-open - Cast Iron
CABLE LENGTH	20'
Liquid Handling:	
SOLIDS SIZE	2-1/2" (SW300), 3" (SW500)
MAXIMUM LIQUID TEMP.	104°F - Intermittent
ACCEPTABLE PH RANGE	6-8 PH
Temperature:	
MAXIMUM STATOR	130°C
Technical Data:	
MOTOR HOUSING	Cast Iron
CASING	Cast Iron
IMPELLER	Cast Iron
MOTOR SHAFT	SS430
HARDWARE	SST
"O" RINGS	NBR
SEALS	Mechanical, Carbon Ceramic
UPPER BEARING	6203
LOWER BEARING	6206
Electrical Data:	
R.P.M.	1750
MOTOR TYPE	PSC (1Ph) and Induction (3Ph)
GEN INSULATION CLASS	B
STATOR WINDING CLASS	B
MAXIMUM STATOR TEMP	130°C
VOLTAGE TOLERANCE	±10%
MOTOR PROTECTION	N/A
HP	3 (SW300) 5 (SW500)
VOLTAGE	208, 230, 460
PHASE	1/3
SERVICE FACTOR	1
Dimensions:	

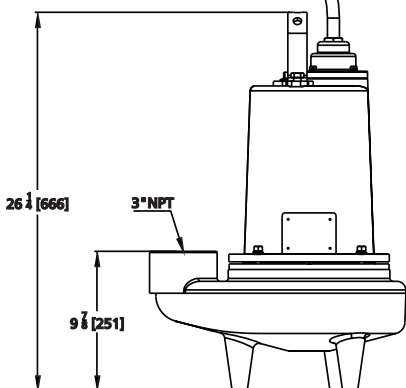
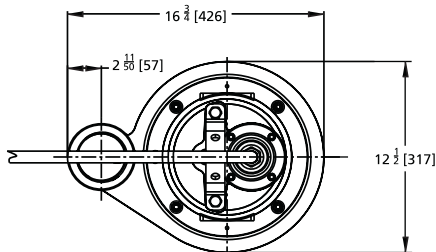

Performance Curve

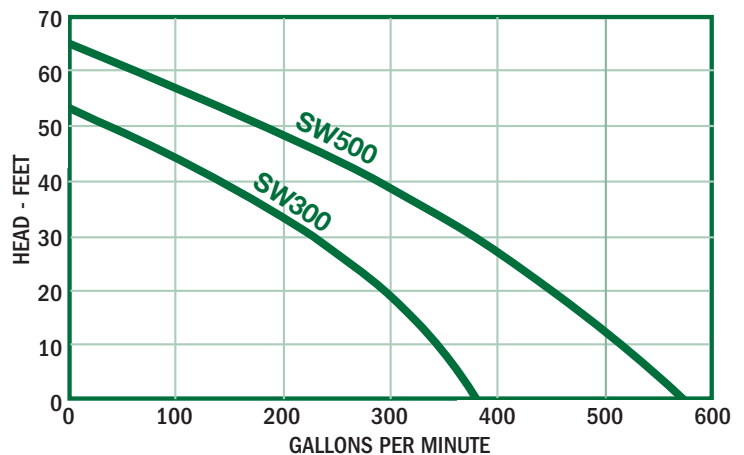



# SW300 and SW500 FEATURES

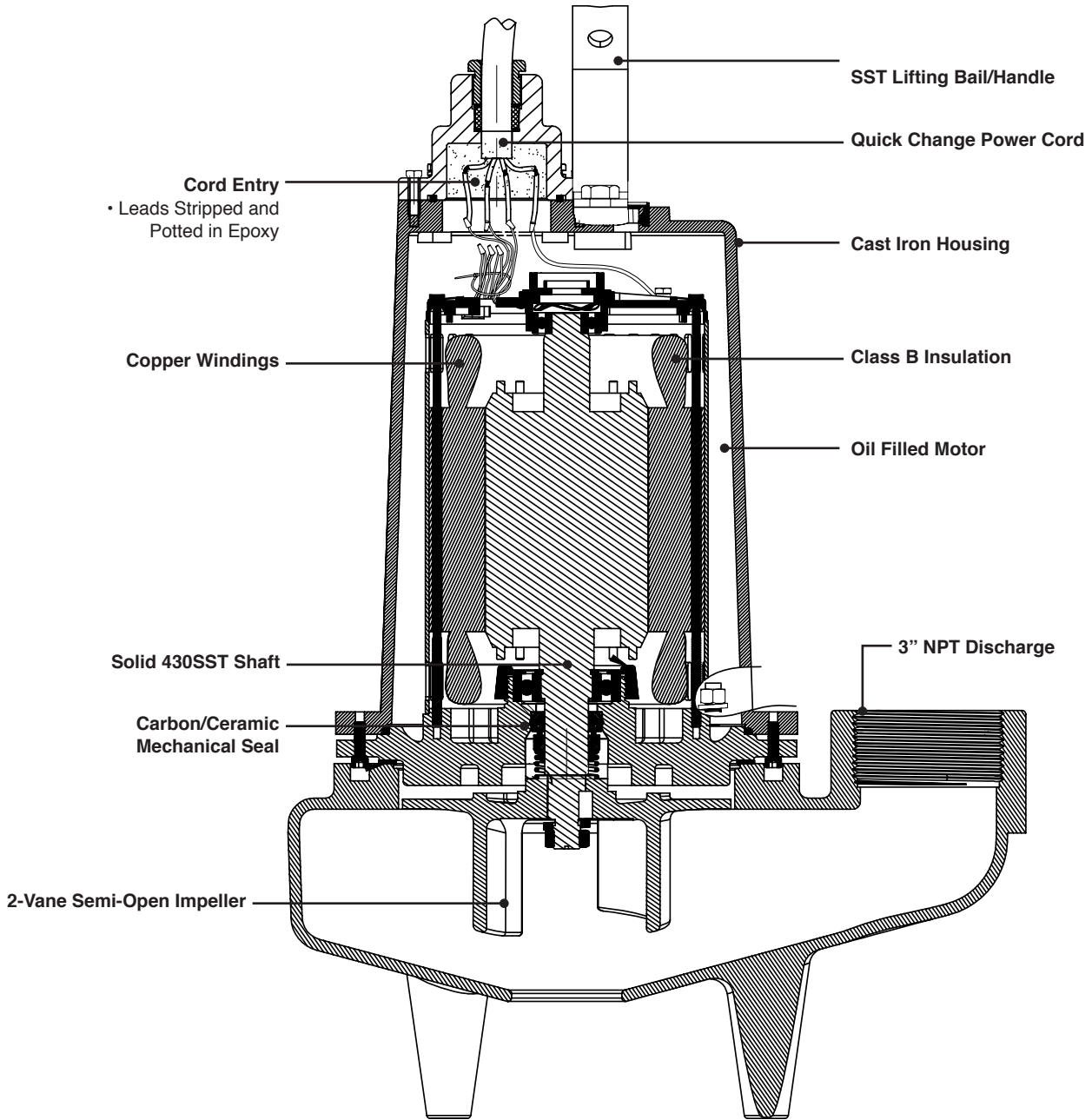

## Specifications

Model	Hp	Hz	Volts/Ph	Rpm	Full Load Amps	Nema Start Code	Cord Type	Power Cord Size	Cord O.D.
SW300M2-20	3	60	230/1	1750	28	D	SOW	8AWG/4C	1.0
SW300M3-20	3	60	230/3	1750	20	D	SOW	12AWG/4C	.7
SW300M4-20	3	60	460/3	1750	10	D	SOW	12AWG/4C	.7
SW300M5-20	3	60	208/1	1750	33.5	D	SOW	8AWG/4C	1.0
SW300M6-20	3	60	208/3	1750	18	D	SOW	12AWG/4C	.7
SW500M2-20	5	60	230/1	1750	45.6	D	SOW	6AWG/4C	1.2
SW500M3-20	5	60	230/3	1750	23.6	D	SOW	12AWG/4C	.7
SW500M4-20	5	60	460/3	1750	11.8	D	SOW	12AWG/4C	.7
SW500M5-20	5	60	208/1	1750	46	D	SOW	6AWG/4C	1.2
SW500M6-20	5	60	208/3	1750	24	D	SOW	12AWG/4C	.7

# GRINDER PUMPS

## Cast Iron Grinder Pump Model: AGP-HC200

### Features

- Heavy duty cast iron construction
- Dual mechanical silicon carbide seals
- Brass, 10 vane vortex impeller
- Quick change power cords
- Viton o-rings
- Double Row Angular contact lower bearing
- Seal leak detection
- 440C SS Hybrid Cutting System
- Vertical or horizontal discharge

### Specifications

#### Physical Data:

DISCHARGE SIZE	1-1/4" NPT + Flanged Horizontal w/Vertical Adapter
IMPELLER TYPE	10-Vane, Open- Brass
CABLE LENGTH	35'

#### Liquid Handling:

SOLIDS COMPOSITION	Domestic Wastewater w/ Fibrous Solids
MAXIMUM LIQUID TEMP.	140°F - Intermittent 104°F - Continuous
ACCEPTABLE PH RANGE	6-8

#### Temperature:

MAXIMUM STATOR	180°C
INSULATION CLASS	H

#### Technical Data:

SENSOR CORD TYPE	18AWG - Quick Change
MOTOR HOUSING	Cast Iron
CASING	Cast Iron
IMPELLER	Brass
MOTOR SHAFT	304SS
HARDWARE	SS
"O" RINGS	Viton
MECHANICAL SEALS	SiC Upper and Lower
UPPER BEARING	6203
LOWER BEARING	3205
CUTTER	440SST - Case Hardened
MOTOR WINDINGS	Copper

#### Electrical Data:

R.P.M.	3450
MOTOR TYPE	CSCR (1PH), Induction (3PH)
GEN INSULATION CLASS	H
STATOR WINDING CLASS	H
WINDING INSULATION TEMP	180°C
VOLTAGE TOLERANCE	±10%
HP	2
VOLTAGE	208/230/460
PHASE	1/3
SERVICE FACTOR	1

#### Dimensions:

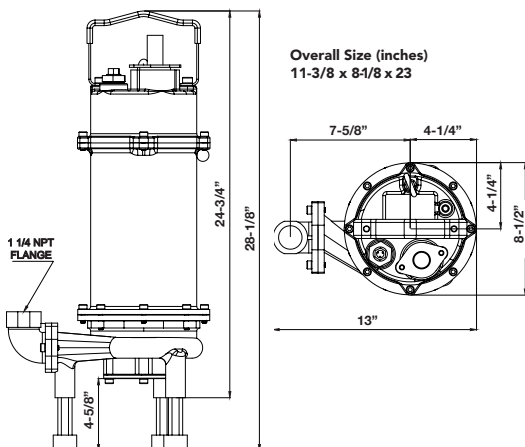

Performance Curve

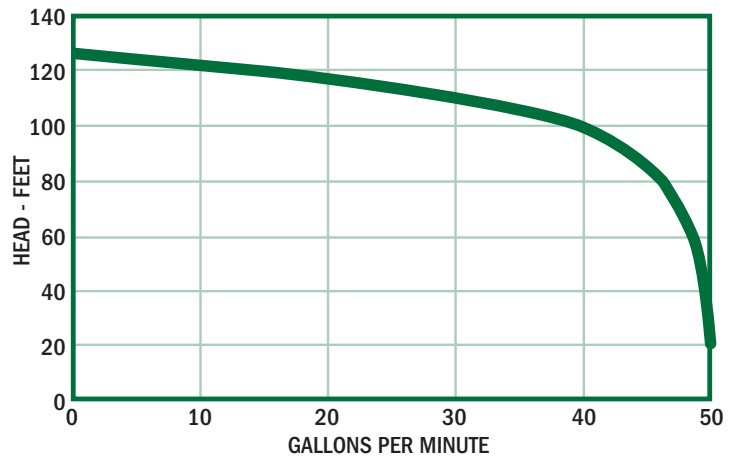

# AGP-HC200 FEATURES

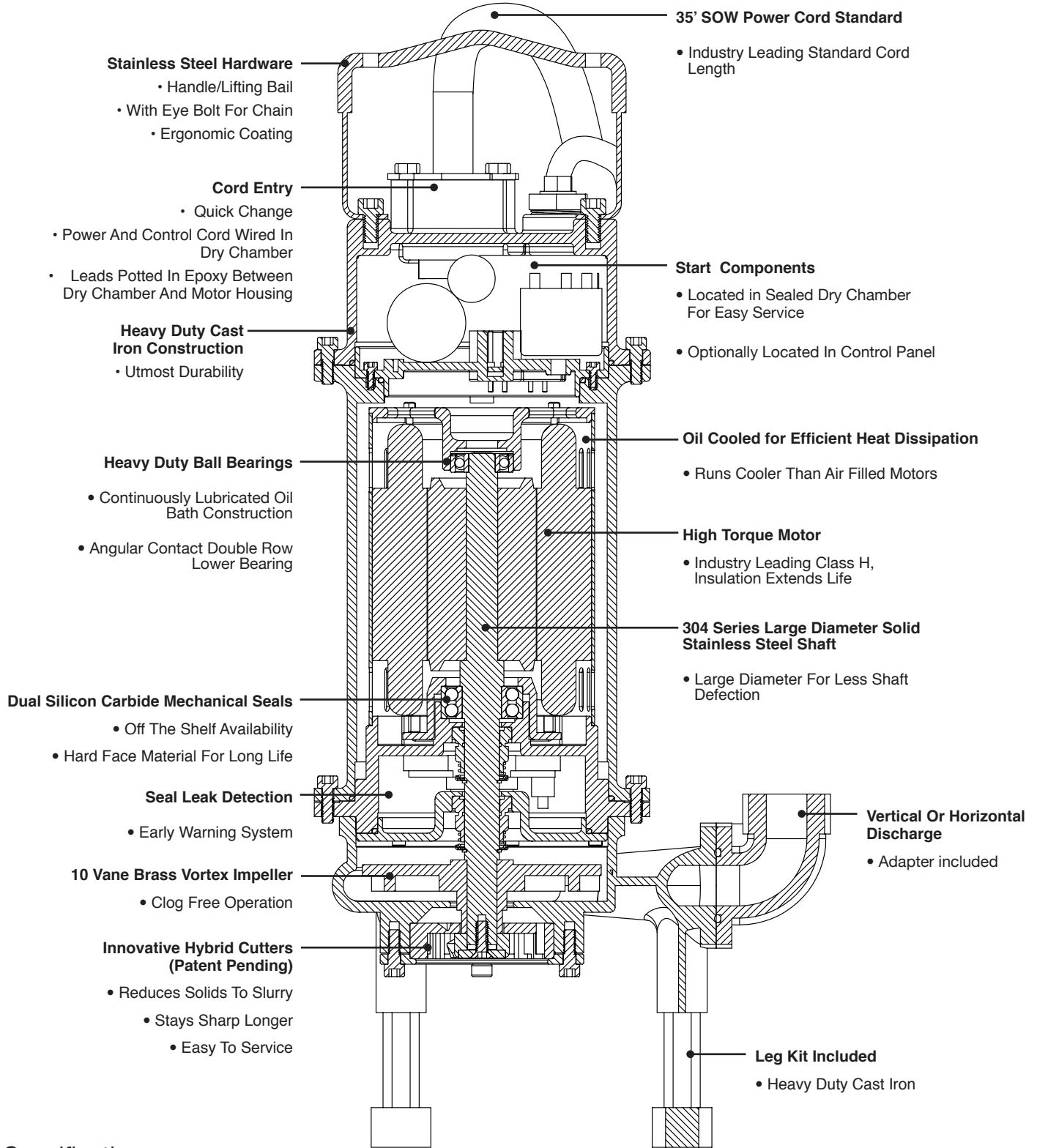

## Specifications

MODEL	HP	HZ	VOLTS/PH	RPM	FULL LOAD AMPS	NEMA START CODE	CORD TYPE	POWER CORD SIZE	CORD O.D.	POTENTIAL RELAY	START CAPACITOR	RUN CAPACITOR
AGP-HC200M5-35	2	60	208/1	3450	23	G	SOW	12 AWG/3C	.6	MARS 19169	MARS 11068	MARS 12248
AGP-HC200M5E-35	2	60	208/1	3450	23	G	SOW	12 AWG/3C	.6	MARS 19169	MARS 11068	MARS 12248
AGP-HC200M6-35	2	60	208/3	3450	12	G	SOW	12 AWG/4C	.6	N/A	N/A	N/A
AGP-HC200M2-35	2	60	230/1	3450	21	G	SOW	12 AWG/3C	.6	MARS 19169	MARS 11068	MARS 12248
AGP-HC200M2E-35	2	60	230/1	3450	21	G	SOW	12AWG/3C	.6	MARS 19169	MARS 11068	MARS 12248
AGP-HC200M3-35	2	60	230/3	3450	12	G	SOW	12 AWG/4C	.65	N/A	N/A	N/A
AGP-HC200M4-35	2	60	460/3	3450	6	G	SOW	12 AWG/4C	.65	N/A	N/A	N/A

# GRINDER PUMPS

## Cast Iron Grinder Pump Model: AGP200

### Features

- Heavy duty cast iron construction
- Dual mechanical silicon carbide seals
- Brass, 10 vane open impeller
- Viton o-rings
- Angular contact lower bearing
- Seal leak detection

### Specifications

#### Physical Data:

DISCHARGE SIZE	1-1/4" NPT
IMPELLER TYPE	10-Vane, Open- Brass
CABLE LENGTH	35'

#### Liquid Handling:

SOLIDS HANDLING	1/2"
MAXIMUM LIQUID TEMP.	140°F - Intermittent 104°F - Continuous
ACCEPTABLE PH RANGE	6-8

#### Temperature:

MAXIMUM STATOR	180°C
INSULATION CLASS	H

#### Technical Data:

SENSOR CORD TYPE	18AWG
MOTOR HOUSING	Cast Iron
CASING	Cast Iron
IMPELLER	Brass
MOTOR SHAFT	304SS
HARDWARE	SS
"O" RINGS	Viton
MECHANICAL SEALS	SiC Upper and Lower
UPPER BEARING	6203
LOWER BEARING	3207 Angular Contact (double row)
CUTTERS	440 SST - Case Hardened

#### Electrical Data:

R.P.M.	3450
MOTOR TYPE	CSCR (1PH), Induction (3PH)
GEN INSULATION CLASS	H
STATOR WINDING CLASS	H
WINDING INSULATION TEMP	180°C
VOLTAGE TOLERANCE	±10%
HP	2
VOLTAGE	208/230/460
PHASE	1/3
SERVICE FACTOR	1

#### Dimensions:

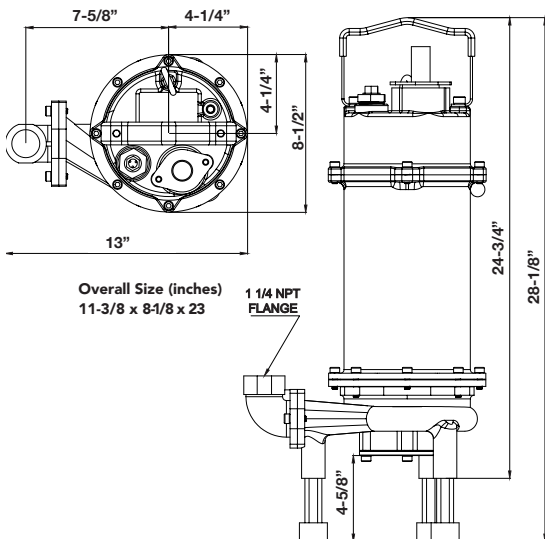

Performance Curve

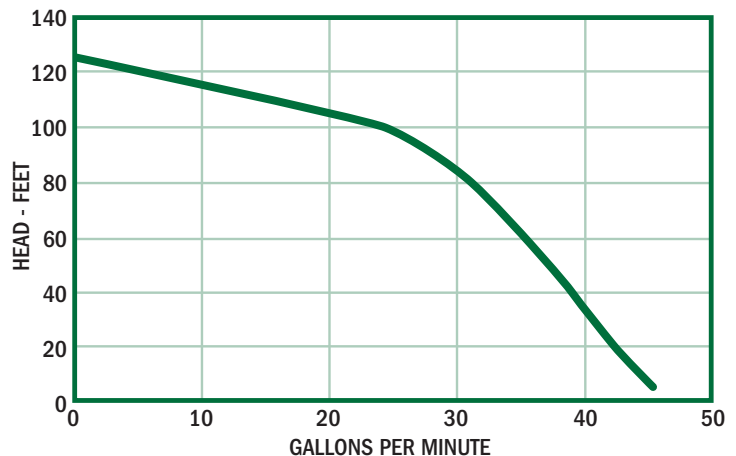

# AGP200 FEATURES

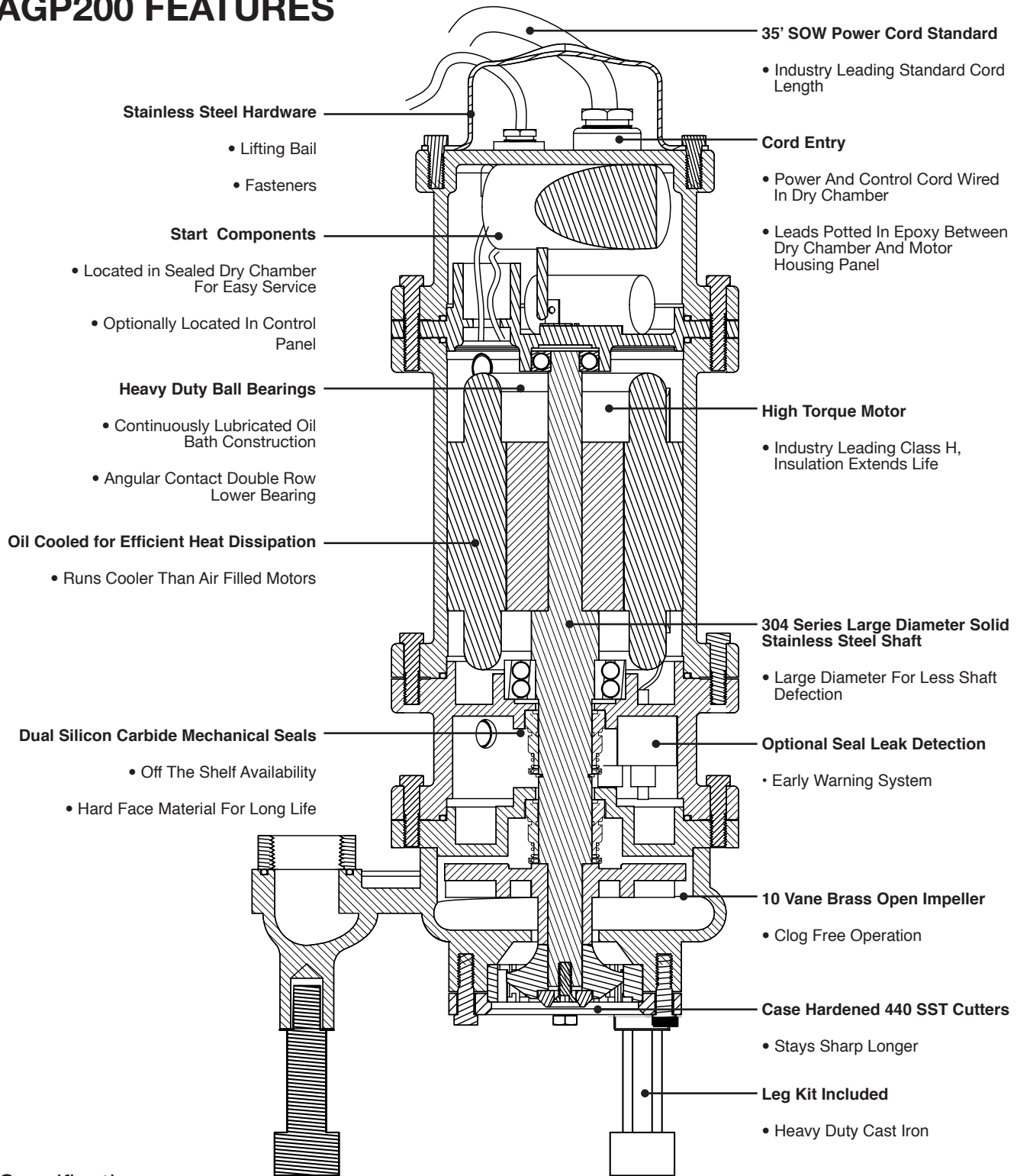

## Specifications

MODEL	HP	HZ	VOLTS/PH	BREAKER SIZE	RPM	FULL LOAD AMPS	NEMA START CODE	CORD TYPE	POWER CORD SIZE	CORD O.D.	POTENTIAL RELAY	START CAPACITOR	RUN CAPACITOR
AGP200M2-35	2	60	230/1	20A, 230V	3450	17	G	SOW	12 AWG	.6	MARS 19169	MARS 11068	MARS 12248
AGP200M2E-35	2	60	230/1	20A, 230V	3450	17	G	SOW	12 AWG	.6	MARS 19169	MARS 11068	MARS 12248
AGP200M3-35	2	60	230/3	20A, 230V	3450	12	G	SOW	12 AWG	.65	N/A	N/A	N/A
AGP200M4-35	2	60	460/3	10A, 460V	3450	6	G	SOW	12 AWG	.65	N/A	N/A	N/A
AGP200M5-35	2	60	208/1	20A, 230V	3450	20	G	SOW	12 AWG	.6	MARS 19169	MARS 11068	MARS 12248
AGP200M5E-35	2	60	208/1	20A, 230V	3450	20	G	SOW	12 AWG	.6	MARS 19169	MARS 11068	MARS 12248
AGP200W2-35	2	60	230/1	20A, 230V	3450	17	G	SOW	12 AWG	.6	MARS 19169	MARS 11068	MARS 12248
AGP200M6-35	2	60	208/3	20A, 230V	3450	13	G	SOW	12 AWG	.6	N/A	N/A	N/A

# GRINDER PUMPS

## Cast Iron Grinder Pump Model: AGP300, AGP500 and AGP750

### Features

- Heavy duty cast iron construction
- Dual mechanical silicon carbide seals
- Brass, 10 vane open impeller
- Viton o-rings
- Angular contact double row lower bearing
- Seal leak detection

### Specifications

<b>Physical Data:</b>	
DISCHARGE SIZE	2-1/2"
IMPELLER TYPE	10-Vane, Open- Brass
CABLE LENGTH	35'
<b>Liquid Handling:</b>	
SOLIDS HANDLING	1/2"
MAXIMUM LIQUID TEMP.	140°F – Intermittent 104°F - Continuous
ACCEPTABLE PH RANGE	6-8
<b>Temperature:</b>	
WINDING INSULATION TEMP.	180°C
INSULATION CLASS	H
<b>Technical Data:</b>	
SENSOR CORD TYPE	18AWG
MOTOR HOUSING	Cast Iron
CASING	Cast Iron
IMPELLER	Brass
MOTOR SHAFT	304SS
HARDWARE	SS
"O" RINGS	Viton
MECHANICAL SEALS	SiC Upper and Lower
UPPER BEARING	6204
LOWER BEARING	3207 Angular Contact (double row)
CUTTERS	440 SST Case Hardened
<b>Electrical Data:</b>	
R.P.M.	3450
MOTOR TYPE	PSC (1PH), Induction (3PH)
GEN INSULATION CLASS	H
STATOR WINDING CLASS	H
WINDING INSULATION TEMP	180°C
VOLTAGE TOLERANCE	±10%
HP	3, 5, 7.5
VOLTAGE	208/230/460
PHASE	1/3
SERVICE FACTOR	1.4 (AGP300), 1.7 (AGP500), 1.15 (AGP750)
<b>Dimensions:</b>	

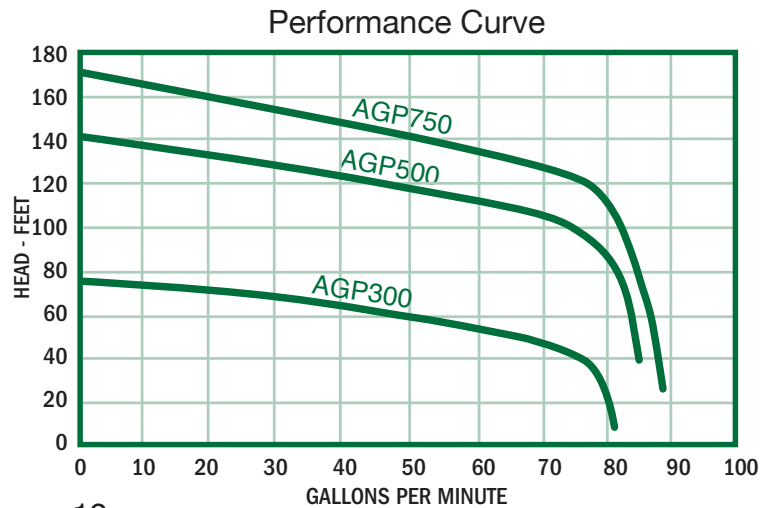
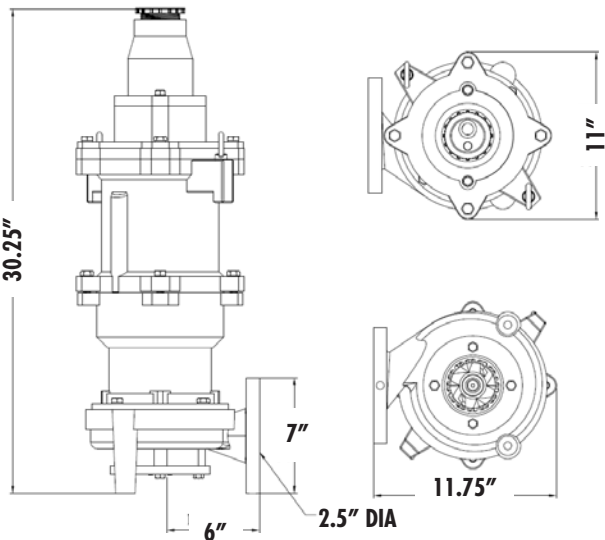

# AGP300, AGP500 and AGP750 FEATURES

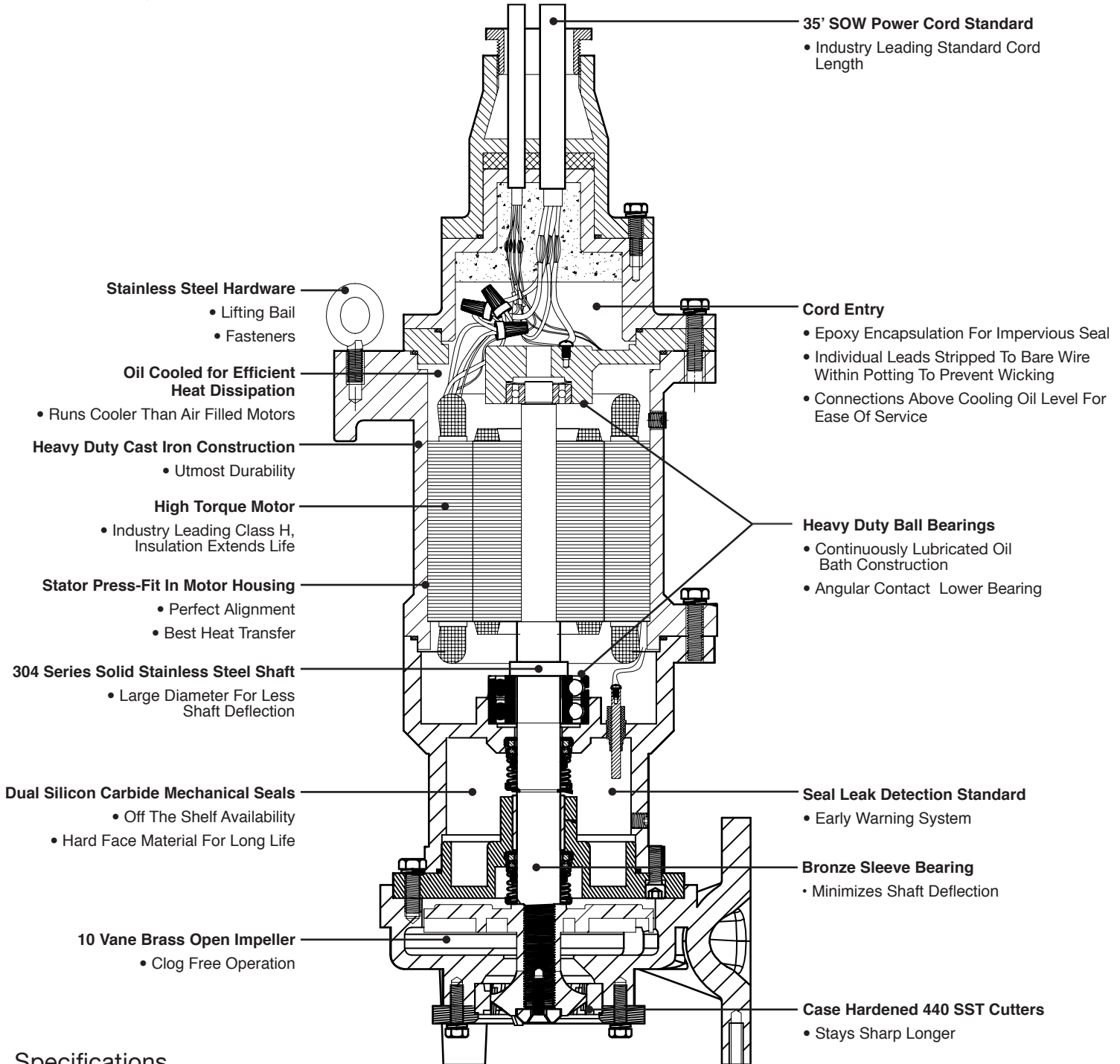

## Specifications

MODEL	HP	HZ	VOLTS/PH	RPM	FULL LOAD AMPS	NEMA START CODE	CORD TYPE	POWER CORD SIZE	CORD O.D.	POTENTIAL RELAY	START CAPACITOR	RUN CAPACITOR
AGP300M2-35	3	60	230/1	3450	23.1	G	SOW	12 AWG/4C	.68	CONT. COIL VOLTAGE: 500 V PICK-UP MAX: 300V DROP-OUT MAX: 135 V	108-130UF-250 VAC	30UF +/-5%-370 VAC
AGP300M3-35	3	60	230/3	3450	14.3	M	SOW	14 AWG/4C	.59	N/A	N/A	N/A
AGP300M4-35	3	60	460/3	3450	7.1	M	SOW	14 AWG/4C	.59	N/A	N/A	N/A
AGP300M5-35	3	60	208/1	3450	26	G	SOW	12 AWG/4C	.68	CONT. COIL VOLTAGE: 500 V PICK-UP MAX: 300V DROP-OUT MAX: 135 V	108-130UF-250 VAC	30UF +/-5%-370 VAC
AGP300M6-35	3	60	208/3	3450	14	M	SOW	14AWG/4C	.59	N/A	N/A	N/A
AGP500M2-35	5	60	230/1	3450	35.2	F	SOW	8AWG/4C	.96	CONT. COIL VOLTAGE: 500 V PICK-UP MAX: 300V DROP-OUT MAX: 135 V	270-324UF-250 VAC	30UF +/-5%-370 VAC
AGP500M3-35	5	60	230/3	3450	20.7	K	SOW	12AWG/4C	.68	N/A	N/A	N/A
AGP500M4-35	5	60	460/3	3450	10.3	K	SOW	12AWG/4C	.68	N/A	N/A	N/A
AGP500M5-35	5	60	208/1	3450	37	F	SOW	8AWG/4C	.96	CONT. COIL VOLTAGE: 500 V PICK-UP MAX: 300V DROP-OUT MAX: 135 V	270-324UF-250 VAC	30UF +/-5%-370 VAC
AGP500M6-35	5	60	208/3	3450	25	K	SOW	12AWG/4C	.68	N/A	N/A	N/A
AGP750M2-35	7.5	60	230/1	3450	36.5	F	SOW	8AWG/4C	.96	CONT. COIL VOLTAGE: 500 V PICK-UP MAX: 300V DROP-OUT MAX: 135 V	270-324UF-250 VAC	30UF +/-5%-370 VAC
AGP750M3-35	7.5	60	230/3	3450	24.6	K	SOW	8AWG/4C	.96	N/A	N/A	N/A
AGP750M4-35	7.5	60	460/3	3450	12.3	K	SOW	8AWG/4C	.96	N/A	N/A	N/A
AGP750M5-35	7.5	60	208/1	3450	38	F	SOW	8AWG/4C	.96	CONT. COIL VOLTAGE: 500 V PICK-UP MAX: 300V DROP-OUT MAX: 135 V	270-324UF-250 VAC	30UF +/-5%-370 VAC
AGP750M6-35	7.5	60	208/3	3450	22	K	SOW	8AWG/4C	.96	N/A	N/A	N/A

# SOLIDS HANDLING PUMPS

Cast Iron Solids Handling Pumps Model: ANC200, ANC300, ANC500 and ANC750

## Features

- Heavy duty cast iron construction
- Dual mechanical silicon carbide seals
- 2-Vane enclosed impeller
- Viton o-rings
- Angular contact double row lower bearing
- Seal leak detection

## Specifications

### Physical Data:

DISCHARGE SIZE	4"
IMPELLER TYPE	2-Vane, Enclosed- Cast Iron
CABLE LENGTH	35'

### Liquid Handling:

SOLIDS HANDLING	3"
MAXIMUM LIQUID TEMP.	140°F – Intermittent 104°F - Continuous
ACCEPTABLE PH RANGE	6-8

### Temperature:

WINDING INSULATION TEMP.	180°C
INSULATION CLASS	H

### Technical Data:

SENSOR CORD TYPE	18AWG
MOTOR HOUSING	Cast Iron
CASING	Cast Iron
IMPELLER	Cast Iron
MOTOR SHAFT	430SS
HARDWARE	SS
"O" RINGS	Viton
MECHANICAL SEALS	SiC Dual mechanical
UPPER BEARING	6203 (ANC200, ANC300) 6204 (ANC500, ANC750)
LOWER BEARING	3208 Angular Contact (ANC200, ANC300) 3308 Angular Contact (ANC500, ANC750)

### Electrical Data:

MOTOR TYPE	CSCR (1PH), Induction (3PH)
GEN INSULATION CLASS	H
STATOR WINDING CLASS	H
WINDING INSULATION TEMP	180°C
VOLTAGE TOLERANCE	±10%
HP	2, 3, 5 and 7.5
VOLTAGE	208/230/460
PHASE	1/3
SERVICE FACTOR	1.2

### Dimensions:

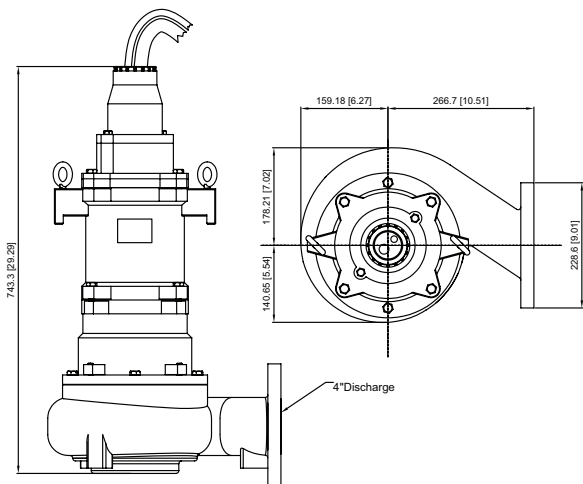

Performance Curve

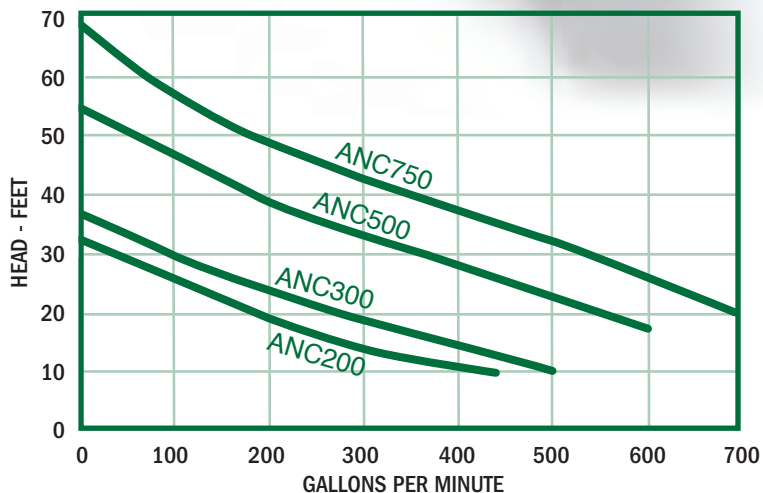



# ANC200, ANC300, ANC500 and ANC750 FEATURES

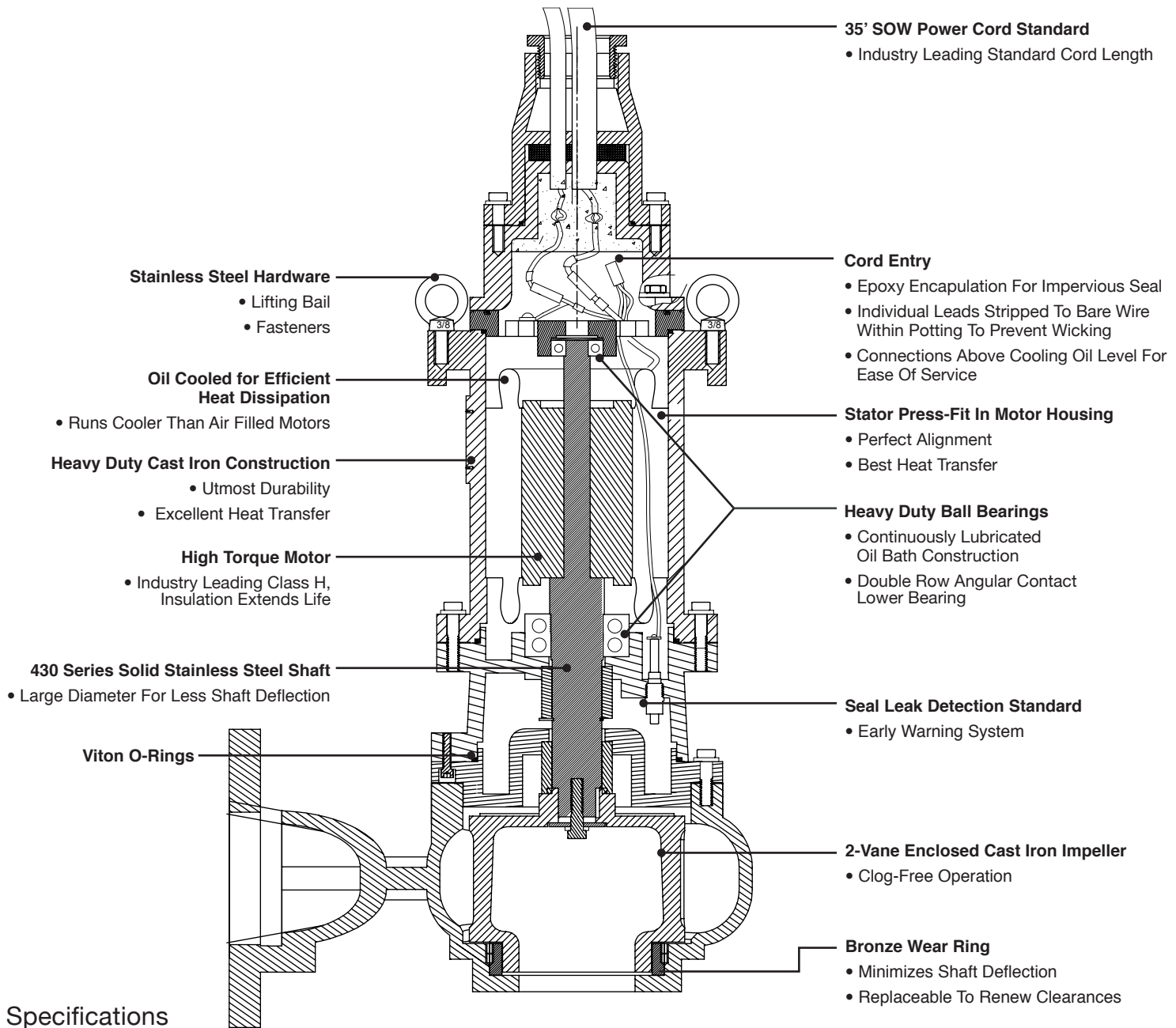

## Specifications

MODEL	HP	HZ	VOLTS/PH	RPM	FULL LOAD AMPS	NEMA START CODE	CORD TYPE	POWER CORD SIZE	CORD O.D.	POTENTIAL RELAY	START CAPACITOR	RUN CAPACITOR
ANC200M2-35	2	60	230/1	1750	16	G	SOW	14AWG/4C	.62	CONT. COIL VOLTAGE: 350 V PICK-UP MAX: 200 V DROP-OUT MAX: 75 V	161-193UF-220VAC	15 UF+/-5%-370VAC
ANC200M3-35	2	60	230/3	1750	8.8	L	SOW	14AWG/4C	.62	N/A	N/A	N/A
ANC200M4-35	2	60	460/3	1750	4.4	L	SOW	14AWG/4C	.62	N/A	N/A	N/A
ANC200M5-35	2	60	208/1	1750	18	G	SOW	14AWG/4C	.62	CONT. COIL VOLTAGE: 350 V PICK-UP MAX: 200 V DROP-OUT MAX: 75 V	161-193UF-220VAC	15UF+/-5%-370VAC
ANC200M6-35	2	60	208/3	1750	10	L	SOW	14AWG/4C	.62	N/A	N/A	N/A
ANC300M2-35	3	60	230/1	1750	19.3	G	SOW	12AWG/4C	.71	CONT. COIL VOLTAGE: 350 V PICK-UP MAX: 200 V DROP-OUT MAX: 75 V	430-516UF-220VAC	30 UF+/-5%-370VAC
ANC300M3-35	3	60	230/3	1750	13.2	K	SOW	14AWG/4C	.62	N/A	N/A	N/A
ANC300M4-35	3	60	460/3	1750	6.6	K	SOW	14AWG/4C	.62	N/A	N/A	N/A
ANC300M5-35	3	60	208/1	1750	22	G	SOW	12AWG/4C	.71	CONT. COIL VOLTAGE: 350 V PICK-UP MAX: 200 V DROP-OUT MAX: 75 V	430-516UF-220VAC	30 UF+/-5%-370VAC
ANC300M6-35	3	60	208/3	1750	14	K	SOW	14AWG/4C	.62	N/A	N/A	N/A
ANC500M2-35	5	60	230/1	1750	37.4	C	SOW	8AWG/4C	1.05	CONT. COIL VOLTAGE: 400 V PICK-UP MAX: 200 V DROP-OUT MAX: 80 V	270-324UF-220VAC	25 UF+/-5%-370VAC
ANC500M3-35	5	60	230/3	1750	19.8	G	SOW	12AWG/4C	.71	N/A	N/A	N/A
ANC500M4-35	5	60	460/3	1750	9.9	G	SOW	12AWG/4C	.71	N/A	N/A	N/A
ANC500M5-35	5	60	208/1	1750	43	C	SOW	8AWG/4C	1.05	CONT. COIL VOLTAGE: 400 V PICK-UP MAX: 200 V DROP-OUT MAX: 80 V	270-324UF-220VAC	25 UF+/-5%-370VAC
ANC500M6-35	5	60	208/3	1750	20	G	SOW	12AWG/4C	.71	N/A	N/A	N/A
ANC750M2-35	7.5	60	230/1	1750	58.2	D	SOW	6AWG/4C	1.2	CONT. COIL VOLTAGE: 400 V PICK-UP MAX: 200 V DROP-OUT MAX: 80 V	750 UF+/-5%-220VAC	40 UF+/-5%-370VAC
ANC750M3-35	7.5	60	230/3	1750	30.8	E	SOW	8AWG/4C	1.05	N/A	N/A	N/A
ANC750M4-35	7.5	60	460/3	1750	15.4	E	SOW	8AWG/4C	1.05	N/A	N/A	N/A
ANC750M5-35	7.5	60	208/1	1750	60	D	SOW	6AWG/4C	1.2	CONT. COIL VOLTAGE: 400 V PICK-UP MAX: 200 V DROP-OUT MAX: 80 V	750 UF+/-5%-220VAC	40 UF+/-5%-370VAC
ANC750M6-35	7.5	60	208/3	1750	31	E	SOW	8AWG/4C	1.05	N/A	N/A	N/A

# SOLIDS HANDLING PUMPS

## Cast Iron Solids Handling Pumps Model: ANC1000, ANC1500, and ANC2000

### Features

- Heavy duty cast iron construction
- Dual mechanical silicon carbide seals
- 2-Vane enclosed impeller
- Viton o-rings
- Angular contact double row lower bearing
- Seal leak detection

### Specifications

Physical Data:	
DISCHARGE SIZE	4"
IMPELLER TYPE	2-Vane, Enclosed- Cast Iron
CABLE LENGTH	35'
Liquid Handling:	
SOLIDS HANDLING	3"
MAXIMUM LIQUID TEMP.	140°F - Intermittent 104°F - Continuous
ACCEPTABLE PH RANGE	6-8
Temperature:	
WINDING INSULATION TEMP.	180°C
INSULATION CLASS	H
Technical Data:	
SENSOR CORD TYPE	18AWG
MOTOR HOUSING	Cast Iron
CASING	Cast Iron
IMPELLER	Cast Iron
MOTOR SHAFT	430SS
HARDWARE	SS
"O" RINGS	Viton
MECHANICAL SEALS	SiC Dual mechanical
UPPER BEARING	6405
LOWER BEARING	3309 Angular Contact
Electrical Data:	
R.P.M.	1750
MOTOR TYPE	Induction
GEN INSULATION CLASS	H
STATOR WINDING CLASS	H
WINDING INSULATION TEMP	180°C
VOLTAGE TOLERANCE	±10%
HP	10, 15, 20
VOLTAGE	230/460
PHASE	3
SERVICE FACTOR	1.2
Dimensions:	

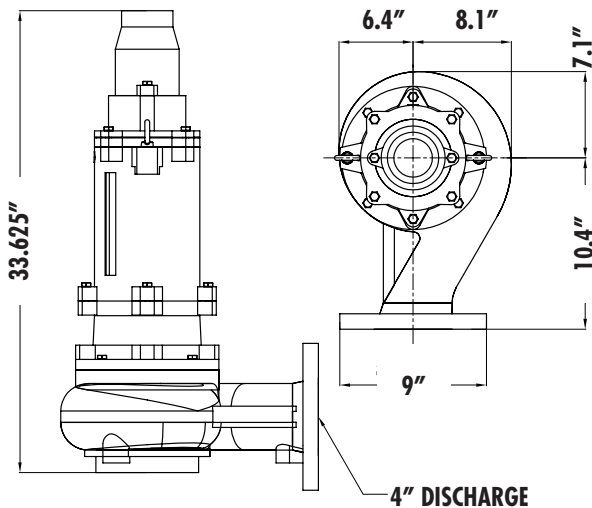

Performance Curve

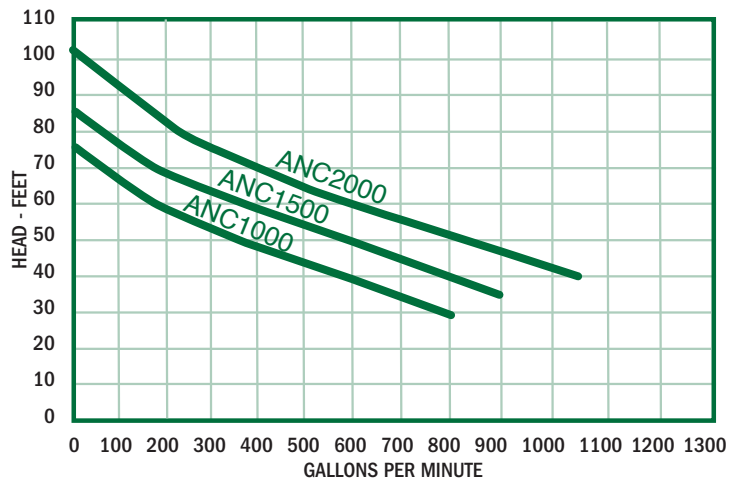

# ANC1000, ANC1500 and ANC2000 FEATURES

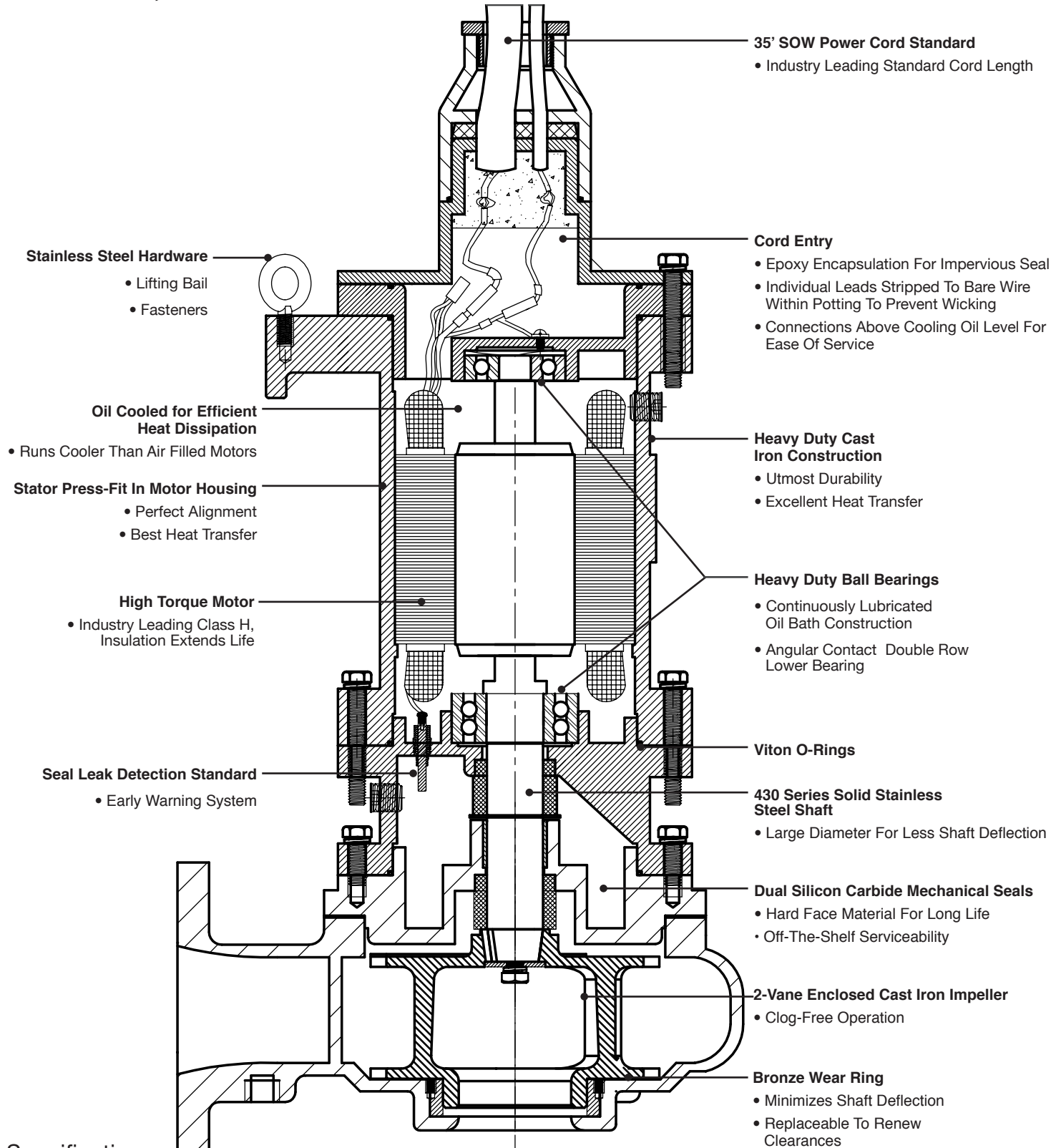

## Specifications

MODEL	HP	HZ	VOLTS/PH	RPM	FULL LOAD AMPS	NEMA START CODE	CORD TYPE	POWER CORD SIZE	CORD O.D.	POTENTIAL RELAY	START CAPACITOR	RUN CAPA
ANC1000M3-35	10	60	230/3	1750	35.2	G	SOW	8AWG/4C	1.05	N/A	N/A	N/A
ANC1000M4-35	10	60	460/3	1750	17.6	G	SOW	8AWG/4C	1.05	N/A	N/A	N/A
ANC1500M3-35	15	60	230/3	1750	57.2	F	SOW	6AWG/4C	1.2	N/A	N/A	N/A
ANC1500M4-35	15	60	460/3	1750	28.6	F	SOW	6AWG/4C	1.2	N/A	N/A	N/A
ANC2000M3-35	20	60	230/3	1750	55	G	SOW	4AWG/4C	1.45	N/A	N/A	N/A
ANC2000M4-35	20	60	460/3	1750	27.5	G	SOW	4AWG/4C	1.45	N/A	N/A	N/A

# BASE ELBOW SYSTEMS

BERS-0125, BERS-0150, BERS-0200

Material	Powder coated
Accessories Material	Stainless steel
Guide Rail Pins	Accept 0.75" or 1" rails
Pump Weight Rating	Less than 200 lbs.
Discharge	2"



BERS-0125



BERS-0125 CV

BERS-0125 CV, BERS-0150 CV, BERS-0200 CV

Material	Powder coated
Accessories Material	Stainless steel
Guide Rail Pins	Accept 0.75" or 1" rails
Pump Weight Rating	Less than 200 lbs.
Discharge	2"
Integral Check Valve	Included

BERS-0125 EX, BERS-0150 EX, BERS-0200 EX

Material	Powder coated
Accessories Material	Stainless steel
Guide Rail Pins	Accept 0.75" or 1" rails
Pump Weight Rating	Less than 200 lbs.
Discharge	2"
Integral Check Valve	Included
Pull out Flange	Bronze
Guide Rail Plate	Bronze



BERS-0125 EX



BERS-0300 V

BERS-0300 V, BERS-0320 V

Designed for pumps with Vertical Discharge

Material	Powder coated
Accessories Material	Stainless steel
Guide Rail Pins	Accept 0.75" or 1" rails
Pump Weight Rating	Less than 400 lbs.
Discharge	3"

BERS-0300 H, BERS-0325 H

Designed for pumps with Horizontal Discharge

Material	Powder coated
Accessories Material	Stainless steel
Guide Rail Pins	Accept 0.75" or 1" rails
Pump Weight Rating	Less than 400 lbs.
Discharge	3"



BERS-0300 H

# ACCESSORIES

## Control Duty Mercury Float Switches

B1 and B2

Material	Polypropylene Shell Polyurethane Foam Filling
Switch	1.52g Mercury Tilt
Operating Temperature	32 170°F
Cable Type	SJOOW-300 V - 18/2 SJOOW-300 V - 18/3

## Piggyback Plug Options

Volt	P1, 120 VAC, 1/2 HP P2, 230 VAC, 1 HP
------	--

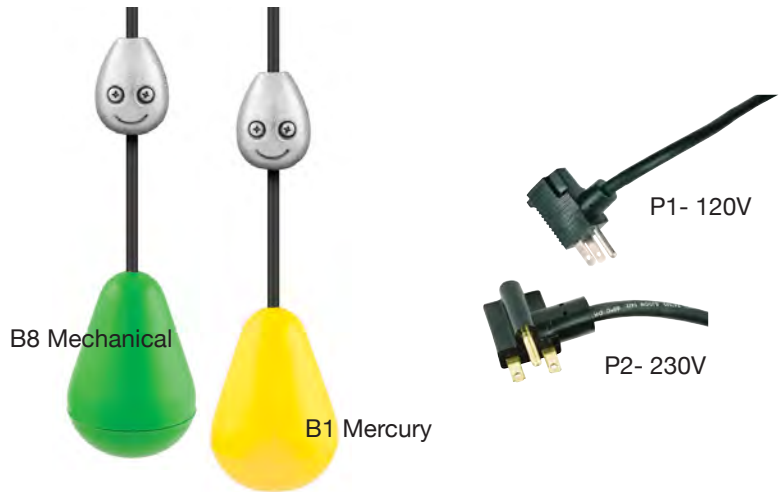

## Brackets, 4FB, 5FB and 6FB Types

Material	Stainless Steel
Accessories	Cord Snubbers

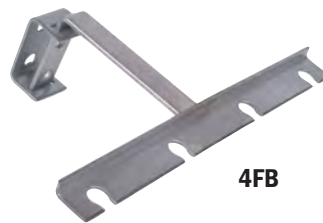

## Stainless Steel Chains and Shackles

Chain Sizes	1/8" up to 1/2"
Shackle Sizes	1/4" up to 5/8"



## TA15H Indoor Alarm

Material	Metallic Enclosure
Size	6" x 4" x 2.5"
Volume	85db Alarm Buzzer
Cord	6' 120 VAC



# CONTROL BOXES

Custom controls, panel specifications and schematics

Simplex/duplex panels: Time Dose,  
BioAerobic Spray,  
Drip and Grinder Panels



# ASHLAND PUMP WARRANTY

Ashland Pump warrants the original purchaser of each product for a period of one (1) year from date of installation or eighteen (18) months from date of manufacture. Obligation under this warranty is limited to repairing or replacing any part, thereof, which shall within one (1) year be returned to us with transportation charges prepaid and proved to be defective.

The above limited warranty takes the place of all other warranties, express or implied and correction of such defects by replacement or repair shall constitute a fulfillment of all obligations under the terms of the warranty, which specifically EXCLUDES any incidental damages caused by or associated with this product or its use. The warranty does not cover any unit which has been damaged either in transit or by misuse, accident or negligence. No warranty or representative not contained herein shall be binder.





**P U M P**

***Honest, Professional, Dependable***

1899 Cottage Street, Ashland, Ohio 44805  
Telephone: 855 281-6830 • Fax: 877 326-1994  
[ashlandpump.com](http://ashlandpump.com)

Ashland Pump Mun/Com Catalog 1/2017