



General Engineering Company
 P.O. Box 340 • 916 Silver Lake Dr. • Portage, WI 53901
 608-742-2169 (Office) • 608-742-2592 (Fax)
 www.generalengineering.net

SITE PLAN
2019 SHORELINE REPAIRS
VILLAGE OF PARDEEVILLE

VILLAGE OF PARDEEVILLE
 COLUMBIA COUNTY, WI

REVISIONS	NO.	BY	DATE

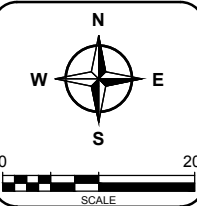

DRAWN BY	SRR
REVIEWED BY	KDA
ISSUE DATE	03/20/2019
GEC FILE NO.	0119-6B
SHEET NO.	C1.0

DIGGERS HOTLINE
 DIAL 811 or 1-800-242-8511
 To Obtain Location of Participants Underground Facilities Before You Dig in Wisconsin
 Wis Statute 182.0175 (1974)
 Requires Min. 3 Work Days Notice Before You Excavate

NOTES:

1. ALL EXISTING UNDERGROUND UTILITY LOCATIONS ARE APPROXIMATE AND SHOULD BE FIELD VERIFIED PRIOR TO CONSTRUCTION.
2. PROPERTY LINES ARE SHOWN APPROXIMATE.
3. REMOVE POWER POLES, ALL TREES AND BRUSH AS DIRECTED BY THE VILLAGE DPW.

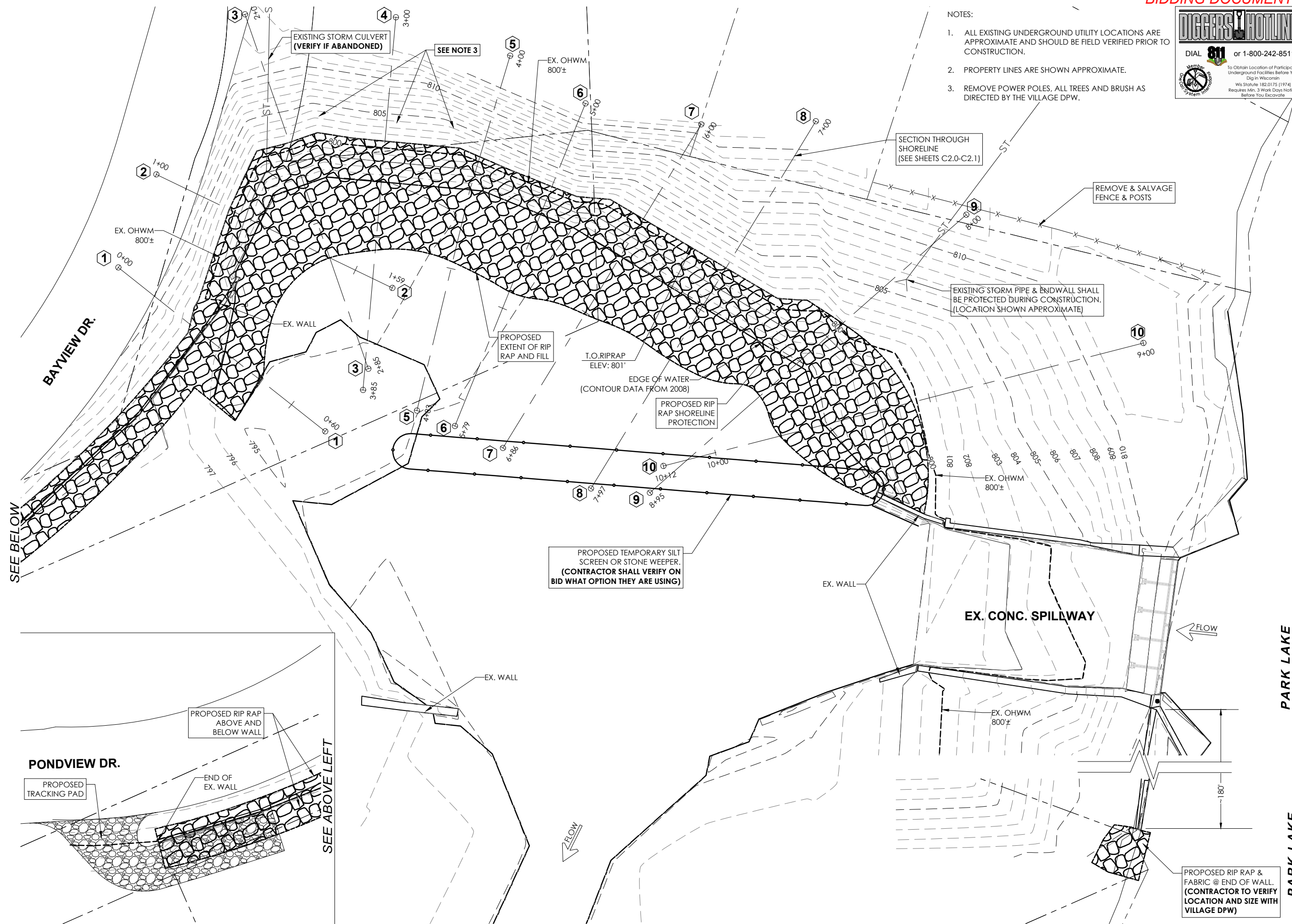

G:\Current Files L-Q\Pardeeville, Village of\2019 Municipal Engineering Services\2019-6B Dam Inspection - March Flooding\CAD 2-0119-6B2_CIVIL\Production Drawings\4_Misc\Sections 0119-6B.dwg, 3/22/2019 1:48:26 PM, 1:1