

Saint Patrick Roman Catholic Church

Mystic, Connecticut



Master Plan : TASK 3 Presentation

Goals

- 1. Create a cohesive, welcoming campus for all**
 - Improve accessibility and flow
 - Build community and support outreach
 - Harmonize with the scale and character of the area
- 2. Establish a connection between the Church and the Parish Center**
 - Facilitating circulation between buildings strengthens the sense of community and encourages participation
 - Center can provide the supplemental spaces currently limited within the existing Church building
- 3. Provide spaces that support Parish needs (i.e. Faith Formation Atria, meeting rooms, hall, etc.)**
 - Spaces that support growing spiritual and educational needs, including outreach programs
 - Meaningful environments that are more welcoming and comfortable
 - Flexible, efficient spaces accommodating large and small groups

List of Needs

This list has been developed throughout the Master Planning process and can continue to be modified and prioritized to ensure that it adequately meets the needs and expectations of the Parish.

CHURCH MAINTENANCE :

- First Floor – minor structural repairs needed at front of Church
- Clean & inspect boiler chimney
- Remove abandoned boiler
- Boiler near end of useful life
- New hot water heater for bathroom
- Insulate existing plumbing piping
- Efficient/ADA compliant fixtures
- Whenever/wherever possible, replace lighting with LED fixtures
- Update Fire Alarm system
- Replace exterior ramp and railings
- Restore stained glass windows
- Refinish floor
- Insulate floor

CHURCH :

- Accessible Bathroom
- Replace Altar windows
- Re-shingle exterior
- Additional seating
- Smaller Font
- Move Choir
- Storage
- Replace carpet

PARISH CENTER :

- Interior Connection to Church
- Gracious Lobby
- Hall w/Commercial Kitchen
- Religious Education Atria (3 rooms + Lobby Area)
- Education Office w/Workroom
- Space for Youth Activities
- Meeting Rooms
- Accessible Entrances
- Accessible Bathrooms
- WIFI, AV
- Storage
- Offices

SITE :

- Improve Parking Flow & Drop-Off
- Exterior lighting
- Large outdoor gathering space near Center
- Playground
- Better drainage overall

Task 3 : Program

This is the preliminary program for the New Parish Center that was incorporated into the Task 3 Recommended Plan.

NEW PARISH CENTER :

- Entry Vestibule on East Main Street
- Main Lobby
- Office Wing: Pastor Office, Pastor Meeting Room, Music Director Office, Sexton Office, Secretary
- Saint Anthony Meeting Room
- Hall
- Kitchen
- Storage
- Mens and Womens Restrooms
- Maintenance Room
- Mechanical/Electrical Room
- Entry Vestibule on Church Street
- Faith Formation Atria Lobby
- Faith Formation Atria (3 total)
- Faith Formation Office
- Workroom & Storage
- Meeting Room 2
- Family Restroom

Vision

While reviewing the recommended plan, please keep the following in mind at this stage of the Master Plan:

- 1. Does the plan address the main concerns, goals and needs of the Parish?**
- 2. Are the plan and renderings inspiring and exciting enough to generate momentum for the capital campaign?**

Task 3 Recommended Plan

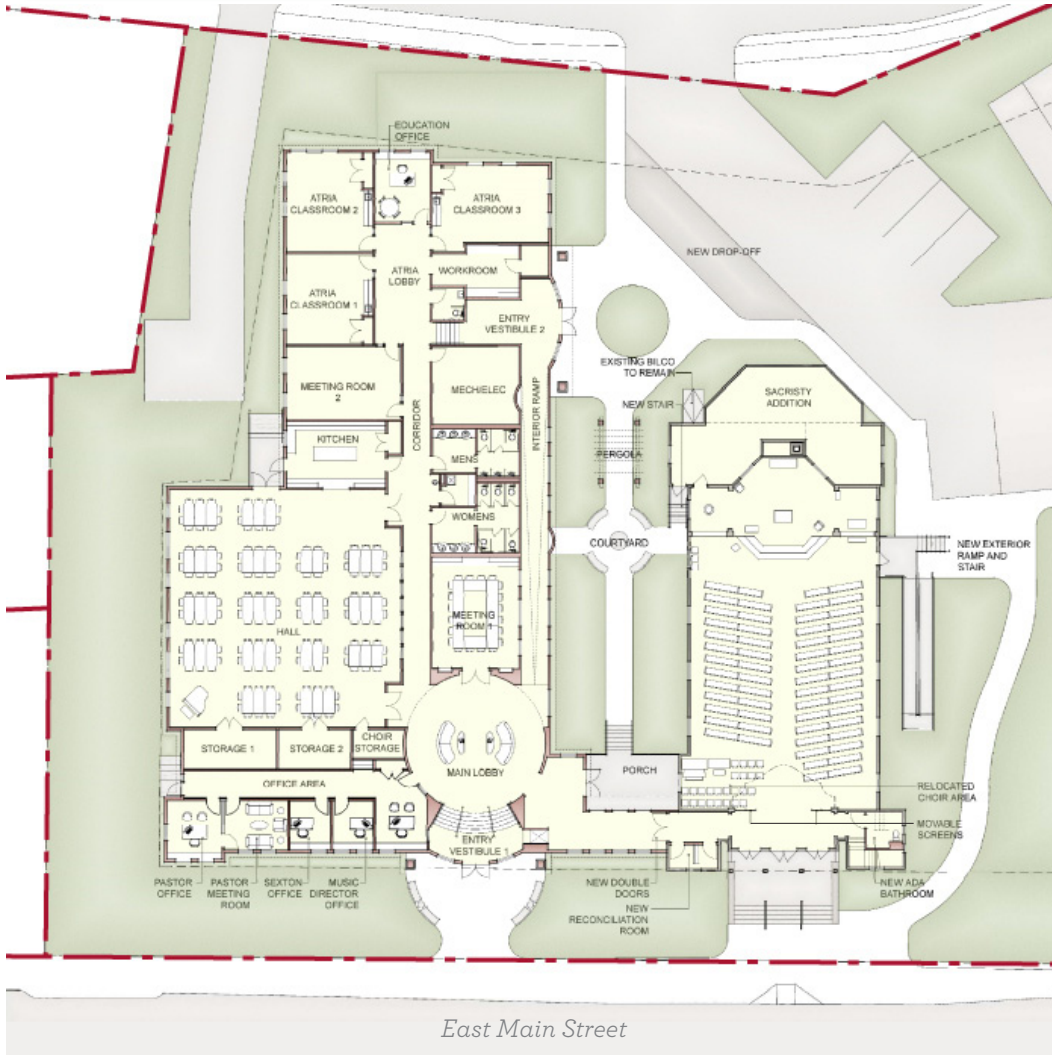

East Main Street View



Church Street View



Courtyard View

Task 3 Questionnaire

The Doyle Coffin Architecture (DCA) master planning team recently completed and presented the Task 3 Recommended Plan. This included a development and analysis of a Master Plan for the St. Patrick Campus that addressed your input from Tasks 1 & 2. The full presentation is available on the Saint Patrick website: www.stpatrickmystic.org for your review. A hard copy may be reviewed at the Rectory Office upon request.

Please take a moment to review the presentation before completing this questionnaire. This questionnaire can also be completed online at:

<https://www.surveymonkey.com/r/StPatrickTask3>

Questionnaire responses are due no later than **September 3, 2017**.

Name (optional): _____ Email (optional): _____

What do you **LIKE** about the Task 3 Recommended Plan? Please comment below:

What do you **DISLIKE** about the Task 3 Recommended Plan? Please comment below:

If there is any information that is inaccurate or missing in the Task 3 Recommended Plan, please comment below:
