

# **2017 Guide to the Blowing Rock Conference Center**



**Your Place in the Mountains**

**Tel: 828-295-7813**

**Email: [info@brccenter.org](mailto:info@brccenter.org)**

**[www.brccenter.org](http://www.brccenter.org)**

**T**he Blowing Rock Conference Center is located in the beautiful mountain village of Blowing Rock, North Carolina, sitting at the highest point in the village at an elevation of 3800 feet.

**Our mission is to provide a special place where God's people can gather for community development, education and spiritual growth.**

BRCC offers churches, schools, and other non-profit organizations a perfect spot for year round retreats, camps and conferences.

Our location, just off the Blue Ridge Parkway, can be your jumping-off point for year-round activities, from antiquing and bird watching to golfing and fishing and – for more adventurous souls – whitewater rafting, skiing, mountain biking and climbing.

Blowing Rock Conference Center is within a two-hour drive from the Charlotte, NC or Greensboro, NC airports.

**Come and be our guest!**

Blowing Rock Conference Center  
1818 Goforth Road  
Blowing Rock, NC 28605  
828.295.7813

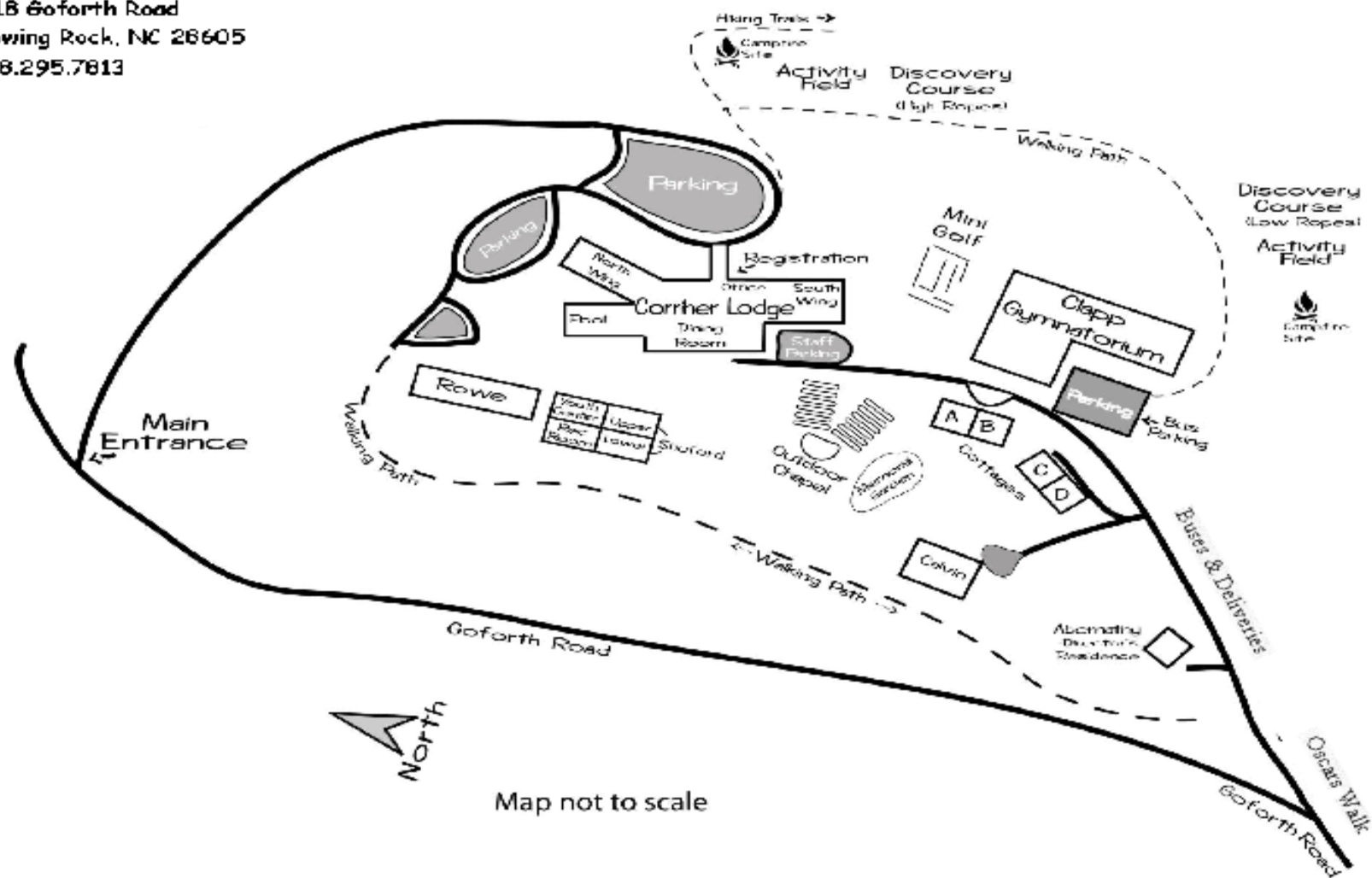



**Corriher Lodge** is Blowing Rock Conference Center's principal building and hub of activity, being the location of the administrative offices, registration desk, dining room, and meditation chapel, in addition to guest rooms and meeting facilities.



There are many pleasant gathering areas for our guests to enjoy quiet conversation and fellowship, from Corriher Lodge's South Lobby with its gas log fireplace, to decks and porches, to small tucked away spots for more intimate conversations.

Each of the 51 lodge guest rooms is comfortably appointed with two double beds and a private bath. Five of the guest rooms are handicapped-accessible. Because of our moderate climate at 4000 ft. above sea level, our buildings are not air-conditioned. Box fans are provided in each bedroom. Wi-Fi is available throughout Corriher Lodge.

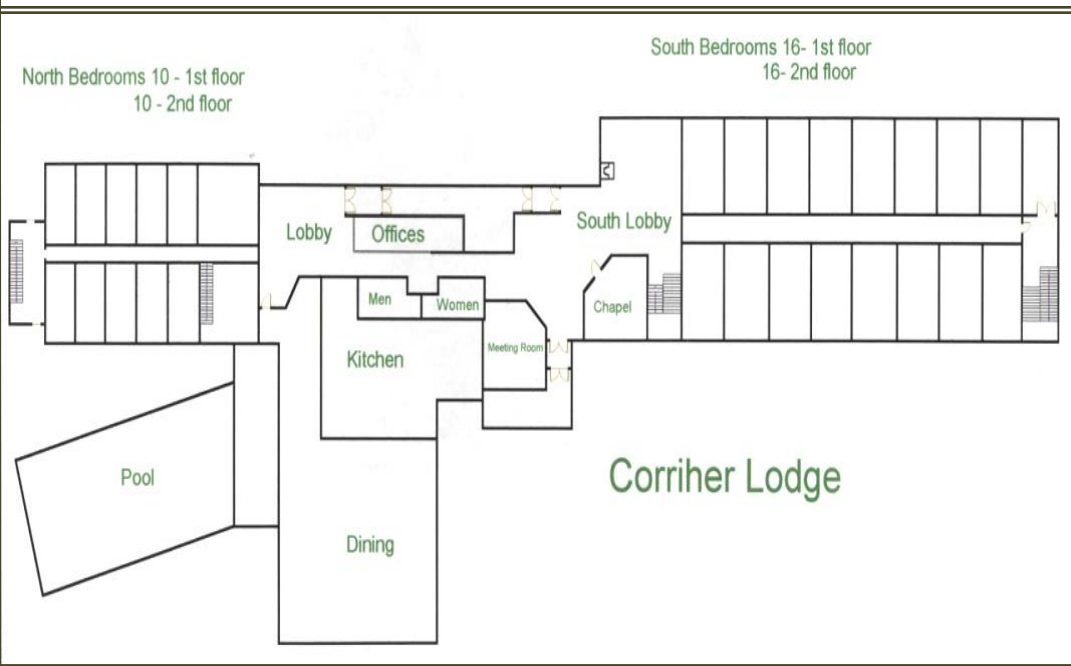



**BRCC's Cottages** are perfect for small retreats or a family get-away, whether for a fall color-viewing weekend or a week long summer vacation!

Our four cottages are actually two duplex buildings. Each building contains two cottages. One building contains cottages A and B; the other is cottages C & D. Each cottage will accommodate six persons, with one bedroom having a queen bed and the other bedroom with 2 single beds and a bunk bed set. Each cottage's kitchenette is equipped with a 3 burner stove, small oven & refrigerator, microwave, & coffee maker. A "kitchen kit" of pots & pans, dishes and utensils are available upon request. Sheets, pillows, and

blankets are provided for beds. Cottages are not air conditioned, but each has a ceiling fan and a floor box fan.



Cabins A&B or C&D

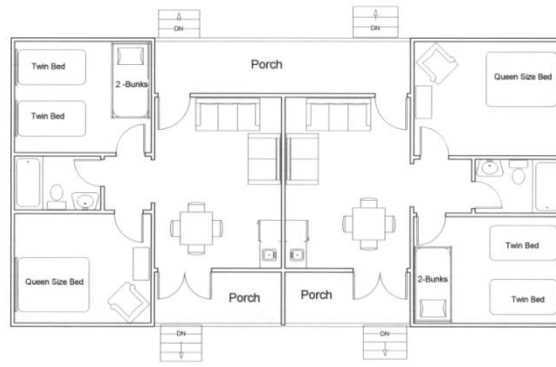



**Rowe Dorm** will accommodate 80 persons in ten two-bedroom dorm-style units, each bedroom sleeping 4 in bunk beds, with a shared bathroom. There are no cooking facilities in Rowe Dorm.

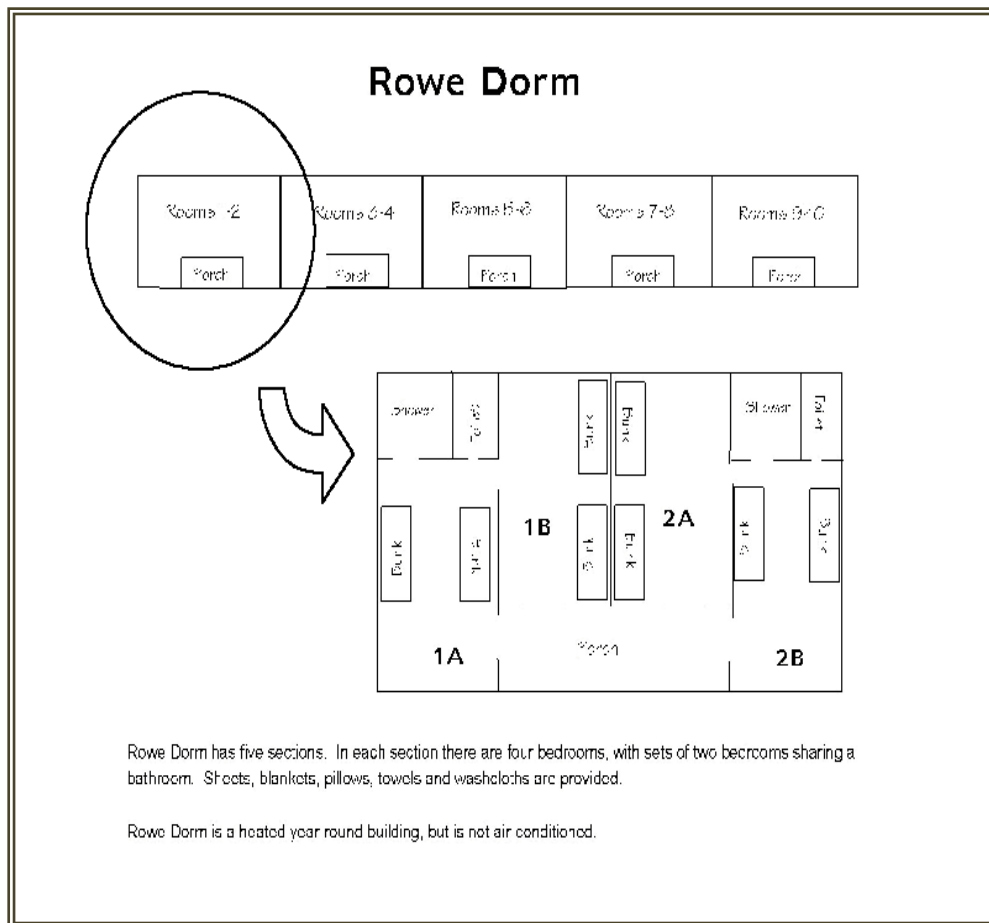



**The Southern Conference Youth Center** has dormitory-style accommodations for 24-28 guests. Each of the four bedrooms contains three sets of bunks and one trundle bed. There are two bathrooms in the Youth Center, each with two showers and two toilets. There are no cooking facilities in the Youth Center.



### Southern Conference Youth Center



The Youth Center will accommodate 24 guests in bunk beds, and each of the 4 rooms also contains a trundle bed, bringing the capacity of the Youth Center to 28. Sheets, blankets, pillows, towels and washcloths are provided.

The Youth Center is a year-round heated facility, but is not air conditioned. There is a box fan provided for each bedroom.

## Calvin

**Cottage** is a year round retreat center accommodating 24 guests. Bedrooms are dormitory-style, with bunk beds. The kitchen includes a full size refrigerator and stove. A coffee maker, pots and pans, dishes utensils, potholders, dishtowels and dishwashing liquid are also provided. The meeting area adjacent to the kitchen contains chairs and tables. Two large decks offer pleasant outdoor space during milder weather. Calvin Cottage is a year round heated retreat center. It is not air conditioned.

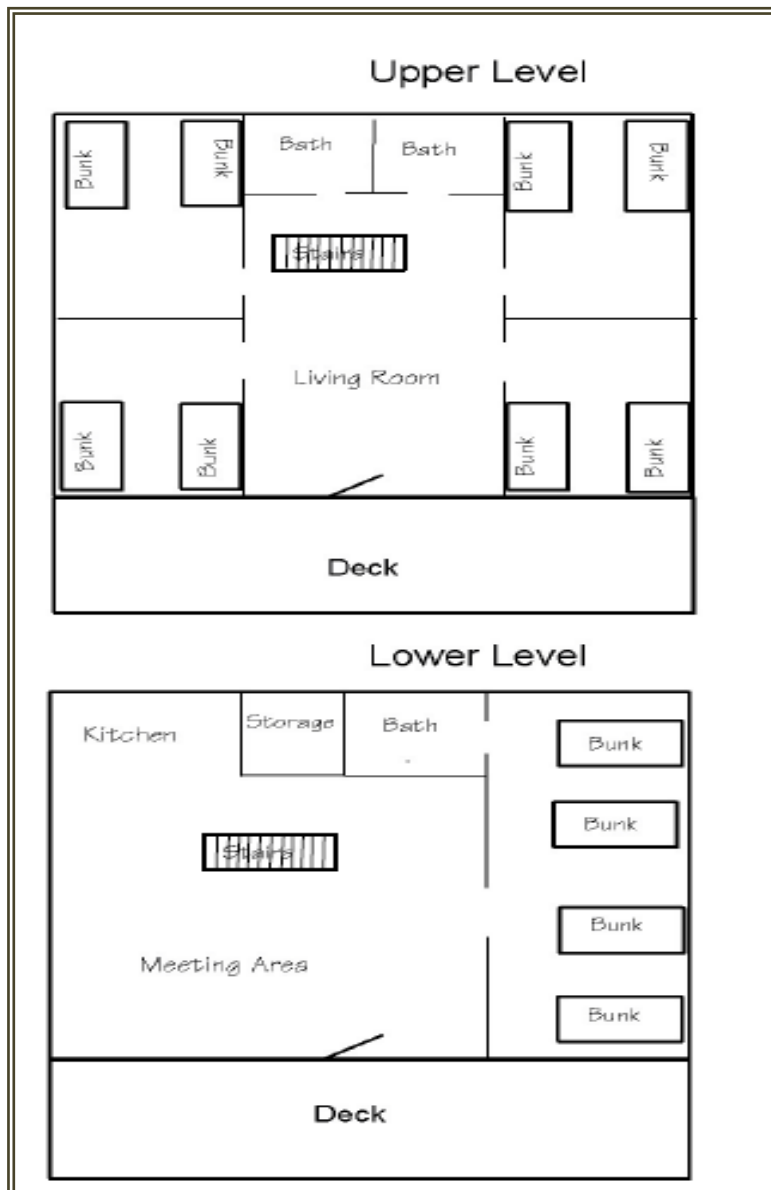



## **Meeting Space Information**

A variety of meeting rooms are available at the Blowing Rock Conference Center - some with fireplaces, and others with a smaller, more business-like atmosphere.

Our staff will make every effort to set your meeting space or breakout rooms according to your request, using the Meeting Space Request Form that each group leader is provided. Although meeting spaces are assigned to groups by our staff, we endeavor to match the meeting space with the group's size and program needs.

We can provide your group with a TV/VCR/DVD, sound system, LCD projector, screen and whiteboard.

Our staff is available to make photocopies and send faxes.

There is free wireless internet available in all of BRCC's meeting rooms.

## BRCC Meeting Rooms

Meeting Room	Location	Dimensions	Square Feet	Wi-Fi	Seating Theater-style	Seating Classroom-style (at 30" X 72" tables)
Lower Conference Room	Corriher Lodge	40 x 32	1280	Yes	60	36
Upper Shuford Hall	Shuford Hall	60 x 30	1800	Yes	150	60
Lower Shuford Hall	Shuford Hall	50 x 28	1400	Yes	120	45
Rec. Room (Southern Conference Meeting Room)	Youth Center	48 x 30	1440	Yes	75	30
Gym Meeting Room	Clapp Gymnatorium	23 x 19	437	Yes	20	18
South Conference Room	Corriher Lodge	24 x 21	504	Yes	20	15
Meditation Chapel	Corriher Lodge	20 x 20	400	Yes	20	n/a
Gathering Place	Corriher Lodge	12 x 40	480	Yes	10	n/a
Gym Lobby	Clapp Gymnatorium	30 x 40	1200	Yes	20+	n/a
Earnhardt Room	Corriher Lodge (Dining Room)	12 x 24	288	Yes	12	n/a
Gymnasium	Clapp Gymnatorium	60 x 100	6000	Yes	350	12

Room dividers are available for either Upper or Lower Shuford.

During our warmer weather months there are several outdoor areas that can serve as meeting or breakout areas, including patios, decks, the Outdoor Chapel, Gazebo and Pavilion.

# Upper Shuford Hall



**Upper Shuford Hall** has a maximum capacity of 150, and is located a few short steps from Corriher Lodge. It is a great location for plenary sessions, worship services and group activities.

Upper Shuford Hall is handicapped-accessible and features a natural stone fireplace, refrigerator and sink, restrooms, a built-in 5 mic audio system and 2 65" smart televisions, and Wi-Fi.





## Lower Shuford Hall

**Lower Shuford** has a maximum capacity of 120. A large natural stone fireplace serves as the focal point of the room. Nearby restrooms, a refrigerator, and a screen are provided.

A small patio is located just outside the meeting area.

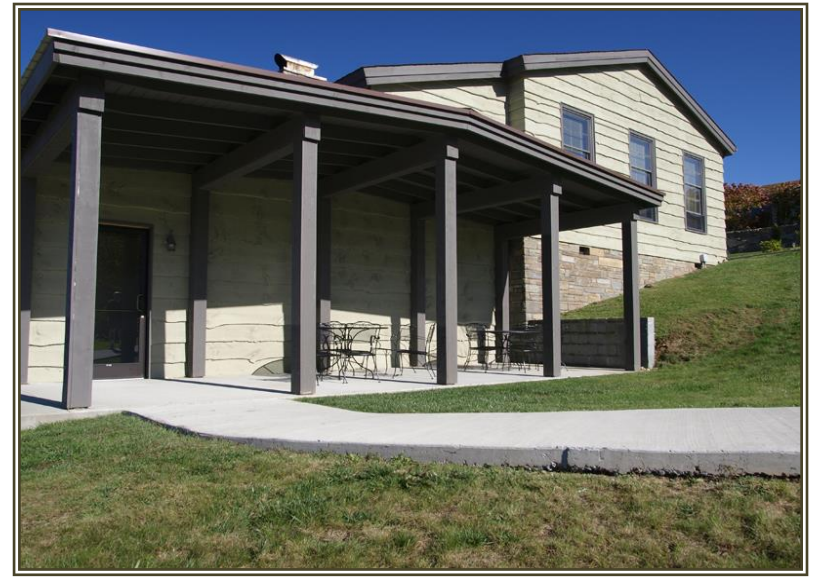

Lower Shuford may be accessed by stairway from Corriher Lodge, or by going around the building and entering the rear of the building, which is handicapped accessible.

## Southern Conference Meeting Room (Rec Room)

**Southern Conference Meeting Room**, sometimes referred to as the “Rec. Room”, has a maximum capacity of 75. This meeting room is located directly beneath the Southern Conference Youth Center, and may be accessed via stairway from the Youth Center, or by entering the rear of the building through the handicapped-accessible entry. A refrigerator and sink, screen and Ping Pong table are located in this room, and restrooms are just off the hallway near the back entrance.



## South Corriher Conference Room



**The South Corriher Conference Room**, located just off the south lobby of Corriher Lodge, is the perfect spot for a small group meeting or breakout space. The room can seat 20 people theater-style, or up to 15 at tables.

A pull-down screen, TV/DVD, and wireless internet are available in this room





## Lower Conference Room

**Corriher Lodge's Lower Conference Room** is located beneath Leonard Dining Room. The room is carpeted, and is ideal for groups of up to 50 people. Free wireless internet is available. A pull-down screen, full-size refrigerator, countertop and sink, are located in the room. Restrooms are just off the hallway, and there is a patio outside the meeting room.



The Lower Conference Room is accessed either by a stairway from Leonard Dining Room or by exiting the South Corriher Lodge lobby and walking a short distance behind the building via the handicapped-accessible route.

## Areas for Worship, Prayer or Contemplation

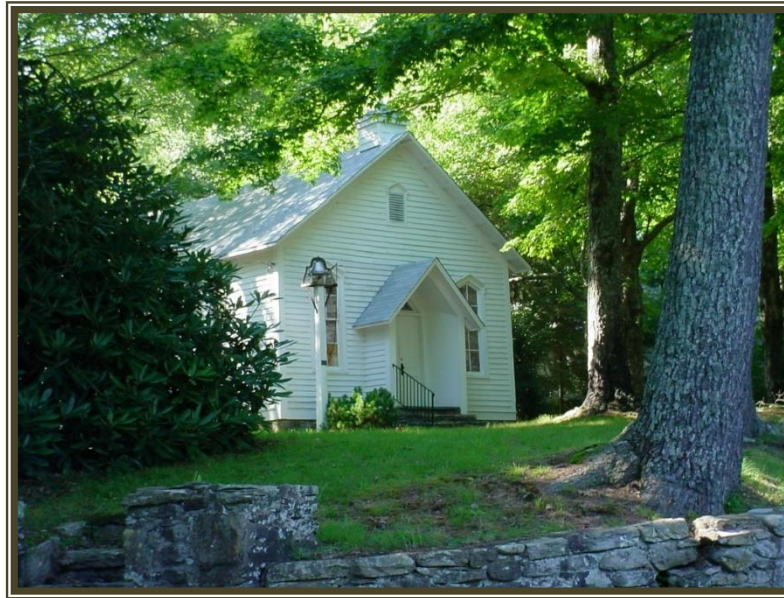

**Mount Bethel Church**, “The Little White Church by the Side of the Road”, is the oldest church building in Blowing Rock. All guests of BRCC are invited to conduct their own worship services during our warmer weather months of May – October in this small, white, simple frame building with its gable roof. Mount Bethel Church is located a short distance from our campus, at 1211 Goforth Road. The church does have electricity, but there are no restroom facilities. Parking space is limited, so you may want to investigate options for shuttling guests to and from the church. Mount Bethel Church will seat about 100 people.

## Meditation Chapel

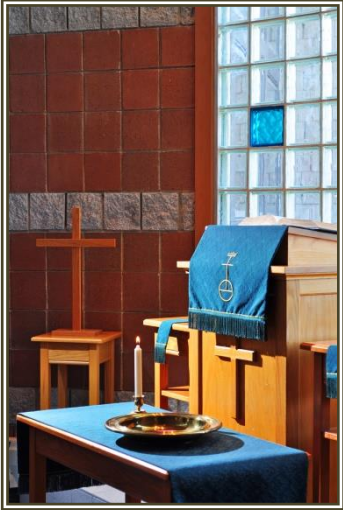

All our guests are welcome to visit this pretty South Corriher Lodge, with its glass block stained glass door. It is a perfect spot for reflection or for intimate worship services or

The chapel will seat 20-25, and is located just Lobby in Corriher Lodge. There is a piano your use.

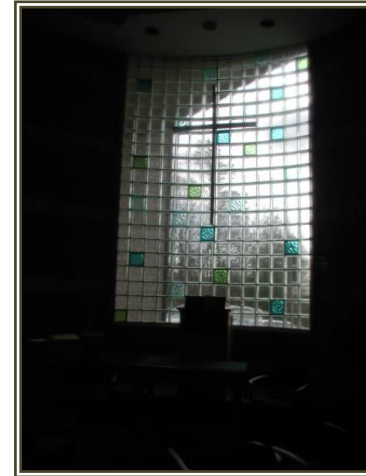

little chapel in windows and quiet weddings.

off the South available for

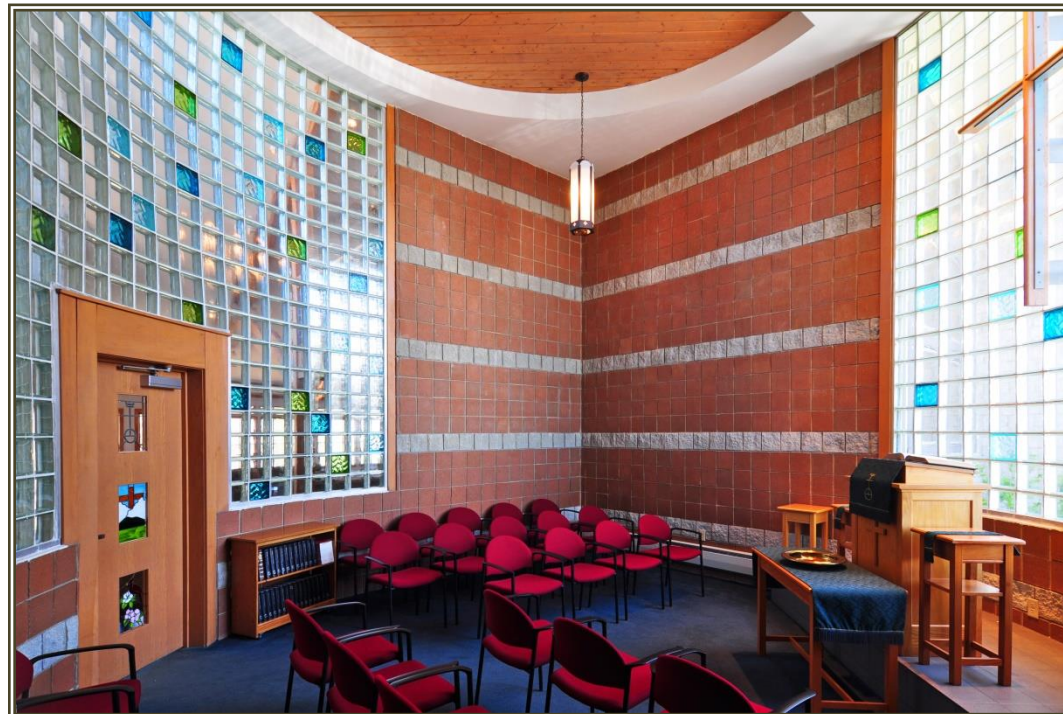



# Shuford Outdoor Chapel



**The Shuford Outdoor Chapel** is perfectly suited for your morning watch or evening vesper services, or a beautiful wedding in a natural setting.

This pleasant outdoor gathering area will seat 90 people, but is just as suitable for solitary meditation or a small-group discussion, and is located off the northwest side of Corriher Lodge.



## The Yvonne Handschuh Brown Memorial Garden

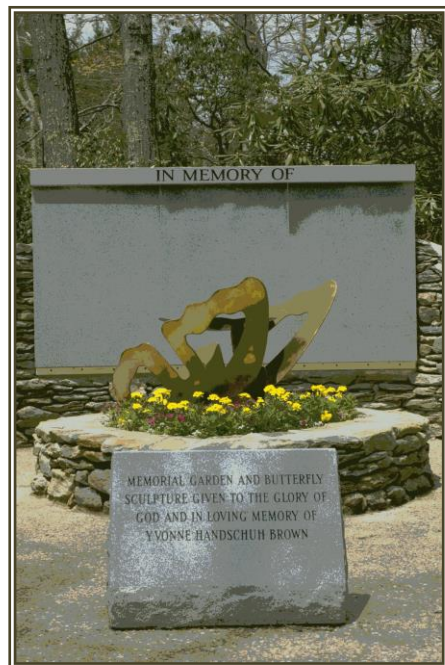

Our Memorial Garden is set in a lovely location amongst the rhododendron between Shuford Cottage and the Shuford Outdoor Chapel, just a short walk from Corriher Lodge. The Yvonne Handschuh Brown Memorial Garden and the butterfly sculpture are a gift from the family of Mr. James Brown of Burlington, in remembrance of his wife, Yvonne.

The primary purpose of the BRCC Memorial Garden is to provide a place for memorials and/or the interment of ash remains for friends of the BRCC, their families and other interested persons.

The Memorial Garden is also intended to be a place for rest, meditation, and prayer where persons can go in the beauty of God's world to experience the spiritual presence of "those who have passed this way before." The Memorial Garden is a quiet spot that is easily visited, yet set apart from view.







## Leonard Dining Room

**Leonard Dining Room**, with its spectacular view of Grandfather Mountain and beautiful stone fireplace, is located in Corriher Lodge. We take pride in offering tasty home-style meals, served buffet-style in a friendly atmosphere for groups of 20-175.

BRCC offers groups the flexibility to decide which meals they would like in their meal package. We serve breakfast, lunch and dinner, and also offer sack lunches or suppers for groups on the go.

Groups wishing to have break refreshments or snacks prepared for them are sent an order form in advance of their event, with choices for food and beverage items in different prices ranges to fit any budget.

### Meal Times

Breakfast	8:00-8:45
Lunch	12:00-12:45
Dinner	6:30-7:15

We also offer an “Early Bird” breakfast during ski season.





## On-Site Recreation

The Blowing Rock Conference center offers a variety of recreation opportunities such as basketball or volleyball in our gymnasium, a mini-putt golf course, bean-bag toss games and walking paths. Our indoor pool is available Memorial Day weekend through Labor Day weekend. A large activity field is available for group games, and we have two camp fire areas with benches, available May – October. A half-court basketball area is located just outside Clapp Gymnatorium, and outdoor volleyball is available during our June – August summer season.

Our high ropes Discovery Course is available year-round for half or full day programs. The Discovery Course program is facilitated by our partner organization, High Gravity Adventures, whose instructors are professional outdoor educators with many years of experience working with people of all ages and walks of life. High Gravity Adventures also offers programs at BRCC using team building activities and our climbing wall, located in our gymnasium.

For more information about High Gravity Adventures and their programs, visit their website at [www.brlc.net](http://www.brlc.net).

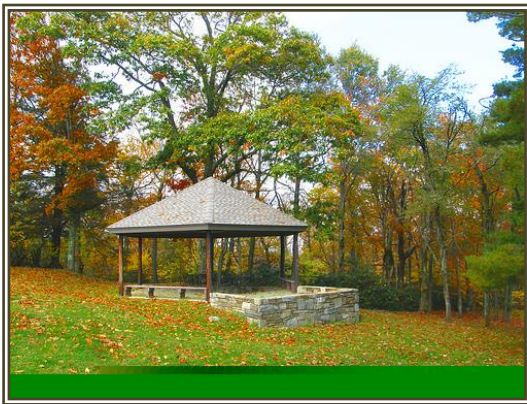

The **pavilion** (*pictured left*) is located between the Corriher Lodge parking lot and the Discovery Course.

# The Ken Clapp Gymnatorium

This multi-purpose building has a full-size gymnasium, restrooms, a large lobby and a meeting room that can accommodate 20 people. The gymnasium is a popular spot for basketball and volleyball. The climbing wall in the gymnasium is available for group programs through High Gravity Adventures. For information about availability and pricing, call them at 828-265-5467.

Our gymnasium can also be set up as a large group meeting space that can accommodate up to 350 people. Wi-Fi is available in the building. Set up with staging and a sound system, it becomes a very effective venue for worship, skits or plenary sessions.

There is a half-court basketball just outside the Gymnatorium and the activity field nearby is available for group games. One of our two campfire area with benches is located just a short walk away.

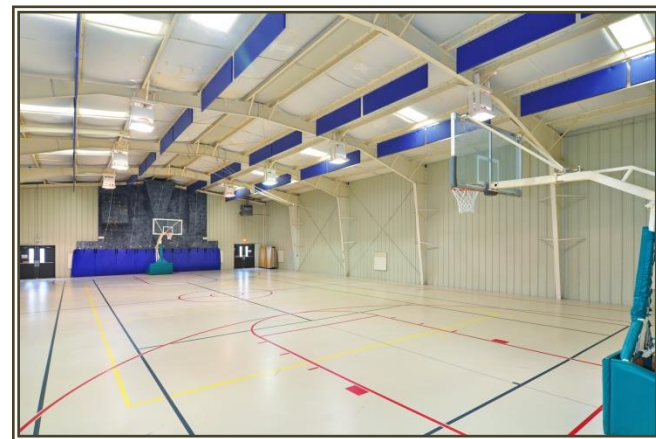
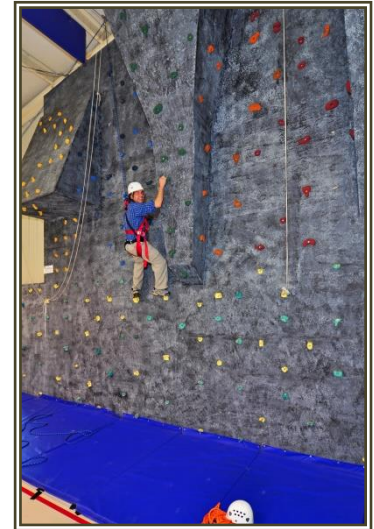

# Swimming Pool

**BRCC's indoor heated swimming pool** is open June 1-August 31. Because BRCC does not provide a lifeguard, adult supervision is required for all youth groups/children. **Reservations must be made in advance.**





# 2017 Rates

## Blowing Rock Conference Center, Inc.

---

**Corriher Lodge:** *Rates are per room, per night and do not include meals. Rates are subject to change. During months when a two night minimum is in force, that minimum may be waived for groups reserving fewer than 60 days in advance. Taxes, when applicable, are additional.*

### NON-PRIME SEASON: January 1 – May 31 and November 13-December 31

WEEKEND AND MIDWEEK RATES. 2 NIGHT MINIMUM JANUARY & FEBRUARY WEEKENDS.			
<u>North Corriher Lodge</u>			
<u>Single</u>	<u>Double</u>	<u>Triple</u>	<u>Quadruple</u>
\$80.00	\$95.00	\$115.00	\$130.00
<u>South Corriher Lodge</u>			
<u>Single</u>	<u>Double</u>	<u>Triple</u>	<u>Quadruple</u>
\$85.00	\$100.00	\$120.00	\$140.00

### PRIME SEASON: June 1-November 12

WEEKEND RATES. 2 NIGHT MINIMUM JUNE, JULY, SEPTEMBER & OCTOBER WEEKENDS			
<u>North Corriher Lodge</u>			
<u>Single</u>	<u>Double</u>	<u>Triple</u>	<u>Quadruple</u>
\$90.00	\$105.00	\$125.00	\$140.00
<u>South Corriher Lodge</u>			
<u>Single</u>	<u>Double</u>	<u>Triple</u>	<u>Quadruple</u>
\$95.00	\$110.00	\$130.00	\$145.00
MID-WEEK RATES (Sunday – Thursday nights) 2 NIGHT MINIMUM DOES NOT APPLY TO MIDWEEK RESERVATIONS			
<u>North Corriher Lodge</u>			
<u>Single</u>	<u>Double</u>	<u>Triple</u>	<u>Quadruple</u>
\$80.00	\$90.00	\$110.00	\$130.00
<u>South Corriher Lodge</u>			
<u>Single</u>	<u>Double</u>	<u>Triple</u>	<u>Quadruple</u>
\$90.00	\$100.00	\$120.00	\$140.00

### **Cottages (A, B, C and D):**

A two night minimum applies for weekends in January, February, June, July, September, and October. For groups reserving fewer than 60 days in advance the two night minimum can be waived.

Rates are year round and do not include meals. Rates are subject to change. Taxes, if applicable, are additional.

<b>Nightly Rate, per Cottage</b>	\$180.00 the first night and \$155.00 each additional night.
<b>Special Weekly Rate, per Cottage</b>	\$550.00 Friday – Friday; each additional night \$120.00

### **Youth Lodging: Rowe Dorm, Southern Conference Youth Center and Calvin Cottage**

A two night minimum applies for weekends in January, February, June, July, September, and October. For groups reserving fewer than 60 days in advance the two night minimum can be waived.

There is a minimum charge for 13 guests for Calvin Cottage and the Southern Conference Youth Center.

\$29.00 per person per night.

Rates are year round and do not include meals, and are subject to change.

**Please note: Youth group rates (rates for Calvin Cottage, Southern Conference Youth Center, and Rowe Dorm) do not apply to youth groups staying in Corriher Lodge or Cottages A, B, C or D; that rate is \$35.00 per person, per night.**

## Meals

Meals are served in the Leonard Dining Room in Corriher Lodge. All groups, unless they are staying in Calvin Cottage or Cottages A, B, C & D, must use Leonard Dining Room meal service or go off site for meals. Rates are per person. There is no charge for children under the age of 5. These rates are subject to change.

	<b><u>Age 5-12</u></b>	<b><u>Age 13+</u></b>
Breakfast	\$6.25	\$9.25
Early Bird Breakfast ( <i>available ski season only</i> )	\$5.25	\$7.75
Lunch	\$6.75	\$10.25
Dinner	\$7.75	\$11.75
Sack lunch or supper	\$6.25	\$8.75

### **Banquet/Reception Meals** Will be priced according to menu selected

	<b><u>Age 5-12</u></b>	<b><u>Age 13+</u></b>
Banquet/Reception meal	\$12.75 minimum	\$17.75 minimum

Other options such as punch and appetizers are available. Per person price for special requests are based on food and beverage choices. We do not serve alcoholic beverages. All meals are served buffet-style. Final payment is due two weeks prior to the meal. Table cloths are available for a \$5.00 per table fee. Additional rental fee for the dining room may apply.



# Miscellaneous Food Services

Rates are subject to change

Taxes may apply

**Coffee Service:** Basic coffee service can be provided in a group's meeting room for \$2.25 per person. Regular and decaf coffee, hot water and associated tea bags are included.

**Basic Refreshment Break:** \$3.00 per person. Choose one of the following items to be added to Basic Coffee Service:

*Mini Muffins	*Large Muffins	*Danish	*Goldfish Crackers	*Pretzels
*Fruit Tray	*Vegetable Tray	*Snack Mix	*Fresh Baked Cookies	

**Extended Refreshment Break:** \$5.00 per person. Choice of three items from each category:

## Provisions:

*Mini Muffins	*Large Muffins	*Danish	*Goldfish Crackers	*Pretzels
*Fruit Tray	*Vegetable Tray	*Snack Mix	*Fresh Baked Cookies	

## Beverages:

*Regular & Decaf Coffee	*Hot Tea	*Iced Tea	*Canned Soda
*Orange Juice	*Bottled Water	*Lemonade	

**Premium Refreshment Break:** \$7.00 per person. Choice of four items from each category:

## Provisions:

*Mini Muffins	*Large Muffins	*Danish	*Goldfish Crackers	*Pretzels
*Fruit Tray	*Vegetable Tray	*Snack Mix	*Fresh Baked Cookies	*Cheese & Crackers Tray
*Mini Sandwiches				

## Beverages:

*Regular & Decaf Coffee	*Hot Tea	*Iced Tea	*Canned Soda	*Apple Juice
*Orange Juice	*Bottled Water	*Lemonade	*Cranberry Juice	*Hot Chocolate
*Hot Cider				

## Meeting/Conference Rooms

### Conference/Facilities Fee:

A portion of this fee will be applied to Blowing Rock Conference Center's Endowment Fund. This fee also applies to individuals attending an event but not staying at BRCC (commuters). Tax, if applicable may be added.

Length of Event	Conference Fee
One Day Event	\$10.00 per person age 5+
Two Day Event	\$11.00 per person age 5+
Three Day Event	\$12.00 per person age 5+
Four Day Event	\$13.00 per person age 5+
Five Day Event	\$14.00 per person age 5+
Six Day Event	\$15.00 per person age 5+
Seven Day Event	\$16.00 per person age 5+
Eight Day Event	\$17.00 per person age 5+
Nine or More Days	\$18.00 per person age 5+

### Audio-visual Aids and Other Program Equipment and Services

Audio-visual equipment is available at no charge for each meeting room. Group leaders can contact BRCC in advance to request these items, using the meeting space setup form supplied.

### Banquet/Reception Rooms

Available on a very limited basis. 50% deposit due at time of booking. Final payment is due 30 days prior to the event. Taxes may apply.

Lower Conference Room	\$360.00
Upper Shuford Hall	\$600.00
Leonard Dining Room	\$900.00

## Dedicated Places for Worship

**Reservations are required. These are provided free of charge to guests; for all others, a rental fee applies.** Groups or organizations who wish to rent any of these facilities are encouraged to call BRCC at 828-295-7813 for availability and pricing information.

	<u>Capacity</u>
Mount Bethel Church	90
Shuford Outdoor Chapel	90
Meditation Chapel	25

## Program Facilities

Available by reservation only and at no charge to guests. Groups or organizations who wish to rent any of these facilities are encouraged to call BRCC at 828-295-7813 for availability and pricing information.

Gymnasium

Swimming pool (available Memorial Weekend through Labor Day Weekend)

Camp Fire

## High Gravity Adventure Programs Available On-Site

Available by reservation only: for information on rates and availability call High Gravity Adventures: 828-265-5467

Discovery Course (High Ropes Course)

Climbing Wall

Group Interaction Course



## Miscellaneous Information

**What to bring:** BRCC supplies bed linens (sheets, pillowcases, pillows and blanket) and towels (bath towel and washcloth). You will need to bring your own toiletries, hairdryers, irons, etc.

**Making your reservation:** Once you have decided on a date and where you would like to stay, our Reservations Staff will be happy to help you finalize your reservation plans. You will need to supply a mailing address for your church or organization, telephone number, and other contact information. You'll be asked to tell us how many people will be in your group, how many rooms you wish to reserve, and which meals we should schedule you for. BRCC requires a deposit in order to confirm your reservation. Deposits are due within thirty days after you have made your reservation, and are non-refundable. Deposits are based on the following guidelines:

**Youth Retreats or Events:** \$25.00 per person (estimated attendance at the time the reservation is made).

**Adult or Family Groups:**

Corriher Lodge	\$50.00 per room reserved
Cottages A, B, C or D	\$100.00 per cottage reserved
Calvin Cottage	\$250.00
Rowe Dorm	\$50.00 per room
Youth Center	\$200.00

**Payments:** the final payment for first time groups is due 14 days prior to the beginning of the event; adjustments will be made at the time of arrival if there has been an increase in the number of participants, and an additional invoice will be prepared. For returning groups, payment is due upon your arrival, unless other arrangements have been made in advance (see below). We accept cash, checks, MasterCard, Visa and Discover. We are happy to email an advance invoice to you.

A returning group may request, in advance, for a later payment and may take the invoice or have us email it to them, in which case the balance is due 10 days from the date of the event's ending. A 1.5% surcharge is added every seven days after that date until we receive your payment.

**Refunds and Cancellation Policies:** If a group cancels prior to their deposit due date and has already paid their deposit, a refund of that amount minus a \$10.00 processing fee will be granted.

**Once the deposit due date has passed,** deposits are non-refundable; however, groups that cancel with at least a sixty day notice from their arrival date are given an opportunity to roll-over their reservation one time within the same calendar year, and the entire amount of the deposit received by BRCC will be applied to your future bill.

Groups who have reserved Corriher Lodge rooms have the opportunity to drop rooms without penalty no less than 60 days prior to their arrival; that date is stated in the reservation contract. After that date if the number of rooms dropped exceeds more than 10% of the total number of rooms reserved, there is a \$50.00 penalty per each dropped room.

**Inclement Weather Policy:** If the NC State Highway Patrol deems road conditions to be too dangerous for travel, we will work with groups to reschedule within a twelve month period. The entire amount of the deposit thus far received by BRCC will be applied to that future bill. Or, if the group chooses to proceed with their retreat and arrive the next day after road conditions have improved, the group would be charged only for overnights and meals taken.

**Meals:** Group leaders are required to contact BRCC two weeks prior to their arrival with a guaranteed number of persons taking meals. The group's invoice will be prepared using that number as the minimum for meal charges. The group will be charged in full for meals reserved and not taken. If the group leader fails to call BRCC with a guaranteed number, the estimated number of participants at the time of booking, as stated in the group's reservation contract, will be used as a minimum.

## How to Contact Us

Our Reservations Office is open Monday – Friday from 9 a.m. until 4:30 p.m.

**Phone:** 828-295-7813

**Fax:** 828-295-5066

**Email:** [info@brccenter.org](mailto:info@brccenter.org)