



## SKID STEER SOLID TIRES

ITEM #	TIRE SIZE	REPLACE'S SIZE	RIM	O.D.	S.W.	TREAD	WEIGHT
		PNEUMATIC TIRE					
UNI-071	7.50-16 C2	10-16.5	6.0	31.7	7.70	50/32nds.	152
UNI-071	7.50-16 SM	10-16.5	6.0	31.5	8.26	N/A	172
UNI-180	30x10-20 SM	10-16.5	7.0	30.1	9.84	N/A	150
UNI-180	30X10-20 SKS	10-16.5	7.0	30.1	9.44	50/32nds.	141
UNI-183	33X12-20 SM	12-16.5	7.5	32.3	11.02	N/A	209
UNI-183	33X12-20 SKS	12-16.5	7.5	32.7	11.30	51/32nds.	187
UNI-185	36.5X12-20 SKS	14X17.5	8.0	36.6	11.90	63/32nds.	280
UNI-186	38.5X14-20 SKS	14X17.5/15X19.5	11.0	38.2	13.46	63/32nds.	315

## SOLID WHEEL INFORMATION

ITEM #	TIRE SIZE	# B / H's	PILOT	B / C	OFFSET	TIRE SIZE
UNI-071 WHEEL	16 X 6.00	6	4.65	6.00	1.00	750X16
UNI-180 WHEEL	20 X 7.00	8	6.00	8.00	0.79	30X10-20
UNI-183 WHEEL	20 X 7.50	8	6.00	8.00	0.91	33X12-20
UNI-183 WHEEL	20 X 7.50	8	9.06	10.75	0.50	33X12-20
UNI-183 WHEEL	20 x 8.00	8	6.00	8.00	1.34	33X12-20
UNI-163 WHEEL	24 x 8.50	10	11.00	13.00	0.25	1300X24
UNI-163 WHEEL	24 x 10.0	10	11.00	13.00	3.94	1400X24

- \* FULL SIZE TIRE REPLACEMENT
- \* RELIABILITY & MAINTENANCE FREE
- \* LOWER COST PER HOUR OF OPERATION
- \* APERTURE HOLES = SOFT RIDE
- \* DEEP TRACTION LUGS
- \* AVAILABLE IN A SMOOTH DESIGN
- \* EASY TIRE REPLACEMENT
- \* TIRE & WHEEL ASSEMBLIES AVAILABLE

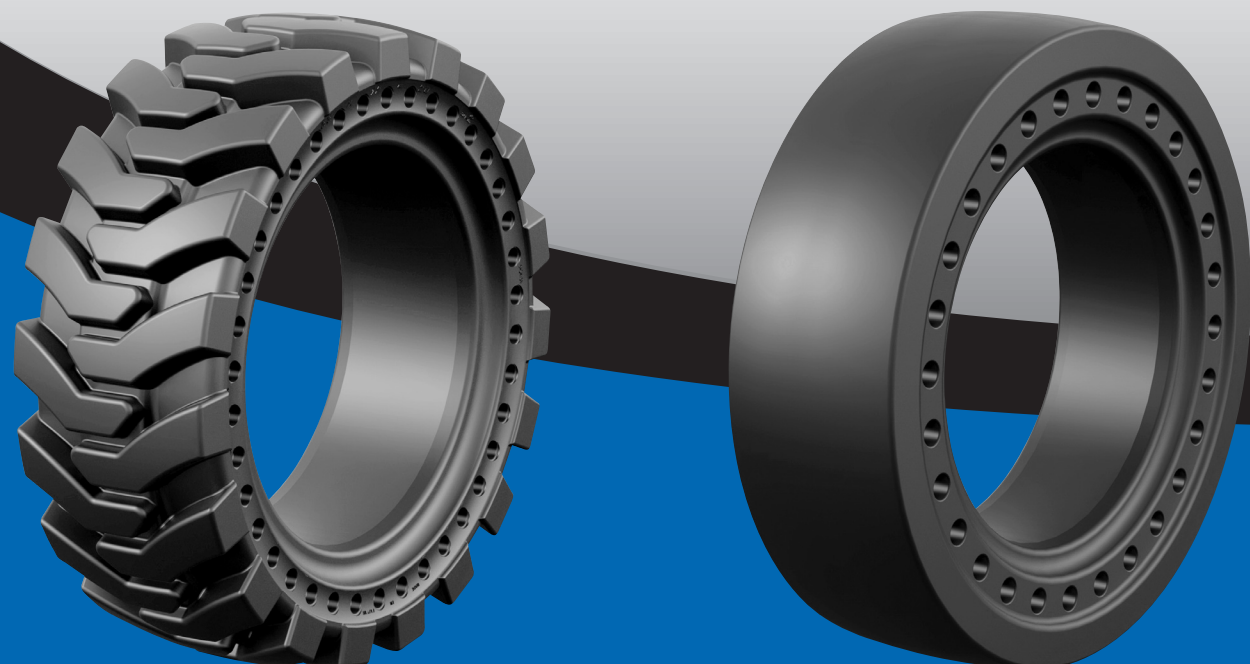

**T.A.I. INDUSTRIAL TIRE**

25 Northwest Point Blvd., Suite 490  
Elk Grove Village, IL 60007  
Tel 800-527-4611  
A Division of Toyota Tsusho America, Inc.

# WHY CHOOSE *UNI-ACE*™ ?

## FORKLIFT TIRE SPECIFICATIONS

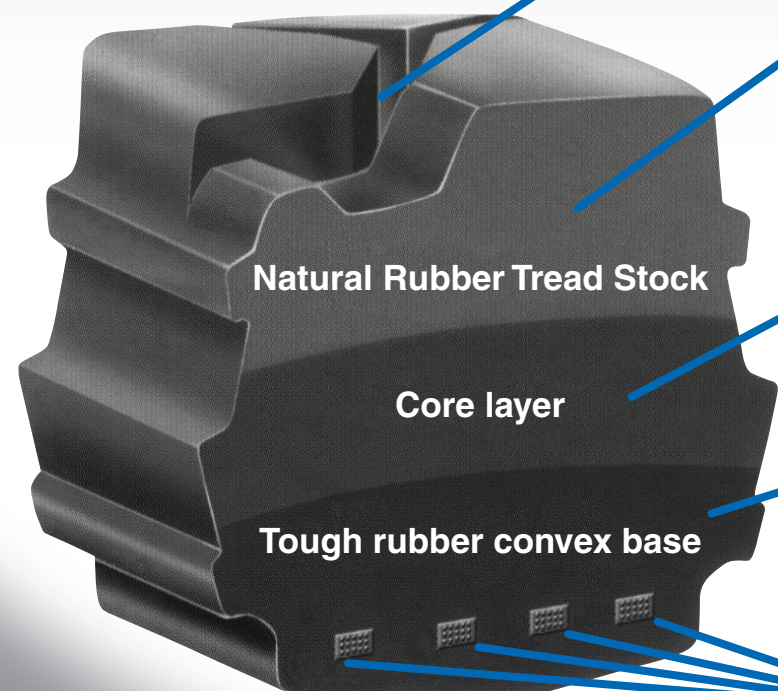

**Aggressive Extra Deep Lug**  
One of the deepest lugs available, the Uni-Ace tire offers maximum traction for the life of the tire.

**Tread Rubber**  
The blend of natural and synthetic rubber provides outstanding abrasion resistance. Our tread compound runs cooler which will extend the life of the tire.

**Core Rubber**  
The special core design will provide a level of comfort comparable to that of a pneumatic tire.

**Base Rubber**  
The rubber base is manufactured with a high durometer rubber mix and is convex in shape. This allows greater stability and grips the wheel.

**Steel Bead Wires**  
The base of the Uni-Ace is reinforced with multiple bead bands that lock onto the wheel. This design is guaranteed **NOT TO SPIN**.

**Natural Rubber Tread Stock**

**Core layer**

**Tough rubber convex base**

### SPECIAL ORDER



C2

SC2



Z-Lug

Rib

ITEM #	SIZE	RIM	PATTERN(S)	DIAMETER	WIDTH	WEIGHT	MAX LOAD
		INCHES		INCHES	INCHES	LBS.	15 MPH
UNI-002	350-5	3.00	C2/RIB	11.5	3.9	13	1102
UNI-003	400-8	3.00	C2/RIB	16.2	3.9	23	1587
UNI-005	400-8	3.75	C2/RIB	16.2	3.9	23	1587
UNI-007	500-8	3.00	C2/SC2/Z LUG	17.8	4.9	37	2358
UNI-146	15X4.5-8	3.00	C2/SC2/Z LUG	15.0	4.6	22	1746
UNI-154	16X6-8	4.33	C2/SC2/Z LUG	16.5	5.7	35	2359
UNI-100	18X7-8	4.33	C2/SC2/Z LUG	18.0	6.5	50	3616
UNI-122	21X8-9	6.00	C2/Z LUG	20.6	7.0	77	4673
UNI-013	600-9	4.00	C2/SC2/Z LUG	21.0	5.9	63	3130
UNI-017	650-10	5.00	C2/SC2/Z LUG	22.6	6.5	79	3924
UNI-145	23X9-10	6.50	C2/Z LUG	23.1	8.5	110	5699
UNI-149	200/50-10	6.50	C2/Z LUG	18.1	7.9	55	4850
UNI-021	700-12	5.00	C2/SC2/Z LUG	26.2	6.8	107	4938
UNI-082	825-12	5.00	C2	28.1	7.5	132	7495
UNI-228	23X7-12	5.00	C2	22.0	6.7	66	3307
UNI-148	23X10-12	8.00	C2/Z LUG	22.8	9.5	107	6393
UNI-144	27X10-12	8.00	C2/Z LUG	26.4	9.7	165	6470
UNI-211	5.50-15	4.50	C2	26.2	6.1	82	3748
UNI-015	600-15	4.50	C2	26.2	6.1	82	3748
UNI-140	250-15	7.00	C2SC2/Z LUG	28.2	9.3	159	7870
UNI-155	250-15	7.50	C2/SC2/Z LUG	28.2	9.3	159	7870
UNI-143	300-15	8.00	C2/SC2/Z LUG	32.3	10.2	247	9722
UNI-123	700-15	5.50	C2	28.3	7.1	137	5930
UNI-230	700-15	6.00	C2	28.3	7.1	137	5930
UNI-127	750-15	5.50	C2	31.7	7.6	172	6569
UNI-109	750-15	6.00	C2	31.7	7.6	172	6569
UNI-030	815-15 / 28x9-15	7.00	C2/SC2/Z LUG	28.0	8.3	139	7595
UNI-033	825-15	6.50	C2/SC2/Z LUG	32.3	8.1	203	8046
UNI-142	28X12.5-15	9.75	C2	28.2	11.1	194	11464
UNI-177	355/65-15	9.75	C2	33.1	13.6	357	13227
UNI-071	750-16	6.00	C2	31.7	7.7	165	5358
UNI-037	900-16	7.00	C2	33.3	9.5	241	9259
UNI-232	28X9-16	6.00	C2	28.2	8.3	126	6613
UNI-035	825-20	6.50	C2/SC2	38.6	8.7	280	8818
UNI-090	900-20	7.00	C2/SC2	38.6	8.7	286	10042
UNI-089	1000-20	7.00	C2/SC2	40.9	9.8	368	10042
UNI-167	1000-20	7.50	C2/SC2	40.9	9.8	368	10042
UNI-153	1000-20	8.00	C2/SC2	40.9	9.8	368	10042
UNI-169	1200-20	8.00	C2/SC2	43.3	11.6	463	12345
UNI-170	1200-20	8.50	C2/SC2	43.3	11.6	463	12345
UNI-162	1200-24	8.00	C2	47.6	12.0	595	15873
UNI-164	1200-24	8.50	C2	47.6	12.0	595	15873
UNI-235	1300-24	8.50	C2	49.2	12.6	710	17637
UNI-165	1400-24	10.00	C2/R LUG	53.2	13.8	893	24735
UNI-171	1400-25	10.00	C2/R LUG	53.2	13.8	882	25463
UNI-174	1600-25	11.25	C2/R LUG	59.1	16.2	1312	18739
UNI-176	1800-25	13.00	R LUG	63.6	19.3	1852	19841

NOTE \*\*\* CLICK / QUICK STYLE TIRES AVAILABLE AS SPECIAL ORDER