

Asphalt accessible ramp (1.83 wide) per std. detail 02861-15

Engineered Wood Fibre (300mm compacted depth) & wear mats per Std. Detail 02861-2-3

EX. ASPHALT PATHWAY

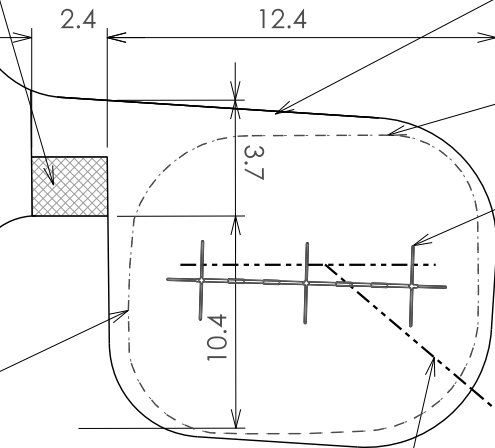

Playground pit drain tile per Std. Detail 02861-2-3

Existing playground sand play to remain undisturbed

Sump per std. detail 02861-3

Proposed playground edge

Existing Playground Edge

Existing playground swings to remain undisturbed

ISNA Elementary School Parking Lot

Play Area ± 125 m²
 Play Pit Drain Tile ± 14 m
 Trench Subdrain ± 3m

Exact locations, site conditions, utilities to be confirmed by Contractor. Contractor to remove all existing structures as identified on plan or on site by Community Services representative. All areas disturbed by construction to be repaired with topsoil and sod.



PARK # 047
SCALE: NTS
DATE: July 2016
DRAWN BY: J.Wu

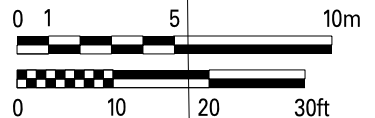

REVISED - July 29, 2016

LAUGHTON HEIGHTS - PLAYGROUND LAYOUT 2