

# FOR LEASE-DAVEY STREET

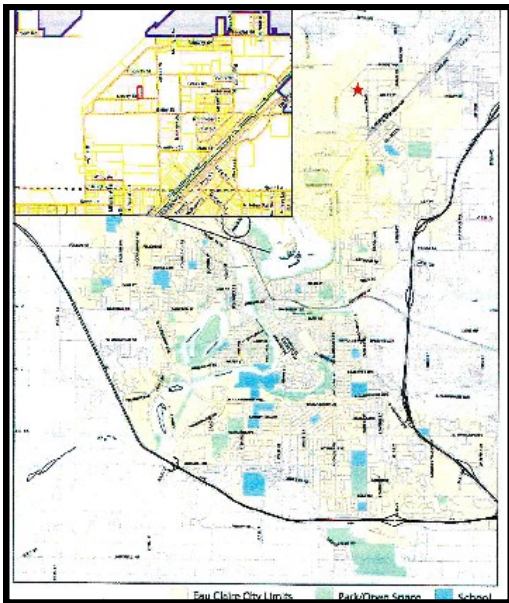

Approximately 14,400 SF of  
Warehouse Space and 300  
SF of Office Space

## **WAREHOUSE AND OFFICE SPACE AVAILABLE Chippewa Valley Industrial Park Eau Claire, Wisconsin**



- Loading Docks
- Competitive Rates
- Forklifts and Operators Available to Unload & Load Your Product
- Exceptionally Clean Facility
- Quick Connection to U.S. 53/Hwy. 29

### **Mid States Development, Inc.**

475 Chippewa Mall Dr., Ste. 335  
Chippewa Falls, WI 54729



### **Contact::**

**DAVID SANDERS**

**715-723-2223 ext 12**

[dsanders@midstatesdevelopment.com](mailto:dsanders@midstatesdevelopment.com)

*"Your Commercial Real Estate Specialists"*

[www.midstatesdevelopment.com](http://www.midstatesdevelopment.com)

# Floor Plan

## APPROXIMATELY 14,400 SF WAREHOUSE AND 300 SF OFFICE SPACE

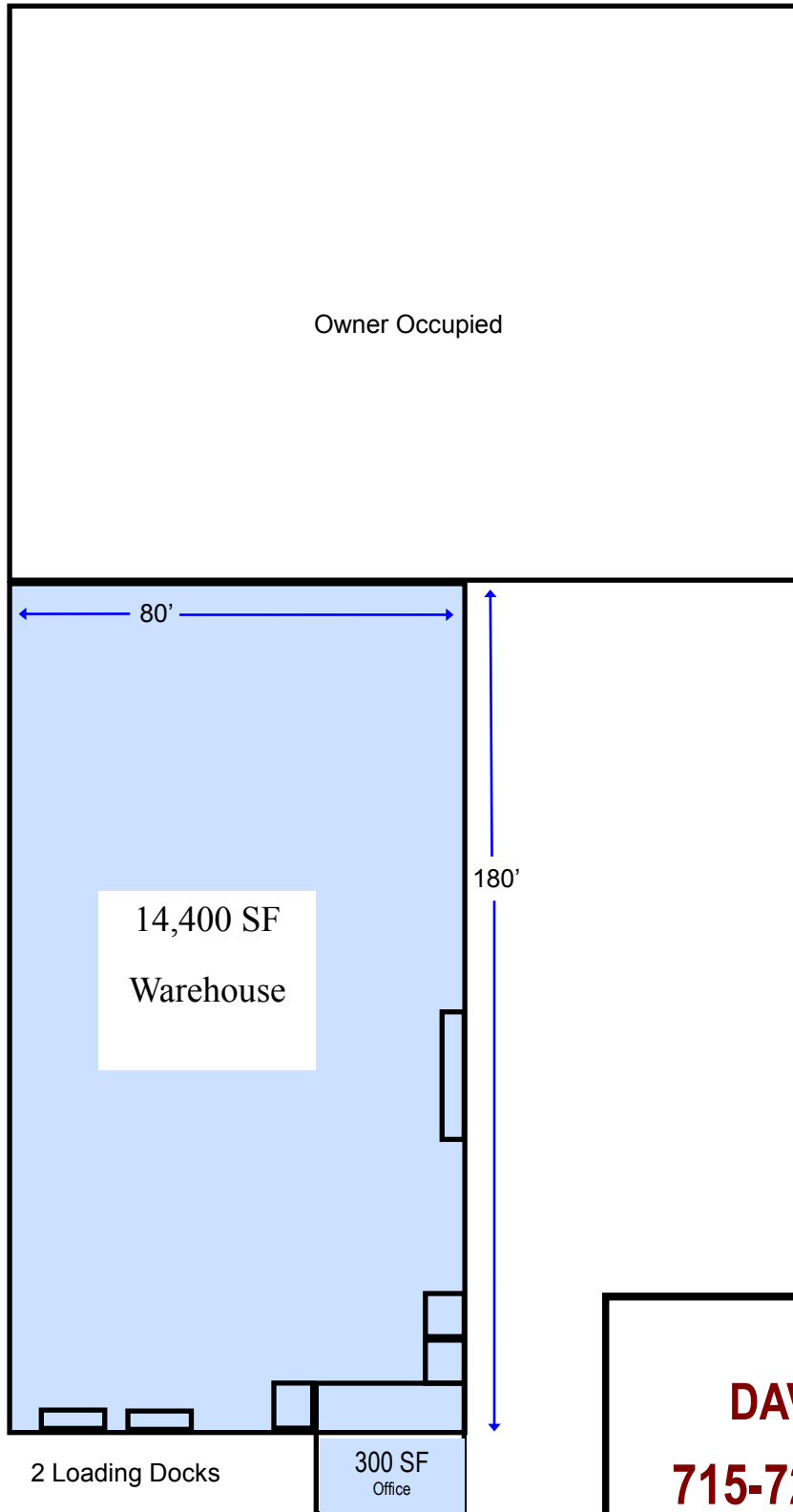

***Contact::***

**DAVID SANDERS**

**715-723[-2223 ext 12**

[dsanders@midstatesdevelopment.com](mailto:dsanders@midstatesdevelopment.com)