



# WINDOW

## SHADINGS

Effective October 8, 2018

*design simplified™*

---

## TABLE OF CONTENTS

---

### Product Overview

- Features & Benefits ..... 2
- Collection Information (includes Light Control) ..... 3-4

### Pricing Groups

- Pricing Group 1 (Standard and Options). .... 5
- Pricing Group 2 (Standard and Options). .... 6
- Motorization Surcharges ..... 7

### Product Specifications

- Features & Options, Cord Loop Drop Chart ..... 8
- Mounting Requirements & Finished Dimensions ..... 9
- Options and Additional Notes ..... 10-12
- Simplicity Rechargeable Motorization: Overview ..... 13
- PowerWand Motorization: Overview. .... 14
- RemoteLift™ 2.0 Product Configuration Specifications. .... 15
- Standard Shading Operation. .... 16
- Retractable Cord and Cordless Shading Operation. .... 17
- Product Components – Standard ..... 18
- Product Components – Retractable Cord ..... 19
- Product Components – Cordless Lift ..... 20
- Product Components – Simplicity Rechargeable Motorization ..... 21
- Product Components – Powerwand™ Motorization ..... 22
- Product Components – Remotelift™ 2.0 ..... 23

### Upsize Common Carrier Delivery

All orders with any quantity of shades or blinds or any continuous valance 96" or more in width are considered upsize. Therefore, a net shipping charge of \$95.00 per order will be assessed.

Upsized orders that require expedited shipping will be quoted and charged accordingly.

Please see General Information for additional freight and shipping charge information.

## FEATURES & BENEFITS



- Three vane sizes complement any window, providing desired view through – available in 2", 2 1/2" and 3" for decorating flexibility.
- Available in translucent and light-dimming vane styles to provide varying degrees of light control.
- Filters out up to 88% of incoming harmful UV rays when open, and up to 99% when closed.
- Covers large window expanses with no visible internal lift cords to detract from their elegant appearance.
- When raised, they completely disappear into the headrail allowing more outside view.
- Standard cord loop, retractable cord control, cordless lift and battery-operated Simplicity Rechargeable, PowerWand, and RemoteLift 2.0 motorization options for operating convenience.
- Cordless lift, Simplicity Rechargeable, PowerWand, and battery-operated RemoteLift 2.0 motorization shades are certified Best for Kids.
- Fabric-covered headrail option for a soft look top to bottom.
- Limited Lifetime Warranty ensures your customers' satisfaction.



# COLLECTION INFORMATION

Family Name	Color Name	Family Code	Color #	Coordinating Hardware Color Number	Coordinating Hardware Color Name	Light Control	Price Group
<b>Classic</b> 2-1/2" Translucent N8	Applesauce	N8	226	551	Worn Leather	B	1
	Beige Glow	N8	203	320	Rich Cream	B	1
	Cashmere	N8	206	320	Rich Cream	B	1
	Cityscape	N8	238	469	Blue Creek	B	1
	Comfy Khakis	N8	199	180	Dove Gray	B	1
	Dried Basil	N8	065	426	Squirrel Gray	B	1
	Dusky View	N8	208	679	Buff Beige	B	1
	French Bread	N8	222	679	Buff Beige	B	1
	Mariner Blue	N8	224	469	Blue Creek	B	1
	Snow Cap	N8	201	661	White Tiara	B	1
	Sun Dream	N8	202	320	Rich Cream	B	1
<b>Coastal</b> 2" Translucent SL2	Foam	SL2	700	885	Flex White	B	1
	Mystery	SL2	761	426	Squirrel Gray	B	1
	Sand	SL2	701	320	Rich Cream	B	1
	Sculpting Clay	SL2	760	180	Dove Gray	B	1
	Seashell	SL2	703	679	Buff Beige	B	1
	Sunrise	SL2	702	320	Rich Cream	B	1
<b>Coastal</b> 3" Translucent SA3	Foam	SA3	700	885	Flex White	B	1
	Mystery	SA3	761	426	Squirrel Gray	B	1
	Sand	SA3	701	320	Rich Cream	B	1
	Sculpting Clay	SA3	760	180	Dove Gray	B	1
	Seashell	SA3	703	679	Buff Beige	B	1
	Sunrise	SA3	702	320	Rich Cream	B	1
<b>Passion</b> 2-1/2" Translucent P9	Classic Cream	P9	254	350	Vanilla	B	1
	Destiny's Dream	P9	253	661	White Tiara	B	1
	Heather White	P9	250	661	White Tiara	B	1
	Hint of Spice	P9	255	319	Earthen Beige	B	1
	Spiced Vinegar	P9	251	320	Rich Cream	B	1
	Touch of Beige	P9	252	320	Rich Cream	B	1
<b>Retreat</b> 2" Light Dimming SR2	Alpine	SR2	300	885	Flex White	C	2
	Antique	SR2	302	329	Summer Linen	C	2
	Faded Gray	SR2	331	551	Worn Leather	C	2
	Nickel	SR2	332	426	Squirrel Gray	C	2
	Sunset	SR2	301	320	Rich Cream	C	2
	Swiss Coffee	SR2	330	656	Golden Straw	C	2
<b>Retreat</b> 3" Light Dimming SR3	Alpine	SR3	300	885	Flex White	C	2
	Antique	SR3	302	329	Summer Linen	C	2
	Ash Gray	SR3	351	426	Squirrel Gray	C	2
	Cloud	SR3	309	320	Rich Cream	C	2
	Coffee Bean	SR3	308	849	Mocha	C	2
	Faded Gray	SR3	331	551	Worn Leather	C	2
	Nickel	SR3	332	426	Squirrel Gray	C	2
	Pebble	SR3	311	810	Mushroom	C	2
	Rock Garden	SR3	350	002	Alabaster	C	2
	Stone	SR3	310	656	Golden Straw	C	2
	Sunset	SR3	301	320	Rich Cream	C	2
	Swiss Coffee	SR3	330	656	Golden Straw	C	2
<b>Slub Style</b> 2-1/2" Translucent N10	Aloe Vera	N10	065	451	Lichen	B	1
	Chiffon	N10	213	320	Rich Cream	B	1
	Honey Roast	N10	222	679	Buff Beige	B	1
	Misty Seas	N10	238	426	Squirrel Gray	B	1
	Seashell	N10	204	320	Rich Cream	B	1
	Sugar Cane	N10	201	661	White Tiara	B	1
	Tea Time	N10	220	319	Earthen Beige	B	1
	Willow Herb	N10	226	551	Worn Leather	B	1

\* Light Dimming fabrics provide category C, opaque light control because even when the vanes are completely closed they DO NOT completely seal off all incoming light. See vane closure diagram on page 12 for a visual reference.

Note: Collections are presented alphabetically. Within each collection colors are also arranged alphabetically



## A. Glare Reducing

Softly filters light and reduces glare. Images, shapes and people can be seen clearly. Provides the least amount of light and shape screening.



## B. Filtering

Filters strong light. Images, shapes and people can be seen with some clarity. Provides a modest degree of light and shape screening.



## C. Shading

Significantly reduces light. Images, shapes and people cannot be seen clearly. Provides a moderate to strong degree of light and shape screening.



## D. Blocking

Dramatically reduces light. Images, shapes and people are not distinguishable. Provides privacy against most all direct light and shape screening (except minimal light that may seep through closed or overlapping opaque/blackout vanes).



## E. Blackout

Blocks out virtually all light (except light that may enter on the sides of the shade) for maximum privacy and darkness.

# COLLECTION INFORMATION

Family Name	Color Name	Family Code	Color #	Coordinating Hardware Color Number	Coordinating Hardware Color Name	Light Control	Price Group
<b>Soft Stripe</b> 2-1/2" Translucent N14	Banana Split	N14	205	350	Vanilla	B	1
	Crème Brûlée	N14	203	320	Rich Cream	B	1
	Ground Ginger	N14	226	551	Worn Leather	B	1
	Honey Butter	N14	222	679	Buff Beige	B	1
	Swan Song	N14	201	661	White Tiara	B	1
	Vanilla Milk Shake	N14	204	320	Rich Cream	B	1
<b>Solitude</b> 2-1/2" Light Dimming M16	Citron	M16	205	350	Vanilla	C	2
	Jute	M16	203	679	Buff Beige	C	2
	Parchment	M16	201	320	Rich Cream	C	2
	Soft Souffle	M16	204	551	Worn Leather	C	2
	Sunlit Crème	M16	202	320	Rich Cream	C	2
	Swan White	M16	200	661	White Tiara	C	2
<b>Sophisticate</b> 2" Translucent SS2	Applesauce	SS2	607	350	Vanilla	B	1
	Blue Wave	SS2	630	469	Blue Creek	B	1
	City Sidewalk	SS2	631	810	Mushroom	B	1
	Eggnog	SS2	605	320	Rich Cream	B	1
	Glacier	SS2	616	661	White Tiara	B	1
	Lily	SS2	601	885	Flex White	B	1
	Mist	SS2	602	661	White Tiara	B	1
	Moonlight	SS2	603	320	Rich Cream	B	1
	Natural Linen	SS2	619	002	Alabaster	B	1
	Opal	SS2	604	320	Rich Cream	B	1
	Pearl Grey	SS2	617	320	Rich Cream	B	1
	Pencil Sketch	SS2	632	426	Squirrel Gray	B	1
	Praline	SS2	609	350	Vanilla	B	1
	Sandstone	SS2	606	319	Earthen Beige	B	1
	Treasure Map	SS2	633	002	Alabaster	B	1
<b>Sophisticate</b> 3" Translucent SS3	Applesauce	SS3	607	350	Vanilla	B	1
	Blue Wave	SS3	630	469	Blue Creek	B	1
	City Sidewalk	SS3	631	810	Mushroom	B	1
	Eggnog	SS3	605	320	Rich Cream	B	1
	Glacier	SS3	616	661	White Tiara	B	1
	Lily	SS3	601	885	Flex White	B	1
	Mist	SS2	602	661	White Tiara	B	1
	Moonlight	SS3	603	320	Rich Cream	B	1
	Natural Linen	SS3	619	002	Alabaster	B	1
	Opal	SS3	604	320	Rich Cream	B	1
	Pearl Grey	SS3	617	320	Rich Cream	B	1
	Pencil Sketch	SS3	632	426	Squirrel Gray	B	1
	Praline	SS3	609	350	Vanilla	B	1
	Sandstone	SS3	606	319	Earthen Beige	B	1
	Treasure Map	SS3	633	002	Alabaster	B	1
<b>Villa</b> 2-1/2" Light Dimming N6	Castle Stone	N6	226	551	Worn Leather	C	2
	Coral	N6	202	320	Rich Cream	C	2
	Cotton	N6	201	885	Flex White	C	2
	Fawn	N6	203	320	Rich Cream	C	2
	Graphite	N6	238	426	Squirrel Gray	C	2
	Island Blue	N6	224	469	Blue Creek	C	2
	Spanish Olive	N6	065	451	Lichen	C	2
	White Sand	N6	213	885	Flex White	C	2

\* Light Dimming fabrics provide category C, opaque light control because even when the vanes are completely closed they DO NOT completely seal off all incoming light. See vane closure diagram on page 12 for a visual reference.

Note: Collections are presented alphabetically. Within each collection colors are also arranged alphabetically



## A. Glare Reducing

Softly filters light and reduces glare. Images, shapes and people can be seen clearly. Provides the least amount of light and shape screening.



## B. Filtering

Filters strong light. Images, shapes and people can be seen with some clarity. Provides a modest degree of light and shape screening.



## C. Shading

Significantly reduces light. Images, shapes and people cannot be seen clearly. Provides a moderate to strong degree of light and shape screening.



## D. Blocking

Dramatically reduces light. Images, shapes and people are not distinguishable. Provides privacy against most all direct light and shape screening (except minimal light that may seep through closed or overlapping opaque/blackout vanes).



## E. Blackout

Blocks out virtually all light (except light that may enter on the sides of the shade) for maximum privacy and darkness.

**2" Translucent**  
Coastal (SL2)  
Sophisticate (SS2)

**2 1/2" Translucent**  
Classic (N8)  
Passion (P9)  
Slub Style (N10)  
Soft Stripe (N14)

**3" Translucent**  
Coastal (SA3)  
Sophisticate (SS3)

**GROUP 1**

WIDTH TO:	24"	30"	36"	42"	48"	54"	60"	66"	72"	76"	84"	90"	96"	102"	109"	120"
HEIGHT TO:																
36"	\$420	472	524	577	628	686	735	789	926	981	1036	1089	1140	1212	1357	1481
42"	440	500	555	615	670	731	789	847	986	1049	1106	1166	1222	1299	1453	1588
48"	468	526	591	651	714	778	846	909	1052	1115	1178	1240	1306	1383	1548	1689
54"	485	553	620	692	760	828	898	976	1114	1182	1250	1322	1394	1480	1660	1812
60"	510	584	655	726	797	881	957	1037	1173	1251	1326	1407	1487	1588	1785	1949
66"	533	612	689	764	847	931	1018	1104	1237	1323	1409	1497	1583	1693	1912	2087
72"	555	640	722	805	894	986	1078	1169	1306	1396	1489	1583	1674	1793	2027	2213
78"	572	660	748	842	932	1028	1123	1223	1366	1468	1563	1663	1754	1884	2133	2328
84"	594	689	780	883	981	1083	1188	1289	1437	1545	1647	1749	1850	1984	2250	2455
90"	619	714	815	924	1028	1139	1246	1353	1506	1616	1728	1836	1944	2083	2362	2577
96"	644	746	849	964	1078	1189	1302	1416	1576	1693	1810	1922	2036	2188	2479	2706
102"	736	853	968	1095	1211	1320	1473	1620	1731	1847	1970	2080	2195	2334	2635	2876
108"	773	896	1018	1152	1272	1391	1549	1707	1821	1946	2070	2192	2312	2457	2775	3030
114"	820	950	1081	1223	1354	1478	1646	1811	1936	2068	2195	2323	2450	2606	2939	3210
120"	883	1018	1160	1309	1445	1583	1761	1938	2070	2212	2355	2487	2625	2790	3147	3436

**STANDARD FEATURES**

- Headrail Size: 3-1/4" x 3-1/16"
- Snap-in Bracket Style
- Cord Tilt & Lift
- Color-Coordinated Hardware

**OPTIONS: EXTRA CHARGE**

- Fabric-Covered Headrail Surcharge . . . . . **add \$42 per shading**
- Hardware Color Substitution Surcharge . . . **add \$24 per shading**
- Cordless Lift Surcharge . . . . . **add \$85 per shading**
- Retractable Cord Control Surcharge . . . . . **add \$75 per shading**
- Retractable Cord Two-on-One Headrail . . . . . **add \$150**
- Motorization . . . . . **see page 7**

**OPTIONS: NO CHARGE – SPECIFY ON ORDER**

- Tilt Only Shadings 6" to 11-7/8" (standard only)
- Two-On-One Headrail – price as 2 separate shades (standard)
- Control Positions (R or L)
- Spacer Blocks
- Extension Brackets
- Hold-Down Brackets
- Back Cover for Inside or End Mounts
- Dust Cover for Outside Mounts

SIZE STANDARDS	Standard Loop	Retractable Cord
Minimum ordered width	12"	12"
Minimum ordered width – tilt only	6"	N/A
Maximum ordered width	120"	120"
Maximum ordered width end mount	48"	48"
Maximum ordered width – tilt only	11-7/8"	N/A
Minimum ordered height	16"	16"
Maximum ordered height – translucent	120"	120"

TWO-ON-ONE HEADRAIL	Standard Loop	Retractable Cord
Minimum ordered width	24"	24"
Maximum ordered width	144"	144"
Maximum height	120"	120"
Center gap	3/8"	3/8"

**Note:** Two-On-One Headrail option not available for end mount applications.

**Note:** Two-On-One Headrail option not available with Cordless Lift, RemoteLift 2.0, PowerWand, or Simplicity Motorization

POWERWAND™ UPGRADE	
Minimum ordered width	21"
Maximum ordered width	120"
Maximum ordered width end mount	48"
Minimum ordered height	12"
Maximum ordered height – Translucent	96"
<b>Maximum Square Feet - Translucent</b>	<b>60</b>

**Note:** Wand available on RIGHT side only.

SIZE STANDARDS	Cordless Lift
Minimum ordered width	18"
Maximum ordered width	84"
Maximum ordered width end mount	N/A
Minimum ordered height	16"
Maximum ordered height – Translucent	84"

**Note:** Two-On-One Headrail option not available with cordless lift

**Note:** End Mount not available with cordless lift

REMOTELIFT 2.0 MOTORIZATION UPGRADE	
Minimum ordered width	12" or 20"***
Maximum ordered width	120"
Maximum ordered width end mount	48"
Minimum ordered height	12"
Maximum ordered height – translucent	120"

\*\*\* Satellite Battery Pack or DC Power Supply = 12" min. Battery Wand = 20" min.

SIMPLICITY MOTORIZATION UPGRADE	
Minimum ordered width	21"
Maximum ordered width	120"
Maximum ordered width end mount	48"
Minimum ordered height	12"
Maximum ordered height – Translucent	96"
<b>Maximum Square Feet - Translucent</b>	<b>60</b>

**GROUP 2**
**2" Light Dimming  
Retreat (SR2)**
**2 1/2" Light Dimming  
Solitude (M16)  
Villa (N6)**
**3" Light Dimming  
Retreat (SR3)**

WIDTH TO:	24"	30"	36"	42"	48"	54"	60"	66"	72"	76"	84"	90"	96"	102"	109"	120"
HEIGHT TO:																
36"	\$464	519	578	636	693	753	808	868	1016	1079	1139	1200	1256	1333	1496	1633
42"	485	552	612	676	740	805	868	931	1088	1153	1217	1282	1345	1427	1595	1741
48"	513	579	651	714	787	856	930	1000	1153	1224	1294	1365	1435	1521	1706	1861
54"	535	610	686	761	830	909	987	1069	1223	1301	1374	1455	1539	1630	1833	2000
60"	560	640	721	799	881	966	1056	1140	1290	1374	1460	1549	1639	1744	1962	2142
66"	585	668	760	846	931	1025	1120	1215	1360	1456	1552	1646	1740	1863	2103	2297
72"	612	702	795	884	984	1088	1183	1283	1435	1539	1640	1740	1837	1972	2257	2464
78"	628	723	824	925	1025	1136	1238	1346	1504	1610	1723	1829	1933	2073	2422	2644
84"	655	760	856	967	1081	1190	1307	1416	1583	1699	1811	2030	2121	2206	2597	2835
90"	683	787	894	1013	1135	1251	1370	1486	1652	1777	1997	2119	2211	2348	2725	2975
96"	780	894	1012	1138	1252	1366	1503	1638	1840	1956	2073	2191	2304	2464	2860	3122
102"	893	1021	1153	1294	1405	1515	1701	1871	2021	2137	2256	2367	2484	2634	3037	3316

**STANDARD FEATURES**

- Headrail Size: 3-1/4" x 3-1/16"
- Snap-in Bracket Style
- Cord Tilt & Lift
- Color-Coordinated Hardware

**OPTIONS: EXTRA CHARGE**

- Fabric-Covered Headrail Surcharge . . . . . **add \$42 per shading**
- Hardware Color Substitution Surcharge . . **add \$24 per shading**
- Cordless Lift Surcharge . . . . . **add \$85 per shading**
- Retractable Cord Control Surcharge . . . . **add \$75 per shading**
- Retractable Cord Two-on-One Headrail . . . . . **add \$150**
- Motorization . . . . . **see page 7**

**OPTIONS: NO CHARGE – SPECIFY ON ORDER**

- Tilt Only Shadings 6" to 11-7/8" (standard only)
- Two-On-One Headrail – price as 2 separate shades (standard)
- Control Positions (R or L)
- Spacer Blocks
- Extension Brackets
- Hold-Down Brackets
- Back Cover for Inside or End Mounts
- Dust Cover for Outside Mounts

SIZE STANDARDS	Standard Loop	Retractable Cord
Minimum ordered width	12"	12"
Minimum ordered width – tilt only	6"	N/A
Maximum ordered width	120"	120"
Maximum ordered width end mount	48"	48"
Maximum ordered width – tilt only	11-7/8"	N/A
Minimum ordered height	16"	16"
Maximum ordered height – light dimming	102"	102"

SIZE STANDARDS	Cordless Lift
Minimum ordered width	18"
Maximum ordered width	84"
Maximum ordered width end mount	N/A
Minimum ordered height	16"
Maximum ordered height – light dimming	84"

**Note:** Two-On-One Headrail option not available with cordless lift

**Note:** End Mount not available with cordless lift

TWO-ON-ONE HEADRAIL	Standard Loop	Retractable Cord
Minimum ordered width	24"	24"
Maximum ordered width	144"	144"
Maximum height	102"	102"
Center gap	3/8"	

**Note:** Two-On-One Headrail option not available for end mount applications.

**Note:** Two-On-One Headrail option not available with Cordless Lift, RemoteLift 2.0, PowerWand, or Simplicity Motorization

REMOTELIFT 2.0 MOTORIZATION UPGRADE	
Minimum ordered width	12" or 20***
Maximum ordered width	120"
Maximum ordered width end mount	48"
Minimum ordered height	12"
Maximum ordered height – light dimming	102"

**\*\*** Satellite Battery Pack or DC Power Supply = 12" min. Battery Wand = 20" min.

POWERWAND™ UPGRADE	
Minimum ordered width	21"
Maximum ordered width	120"
Maximum ordered width end mount	48"
Minimum ordered height	12"
Maximum ordered height – light dimming	84"
<b>Maximum Square Feet</b> – light dimming	<b>50</b>

**Note:** Wand available on RIGHT side only.

SIMPLICITY MOTORIZATION UPGRADE	
Minimum ordered width	21"
Maximum ordered width	120"
Maximum ordered width end mount	48"
Minimum ordered height	12"
Maximum ordered height – light dimming	84"
<b>Maximum Square Feet</b> – light dimming	<b>50</b>

Motorization consists of a **motor, power source, and controller**. Be sure all of these elements are included when determining final price.

**SIMPLICITY RECHARGEABLE OPTIONS: EXTRA CHARGE – SPECIFY ON ORDER**  
USE APPROPRIATE GRID FOR SHADE PRICE, THEN ADD EXTRA CHARGE(S) BELOW.

- Simplicity Rechargeable Motor .....add \$312 per motor
- 5 Channel Remote Control (Black Part #CS5138 or White Part #CS5138W) .....add \$46 each
- Solar Panel (Part #CS52096 Solar Panel & mounting brackets) (Part #02-70-9021 Mounting bracket screws) .....add \$170 each
- PowerWand .....add \$125 each
- Plug-in Charger (Can be used for both Simplicity Rechargeable and PowerWand) (Part #CS5199) .....add \$34 each

**REMOTELIFT™ MOTORIZATION OPTIONS: EXTRA CHARGE – SPECIFY ON ORDER**

- Motorization .....add \$502 per shading
- Remote Control..... Part #2984495100 .....add \$61 each
- Wireless Wall Switch..... Part #2986350100 .....add \$83 each
- Satellite Battery Pack – select with wire length below..... Part #KIT2520
- Satellite Battery Pack – with 15" wire ..... Part #2989899000 .....add \$71 each
- Satellite Battery Pack – with 4' wire ..... Part #2989900000 .....add \$79 each
- Satellite Battery Pack – with 10' wire ..... Part #2989901000 .....add \$91 each
- Satellite Battery Pack – with 20' wire ..... Part #2989902000 .....add \$102 each
- DC Power Supply – select with wire length below..... Part #7806000000
- DC Power Supply – with 15" wire ..... Part #2989899000 .....add \$106 each
- DC Power Supply – with 4' wire ..... Part #2989900000 .....add \$107 each
- DC Power Supply – with 10' wire ..... Part #2989901000 .....add \$112 each
- DC Power Supply – with 20' wire ..... Part #2989902000 .....add \$116 each
- Daisy Chain Adapter – select with wire length below ..... Part #2989875000
- Daisy Chain Adapter – with 15" cable ..... Part #2989899000 .....add \$50 each
- Daisy Chain Adapter – with 4' cable ..... Part #2989900000 .....add \$57 each
- Daisy Chain Adapter – with 10' cable ..... Part #2989901000 .....add \$62 each
- Daisy Chain Adapter – with 20' cable ..... Part #2989902000 .....add \$67 each

Notes: For surcharges on oversize common carrier delivery, express ship program, shipments to Hawaii, Alaska and Puerto Rico, see General Information Section

**MOMENTA APP BRIDGE KIT**

- Momenta App Bridge Kit (includes one Momenta Extender Kit) .....Part #2920072100 (must be submitted as part order).....add \$128 NET Cost
- Momenta Extender Kit.....Part #2920075100 (must be submitted as part order).....add \$47 NET Cost

**Momenta App Bridge Kit (Includes One Momenta Extender Kit)**



**REMOTELIFT 2.0 ORDERING NOTES**

- Specify Inside (IB), outside (OB) or end (EB) mount.
- Specify if optional back cover is desired with inside (IB) mounts or end (EB) mounts.
- Specify if additional spacer blocks or extension brackets are needed for added clearance.
- Specify left- or right-side motor assembly.
- Specify number of remote control units (at least 1 required per order).
- If ordering satellite battery pack, specify wire length (15", 4', 10' or 20').
- If ordering DC power supply, specify wire length (15", 4', 10' or 20').
- Specify if daisy-chain cables are required to daisy-chain 2 or 3 shadings together (requires DC power supply). If ordering, specify wire length (15", 4', 10' or 20')



## PRODUCT SPECIFICATIONS

FEATURES	
# of fabric styles	12
# of Colors	105
Headrail size	3-1/4" X 3-1/16"
Bracket style	Snap-in
Cord loop tilt and lift	Yes, Standard
Raise, lower and tilt with one cord	Yes
Safety cord tensioner	Color Coordinated
Warranty	Lifetime Limited

OPTIONS - EXTRA CHARGE	
Fabric Covered Headrail	Yes
Hardware Color Substitution	Yes
Retractable Cord Control*	Yes
Cordless Lift <small>Not available as Two-on-One headrail</small>	Yes
PowerWand Motorization <small>Not available as Two-on-One headrail</small>	Yes
Simplicity Motorization <small>Not available as Two-on-One headrail</small>	Yes
RemoteLift 2.0 Motorization <small>Not available as Two-on-One headrail</small>	Yes
OPTIONS - NO CHARGE	
Tilt Only (available on standard loop control only)	Yes
Two-On-One Headrail Option <small>Not available with Cordless Lift, PowerWand, Simplicity Motorization or RemoteLift</small>	Yes
Control positions <small>PowerWand and Simplicity RIGHT only</small>	R or L
Spacer blocks	Yes
Extension brackets	Yes
Hold-down brackets	Yes
Back cover (Inside or End Mounts)	Yes
Dust cover (Outside Mounts)	Yes
Cord length (See Cord Loop Drop Chart)	Yes
Specialty shapes	No
Tile cut-out	No

\* Retractable cord will be equal to 2/3 of shading height.

## CORD LOOP DROP CHART

SHADING HEIGHT	CORD LOOP DROP
16" to 26-7/8"	1 ft. (white-only)
27" to 39-7/8"	2 ft.
40" to 59-7/8"	3 ft.
60" to 83-7/8"	4 ft.
84" to 107-7/8"	5 ft.
108" to 120"	6 ft. (white-only)

OPTIONAL CORD DROPS (White Cord Only)	
CORD DROP	INCREMENTS
6' – 12'	6" increments
12' – 16'	12" increments

Note: 18" white only cords available upon request

## MOUNTING REQUIREMENTS

INSIDE MOUNT	
Standard, Cordless, Retractable Cord, Simplicity Motorization, & PowerWand	
Minimum casement depth*	1"
Minimum casement depth*, fully recessed	3-3/8"
Minimum rear fabric clearance	1/8"

OUTSIDE MOUNT	
Standard, Cordless, Retractable Cord, Simplicity Motorization, & PowerWand	
Minimum mounting surface height	1"
Recommended width overlap per side	3"
Minimum rear fabric clearance	1/8"

END MOUNT	
Standard, Retractable Cord, Simplicity Motorization & PowerWand	
Minimum mounting surface depth*	1-1/4"

\* Add 1/4" to minimum depth dimensions if optional back cover is used for inside or end mounts.

INSIDE MOUNT - REMOTELIFT 2.0	Battery Wand	Sat. Bat. Pack
Minimum casement depth*	2"	1-1/4"
Minimum casement depth*, fully recessed	4"	3-1/2"
Minimum rear fabric clearance	1/8"	1/8"

OUTSIDE MOUNT - REMOTELIFT 2.0	Battery Wand **	Sat. Bat. Pack
Minimum mounting surface height	1"	1"
Recommended width overlap per side	3"	3"
Minimum rear fabric clearance	1/8"	1/8"

END MOUNT - REMOTELIFT 2.0	Battery Wand	Sat. Bat. Pack
Minimum mounting surface depth*	2-1/8"	1-1/2"

\* For inside and end mounts an optional back cover and back cover bracket may be ordered. The back cover bracket attaches to the installation brackets.

\*\* Requires 3/4" spacers per installation bracket (included), due to the added clearance required for the battery wand.

## FINISHED DIMENSIONS

Dimensions apply to standard loop control, cordless lift, retractable cord and motorization

NOTE: WIDTH AND HEIGHT MAY VARY  $\pm 1/8"$

INSIDE MOUNT – Standard Deductions	
Headrail unit	1/8" less than ordered width
Fabric width	1" less than ordered width
Fabric width - Cordless Lift	3/4" less than ordered width
Shading height	1/8" less than ordered height

OUTSIDE MOUNT – Standard Deductions	
Headrail unit	ordered width
Fabric width	3/4" less than ordered width
Fabric width - Cordless Lift	5/8" less than ordered width
Shading height	1/8" less than ordered height

END MOUNT – Standard Deductions (not available with Cordless Lift)	
Headrail unit	11/16" less than ordered width
Fabric width	1-1/2" less than ordered width
Shading height	1/8" less than ordered height

TWO-ON-ONE HEADRAIL (not available with Cordless Lift, RemoteLift 2.0, Simplicity Rechargeable, or PowerWand)	
Fabric width	1 1/4" less than ordered width
Gap between fabric panels	3/8"

FABRIC GAP – End Gap to Fabric (Gaps On Each Side)	
Control Side	5/8"
Idle Side	3/8"
Both Sides - Cordless Lift	3/8"

## OPTIONS

### RETRACTABLE CORD

Raise, lower and tilt shadings with one retractable cord. The cord length remains constant when shading is raised or lowered, making it ideal in homes with children or pets. Cord length will be equal to 2/3 of the shading height and may be shortened for enhanced child safety.

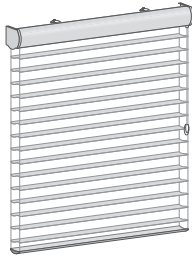

### TWO-ON-ONE HEADRAIL

Cover patio doors and other large expanses by placing two independently operated shades side-by-side on the same headrail. Note there will be a 3/8" light gap between the two shades, see minimum/maximum requirements under product specification section.

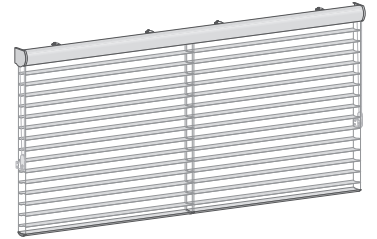

### CORDLESS LIFT

Raise, lower, and tilt shadings with cordless lift. A great choice for homes with children and pets, the lift, lower, and tilt mechanism are all controlled by the clear plastic handle attached to the bottomrail.



With your thumb on the front of the handle and fingers on the back, gently pull down to lower the shading. The hinged handle elegantly retracts when released. Continue pulling on the handle to lower the shadings and open the vanes.

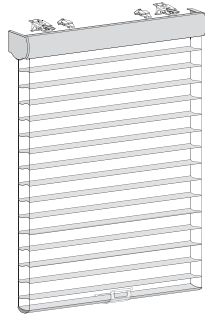

To close the vanes and raise the shades, gently pull down on the handle (about 1") and release. The vanes will close and then the shading will retract into the headrail.

### TILT ONLY SHADING

Ideal for sidelights or narrow windows.

- Shading cannot be raised, it can only be tilted open or closed.
- Hold down brackets are used to secure the bottomrail.

### FABRIC-COVERED HEADRAIL

Features a coordinating fabric wrapped onto the headrail to provide a soft fabric look from top to bottom. (See surcharge on pricing pages)

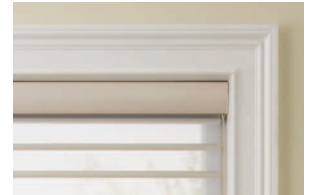

## OPTIONS

### OPTIONAL BACK COVER (INSIDE MOUNT)

Used with inside mounts to conceal the open rear side of the headrail for a more pleasing exterior look. Use of the back cover adds 1/4" to minimum inside mounting depths.

#### MINIMUM INSIDE MOUNTING DEPTH

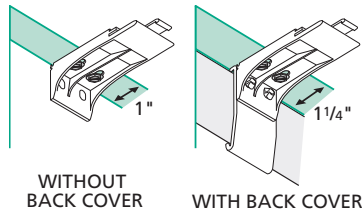

The back cover is secured in place by a back cover bracket attached to the installation bracket.

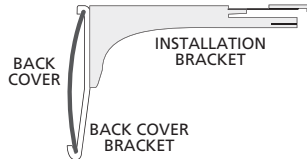

### OPTIONAL DUST COVER (OUTSIDE MOUNT)

Shields the fabric and internal headrail components from dirt, dust, and other contaminants.

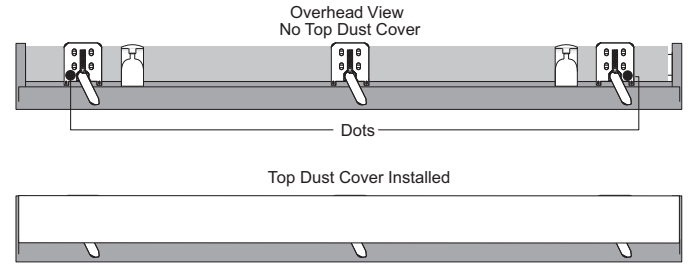

### SIDE-BY-SIDE VANE ALIGNMENT

When window shadings are installed side by side, vane alignment can be guaranteed within 1/4" only if:

- Shadings are ordered at the same time and in the identical style, color and height.
- Shadings that need to be aligned are specified on the order form (a note must be included in Special Instructions).

Note: Vane alignment cannot be guaranteed for Two-On-One Headrail and motorized shadings combined on the same order.

### BACK COVER BRACKET

When a back cover is used, attach back cover brackets to the installation brackets before mounting them. Remove the tab from the top of the back cover brackets and both tabs at the rear of the installation brackets.

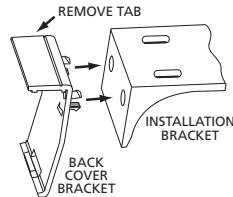

After mounting the installation brackets, install the back cover.

### ADJACENT SHADINGS

To span wide window openings, window shadings may be installed adjacently, so their headrails abut. The gap between the fabric panels of the adjacent shadings varies according to the control placement, as shown in the table below.

CONTROL PLACEMENT	
Adjacent (Abutting) Window Shadings	
Left/Right Shadings	Center Gap
Right/Right Controls	3/4"
Left/Left Controls	3/4"
Right/Left Controls	1-1/16"
Left/Right Controls	1/2"
Window shadings are not recommended for bay windows or butt-and-pass applications.	



## ADDITIONAL NOTES

### SHADING ADJUSTMENT

Shadings should wind evenly and not skew to one side.

A balance weight on the bottomrail can easily be adjusted if the fabric winds unevenly on the roll when the window shading is raised. Uneven winding can cause damage to the edge of the fabric.

- If skewing does occur:
  - Ensure headrail was installed level; shim if necessary.
  - To release, insert a flat blade screwdriver into the weight lock and turn clockwise.
  - Adjust placement of weight in bottomrail, 1" at a time, toward side where fabric is gathering.
  - Secure the weight locks in position by turning them counter clockwise, after making the adjustment.
  - Raise shade, then lower, if necessary, adjust again.

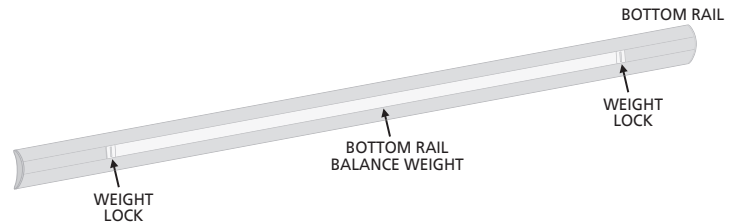

### SHADING INSTALLATION

To mount the shading, insert the top of the headrail into the brackets between the locking tab and the bracket flange. Push the headrail into the brackets until the locking tab clicks in place.

To remove the shading, lift the locking tab to release the headrail, rotate the headrail forward, and pull it straight out.

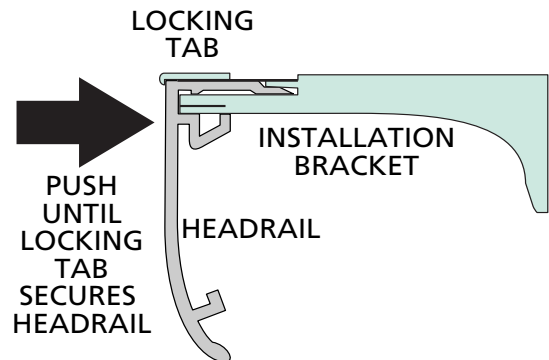

### MAGNETIC HOLD-DOWN BRACKETS

Magnetic hold-down brackets secure the bottom of the shading to prevent swaying. Available upon request. Standard on tilt-only shadings.

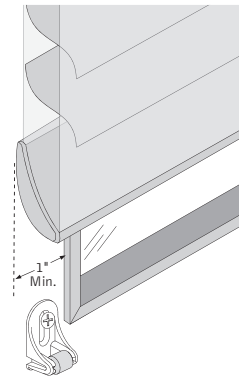

## SIMPLICITY RECHARGEABLE MOTORIZATION: OVERVIEW

### Simplicity Rechargeable

- The Rechargeable Simplicity motor program features an integrated rechargeable lithium ion battery in the motor casing and is fully concealed by the inner tube.
- Rechargeable battery is included with the motor. The average battery charge will last 6-12 months based on an average sized shade raised and lowered once per day. The life of the battery charge will vary based on the type of window covering selected, the size and weight of the window covering and the number of times the shade is operated on a daily basis. The battery can be recharged up to 500 times. It takes approximately 5 hours to recharge the motor when fully depleted. (Charging port available on the right side only)

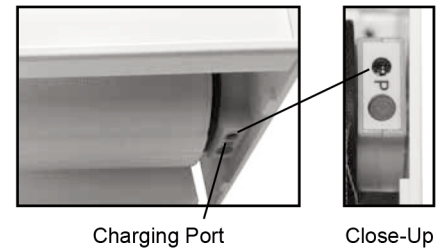

### Battery Charger

- An 8.4 Volt charger requires a standard power outlet to recharge the battery. The charger must be specified when ordering Simplicity Rechargeable Motorized shade option. The charger plugs into the charging port of the motor. The charger is black and comes with a 156" wire. The dimensions are 1" wide x 2-1/2" length x 1-3/4" deep. Sold separately.



### Solar Panel Recharge Option

- Plugs in to any Simplicity Rechargeable motorized shading (does not work with PowerWand). Provides constant trickle charge to 7.4v Li-ION Rechargeable battery packs. Does not require direct sunlight, but performs best in regular direct sunlight applications. Will prolong the life of the charge of the 7.4v rechargeable battery packs, and in some applications will maintain charge indefinitely.
- Life of charge is subject to application variables such as size and weight of shade, frequency of use, amount of direct sunlight exposure, etc.



Dimensions of panel  
18½" x 1½"

### 5 Channel Remote

- The remote can operate up to five shadings simultaneously, individually or in groups. Remotes and holders are available in white or black. The remote comes with a holder which can be mounted to a wall for easy storage. The range of the remote is approximately 80 feet.



Please Note:

- Not all motors run at the same rate of speed.
- Simplicity motors have a "Favorites" position setting. To set a "Favorites" position, follow instructions provided in the installation instructions.

## POWERWAND MOTORIZATION: OVERVIEW

### PowerWand™ Motorization

- Shadings can be fabricated with the PowerWand Rechargeable Push Button Control option. The PowerWand Rechargeable option is an easy, cord free motorized operation for the budget savvy homeowner. PowerWand Rechargeable uses Simplicity motors and components.

### PowerWand Rechargeable Shades Operation

- Press the up or down button on the pendant to raise or lower the shading to your desired position. No programming is required with PowerWand as upper and lower limits are set at the factory. If desired, upper and lower limits can be adjusted in the field.
- Please refer to the installation instructions for instructions on resetting the upper and lower limits and setting a favorites position can be programmed on-site.

### PowerWand Appearance

- The PowerWand Rechargeable wand and pendant is attached to the head rail and requires no additional mounting.
- The wand and pendant hangs down the front of the shades from the head rail.
- Pendant is 2-1/2" long.
- The pendant does not need to be mounted to the wall to operate the shade.

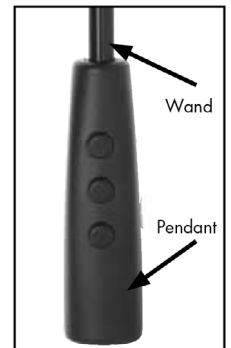

### PowerWand Options

- Wand is available in Black or White (there is no default).
- Wand is available in 1 foot increments from 1 to 5 feet (there is no default).
- Wand is available on the right side of the shade ONLY.

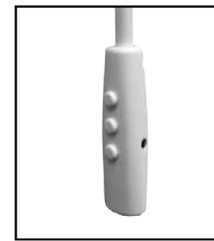

### PowerWand Battery Life

- The battery life will vary based on the type of window covering selected, the size and weight of the window covering and the number of times you operate the blind on a daily basis.

### Battery Charger

- 8.4 Volt charger requires a standard power outlet to recharge the battery. The charger must be specified when ordering the PowerWand motorization option. The charger plugs into the charger port on the side of the pendant. The charger is black and comes with a 156" wire. The dimensions are 1" wide x 2-1/2" length x 1-3/4" deep.



# REMOTELIFT™ 2.0 PRODUCT CONFIGURATION SPECIFICATIONS

RemoteLift 2.0 combines IR and RF wireless signals to control your window shadings. By using both line-of-sight (infrared technology) and "out-of-sight" (radio frequency technology), your customers achieve more operating flexibility. RemoteLift 2.0 operates one window at a time or a group of windows, even in multiple rooms.

- Quieter, more robust motor for raising, lowering and tilting shadings
- Ideal option for hard-to-reach windows behind furniture, above counters, in high foyers, etc.
- Enhanced safety in homes with children and pets
- State-of-the-art convenience; multiple options allow even further customization of window shadings
- Battery-powered system is easy to install and requires no additional wiring



## REMOTELIFT 2.0 SYSTEM OPTIONS

### BATTERY WAND

Battery wands are the standard power source whether inside (IB), outside (OB) or end (EB) mount, if applicable. Battery wands are mounted on the rear of the headrail. The redesigned battery wand will allow for batteries to be changed without removing the window covering from the window.

- 12 AA 1.5V alkaline batteries.
- Battery life exceeds one year, depending on usage.
- Replace batteries when the window covering(s) begin to operate slowly.



18V Battery Wand

### SATELLITE BATTERY PACK

The satellite battery pack is an optional power source. The battery pack connects to the same side of the headrail where the receiver eye or satellite eye is located. The satellite battery pack is the best choice when the window covering is mounted in a high window, restricting access to a battery wand.

- 18V satellite battery pack:
  - Available in 15", 4', 10' and 20' wire lengths.
  - 12 AA 1.5V alkaline batteries.
- Battery life is approximately one year, depending on usage.
- Replace batteries when the window covering(s) begin to operate slowly.
- Mounting options: top of headrail, next to molding or under the sill.
- Satellite battery pack cover can be painted.



18V Satellite Battery Pack

### DC POWER SUPPLY

The DC power supply is an optional power source. The DC power supply plugs into any standard household outlet.

- 18V DC power supply:
  - Available in 15", 4', 10' and 20' wire lengths.
- Eliminates need to change batteries.



18V DC Power Supply

## DAISY CHAIN

The optional Daisy Chain Adapter allows up to 3 shades to run off of one DC power supply. You must specify the cable wire length when order is placed.

Note: Keep in mind which side the sensor eye is positioned on each side when determining daisy-chain length.



Daisy-Chain Adapter/Connector



# STANDARD SHADING OPERATION

## STANDARD SHADING OPERATION

Shadings are operated using a continuous cord loop. As shown in the illustration below, from the fully raised position [1] pulling down on the rear half of the cord loop lowers the shading [2, 3]. After it is fully lowered, continuing to pull down on the cord pivots the bottomrail and opens the fabric vanes [4]. When the vanes are fully open [5], limit stops in the headrail prevent further movement in that direction.

With the fabric vanes fully open, pulling down on the front half of the cord loop first closes the vanes [6, 7] and then raises the window shading [8]. When it is fully raised [1], limit stops again halt shading movement, preventing the bottomrail from being retracted too far into the headrail.

## Light Control

With the shading in the fully lowered position, the continuous cord loop is used to adjust the fabric vanes from open to closed, and anywhere in between. Light control is at your customer's fingertips. (Note: The degree of maximum vane closure varies slightly from the top to the bottom of the shading.)

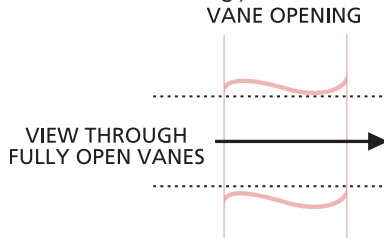

## Vane Opening

Vane opening is the amount of unobstructed visibility between fully open vanes when looking through the shading at eye level. Vane opening for shadings is 1" to 1-1/2" depending on vane size and opacity.

## Vane Closure

When the vanes of a window shading are closed, they overlap each other, blocking the view. However, the vanes do not contact each other along the full length of the shading – they do not form a perfect seal against light leakage. This is most visible toward the bottom of the shading.

Vane closure is measured as the distance between the front and rear fabric facings 6" up from the lowest point of the bottomrail, with the shading fully lowered and the vanes closed, as illustrated here. Vane closure is 5/8" for shadings under 96" in height and 7/8" for shadings over 96" in height.

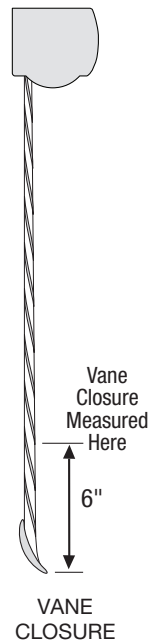

**PLEASE NOTE:** Cord tensioner MUST be mounted to window casement or wall in order for the shade to operate.

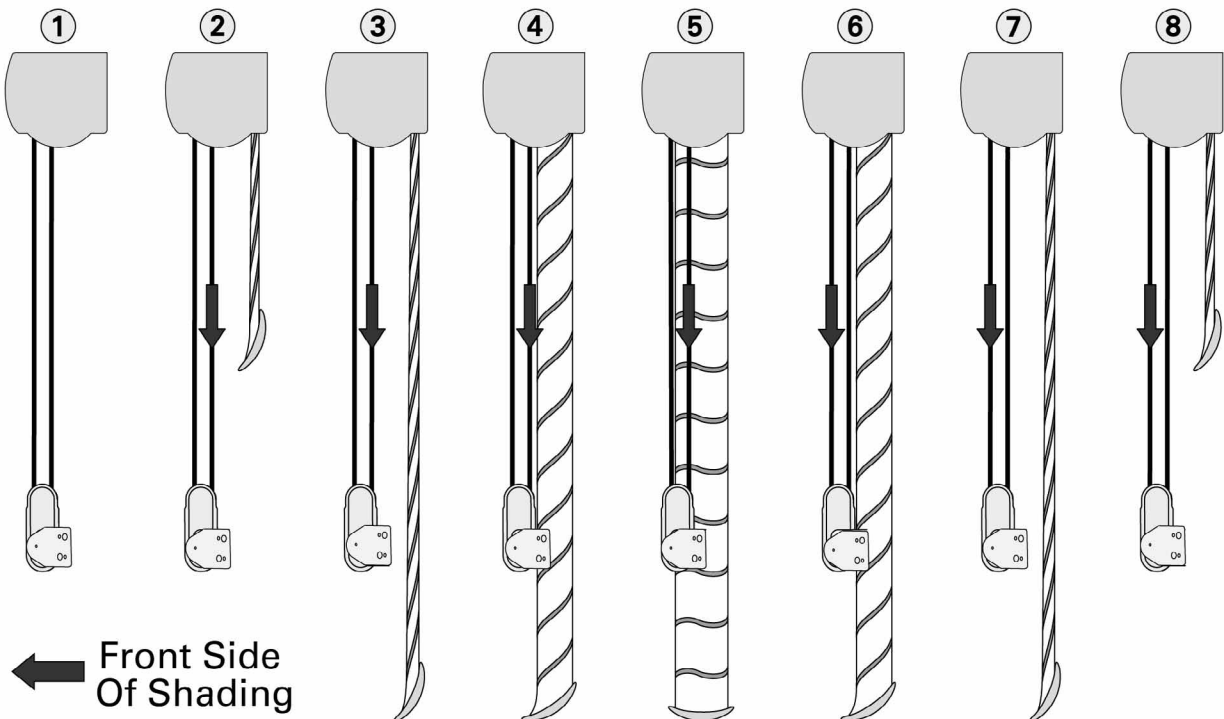

## OPERATION

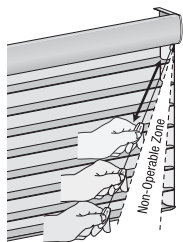

### RETRACTABLE CORD

#### To Lower the Shading

To lower shading and open vanes, pull cord toward the center and down in long even strokes.

Note: Allow cord to fully retract between each stroke.

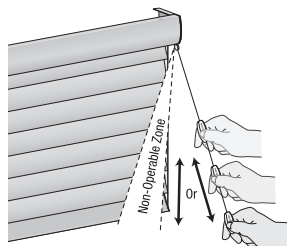

#### To Close and Raise the Shading

To close vanes and raise shading, pull cord straight down or down and slightly out using long even strokes.

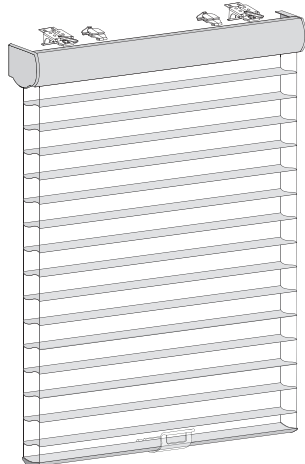

### CORDLESS LIFT

Raise, lower, and tilt shadings with cordless lift. A great choice for homes with children and pets, the lift, lower, and tilt mechanism are all controlled by the clear plastic handle attached to the bottomrail.

With your thumb on the front of the handle and fingers on the back, gently pull down to lower the shading. The hinged handle elegantly retracts when released. Continue pulling on the handle to lower the shadings and open the vanes.

To close the vanes and raise the shades, gently pull down on the handle (about 1") and release. The vanes will close and then the shading will retract into the headrail.



# PRODUCT COMPONENTS – STANDARD

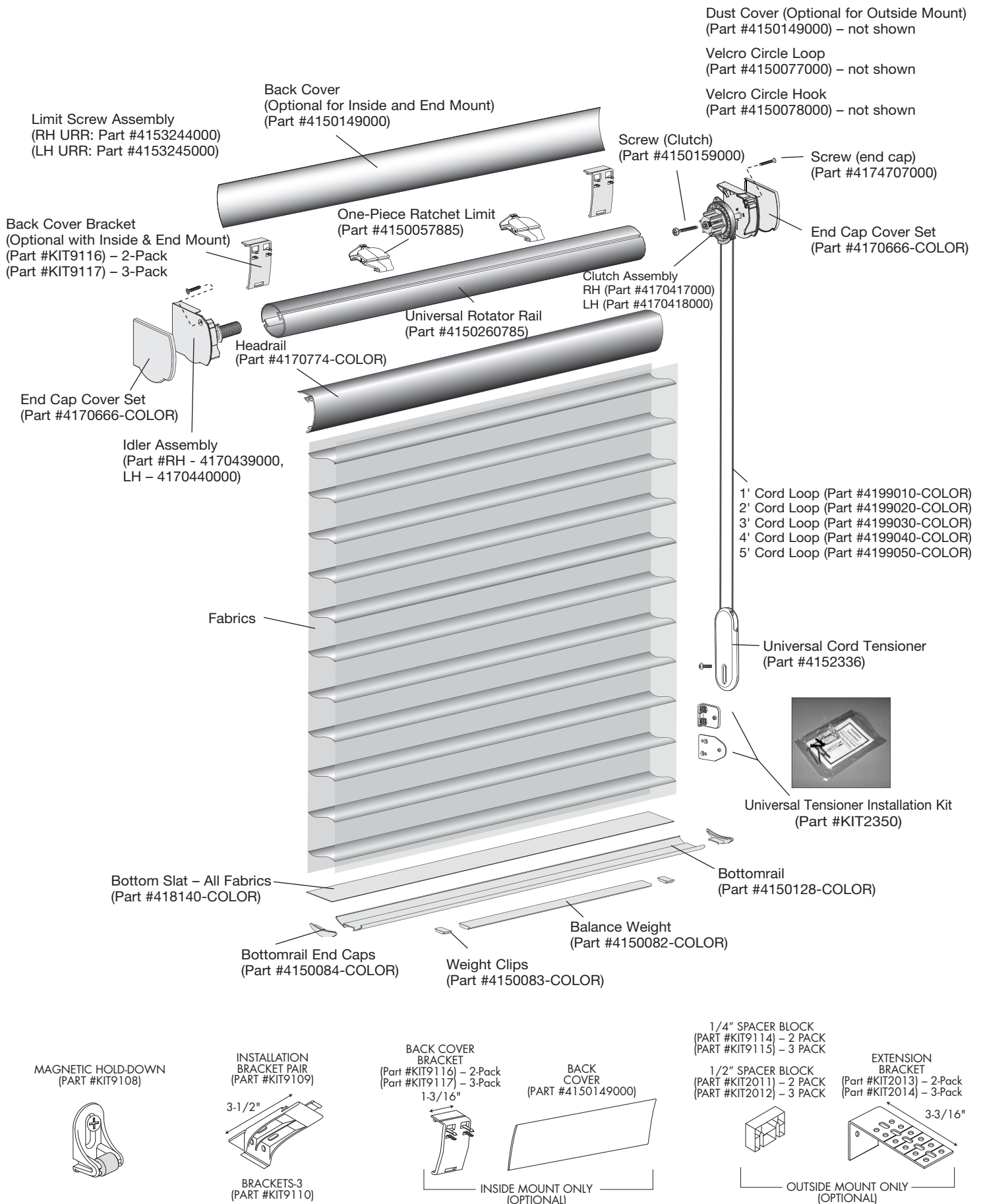

## PRODUCT COMPONENTS – RETRACTABLE CORD

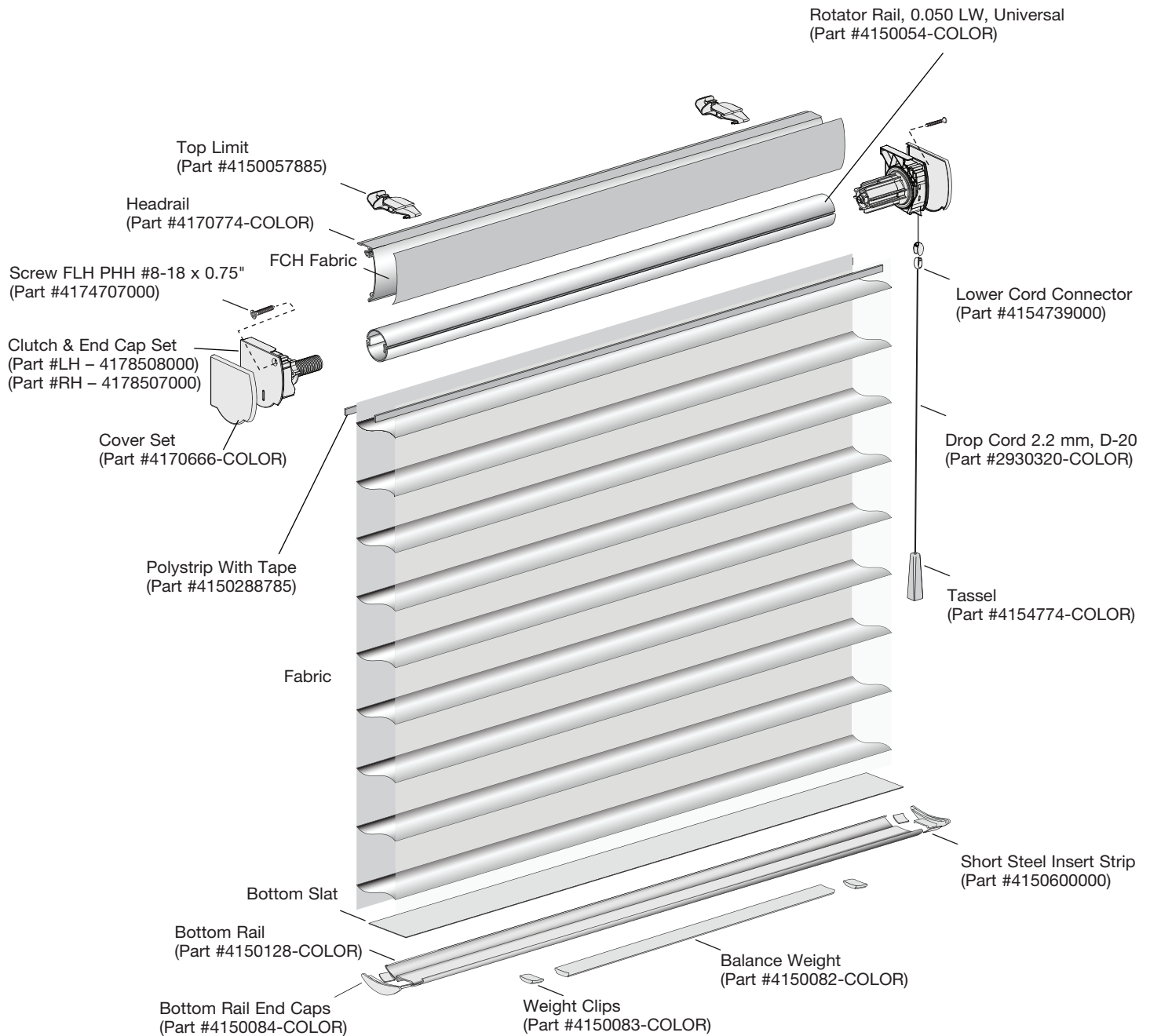



# PRODUCT COMPONENTS – CORDLESS LIFT

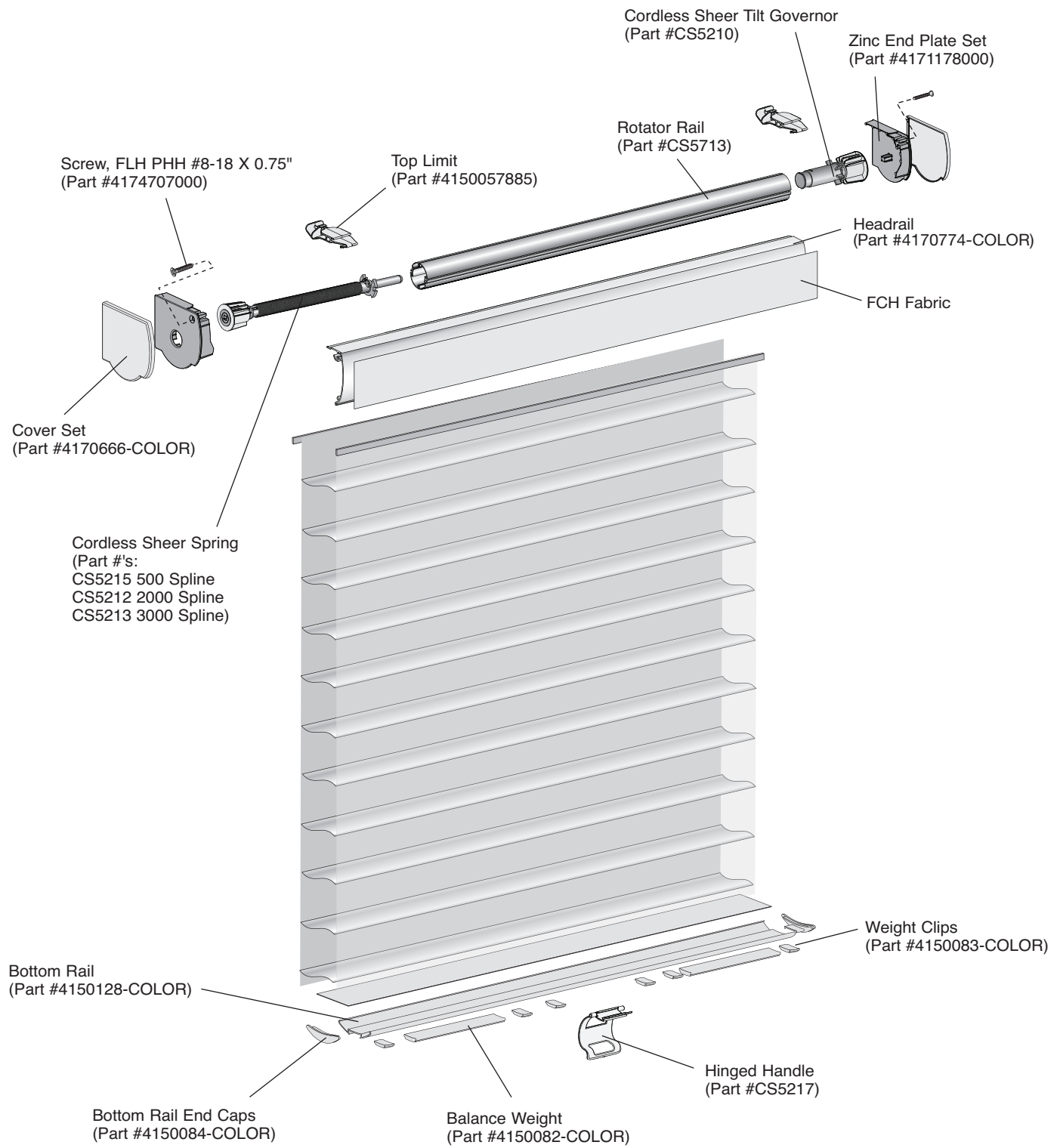

# PRODUCT COMPONENTS – SIMPLICITY RECHARGEABLE MOTORIZATION

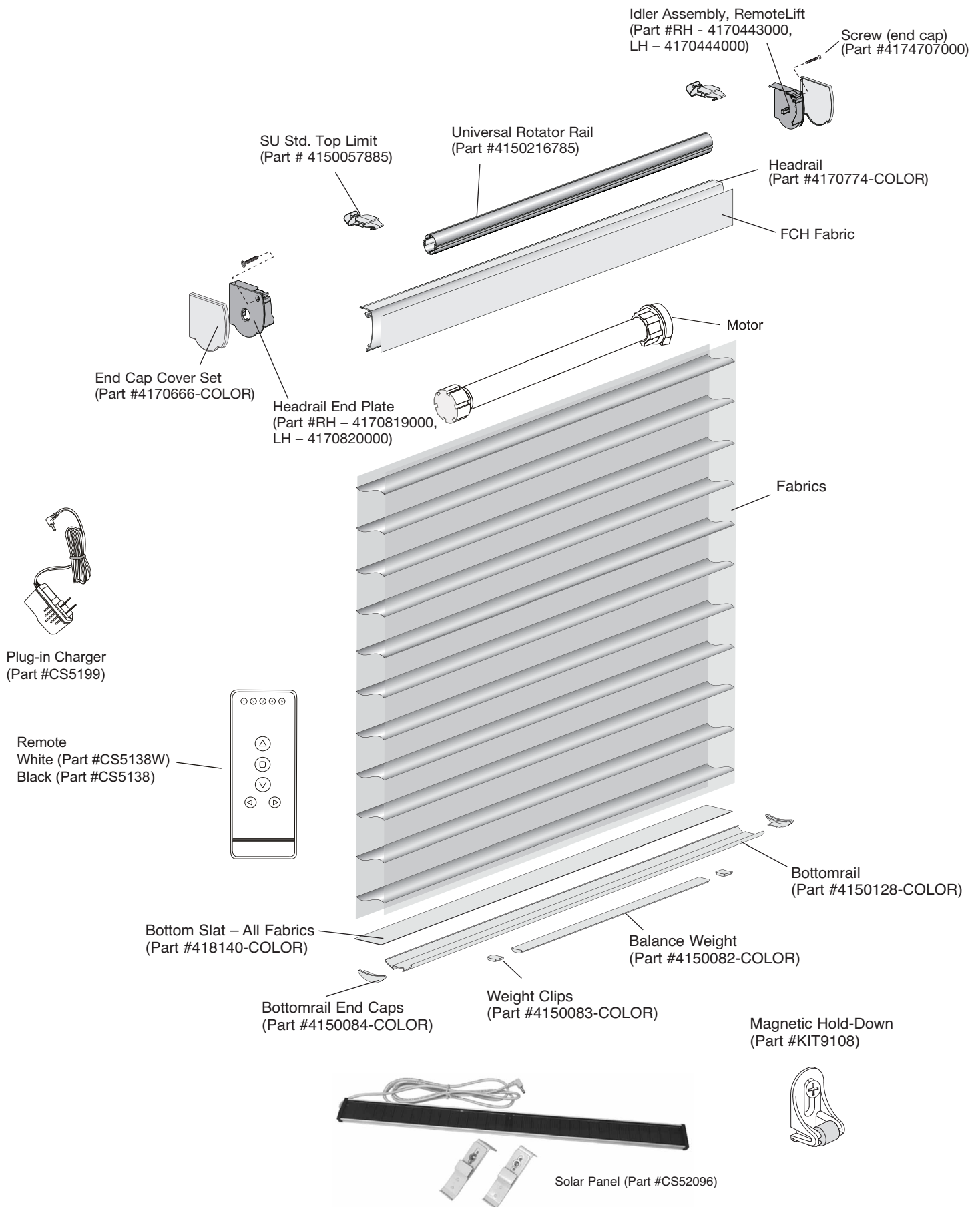

# PRODUCT COMPONENTS – POWERWAND MOTORIZATION

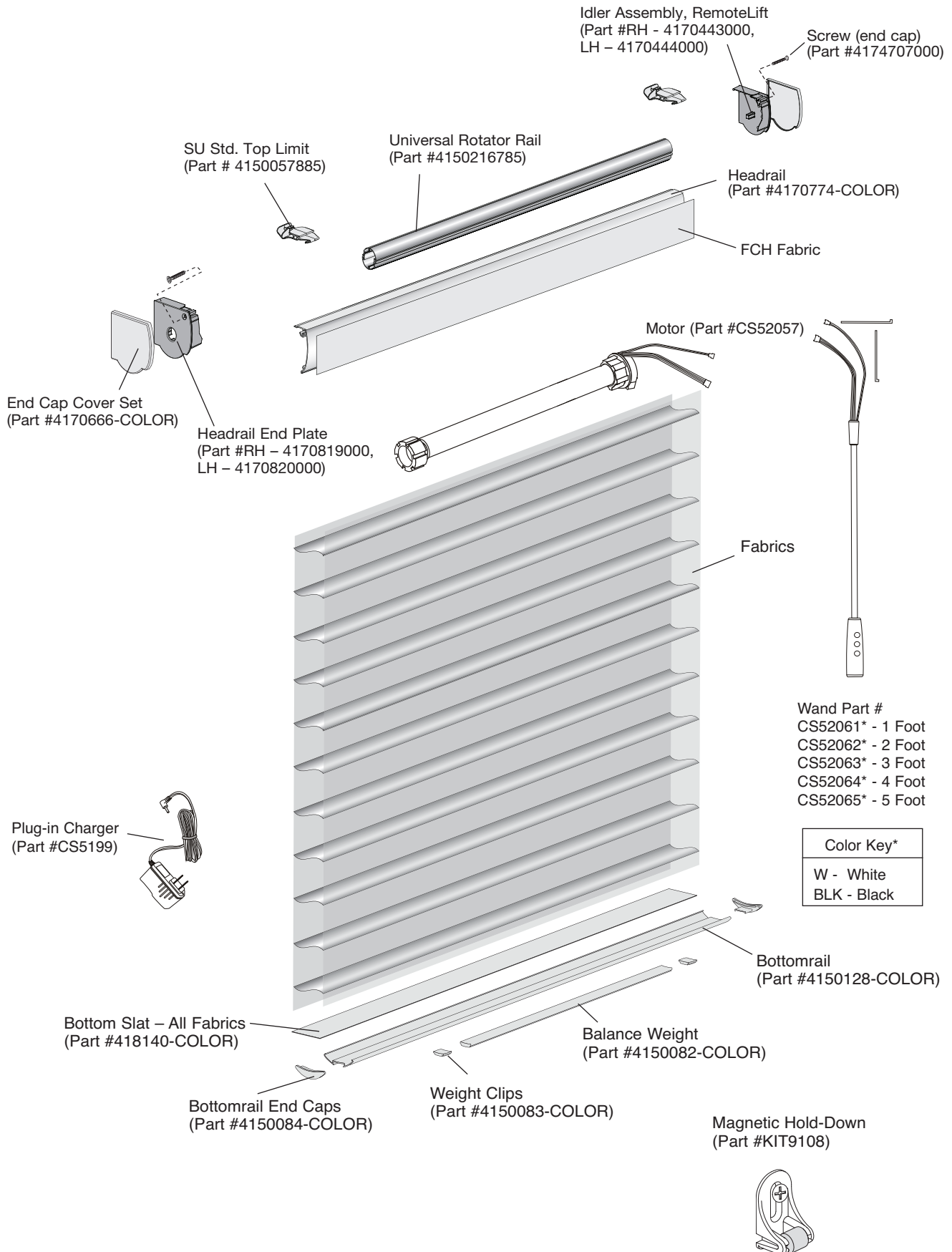

# PRODUCT COMPONENTS – REMOTELIFT™ 2.0

