

## // Retail Price List & Product Info Guide

**ALTA**  
WINDOW FASHIONS

**PORTER  
PRESTON**

Quality Wholesale Window Coverings  
Contract • Hospitality • Residential



# BASICS

## WINDOW SHADINGS

Effective February 3, 2020

*design simplified™*



---

## TABLE OF CONTENTS

---

### Product Overview

- Features & Benefits ..... 3
- Collection Information (includes Light Control) ..... 4

### Pricing Groups

- Pricing Group 1 (Translucent) ..... 5
- Pricing Group 2 (Light Dimming) ..... 6

### Product Specifications

- Product Specifications and Finished Dimensions ..... 7
- Options and Additional Notes ..... 8
- Standard Shading Operation ..... 9
- Motorization Overview ..... 10-11
- Product Components ..... 12-14

### **Upsize Common Carrier Delivery**

All orders with any quantity of shades or blinds or any continuous valance 96" or more in width are considered upsize. Therefore, a net shipping charge of \$45 per oversized unit will be assessed.

Oversized orders that require expedited shipping will be quoted and charged accordingly.

Please see General Information for additional freight and shipping charge information.



## FEATURES & BENEFITS



- Offered in the popular 2-1/2" vane size, ideal for any size window.
- Streamlined collection featuring both translucent and light-dimming vane styles to provide varying degrees of light control.
- Available with one of the two new motorization systems
  - Simplicity Rechargeable: Rechargeable RF motorization system provides months of use between charges (with normal use). The rechargeable battery is hidden in the rotating rail meaning no external battery pack. Solar recharge option available.
  - PowerWand: The ease of Simplicity motorization with the convenience of remote free operation. Lift and lower the shading with the touch of a button on the pendant that hangs from the front of the headrail. The rechargeable battery is charged using the charging port in pendant.
    - > To suit your customer's needs the black or white colored wand is available in one foot increments from one to five feet and can be placed on either the left or right.
- Limited Lifetime Warranty ensures your customers' satisfaction.



## COLLECTION INFORMATION

Family Name	Color Name	Family Code	Color #	Coordinating Hardware Color Name	Light Control	Price Group
<b>Dynamic</b> 2-1/2" Translucent	Aspen	DYSS	335	White	B	1
	Confection	DYSS	333	White	B	1
	Mystic	DYSS	331	White	B	1
	Pencil Sketch	DYSS	330	White	B	1
	Poppyfield	DYSS	334	White	B	1
	Tailwind	DYSS	332	White	B	1
<b>Mistral</b> 2-1/2" Translucent	Bay Leaf	MTSS	300	Evening Light	B	1
	Casual White	MTSS	304	White	B	1
	December Gray	MTSS	305	Silver Gray	B	1
	Prailine	MTSS	303	Vanilla	B	1
	Sailcloth	MTSS	302	Vanilla	B	1
	Wildflower	MTSS	301	Vanilla	B	1
<b>Pergola</b> 2-1/2" Translucent	Butter Cream	PGSS	315	Vanilla	B	1
	Canvas	PGSS	313	Vanilla	B	1
	Cobblestone	PGSS	310	Silver Gray	B	1
	Cotton Field	PGSS	311	White	B	1
	Honey Beige	PGSS	314	Vanilla	B	1
	Spring Snow	PGSS	312	White	B	1
<b>Repose</b> 2-1/2" Light Dimming *	Cloud White	RPSS	325	White	C	2
	Peaceful	RPSS	322	Vanilla	C	2
	Sandrift	RPSS	323	Vanilla	C	2
	Sesame	RPSS	324	Vanilla	C	2
	Shadow	RPSS	320	Silver Gray	C	2
	Twilight	RPSS	321	White	C	2

\* Light Dimming fabrics provide category C, opaque light control because even when the vanes are completely closed they DO NOT completely seal off all incoming light.

See vane closure diagram on page 8 for a visual reference.

Note: Collections are presented alphabetically. Within each collection colors are also arranged alphabetically



### A. Glare Reducing

Softly filters light and reduces glare. Images, shapes and people can be seen clearly. Provides the least amount of light and shape screening.



### B. Filtering

Filters strong light. Images, shapes and people can be seen with some clarity. Provides a modest degree of light and shape screening.



### C. Shading

Significantly reduces light. Images, shapes and people cannot be seen clearly. Provides a moderate to strong degree of light and shape screening.



### D. Blocking

Dramatically reduces light. Images, shapes and people are not distinguishable. Provides privacy against most all direct light and shape screening (except minimal light that may seep through closed or overlapping opaque/blackout vanes).



### E. Blackout

Blocks out virtually all light (except light that may enter on the sides of the shade) for maximum privacy and darkness.



**2-1/2" Translucent  
Dynamic (DYSS)  
Mistral (MTSS)  
Pergola (PGSS)**

**GROUP 1**

WIDTH TO:	24"	30"	36"	42"	48"	54"	60"	66"	72"	76"	84"	90"	96"	102"	109"	120"
HEIGHT TO:																
36"	\$336	378	420	463	504	550	588	632	742	786	830	873	914	971	1087	1187
42"	353	401	446	491	537	585	632	679	791	840	887	935	979	1042	1165	1272
48"	375	421	473	521	573	623	678	729	843	894	944	994	1046	1108	1240	1353
54"	389	445	498	555	609	664	720	782	893	948	1002	1059	1118	1186	1331	1452
60"	409	468	525	581	639	706	767	831	941	1003	1062	1128	1192	1272	1431	1562
66"	426	490	553	613	679	745	816	885	991	1060	1129	1200	1268	1356	1532	1672
72"	446	513	578	644	717	791	864	937	1046	1119	1193	1268	1342	1437	1624	1773
78"	458	529	600	675	746	825	900	980	1095	1176	1252	1333	1406	1510	1709	1866
84"	476	553	625	707	786	867	951	1033	1152	1238	1320	1401	1483	1591	1802	1968
90"	497	573	653	740	825	913	998	1084	1207	1295	1386	1471	1558	1669	1892	2065
96"	516	598	680	773	864	952	1044	1135	1263	1356	1450	1541	1632	1755	1987	2168
102"	589	683	776	878	970	1058	1181	1297	1388	1482	1577	1667	1760	1871	2111	2305
108"	620	718	816	922	1019	1114	1241	1368	1459	1559	1660	1757	1853	1970	2224	2428
114"	658	762	866	980	1085	1184	1319	1451	1551	1658	1760	1862	1963	2089	2355	2573
120"	707	816	930	1049	1158	1268	1411	1553	1660	1773	1886	1993	2103	2235	2522	2754

**STANDARD FEATURES**

- Headrail Size: 3-5/8" x 3"
- Snap-in Bracket Style
- Cord Tilt & Lift
- Color-Coordinated Hardware

**OPTIONS: NO CHARGE – SPECIFY ON ORDER**

- Fabric Headrail Insert
- Tilt Only
- Control Positions (R or L)
- Spacer Blocks
- Hold-Down Brackets
- Two-On-One Headrail – price as 2 separate shades (Standard Cord Loop Only)

**OPTIONS: EXTRA CHARGE**

- Cordless Lift ..... add \$77 per shading

**MOTORIZATION OPTIONS: EXTRA CHARGE**

- Simplicity Rechargeable Motor ..... add \$281 per shading  
(Charging port available on the right side only)  
– 5 Channel Remote Control  
(Black Part #CS5138 or White Part #CS5138W) ... add \$41 each  
– Solar Panel (Part #CS52096) ..... add \$153 each
- PowerWand ..... add \$113 per shading  
– PowerWand Options (must be specified):  
1) Control Side (Left or Right)  
2) Wand Color (Black or White)  
3) Wand Length:  
1 foot (12")  
2 feet (24")  
3 feet (36")  
4 feet (48")  
5 feet (60")
- Plug-in Charger (Can be used for both Simplicity Rechargeable and PowerWand) (Part #CS5199) ..... add \$31 each

SIZE STANDARDS	Standard Cord Loop	
	Single Shade	2-on-1 Headrail
Minimum ordered width	12"	24"
Minimum ordered width – tilt only	6"	N/A
Maximum ordered width	120"	120"
Maximum ordered width – tilt only	11-7/8"	N/A
Minimum ordered height	16"	16"
Maximum ordered height – translucent	120"	120"

SIZE STANDARDS	Cordless Lift	Simplicity Rechargeable	PowerWand™
Minimum ordered width	18"	19"	21"
Minimum ordered width – tilt only	NA	N/A	N/A
Maximum ordered width	84"	120"	120"
Maximum ordered width – tilt only	NA	N/A	N/A
Minimum ordered height	16"	16"	16"
Maximum ordered height – translucent	84"	120"	120"



**GROUP 2**
**2-1/2" Light Dimming  
 Repose (RPSS)**

WIDTH TO:	24"	30"	36"	42"	48"	54"	60"	66"	72"	76"	84"	90"	96"	102"	109"	120"
HEIGHT TO:																
36"	\$371	417	464	511	556	605	647	696	814	865	913	962	1006	1069	1199	1308
42"	389	444	490	541	593	644	696	745	872	923	976	1027	1078	1143	1278	1395
48"	411	464	521	573	631	686	744	800	923	981	1037	1094	1150	1219	1367	1492
54"	428	488	550	610	666	729	791	856	980	1044	1101	1166	1233	1305	1468	1604
60"	450	513	577	640	706	774	847	914	1034	1101	1170	1241	1314	1398	1572	1717
66"	469	535	609	678	745	822	897	974	1090	1167	1243	1319	1394	1493	1685	1840
72"	490	563	637	708	789	872	949	1028	1150	1233	1315	1394	1472	1579	1810	1975
78"	504	579	661	741	822	911	992	1079	1205	1291	1381	1465	1549	1661	1941	2119
84"	525	609	686	775	866	953	1047	1135	1268	1361	1451	1626	1700	1768	2082	2272
90"	548	631	717	812	910	1003	1099	1191	1324	1424	1601	1699	1772	1882	2184	2384
96"	625	717	811	913	1004	1095	1204	1313	1474	1567	1661	1756	1847	1975	2291	2502
102"	717	819	923	1037	1127	1214	1362	1500	1619	1713	1809	1897	1990	2110	2434	2657

**STANDARD FEATURES**

- Headrail Size: 3-5/8" x 3"
- Snap-in Bracket Style
- Cord Tilt & Lift
- Color-Coordinated Hardware

**OPTIONS: NO CHARGE – SPECIFY ON ORDER**

- Fabric Headrail Insert
- Tilt Only
- Control Positions (R or L)
- Spacer Blocks
- Hold-Down Brackets
- Two-On-One Headrail – price as 2 separate shades (Standard Cord Loop Only)

**OPTIONS: EXTRA CHARGE**

- Cordless Lift ..... add \$77 per shading

**MOTORIZATION OPTIONS: EXTRA CHARGE**

- Simplicity Rechargeable Motor ..... add \$281 per shading  
 (Charging port available on the right side only)  
 – 5 Channel Remote Control  
 (Black Part #CS5138 or White Part #CS5138W) ... add \$41 each  
 – Solar Panel (Part #CS52096) ..... add \$153 each
- PowerWand ..... add \$113 per shading  
 – PowerWand Options (must be specified):  
   1) Control Side (Left or Right)  
   2) Wand Color (Black or White)  
   3) Wand Length:  
     1 foot (12")  
     2 feet (24")  
     3 feet (36")  
     4 feet (48")  
     5 feet (60")
- Plug-in Charger (Can be used for both Simplicity Rechargeable and PowerWand) (Part #CS5199) ..... add \$31 each

SIZE STANDARDS	Standard Cord Loop	
	Single Shade	2-on-1 Headrail
Minimum ordered width	12"	24"
Minimum ordered width – tilt only	6"	N/A
Maximum ordered width	120"	120"
Maximum ordered width – tilt only	11-7/8"	N/A
Minimum ordered height	16"	16"
Maximum ordered height – <b>light dimming</b>	102"	102"

SIZE STANDARDS	Cordless Lift	Simplicity Rechargeable	PowerWand™
Minimum ordered width	18"	19"	21"
Minimum ordered width – tilt only	N/A	N/A	N/A
Maximum ordered width	84"	120"	120"
Maximum ordered width – tilt only	N/A	N/A	N/A
Minimum ordered height	16"	16"	16"
Maximum ordered height – <b>light dimming</b>	84"	102"	102"



# PRODUCT SPECIFICATIONS

## FEATURES

# of fabric styles	4
# of colors	24
Headrail size	3-5/8" x 3"
Bracket style	Snap-in
Cord loop tilt and lift	Yes
Safety cord tensioner	Color Coordinated
Warranty	Limited Lifetime

## OPTIONS

Two-on-One Headrail Option (Std Cordloop ONLY) <b>not available</b> with Cordless Lift or Motorized systems	Yes
Cordless Lift	Yes
Control positions	Left or Right
Fabric Headrail Insert	Yes
Hold-down brackets	Yes
Spacer blocks	Yes
Tilt Only (Standard Cordloop ONLY)	Yes
Specialty shapes	No
Tile cut-out	No
Cord Loop Drop	Yes

## MOTORIZATION OPTIONS

<b>Simplicity Rechargeable</b>	Yes
- Remote	Black or White
- Plug-in Charger	Yes
- Solar Panel Charger	Yes
<b>PowerWand Motorization (Rechargeable)</b>	Yes
- Wand Length	1, 2, 3, 4, 5 feet
- Wand Color	Black or White
- Wand Position	Left or Right
- Plug-in Charger	Yes

## CORD LOOP LENGTH

Translucent		Light Dimming	
Ordered Length	Cord Length	Ordered Length	Cord Length
16" to 19-7/8"	12"	16" to 19-7/8"	12"
20" to 26-7/8"	18"	20" to 26-7/8"	18"
27 to 39-7/8"	24"	27 to 39-7/8"	24"
40" to 59-7/8"	36"	40" to 59-7/8"	36"
60" to 83-7/8"	48"	60" to 83-7/8"	48"
84" to 107-7/8"	60"	84" to 102"	60"
108" to 120"	72"		

## MOUNTING REQUIREMENTS

INSIDE MOUNT	
Minimum casement depth*	1-1/2"
Minimum casement depth*, fully recessed	3-3/4"
Minimum rear fabric clearance	1/8"

OUTSIDE MOUNT	
Minimum mounting surface height	3-1/8"
Recommended width overlap per side	3"
Minimum rear fabric clearance	1/8"

## FINISHED DIMENSIONS

NOTE: WIDTH AND HEIGHT MAY VARY  $\pm 1/8"$

INSIDE MOUNT – Standard Deductions		
	Standard Cord Loop	
	Single Shade	2-on-1 Headrail
Headrail unit	1/8" less than ordered width	1/8" less than ordered width
Fabric width	1" less than ordered width	1" less than ordered width
Shading height	1/8" less than ordered height	1/8" less than ordered height
Fabric Gap	N/A	3/8"
OUTSIDE MOUNT – Standard Deductions		
	Standard Cord Loop	
	Single Shade	2-on-1 Headrail
Headrail unit	ordered width	ordered width
Fabric width	3/4" less than ordered width	3/4" less than ordered width
Shading height	1/8" less than ordered height	1/8" less than ordered height
Fabric Gap	N/A	3/8"

INSIDE MOUNT – Standard Deductions			
	Cordless Lift	Simplicity Rechargeable	PowerWand™
Headrail unit	1/8" less than ordered width	1/8" less than ordered width	1/8" less than ordered width
Fabric width	3/4" less than ordered width	1-1/8" less than ordered width	1" less than ordered width
Shading height	1/8" less than ordered height	1/8" less than ordered height	1/8" less than ordered height
OUTSIDE MOUNT – Standard Deductions			
	Cordless Lift	Simplicity Rechargeable	PowerWand™
Headrail unit	ordered width	ordered width	ordered width
Fabric width	5/8" less than ordered width	1" less than ordered width	3/4" less than ordered width
Shading height	1/8" less than ordered height	1/8" less than ordered height	1/8" less than ordered height



## OPTIONS

### FABRIC HEADRAIL INSERT

Features a coordinating fabric inserted into the front of the headrail to provide a soft fabric look from top to bottom.  
(See surcharge on pricing pages)



### SIDE-BY-SIDE VANE ALIGNMENT

When window shadings are installed side by side, vane alignment can be guaranteed within 1/4" only if:

- Shadings are ordered at the same time and in the identical style, color and height.
- Shadings that need to be aligned are specified on the order form (a note must be included in Special Instructions).

### ADJACENT SHADINGS

To span wide window openings, window shadings may be installed adjacently, so their headrails abut. The gap between the fabric panels of the adjacent shadings varies according to the control placement, as shown in the table below.

CONTROL PLACEMENT	
Adjacent (Abutting)	Window Shadings
Left/Right Shadings	Center Gap
Right/Right Controls	3/4"
Left/Left Controls	3/4"
Right/Left Controls	1-1/16"
Left/Right Controls	1/2"
Window shadings are not recommended for bay windows or butt-and-pass applications.	

## ADDITIONAL NOTES

### SHADING ADJUSTMENT

Shadings should wind evenly and not skew to one side.

A balance weight on the bottomrail can easily be adjusted if the fabric winds unevenly on the roll when the window shading is raised. Uneven winding can cause damage to the edge of the fabric.

- If skewing does occur:
  - Ensure headrail was installed level; shim if necessary.
  - To release, insert a flat blade screwdriver into the weight lock and turn clockwise.
  - Adjust placement of weight in bottomrail, 1" at a time, toward side where fabric is gathering.
  - Secure the weight locks in position by turning them counter clockwise, after making the adjustment.
  - Raise shade, then lower, if necessary, adjust again.

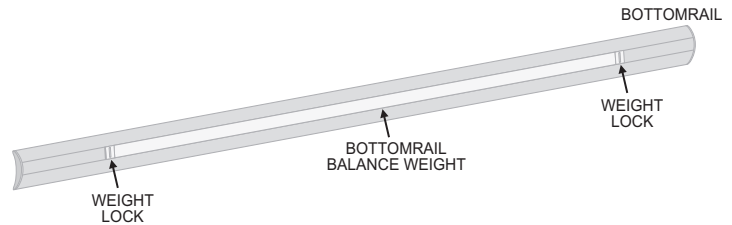

### MAGNETIC HOLD-DOWN BRACKETS

Magnetic hold-down brackets secure the bottom of the shading to prevent swaying. Available upon request. Standard on tilt-only shadings.

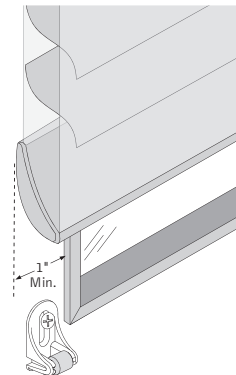



## STANDARD SHADING OPERATION

### STANDARD SHADING OPERATION

Referring to the illustration below.

- 1) Shading in fully raised position.
- 2) Pull down on rear half of the cord loop to lower shading and open fabric vanes.
- 3) Pull down on front half of the cord loop to close vanes and raise shading.

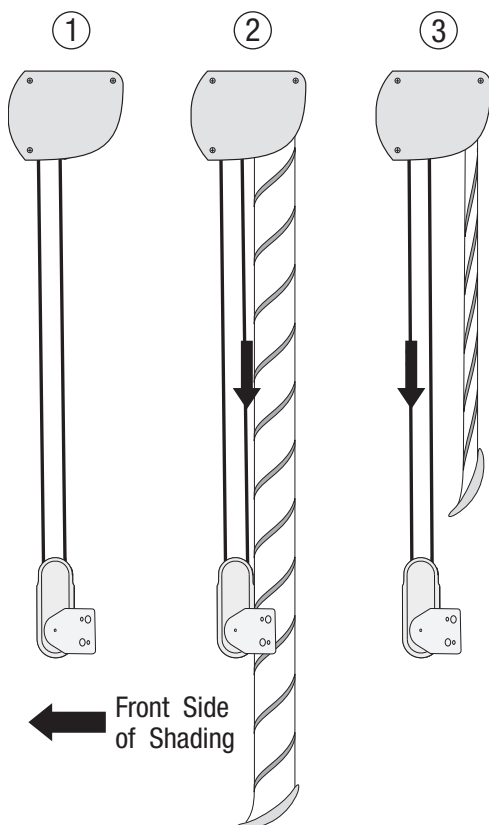

### Light Control

With the shading in the fully lowered position, the cord loop is used to adjust the fabric vanes from open to closed, and anywhere in between. Light control is at your customer's fingertips. (Note: The degree of maximum vane closure varies slightly from the top to the bottom of the shading.)

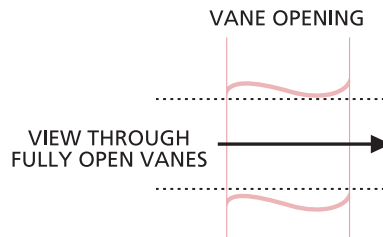

### Vane Opening

Vane opening is the amount of unobstructed visibility between fully open vanes when looking through the shading at eye level. Vane opening for shadings is up to 1-1/4".

### Vane Closure

When the vanes of a window shading are closed, they overlap each other, blocking the view. However, the vanes do not contact each other along the full length of the shading – they do not form a perfect seal against light leakage. This is most visible toward the bottom of the shading.

Vane closure is measured as the distance between the front and rear fabric facings 6" up from the lowest point of the bottomrail, with the shading fully lowered and the vanes closed, as illustrated here. Vane closure is 5/8" for shadings under 96" in height and 7/8" for shadings over 96" in height.

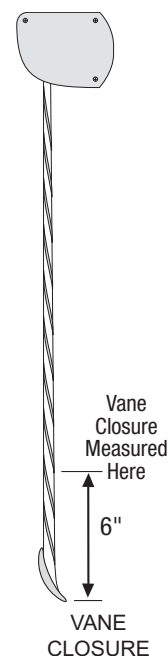

**PLEASE NOTE:** Cord tensioner MUST be mounted to window casement or wall in order for the shade to operate.

### Cordless Operation

#### To Lower The Shade

- Pull down on the tassel until the shade is at the desired height.

#### To Raise The Shade

- Gently pull down on the tassel. To raise the shade completely, simply release the tassel and the shade will roll up fully into the headrail. To raise the shade partially, when the shade is at the desired height, gently pull on the tassel to stop the shade from raising.



Optional cordless lift control only



## SIMPLICITY RECHARGEABLE MOTORIZATION: OVERVIEW

### Simplicity Rechargeable

- The Rechargeable Simplicity motor program features an integrated rechargeable lithium ion battery in the motor casing and is fully concealed by the inner tube.
- Rechargeable battery is included with the motor. The average battery charge will last 6-12 months based on an average sized shade raised and lowered once per day. The life of the battery charge will vary based on the type of window covering selected, the size and weight of the window covering and the number of times the shade is operated on a daily basis. The battery can be recharged up to 500 times. It takes approximately 5 hours to recharge the motor when fully depleted. Charging port available on the right side only.

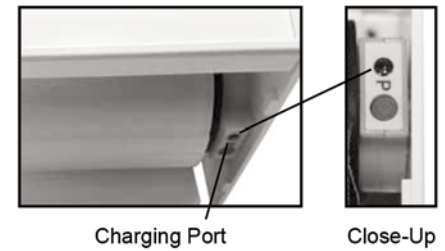

### Battery Charger

- An 8.4 Volt charger requires a standard power outlet to recharge the battery. The charger must be specified when ordering Simplicity Rechargeable Motorized shade option. The charger plugs into the charging port of the motor. The charger is black and comes with a 156" wire. The dimensions are 1" wide x 2-1/2" length x 1-3/4" deep. Sold separately.



### Solar Panel Recharge Option

- Plugs in to any Simplicity Rechargeable motorized shading (does not work with PowerWand). Provides constant trickle charge to 7.4v Li-ION Rechargeable battery packs. Does not require direct sunlight, but performs best in regular direct sunlight applications. Will prolong the life of the charge of the 7.4v rechargeable battery packs, and in some applications will maintain charge indefinitely.
- Life of charge is subject to application variables such as size and weight of shade, frequency of use, amount of direct sunlight exposure, etc.



Dimensions of panel  
18½" x 1½"

### 5 Channel Remote

- The remote can operate up to five shadings simultaneously, individually or in groups. Remotes and holders are available in white or black. The remote comes with a holder which can be mounted to a wall for easy storage. The range of the remote is approximately 80 feet.



Please Note:

- Not all motors run at the same rate of speed.
- Simplicity motors have a "Favorites" position setting. To set a "Favorites" position, follow instructions provided in the installation instructions.



---

## POWERWAND MOTORIZATION: OVERVIEW

---

### PowerWand™ Motorization

- Shadings can be fabricated with the PowerWand Rechargeable Push Button Control option. The PowerWand Rechargeable option is an easy, cord free motorized operation for the budget savvy homeowner. PowerWand Rechargeable uses Simplicity motors and components.

### PowerWand Rechargeable Shades Operation

- Press the up or down button on the pendant to raise or lower the shading to your desired position. No programming is required with PowerWand as upper and lower limits are set at the factory. If desired, upper and lower limits can be adjusted in the field.
- Please refer to the installation instructions for instructions on resetting the upper and lower limits and setting a favorites position can be programmed on-site.

### PowerWand Appearance

- The PowerWand Rechargeable wand and pendant is attached to the head rail and requires no additional mounting.
- The wand and pendant hangs down the front of the shades from the head rail.
- Pendant is 2-1/2" long.
- The pendant does not need to be mounted to the wall to operate the shade.

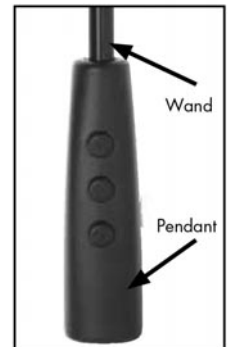

### PowerWand Options

- Wand is available in Black or White (there is no default)
- Wand is available in 1 foot increments from 1 to 5 feet (there is no default)
- Wand is available on either the right or left side of the shade (there is no default)



### PowerWand Battery Life

- The battery life will vary based on the type of window covering selected, the size and weight of the window covering and the number of times you operate the blind on a daily basis.

### Battery Charger

- 8.4 Volt charger requires a standard power outlet to recharge the battery. The charger must be specified when ordering the PowerWand motorization option. The charger plugs into the charger port on the side of the pendant. The charger is black and comes with a 156" wire. The dimensions are 1" wide x 2-1/2" length x 1-3/4" deep.





## PRODUCT COMPONENTS – STANDARD

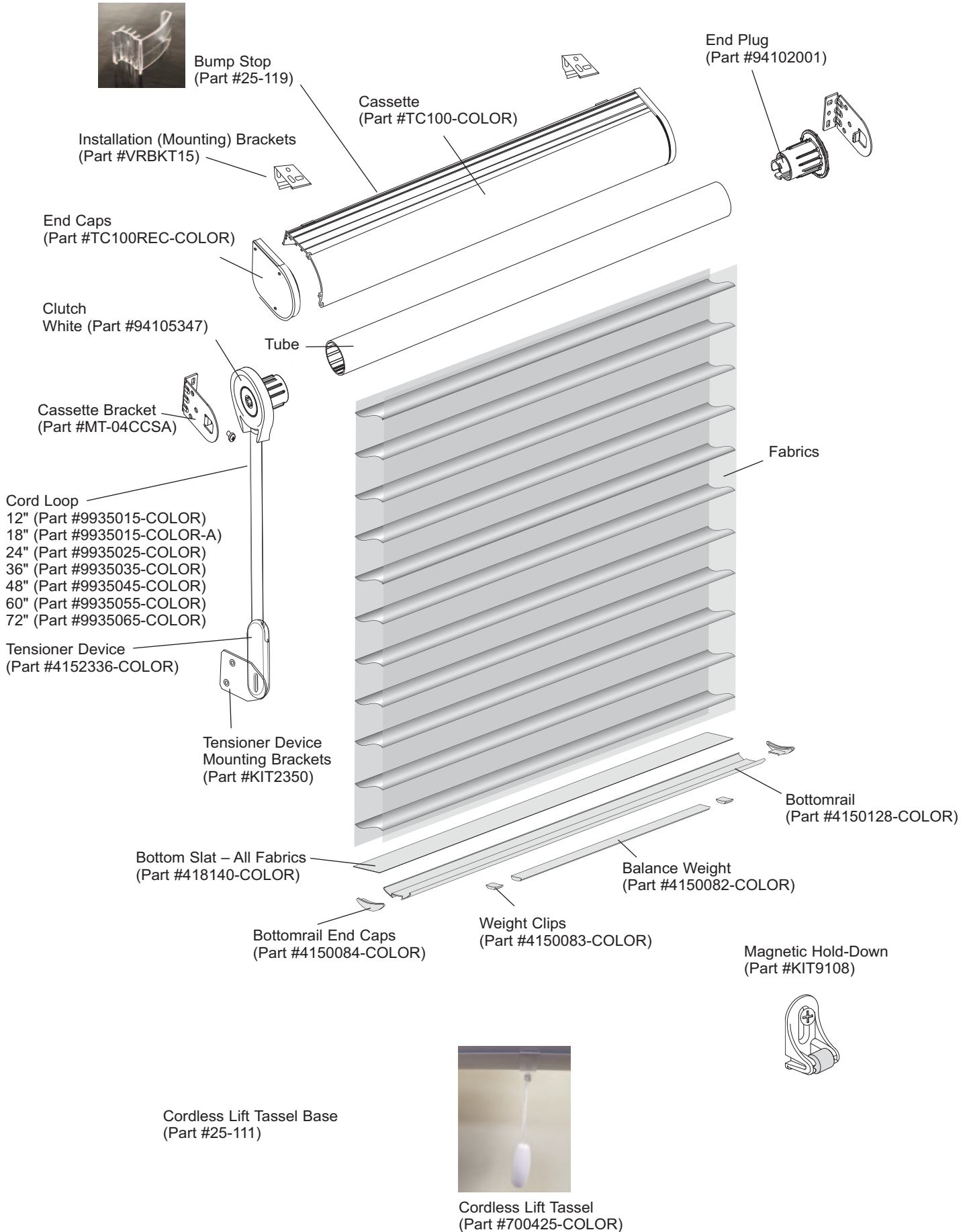



# PRODUCT COMPONENTS – SIMPLICITY RECHARGEABLE MOTORIZATION

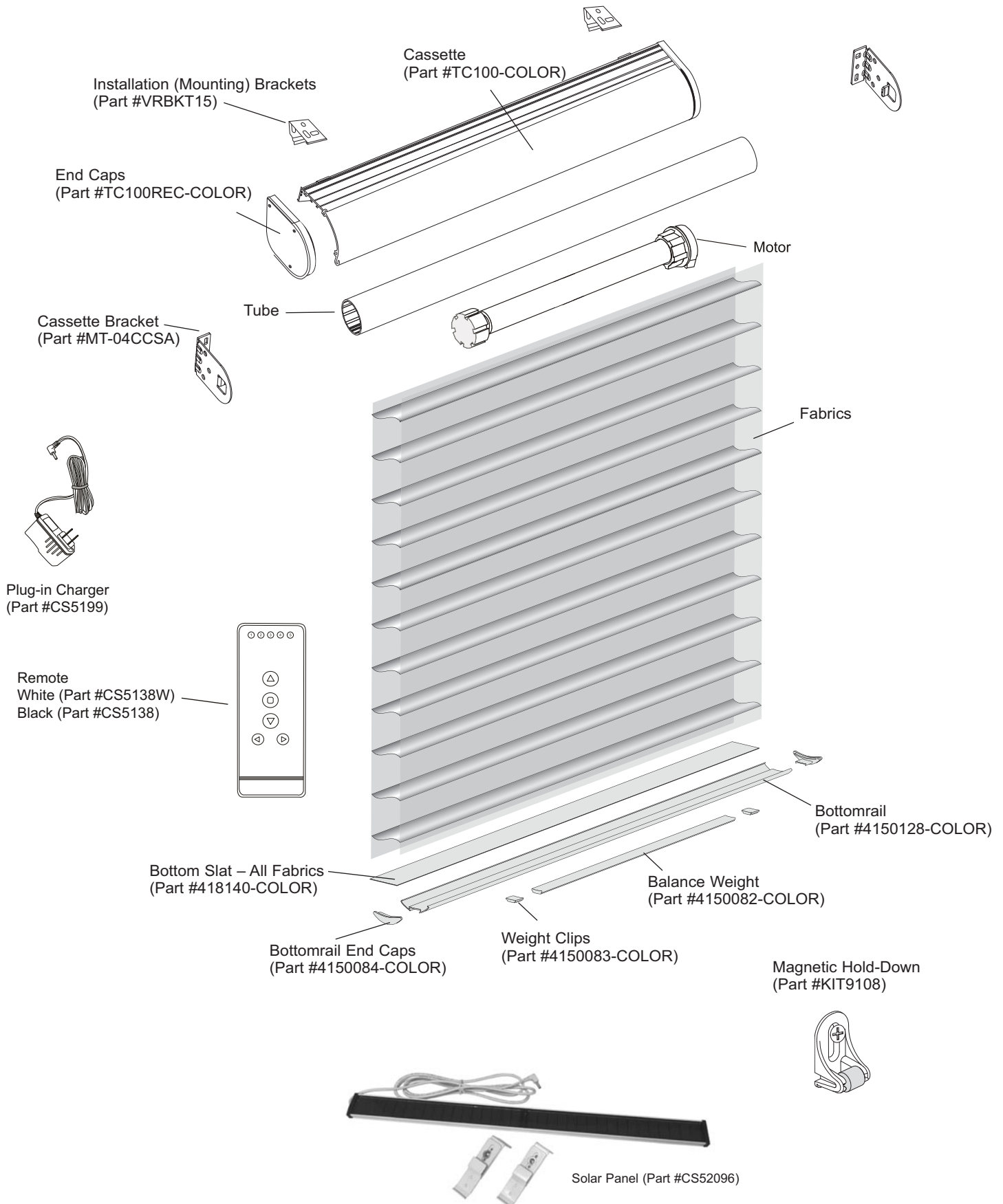



# PRODUCT COMPONENTS – POWERWAND MOTORIZATION

