



Property Data

STRAP: 19-46-24-W4-0140B.0010 Folio ID: 10228351

Owner Of Record

GRAND RESORT FT MYERS BEACH
LLC
4805 TAMiami TRAIL NORTH
NAPLES FL 34103

Site Address

1188/1190 ESTERO BLVD
FORT MYERS BEACH FL 33931

Legal Description

CRESCENT PARK BLK B PB 4 PG 39 LOT 1

Classification / DOR Code

STORES, ONE STORY / 11

[Tax Map Viewer]



[Pictometry Aerial Viewer]



Current Working Values



Just 307,836 As Of 07/14/2015

Attributes

Land Units Of Measure	Units	Frontage	Depth	Total Number of Buildings	Total Bedrooms / Fixtures	Total Living Area	1st Year Building on Tax Roll	Historic District

Image of Structure



◀ Photo Date April of 2015 ▶



Exemptions



Values (2015 Tax Roll)



Taxing Authorities



Sales / Transactions



Building/Construction Permit Data

Permit Number	Permit Type	Date
COM2002-00051	Commercial	02/11/2002
COM2002-00757	Commercial	05/06/2002
COM12-0291	Building Addition	12/14/2012
115484	Commercial	01/27/1998
COM000115484	Building Addition	01/28/1998
COM2001-01536	Building Remodel / Repair	12/17/2001
Z10727	Commercial	08/27/1987
ROF13-0063	Roof	06/26/2013
ROF2002-00189	Roof	01/17/2002
FNC12-0051	Fence	01/03/2013

IMPORTANT INFORMATION: THIS MAY NOT BE A COMPREHENSIVE OR TIMELY LISTING OF PERMITS ISSUED FOR THIS PROPERTY.

Note: The Lee County Property Appraiser's Office does not issue or maintain any permit information. The Building/Construction permit data displayed here represents only those records this Office may find necessary to conduct Property Appraiser business. Use of this information is with the understanding that in no way is this to be considered a comprehensive listing of permits for this or any other parcel.

The Date field represents the date the property appraiser received information regarding permit activity; it may or not represent the actual date of permit issuance or completion.

Full, accurate, active and valid permit information for parcels can only be obtained from the [appropriate permit issuing agency](#).

Parcel Numbering History

Prior STRAP	Prior Folio ID	Renumber Reason	Renumber Date
19-46-24-14-0000B.0010	N/A	Reserved for Renumber ONLY	01/12/1995

Location Information

Solid Waste (Garbage) Roll Data

Flood and Storm Information

Appraisal Details

Land

Land Tracts

Use Code	Use Code Description	Depth	Frontage	Number of Units	Unit of Measure
1100	Store, One (1) Floor	0	0	3240.00	Square Feet

Buildings

Building 1 of 1

Building Characteristics

Improvement Type	Model Type	Stories	Living Units
21 - Stores/Office/Res Combination	4 - commercial	2.0	2
Bedrooms	Fixtures	Year Built	Effective Year Built
2	7.0	1962	1980

Building Subareas

Description	Heated / Under Air	Area (Sq Ft)
APT - APARTMENT	Y	864
BAS - BASE	Y	864
BAS - BASE	Y	312
STP - STOOP	N	191
STP - STOOP	N	161

Building Features

Description	Year Added	Units
PATIO - BRICK AND TILE	2000	637

Building Front Photo

Building Footprint



Photo Date : April of 2015

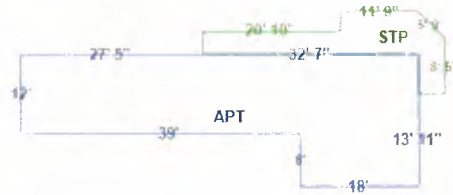
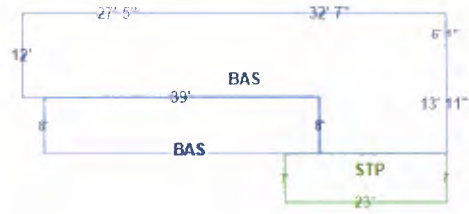

TRIM (proposed tax) Notices are available for the following tax years
[2007 2008 2009 2010 2011 2012 2013 2014 2015]

[Previous Parcel Number](#) [Next Parcel Number](#) [New Query](#) [Search Results](#) [Home](#)

Parcel Information

The information below summarizes the parcel you selected.

Parcel:	194624W40140B0010
Address:	1188/1 ESTERO BLVD 1190 ESTERO BLVD 1188 ESTERO BLVD 1190 ESTERO BLVD 1190 ESTERO BLVD 1190 ESTERO BLVD 1188 1190 ESTERO BLVD 1188 1190 ESTERO BLVD 1188 1190 ESTERO BLVD 1188 1190 ESTERO BLVD 1188 1190 ESTERO BLVD 1188 1190 ESTERO BLVD 1188 1190 ESTERO BLVD
Owner:	GRAND RESORT FT MYERS BEACH

General Information

Prior Strap: 194624140000B0010
Legal Description: CRESCENT PARK BLK B PB 4 PG 39 LOT 1
Historical District: No

Cases Associated with this Parcel Record

Case Number:	Description:	Status:
COM000115484	INT REM/HEALTH FOOD + MASSAGE RIGBY BODYWORKS NEW OWNER KIM REEVE	Finaled
COM000400895	INT REM/THERAPUTIC MASSAGE CTR	Received
COM000400896	INT REMODEL "CASE RIGBY"	Archived
COM2001-01536	INT REM - RITA'S RESTAURANT	Archived
COM2002-00051	AWNING FOR RITA'S	Archived
COM2002-00757	AWNINNG FOR ANA MARIA BRAZILIAN CONNECTION	Archived
ELE2002-00211	ELECTRIC FOR TOWN OF FT. MYERS BEACH SIGN PERMIT 2002-04	Finaled
ELE2002-00222	MIN ELECTRIC FOR AWNING - COM2002-00051	Finaled
ELE220072560	CHG O/H TO U/G(TIMES SQUARE)	Finaled
LDO2002-00378	*transmittal letter has wrong case number on it. (LDO2002-00351)	Issued
MEC220083481	A/C PKG UNIT *RIGBY HEALTH SHO	Finaled
PLU2004-00584	REPLACE 3 COMPARTMENT SINK,REPLACE 3 HAND SINKS,INSTALL LAUNDRY TUB	Finaled
ROF2002-00189	REROOF MD TEAR OFF	Finaled
SGN2002-00312	**VOID-SIGN IN TOWN OF FT MYERS BEACH**AWNING SIGN	Received
SGN220080507	RIGBY'S HEALTH SHOPPE	Finaled
USE000362366	IT'S MANAGING, INC.	Received

USE2002-00241	RETAIL SALES AND WHOLESale	Archived
USE2002-01342	RETAIL SALES	Archived
USE2004-01286	RESTAURANT	Archived
USE2004-01327	RETAIL SALES (GIFTS)	Finalized
VAR957760	970722605V 01.01 RIGBY'S HEALTH SHOPPE	Finalized
VIO2002-04348	issued Citation 410 (\$100-FIRST OFFENSE) for electrical contracting w/o license	Closed
VIO2005-09912	warning 0000642F issued to Barry Gould reference "A Frame" signs	Closed
ZVL2006-00103	APPLICATION FOR verification of zoning, uses, and density.	Done

[Back to Search](#)
[Top of Page](#)

Version: 3.5.3.20051221.03

Copyright © 2005 by Accela, Inc.

To comment on this page, send email to eConnect@leegov.com or call (239) 533-8329.

Parcel Information

The information below summarizes the parcel you selected.

Parcel:	194624140000B0010
Address:	1190 ESTERO BLVD 1190 ESTERO BLVD 1190 ESTERO BLVD 1190 ESTERO BLVD

Owner:

General Information

Prior Strap:
Legal Description:
Historical District:

Cases Associated with this Parcel Record

Case Number:	Description:	Status:
COM199008193	FABRIC AWNING"CASE RIGBY R.E."	Record is too old for any further action
DRV000030259	REPAVE DRIVEWAY	Issued
SGN220013764	SIGN FOR CANOPY (BP 199008193)	Finaled
SGN220053091	EURO DESIGNER HAUS/TEMP FLAGS+	Finaled

[Back to Search](#) [Top of Page](#)



Version: 3.5.3.20051221.03

Copyright © 2005 by Accela, Inc.
To comment on this page, send email to eConnect@leegov.com or call (239) 533-8329.

MEMORANDUM
FROM
THE DEPARTMENT OF
COMMUNITY DEVELOPMENT
DIVISION OF ZONING & DEVELOPMENT SERVICES

DATE: December 10, 2002

TO: Codes & Building Services

FROM: Jon Hagan,
Development Review
Representative

Re: Transmittal No. LDO2002-00351

00378

STRAP Number: 19-46-24-W4-0140B.0010

Subject: Extension of existing walkway

Location: 1188 & 1190 Estero Blvd., Ft. Myers Beach, Florida

Background Comments: Applicant wants to extend an existing walkway in order to create a safer walkway for customers.

Approved to pour an 8' x 22' (176 square feet +/-) concrete slab to extend an existing walkway.



LEE COUNTY

Case Activity Listing Case #: LDO2002-00378

12/26/2002
7:52:15AM

Description	Activity Entered Date	Target Date	Completed Date	Status	Assigned To	Done By	Notes
-------------	-----------------------	-------------	----------------	--------	-------------	---------	-------

Application Submitted	12/9/2002		12/9/2002	DONE		AXG	
Assign Checklists	12/9/2002	12/10/2002	12/9/2002	DONE	SLH	SLH	
Assign to Staff	12/9/2002	12/10/2002	12/9/2002	DONE	JGH	JGH	
Check legal	12/9/2002	12/13/2002	12/9/2002	N/A		JGH	
Initial GIS mapping	12/9/2002	12/13/2002	12/9/2002	N/A	JGH	JGH	
L99 Application (Transmit)	12/9/2002	12/11/2002	12/10/2002	APPR	JGH	JGH	JGH - L99 Approved to pour an 8' x 22' (176 square feet +/-) concrete slab to extend an existing walkway.

*Submitted after (15002002-00378) JGH
 have a copy of the permit
 of the permit.*

PROPOSED

DECK
FITTING



water

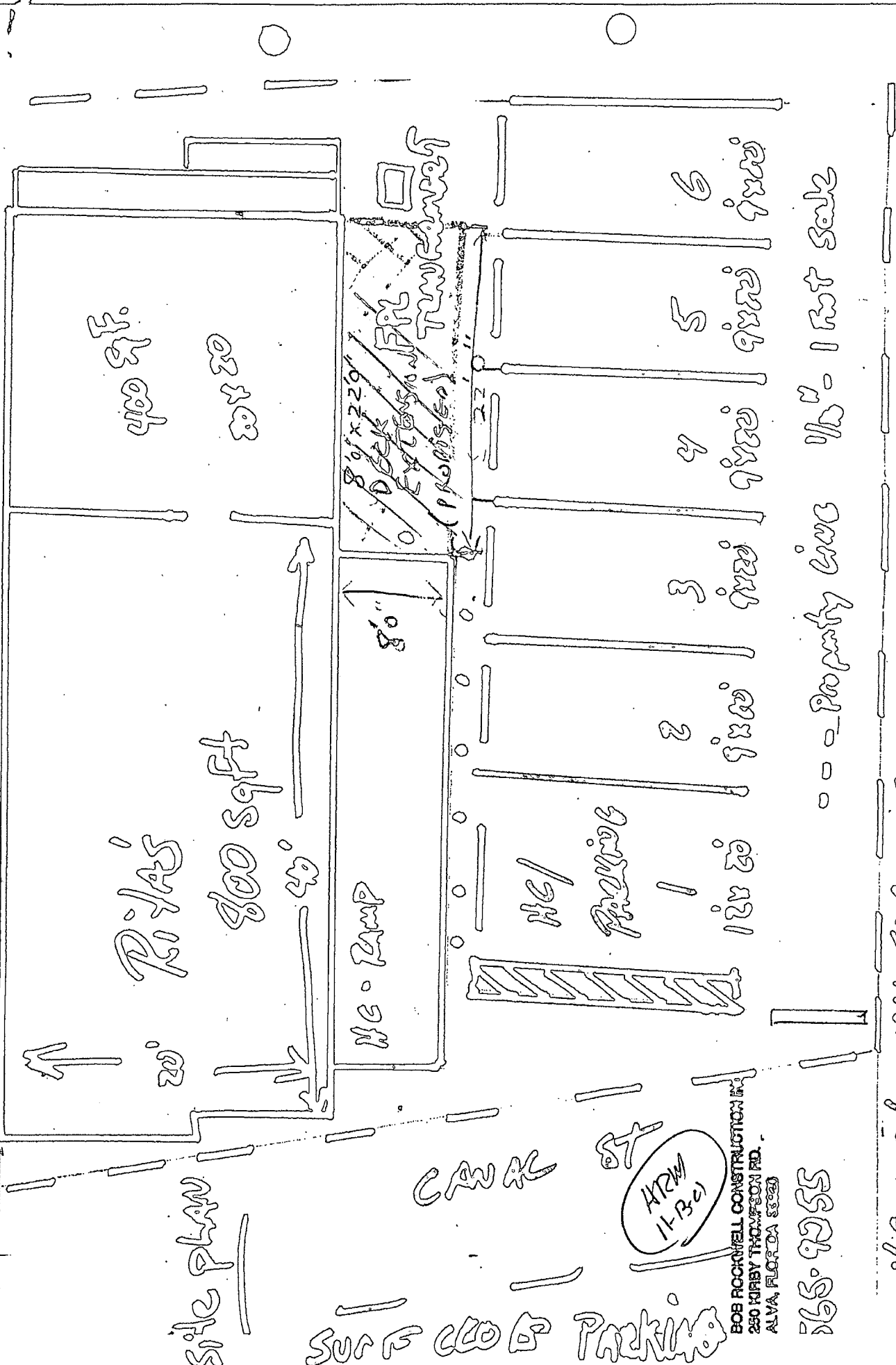

400 sqft.

80' x 20'

Riya's

800 sqft

40'

HG - Ramp

80'

8' x 22' Deck Extension (Proposed)

HE/ Parking

120 sqft

2

3

4

5

6

Property Line 1/2" - 1 foot scale

APRM 11-13-21

CAVAL ST

SURF CEO OF PARKING

BOB ROCKWELL CONSTRUCTION INC.
250 IRBY THOMPSON RD.
ALVA, FLORIDA 33420

765-9255

ZVL2006-00103

See Tab F