



Merrill Plaza Office/Retail FOR LEASE

1604 Merrill Dr, Suite C • Little Rock, Arkansas

Lease Rate:
\$950/month

**900 SF Available
for Lease**

-Tenant responsible
for utilities
-TI allowance
negotiable

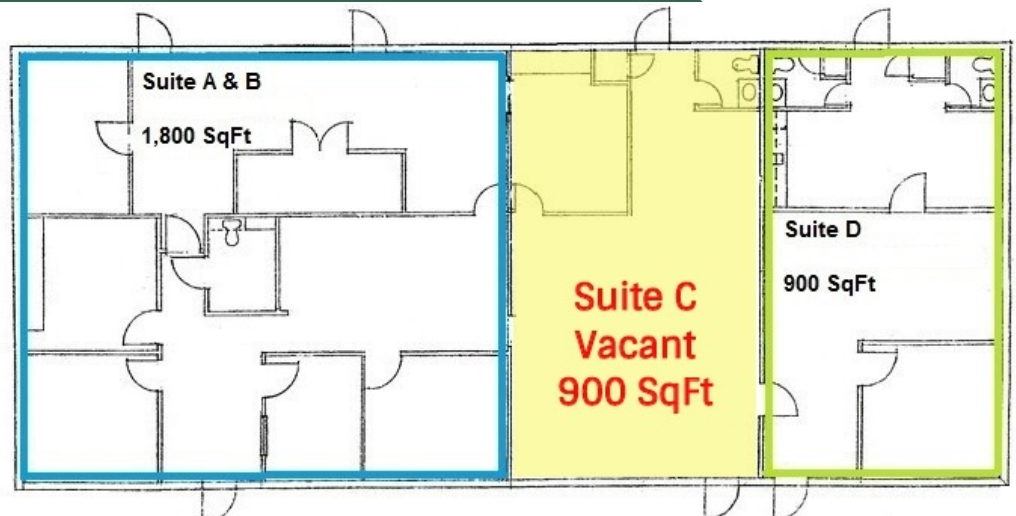

Perfect for office
or retail space
with easy access to
Interstate 430 and
ample parking.

Demographics:

	1 Mile	3 Miles	5 Miles
2015 Population	12,780	68,546	117,939
Avg HH Inc	\$61,147	\$70,918	\$62,558
Total HH	6,337	30,948	51,522

FOR MORE INFORMATION, CONTACT:

Lauren Frederick

Commercial Agent

501-374-2303

lfrederick@hosto.com

haybarrealestate.com

1602 & 1604 Merrill Dr. • Little Rock, Arkansas

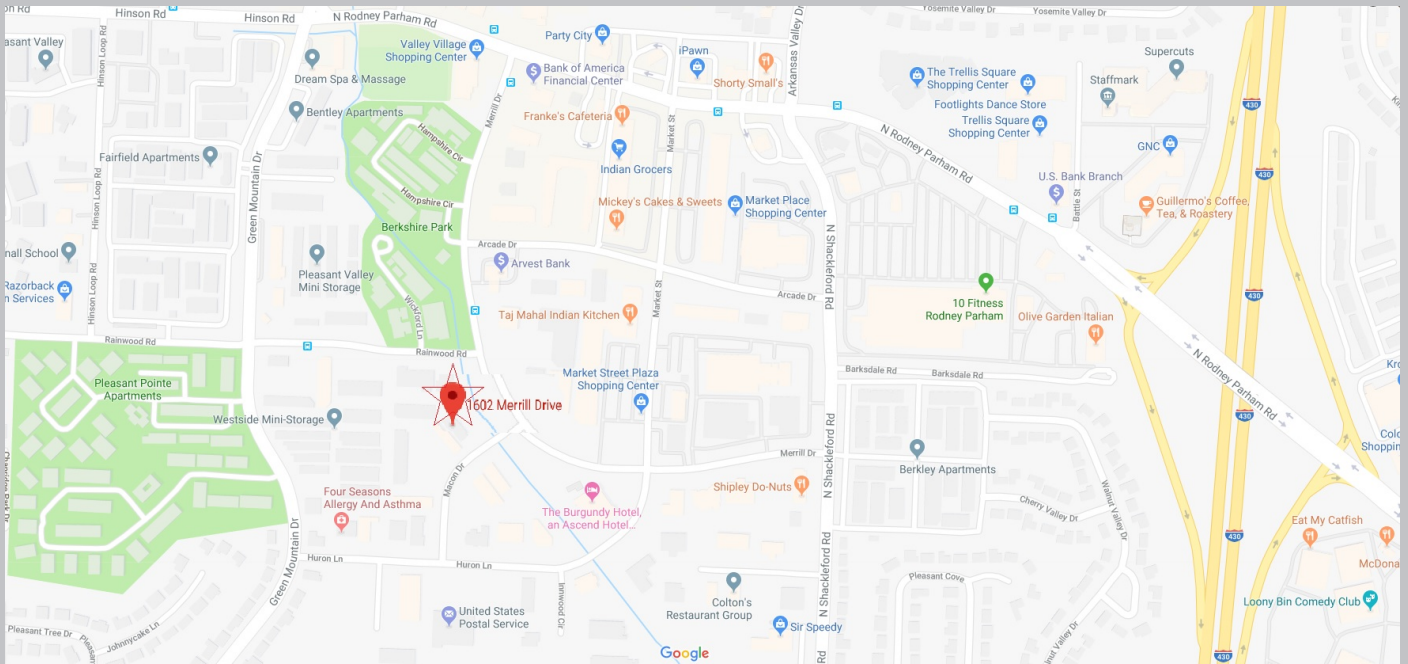

Located near Rodney Parham Road, off Rainwood Road & Merrill Drive.
Near national, regional and local retailers, restaurants and businesses.

All information contained herein is secured from sources we believe to be reliable. However, no information is guaranteed in any way. Any reproduction of this material is prohibited without consent of Haybar Real Estate.

AGENCY/OWNERSHIP DISCLOSURE

Haybar Real Estate is the agent for the owner of the property described herein and has an ownership interest.



701 W. 7th Street • PO Box 3395 • Little Rock, AR 72203 • (501) 374-2303 (O) • (501) 372-3850 (F)