

Soils Map

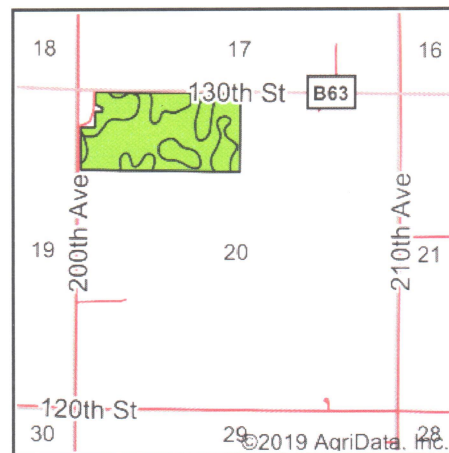

State: **Iowa**
 County: **Kossuth**
 Location: **20-94N-27W**
 Township: **Lu Verne**
 Acres: **72.47**
 Date: **2/20/2019**

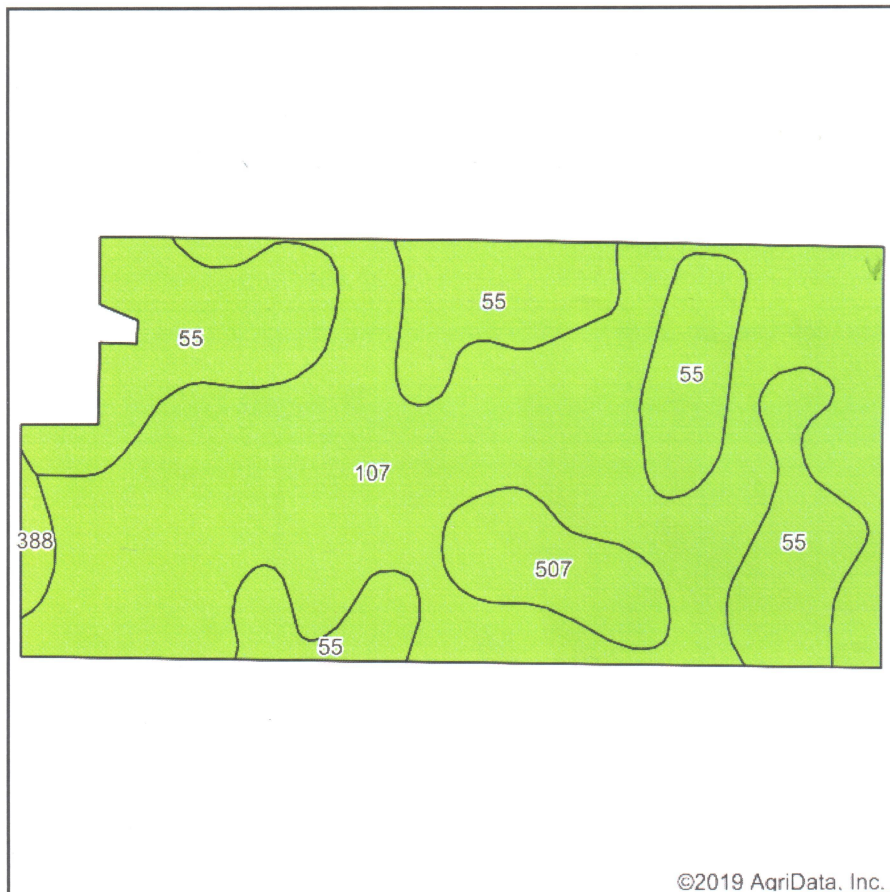

Soils data provided by USDA and NRCS.

Area Symbol: IA109, Soil Area Version: 24

Code	Soil Description	Acres	Percent of field	CSR2 Legend	Water Table	Restrictive Layer	Septic Limits	Foundation Limits	Non-Irr Class *c	CSR2**	CSR	*n NCCPI Soybeans
107	Webster clay loam, 0 to 2 percent slopes	43.15	59.5%		0ft.	> 6.5ft.	very limited	very limited	Ilw	86	80	80
55	Nicollet clay loam, 1 to 3 percent slopes	24.10	33.3%		3.7ft.	> 6.5ft.	very limited	very limited	lw	89	85	78
507	Canisteo clay loam, 0 to 2 percent slopes	4.39	6.1%		2ft.	> 6.5ft.	very limited	very limited	Ilw	84	75	79
388	Kossuth silty clay loam, 0 to 2 percent slopes	0.83	1.1%		0ft.	> 6.5ft.	very limited	very limited	Ilw	86	75	90
Weighted Average										86.9	81.3	*n 79.4

**IA has updated the CSR values for each county to CSR2.

*n: The aggregation method is "Weighted Average using major components"

*c: Using Capabilities Class Dominant Condition Aggregation Method

Soils data provided by USDA and NRCS.