

Neoprene Inserts

Blind threaded fastener that has a brass threaded insert molded into a neoprene bushing. Made of synthetic rubber and resistant to most chemicals, oils, and weather conditions . You can install this insert into through holes or blind holes without tools of any kind. This fastener makes the joint waterproof, isolates vibration and is electrically insulated.

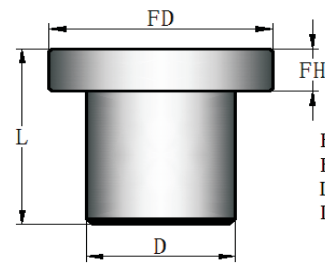

FD=Flange Diameter
 FH=Flange Height
 L =Length
 D =Diameter

UNIFIED THREAD SIZES (inch)			Hole Size	D. Nom	FD. Norn	L. Norn	FH. Norn
Thread Size	Part Number	Min-Max Grip	(+.000/- .006)	(+.000/- .006)	(+/- .006)	(+/- .006)	(+/- .006)
6-32	GFEC632	0.375-0.607	0.250	0.240	0.554	0.981	0.035
6-32	GFEE632	0.015-0.156	0.312	0.312	0.452	0.499	0.062
8-32	GFEB832	0.015-0.156	0.312	0.312	0.438	0.499	0.052
8-32	GFEC832	0.015-0.172	0.312	0.312	0.750	0.560	0.060
8-32	GFE2D832	0.015-0.050	0.312	0.310	0.500	0.430	0.050
10-24	GFEL1024	0.030-0.227	0.375	0.375	0.562	0.767	0.187
10-32	GFE10S	0.015-0.192	0.375	0.375	0.500	0.554	0.036
10-32	GFE10SL	0.312-0.643	0.375	0.375	0.562	1.051	0.051
10-32	GFE10XL	0.812-1.143	0.375	0.375	0.562	1.551	0.051
10-32	GFEG1032	0.030-0.227	0.375	0.375	0.750	0.807	0.187
10-32	GFEH1032	0.312-0.450	0.375	0.375	0.554	0.847	0.035
10-32	GFEJ1032	0.030-0.227	0.375	0.375	0.750	0.700	0.080
10-32	GFE01032	0.035-0.232	0.375	0.375	0.562	0.665	0.040
1/4-20	GFE1/4S	0.015-0.111	0.500	0.500	0.630	0.630	0.051
1/4-20	GFED1420	0.031-0.187	0.500	0.500	0.750	0.829	0.187
1/4-20	GFEJ1420	0.250-0.457	0.500	0.500	0.635	1.051	0.051
5/16-18	GFEE51618	0.015-0.156	0.625	0.620	0.875	0.725	0.125
5/16-18	GFEE51618	0.156-0.375	0.625	0.620	0.875	1.100	0.225
3/8-16	GFEA3816	0.015-0.437	0.750	0.750	1.250	1.062	0.187

Standard Neoprene Inserts are manufactured of Neoprene with a brass insert. EPDM and Nitrile rubber compounds available in most sizes as special order.