

CL Challenger Lifts

INSTALLATION & OPERATION MANUAL SUPPLEMENT 7,000LB PAD ADAPTER

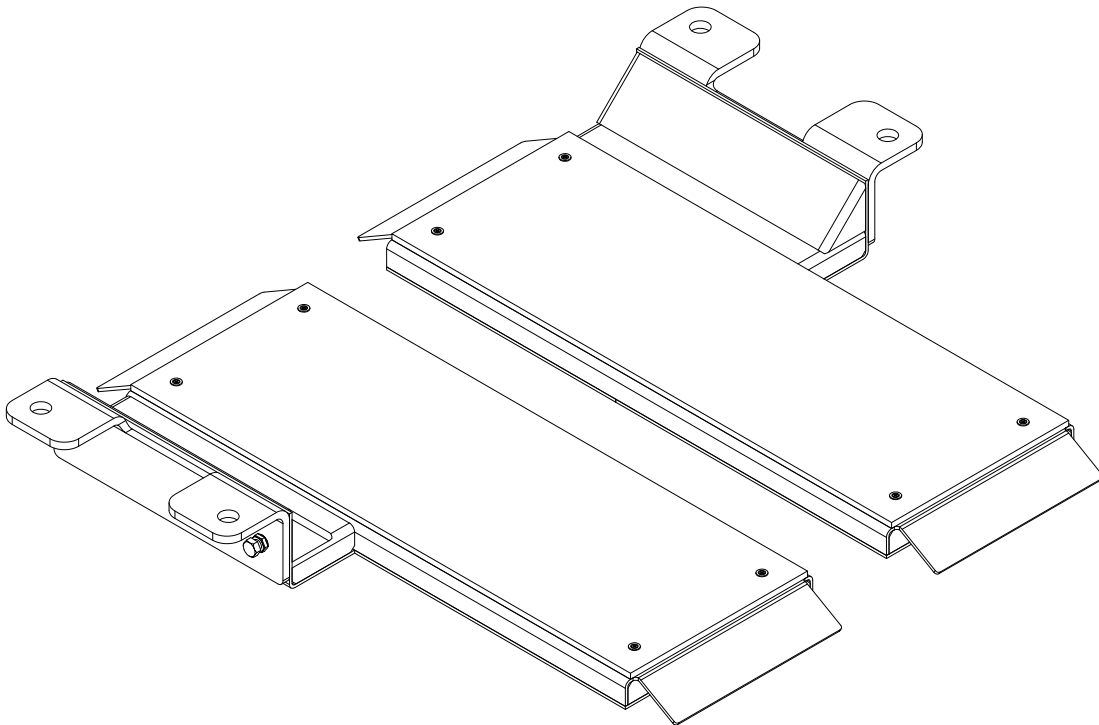

FOR MODELS CL9 & CL10

200 CABLE STREET, P.O. BOX 3944 LOUISVILLE, KENTUCKY 40201-3944
EMAIL: SALES@CHALLENGERLIFTS.COM WEB SITE: WWW.CHALLENGERLIFTS.COM
OFFICE 800-648-5438 / 502-625-0700 FAX 502-587-1933

**IMPORTANT: READ THIS MANUAL COMPLETELY BEFORE INSTALLING OR
OPERATING LIFT**

Read entire manual before assembling, installing, operating, or servicing this equipment. Proper maintenance and inspection is necessary for safe operation. DO NOT operate a damaged lift.

CL9 & CL10 Pad Adapter
Installation & Operation Supplement

General Specifications

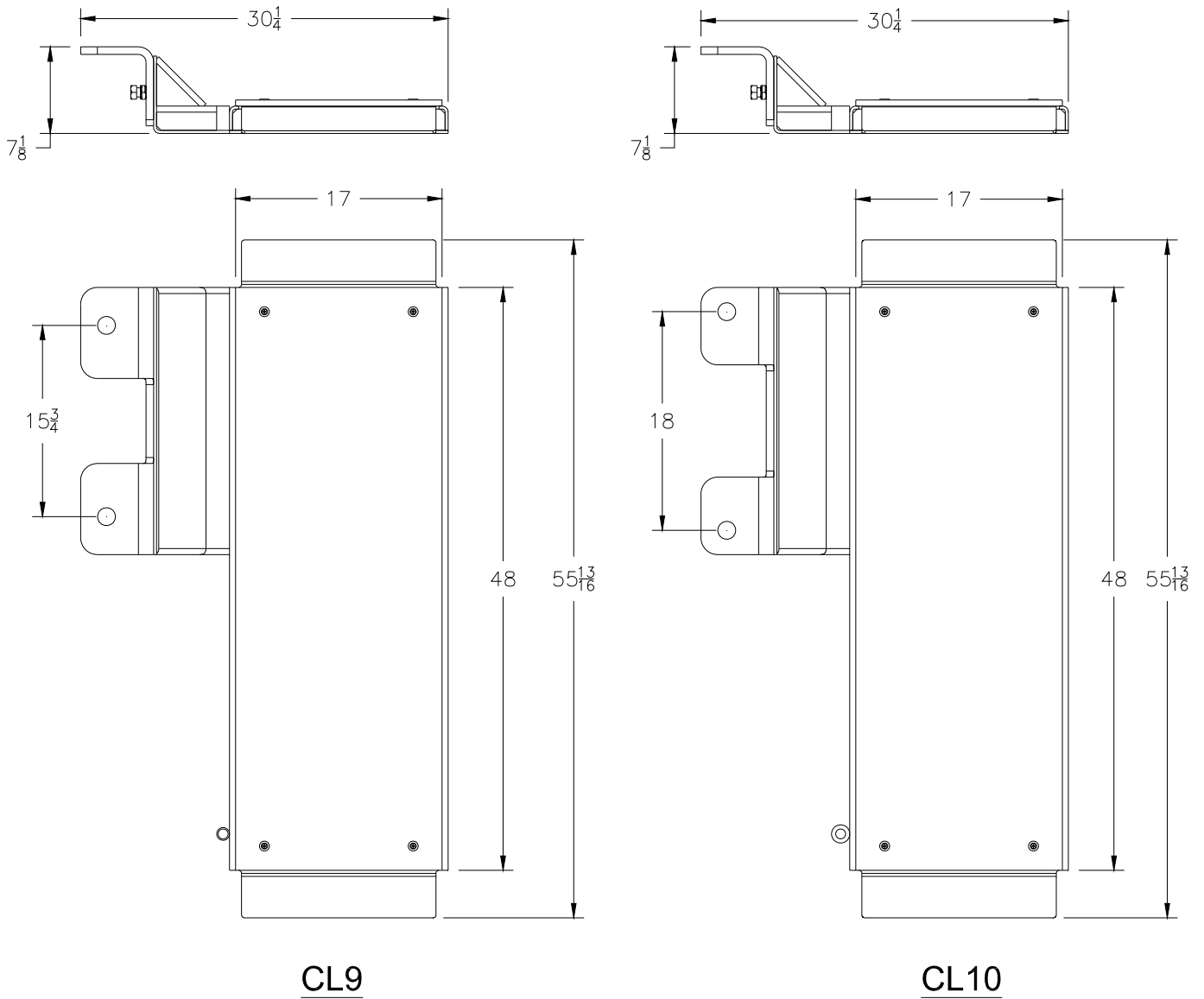

Figure 1

CL9 & CL10 Pad Adapter
Installation & Operation Supplement

INSTALLATION

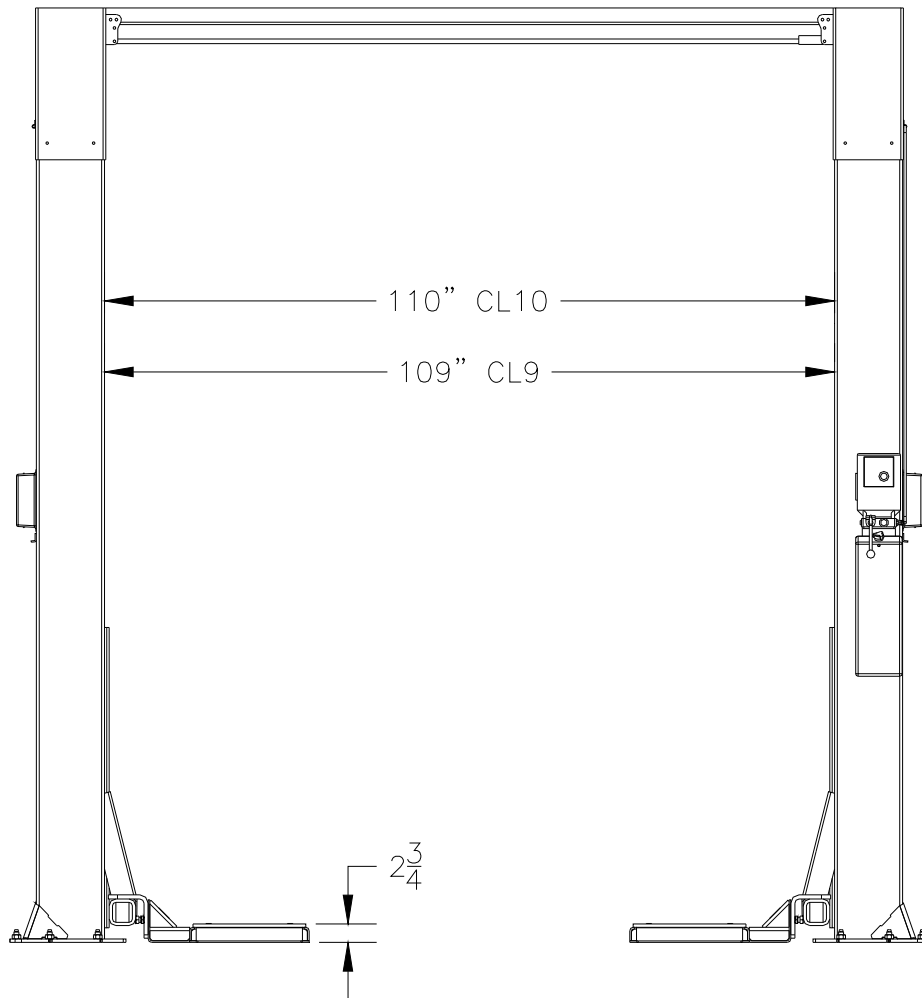
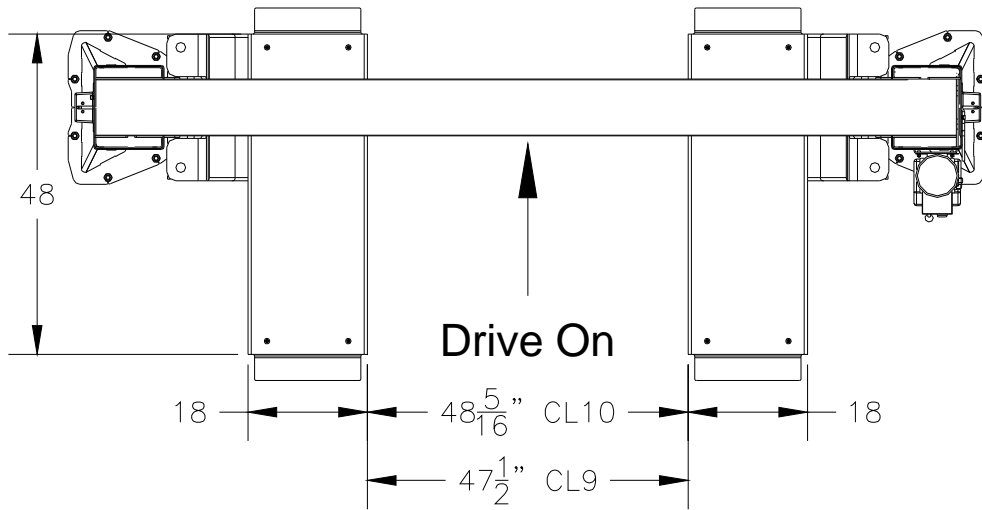

Figure 2

CL9 & CL10 Pad Adapter
Installation & Operation Supplement

1. The Pad Adapters are designed to be installed on the CL9 with a inside to inside column dimension of 109", and on a CL10 with a inside to inside column dimension of 110". See Figure 2.

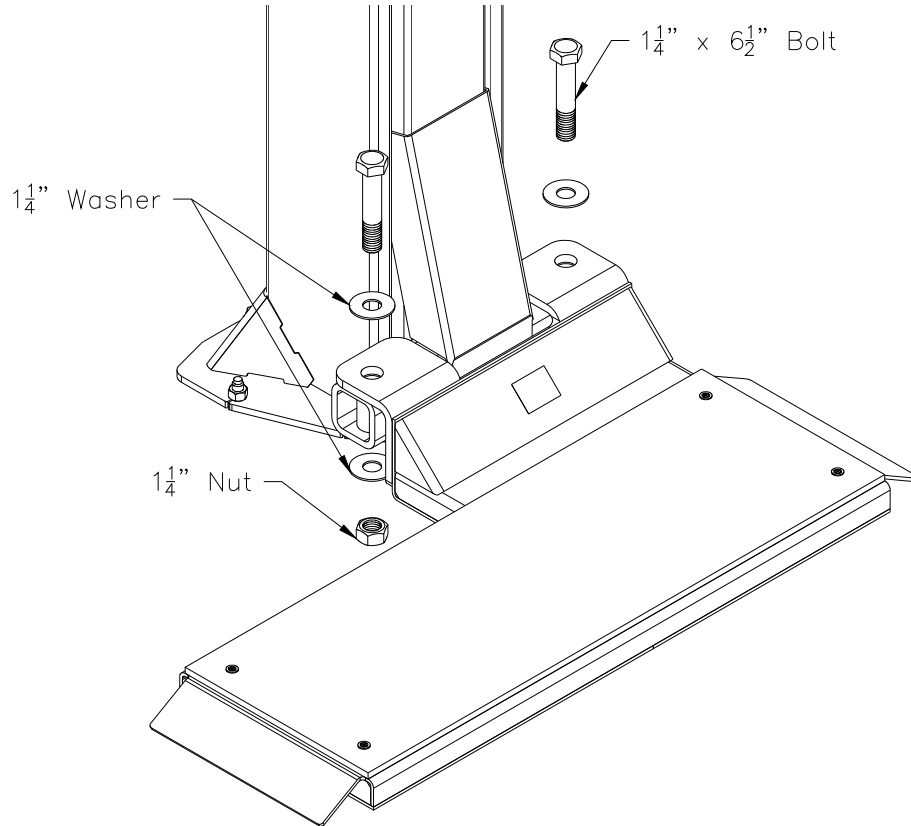

Figure 3

2. Using supplied hardware, install the Pad Adapters as shown in Figure 3. Note Pad Adapter orientation in Figure 2.

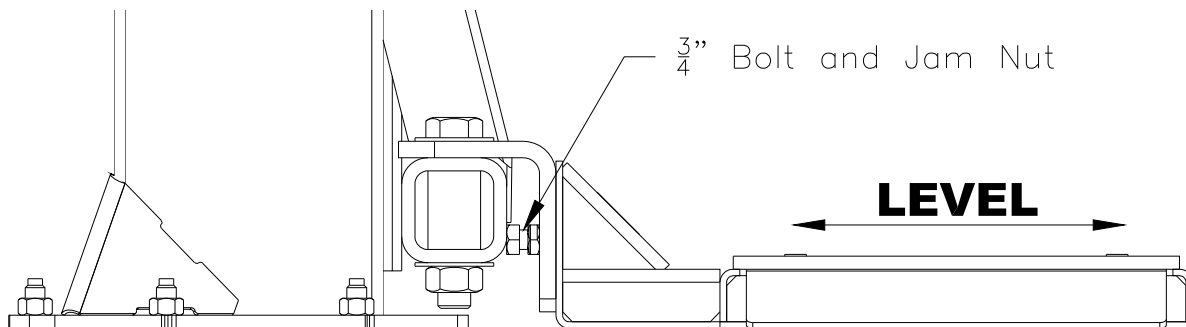

Figure 4

3. Adjust $\frac{3}{4}$ " Bolt and Jam Nut so Pad Adapter is level. See Figure 4.

CL9 & CL10 Pad Adapter
Installation & Operation Supplement

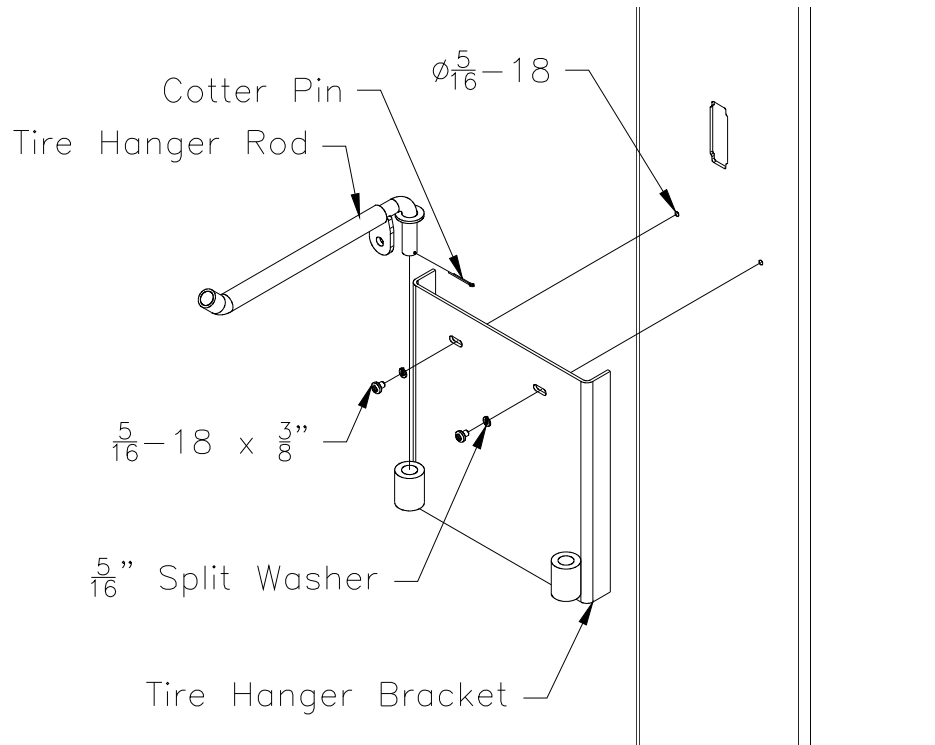
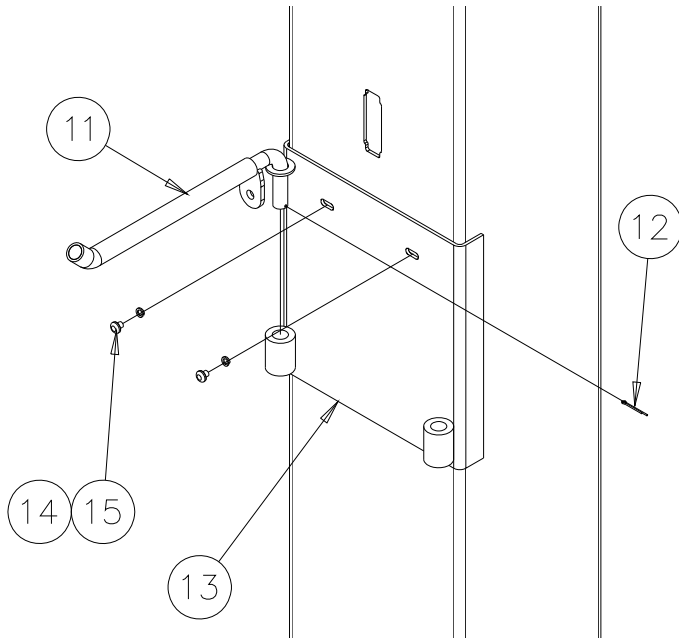
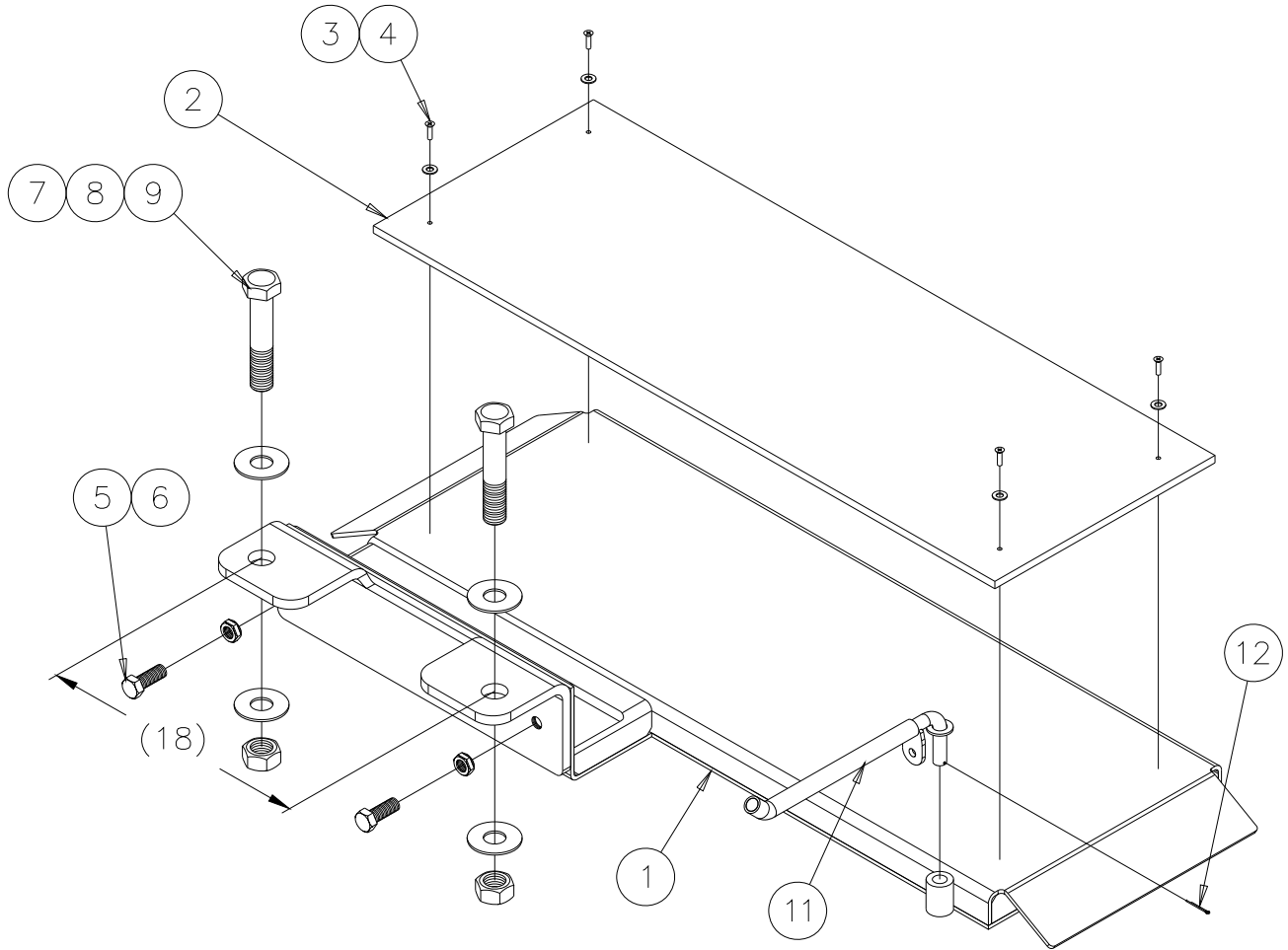

Figure 5

4. Locate the $\frac{1}{4}$ " holes already in the column and tap 5/16-18 NC. If there are accessories located at that location find a suitable working height and using the Tire Hanger Bracket as a template drill two $\frac{1}{4}$ " holes and tap 5/16-18 NC. See Figure 5.
5. The Tire Hanger Rod's are installed into the sleeves on the Tire Hanger Bracket and on the Pad Adapters, use supplied Cotter Pin during installation.

CL9 & CL10 Pad Adapter
Installation & Operation Supplement

PARTS BREAKDOWN CL9 & CL10



CL9 & CL10 Pad Adapter
Installation & Operation Supplement

Item #	Part #	Qty./Lift	Description
1	P1002-01	1	CL9 Pad Adapter Weld-Left
	P1002-02	1	CL9 Pad Adapter Weld-Right
	P2002-01	1	CL10 Pad Adapter Weld-Left (Shown)
	P2002-02	1	CL10 Pad Adapter Weld-Right
2	P1002-03	2	Rubber Pad
3	427041	8	¼-20 Self Tapping Screw
4	4100082	8	Washer, 13/32 x 13/16
5	10028	4	¾-10 x 2 Hex Head Cap Screw, Gr. 5
6	10029	4	¾-10 Jam Nut
7	10030	4	1 ¼"-7 x 6 ½" HHCS, Plated, Grade 5
8	10032	8	1 ¼" Flat Washer, Plated
9	10031	4	1 ¼"-7 Steel Lock Nut, Plated
10	10048	2	Capacity Decal (Not Shown)
11	TH-01	4	Tire Hanger Assembly
12	40126	4	Cotter Pin
13	P1002-06	2	CL9 Channel Weld-Front Tire Hanger
	P2002-04	2	CL10 Channel Weld-Front Tire Hanger
14	10335	4	5/16-18 x 3/8" Phillips Pan HD Screw
15	31331	4	5/16" Split Lock Washer