

America's Finest Travel Trailer

AVION

BY FLEETWOOD®



1989

FLEETWOOD and WALT DISNEY WORLD

Bring You the Best in Family Fun!



Now is the time to look at the new Avion, one of the Official RVs of Fort Wilderness at the WALT DISNEY WORLD Resort. Only **Fleetwood** makes them. Why? Because throughout the RV lineup from Fleetwood, America's No. 1 builder, you'll find top family value.

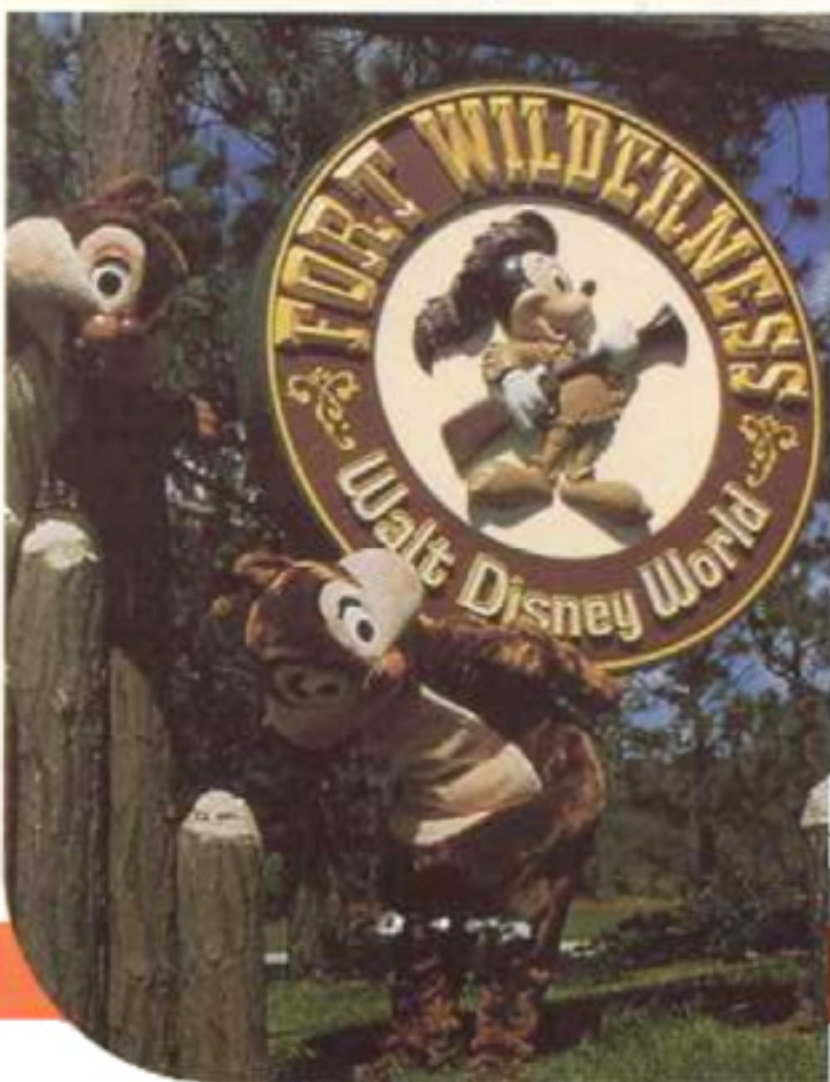

After you've purchased your new Avion, plan the "break-in" trip to Fort Wilderness. While you're there, be sure to stay at the Fort Wilderness Campground Resort. And, take your family to Pioneer Hall for the Fleetwood-sponsored Hoop-Dee-Do Musical Revue. It's a foot-stompin', hand-clappin' extravaganza you'll never forget.

FLEETWOOD

The 1989 Avion is the epitome of livability. Throughout, tasteful furnishings and proven floor plans contribute to fun, relaxation and the joy of long-term vacations. The classic woodwork and brass hardware make a statement of all-American, through and through.



The 1989 Avion is tastefully trimmed in blue, burgundy and grey . . . a dynamic statement of its fine quality. It is totally prepared for extended travel with full residential level interior appointments.



A LIGHTING

Residential lighting is contributed by the new reading lamp. It's portable and may be used throughout the Avion living areas.

B BEDROOM

Depending upon the model, Avion travel trailers are available with twin, double or queen bed as shown. The Sealy® mattress is standard equipment.

C AM/FM STEREO

The front overhead cabinet contains the AM/FM/Cassette stereo tuner. The tuner is equipped with "seek and scan" and is all electronic. Four 2-way speakers are included in the sound system. Cassette tape library trays are spring loaded for safe tape storage and travel security.

D TV CABINET

The TV table is designed for the contemporary, portable TV. The shelf recesses out of the way when not in use (in select models). TV antenna and wiring for the park cable TV co-axial cable is standard.

E BATH

All Avion models are equipped with a large tub/shower for personal convenience and comfort. A cast-in shower seat and Fan-Tastic® vent fan are included. The bath vanity countertop is covered with self-edged high-impact marble finish laminate for durability and elegance. A residential quality single-mix faucet is standard.





F GALLEY

Avion's galley reflects careful planning with its large, overhead storage cabinets. The double bowl residential quality porcelain sink is equipped with single mix faucet plus purified fresh water dispenser. A four burner LPG range/oven and Magic Chef® electronic "Touch Control" microwave with "Browning" oven are standard. An optional 4 burner cooktop and deluxe convection/microwave oven is available.

G CLOCK

This residential wall clock is also part of Avion's impressive interior.

H RECESSED LIGHTING

Interiors are enhanced by Avion's recessed fluorescent lighting.

International Travel Club

Membership in the Avion International Travelcade Club is available to all Avion owners. Highlights include professionally planned Travelcades, three International Rendezvous as well as State Unit Rallies. The club offers the ideal opportunity to make new friends and enjoy the camaraderie found with Avion ownership. For complete details, contact

Executive Secretary
Avion Travelcade Club, Box 236
DeBary, Florida 32713

Nationally known products within Avion include: Magic Chef®, Dometic®, Scotchgard®, Flexsteel®, Suburban®, Sealy®, Armstrong®, Wilsonart®, Hydroflame® and Coleman®.

A DINETTE

You'll dine in total comfort while seated on the 5" thick Superfoam cushions. Scotchgard® protected upholstery provides durability and easy maintenance. Beneath each seat, a generous storage compartment for less frequently used items. Flex-O-Lator® springs and hardware provide residential comfort plus 2-position seating for dining or relaxing.

B ELEGANT DETAIL

Both the dining table and galley tops are trimmed with wood to enhance the quality interior in the 1989 Avion.

C MONITOR PANEL

Avion's monitor panel contains a 12 Volt disconnect switch to power down all 12V circuits when not in use. Other functions include LP gas reserve, battery condition, barometer, thermometer and hygrometer.





Step aboard on Avion's durable steel double step that has rounded corners and non-skid edges for your personal safety. Convenient night lights are also included.

An all aluminum LPG tank cover protects the LP tanks from road hazards. The hinged ABS top allows for quick inspection of the visual gas reserve gauge.



AVION BASEMENT MODELS

MODELS 34VB AND 34XB ARE OFFERED WITH ADDITIONAL STORAGE CAPABILITY FOR THE FULL TIMER OR FAMILY WHO TAKES EXTENDED RANGE VACATIONS. UNIQUE FEATURES INCLUDE:

- Dual furnaces — controlled heating
- Increased fresh & waste water/holding capacity — greater range
- Concealed LPG tanks — appearance, cleaner hitch, tanks protected
- Triple entry steps — personal convenience
- Entire inside floor all flat — no wheel well intrusion, more storage
- Central utility compartment — hookups fully protected
- Extra capacity exterior compartments — perfect for the extended range cruise, full timing

LP tanks and batteries are concealed within the Avion body for full protection.



3-tier steps make entry/exit easy. Steps fold into trailer body for travel.

Extra capacity exterior compartments enable you to "take it with you".



28A

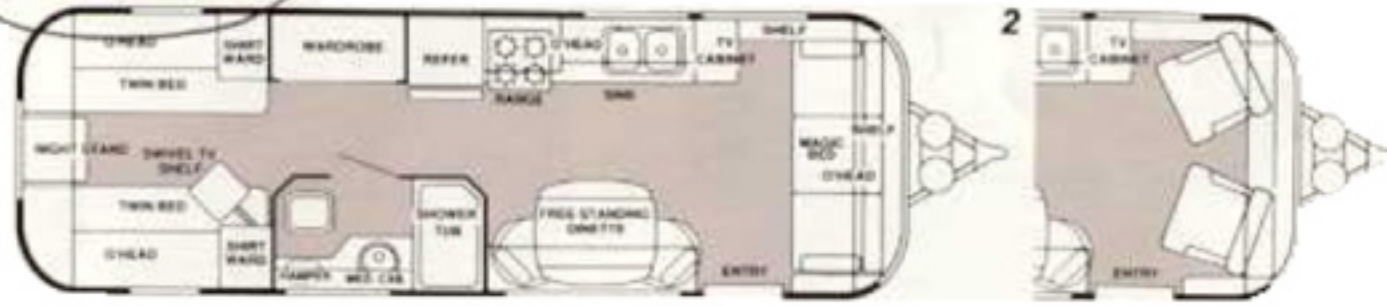

This smaller model offers full conveniences of home. **HIGHLIGHTS** — free standing dinette for seating and room arrangement choice, full side bath with adjacent wardrobe. Option (1) double bed (2) swivel recliners.

30P

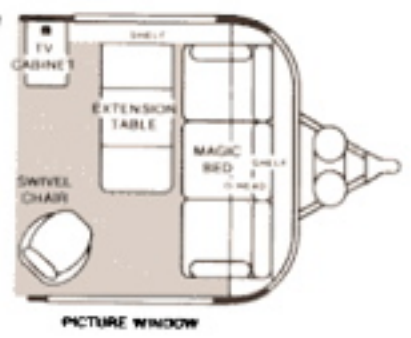

This mid-size model offers excellent towing characteristics and livability. **HIGHLIGHTS** — front living room also offers very comfortable dining as well as guest sleeping capability. Rear bath and center bedroom can be made totally private. Note the abundant wardrobe space in the bath. Option (1) front Magic Bed®.

32S

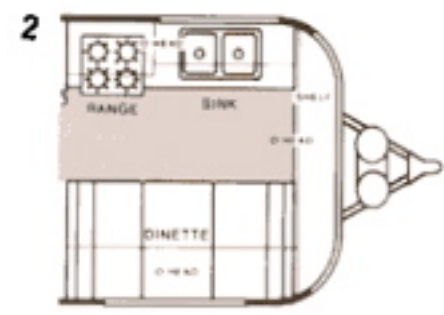
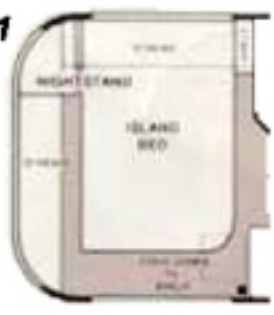
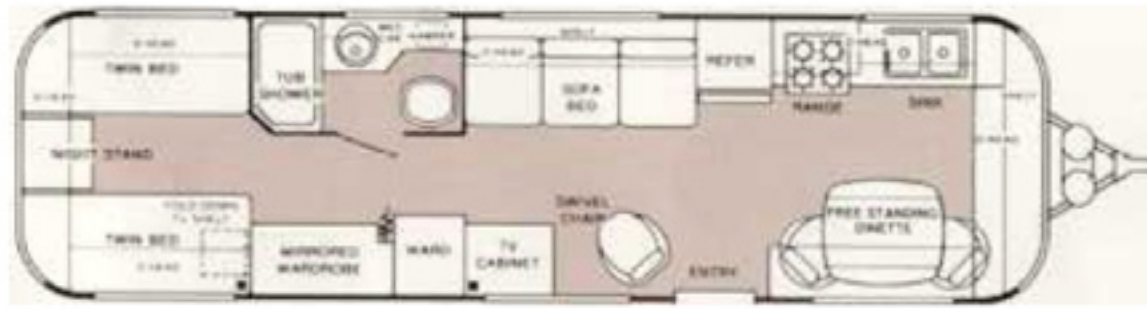

This model offers numerous owner benefits. **HIGHLIGHTS** — center living room offers "at home" welcome to friends. Front galley and free-standing dinette provides for private dining or separate entertaining. Bath and bedroom can be made totally private with the folding, wooden door. Options (1) double bed (2) traditional dinette.

34V

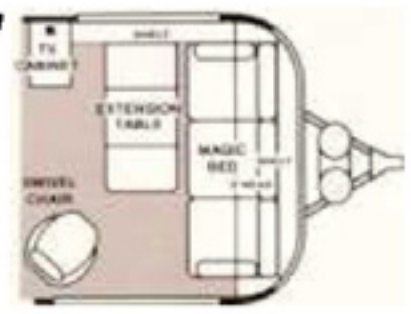

This traditional plan offers three distinct living areas. **HIGHLIGHTS** — the Magic Bed® converts for guest and family sleeping. The living room can be made night-time private with the folding wooden door. Abundant wardrobe storage is found throughout. Option (1) front Magic Bed®. Also available with basement storage exterior compartments (Model 34VB).

America's Finest Travel Trailer

34W



This proven model offers four distinct living areas for the family. **HIGHLIGHTS** — large, convenient center wardrobe facility plus twin folding wooden doors outside the bath to create a private dressing area. Options (1) double bed (2) front Magic Bed®.

34X



This new model has spacious living areas throughout. **HIGHLIGHTS** — intimate front living room and full walk-through bath with alternate privacy provisions; queen size bed. Options (1) twin beds (2) side Magic Bed®. Also available with basement storage exterior compartments (Model 34XB).

38 5M



ALL NEW 5TH WHEEL MODEL WITH SLIDE OUT OPTION

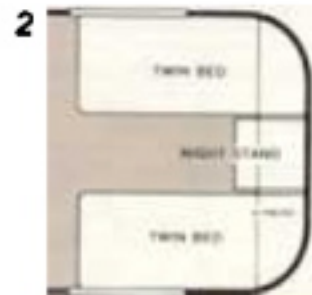
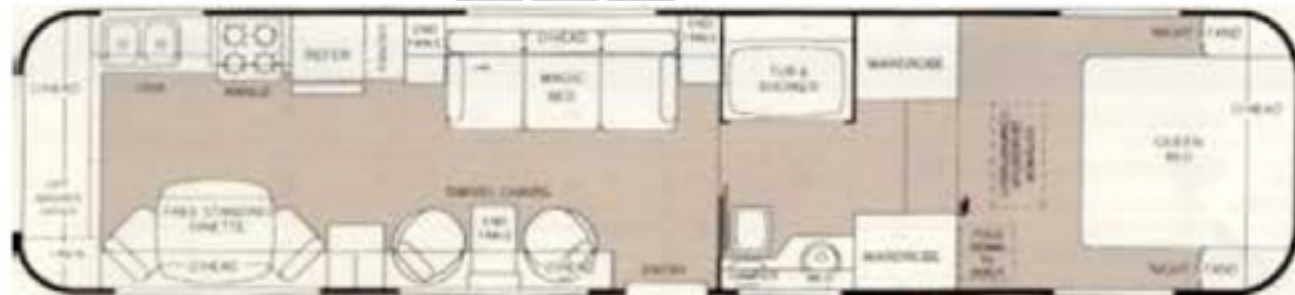

Avion's 5th wheel offers total elegance throughout. **HIGHLIGHTS** — free standing dinette for seating and room arrangement choice, four distinct living areas. This model is equipped with basement storage. Options (1) power slide out (2) twin beds. (Request delivery information from your Avion dealer.)



The 1989 Avion travel trailer is offered in seven basic models ranging in size from the efficient Model 28A to the impressive thirty-six foot fifth-wheel. Two of the travel trailer models as well as the fifth-wheel are offered with basement storage.

Avion Hidden Features

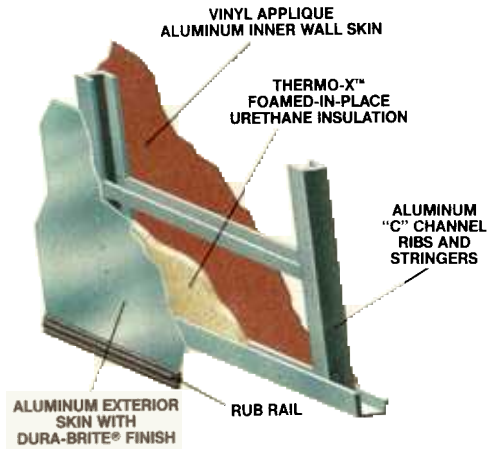

Wall Construction

In line with traditional aircraft construction, Avion's inner aluminum wall and outer aluminum skin is supported by aluminum ribs and stringers. The Thermo-X™ insulation is foamed in place and creates uniform thermal and sound insulation throughout. New Dura-Brite® exterior offers easy maintenance and superior finish.

AL-KO® Suspension

Tested on Europe's Auto Bahn, AL-KO® suspension provides incredibly smooth towing and handling — for your safety and protection of on-board personal goods.

Fully independent suspension • Patented hexagonal design for maximum shock absorption • Safe, smooth, quiet ride • Maintenance free, no metal to metal contact • Faster, easier installation • Lower center of gravity, improved stability • Capacities from 500 to 7,000 pounds • Manufactured in U.S.A.

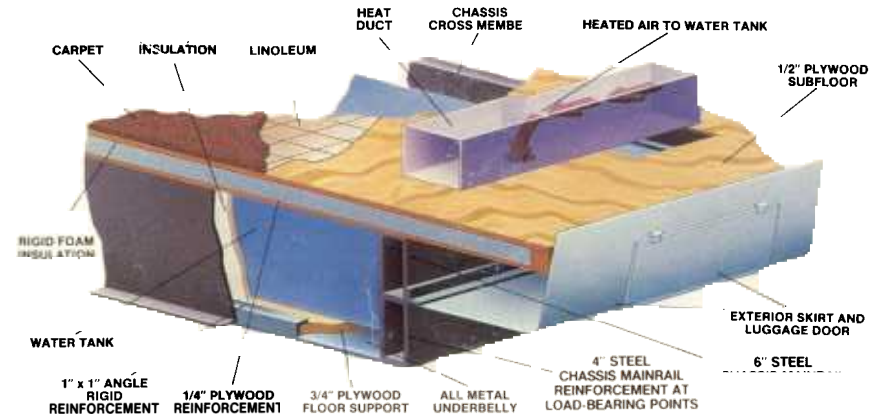
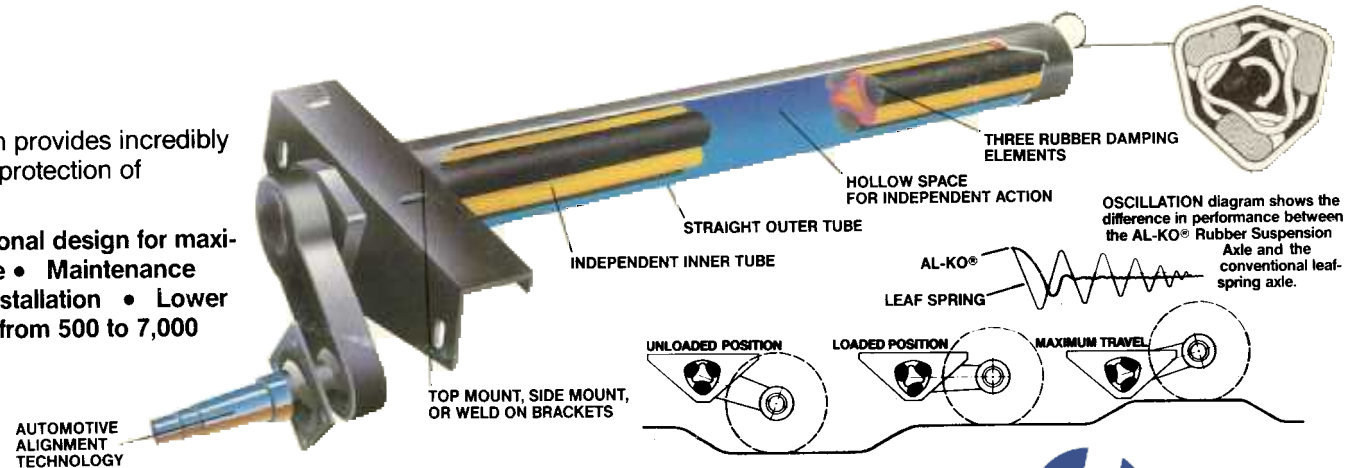

Floor Construction

Floor construction assures the strength, durability, and convenience you expect from Avion. All water and plumbing lines are contained within the floor and protected by the full length all metal underbelly. Basement floor construction differs somewhat.

Avion Travel Trailers are manufactured by this subsidiary of Fleetwood Enterprises, Inc.

Avion Coach Corporation

1300 E. Empire Avenue
Benton Harbor, Michigan 49022

Your Local Avion Dealer Is:



HAROLD'S RV CENTER
7255 AIRPORT RD.
BATH, PA. 18014
215-837-9280

AVION

FLEETWOOD®

FLEETWOOD ENTERPRISES, INC.

P.O. Box 7638
Riverside, California 92523

If It's Built By Fleetwood, It's Built For Fun!