

## Expandet Nylon Cavity Anchor with screw

Expandet Nylon Cavity Anchor with screw is effective in most of the quick and light solutions in both 1 and 2 layer of plasterboard or other materials as chipboards, gypsum fiber boards and other walls with cavities.

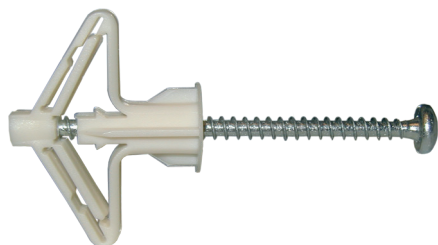

### INSTALLATION:

#### ADVANTAGES

- This product is useable in 1 and 2 layer plasterboards.
- The wings of the dowel prevents rotation in the dilled hole.
- Large selection of usable screws.

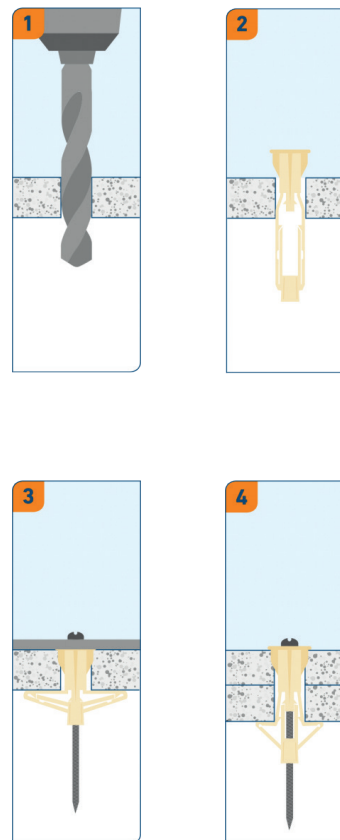

Type	Layer	Load capacities
DIMENSION	1 or 2 layers (12-24 mm)	$N_{rec}$
		Recommended tension load kN*
4 x 60	1	0,12
4 x 60	2	0,17

- \* Loads are recommended maximum in plasterboards with 300 mm spacing between each Nylon Cavity Anchor with screw. Safety factor is included ( $\geq 3$ ). 1 kN  $\approx$  100 kg.

**NOTE:** Is the recommended spacing not applied the load-capacity will be reduced. Free space behind the sheet:  $\geq 35$  mm.

## Expandet Nylon Cavity Anchor with screw

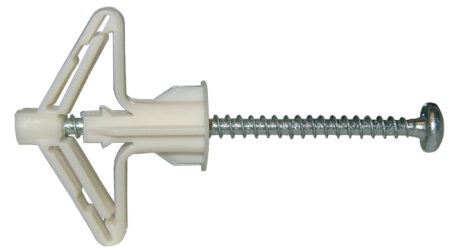

### PROPERTIES:

TYPE DIMENSION	THICKNESS OF BOARD MM	DRILL DIA. MM	LENGTH OF SCREW MM	FITTING THICKNESS (MAX.) MM	EXPANDET ARTICLE NO.	PCS. PER BOX	EAN 13 PER BOX
4 x 60	12- 24	10	60	15	900099	50	5708620200392

#### APPLICATIONS:

- Mounts
- Lighting
- Electrical installations
- HVAC and plumbing fixings

#### ALSO SUITABLE FOR FOLLOWING BASE MATERIALS:

- Gypsum plasterboard
- Gypsum plasterboard composite
- Timber-based building board