

## Dimensions : MORSE tapers

MORSE (T1)	D	D1	d2	L3	L4	b
0	0.356	0.362	0.240	2.224	2.342	0.153
1	0.475	0.480	0.354	2.441	2.579	0.205
2	0.700	0.709	0.551	2.953	3.150	0.248
3	0.938	0.949	0.752	3.700	3.898	0.311
4	1.231	1.244	0.992	4.626	4.882	0.469
5	1.748	1.760	1.437	5.886	6.142	0.626
6	2.494	2.512	2.063	8.268	8.583	0.748

## Dimensions : JACOBS tapers

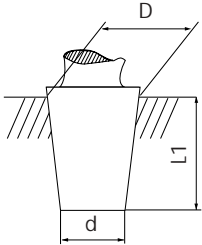

JACOBS (E2)	D	d	L1
0JT	0.250	0.228	0.437
1JT	0.384	0.333	0.656
2shJT	0.549	0.488	0.750
2JT	0.559	0.488	0.875
33JT	0.624	0.560	1.000
6JT	0.676	0.624	1.000
3JT	0.811	0.746	1.219
4JT	1.124	1.037	1.656
5JT	1.413	1.316	1.875

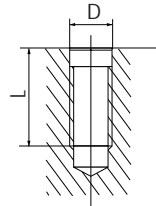

## Dimensions : UNF and UN internal thread

UNF - UN (E3)		D	Number of threads per inch	L min.
5/16-24UNF	3B	0.312	0.042	0.551
3/8-24UNF	3B	0.375	0.042	0.571
1/2-20UNF	3B	0.500	0.050	0.630
5/8-16UN	3B	0.625	0.062	0.748
3/4-16UNF	3B	0.750	0.062	0.748

**Spare parts :** Specify the name of the part and the chuck number.

**Note :** Jaws and nut must be ordered as set.



Jaws (3)



Nut



Sleeve



Ring

**Spare parts :** Specify the name of the part and the chuck



Jaws (3)



Screw



Sleeve

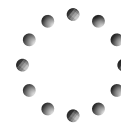

Balls



Lock Ring