

ISO Hardware & Seals

ISO CENTERING RINGS

*Material: SS 304 / Aluminum



Part Number (SS 304)	Part Number (Aluminum)	Size	A	B	C	D
ISO-CR-63	ISO-CR-63-AL	ISO63	68.00	70.00	3.90	8
ISO-CR-80	ISO-CR-80-AL	ISO80	81.00	83.00	3.90	8
ISO-CR-100	ISO-CR-100-AL	ISO100	100.00	102.00	3.90	8
ISO-CR-160	ISO-CR-160-AL	ISO160	151.00	153.00	3.90	8
ISO-CR-200	ISO-CR-200-AL	ISO200	210.00	213.00	3.90	8
ISO-CR-250	ISO-CR-250-AL	ISO250	256.00	261.00	3.90	8
ISO-CR-320	ISO-CR-320-AL	ISO320	311.15	316.48	5.50	14
ISO-CR-400	ISO-CR-400-AL	ISO400	392.93	398.02	5.50	14

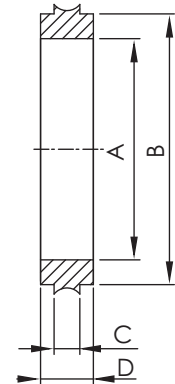

*Note: SS 316L Material Available on Request.

**ISO
NW**

ISO CENTERING RINGS with O-RINGS

*Centering Ring Material: SS 304

*O-Ring Material: FKM / NBR



Part Number (FKM)	Part Number (NBR)	Size	A	B	C	D
ISO-CRO-63	ISO-CRO-63-NB	ISO63	68.00	70.00	3.90	8
ISO-CRO-80	ISO-CRO-80-NB	ISO80	81.00	83.00	3.90	8
ISO-CRO-100	ISO-CRO-100-NB	ISO100	100.00	102.00	3.90	8
ISO-CRO-160	ISO-CRO-160-NB	ISO160	151.00	153.00	3.90	8
ISO-CRO-200	ISO-CRO-200-NB	ISO200	210.00	213.00	3.90	8
ISO-CRO-250	ISO-CRO-250-NB	ISO250	256.00	261.00	3.90	8
ISO-CRO-320	ISO-CRO-320-NB	ISO320	311.15	316.48	5.50	14
ISO-CRO-400	ISO-CRO-400-NB	ISO400	392.93	398.02	5.50	14

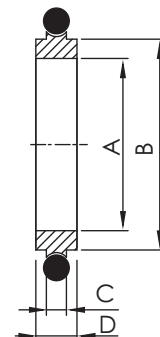

ISO CENTERING RINGS with O-RINGS, ALUMINUM

*Centering Ring Material: Aluminum

*O-Ring Material: FKM / NBR



Part Number (FKM)	Part Number (NBR)	Size	A	B	C	D
ISO-CRO-63-AL	ISO-CRO-63-AL-NB	ISO63	68.00	70.00	3.90	8
ISO-CRO-80-AL	ISO-CRO-80-AL-NB	ISO80	81.00	83.00	3.90	8
ISO-CRO-100-AL	ISO-CRO-100-AL-NB	ISO100	100.00	102.00	3.90	8
ISO-CRO-160-AL	ISO-CRO-160-AL-NB	ISO160	151.00	153.00	3.90	8
ISO-CRO-200-AL	ISO-CRO-200-AL-NB	ISO200	210.00	213.00	3.90	8
ISO-CRO-250-AL	ISO-CRO-250-AL-NB	ISO250	256.00	261.00	3.90	8
ISO-CRO-320-AL	ISO-CRO-320-AL-NB	ISO320	311.15	316.48	5.50	14
ISO-CRO-400-AL	ISO-CRO-400-AL-NB	ISO400	392.93	398.02	5.50	14

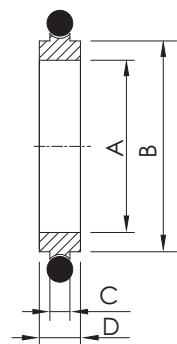

ISO Hardware & Seals

ISO CENTERING RINGS with O-RINGS and SPACERS

- *Centering Ring Material: SS 304/ Aluminum
- *O-Ring Material: FKM
- *Spacer Material: Aluminum



Part Number (SS 304)	Part Number (Aluminum)	Size	A	B	C	D
ISO-CROS-63	ISO-CROS-63-AL	ISO63	94.00	68.00	3.90	8
ISO-CROS-80	ISO-CROS-80-AL	ISO80	109.00	81.00	3.90	8
ISO-CROS-100	ISO-CROS-100-AL	ISO100	128.00	100.00	3.90	8
ISO-CROS-160	ISO-CROS-160-AL	ISO160	179.00	151.00	3.90	8
ISO-CROS-200	ISO-CROS-200-AL	ISO200	239.00	210.00	3.90	8
ISO-CROS-250	ISO-CROS-250-AL	ISO250	287.00	256.00	3.90	8
ISO-CROS-320	ISO-CROS-320-AL	ISO320	346.33	311.15	5.50	14
ISO-CROS-400	ISO-CROS-400-AL	ISO400	428.80	392.93	5.50	14

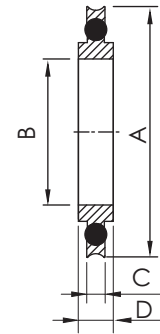

- *Note: SS 316L or Aluminum Material Available on Request.
- *Note: FFKM O-Ring Material Available on Request.

ISO SCREENED CENTERING RINGS with O-RINGS

- *Centering Ring Material: SS 304
- *70 Mesh Screen
- *Screen Material: SS 304

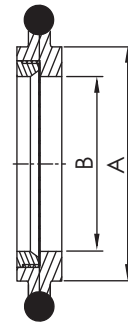

Part Number	Size	A	B
ISO-CROSC-63	ISO63	69.60	62.00
ISO-CROSC-80	ISO80	82.60	72.90
ISO-CROSC-100	ISO100	102.00	92.00
ISO-CROSC-160	ISO160	153.00	139.70

ISO
NW

ISO Hardware & Seals

ISO REPLACEMENT O-RINGS

*Material: FKM / NBR



Part Number(FKM)	Part Number(NBR)	Size	A	B
ISO-RO-63	ISO-RO-63-NB	ISO63	72.39	5.33
ISO-RO-80	ISO-RO-80-NB	ISO80	85.09	5.33
ISO-RO-100	ISO-RO-100-NB	ISO100	104.14	5.33
ISO-RO-160	ISO-RO-160-NB	ISO160	151.77	5.33
ISO-RO-200	ISO-RO-200-NB	ISO200	215.27	5.33
ISO-RO-250	ISO-RO-250-NB	ISO250	266.07	5.33
ISO-RO-320	ISO-RO-320-NB	ISO320	316.87	6.99
ISO-RO-400	ISO-RO-400-NB	ISO400	393.07	6.99

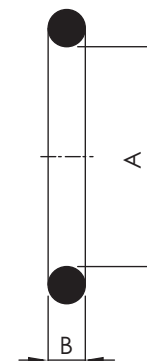

*Note: FFKM O-Ring Material Available on Request.

ISO SPACER RINGS

*Material: Aluminum



Part Number	Size	A	B	C
ISO-OR-63	ISO63	85.40	92.60	3.75
ISO-OR-80	ISO80	98.70	107.80	3.75
ISO-OR-100	ISO100	116.40	125.60	3.75
ISO-OR-160	ISO160	167.80	177.00	3.75
ISO-OR-200	ISO200	227.80	237.00	3.75
ISO-OR-250	ISO250	275.40	284.60	3.75
ISO-OR-320	ISO320	335.50	344.00	5.59
ISO-OR-400	ISO400	420.30	428.80	5.59

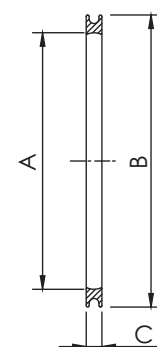

ISO
NW

ISO-K FLANGE PLASTIC CAP

*Material: PE



Part Number	Size	A	B
ISOK-PC-63	ISO63	97.8	95.0
ISOK-PC-80	ISO80	113.0	110.0
ISOK-PC-100	ISO100	133.0	130.0
ISOK-PC-160	ISO160	183.0	180.0
ISOK-PC-200	ISO200	242.0	240.0
ISOK-PC-250	ISO250	293.4	290.0
ISOK-PC-320	ISO320	373.9	370.5
ISOK-PC-400	ISO400	454.2	450.8
ISOK-PC-500	ISO500	553.9	550.5

