

From: Vision Engineering and Planning<pgilliam@vision-ep.com>

Reply: pgilliam@vision-ep.com

Subject: **Here's a quick update from us**

Preheader: **You don't want to miss this.**



2017 has been an exciting year for Vision! In addition to adding a Senior Traffic Engineer, Sunil Gyawali, to our Florida office, Vision has been involved in a number of cutting edge projects including the City of Frederick, MD Electric Vehicle Study where Vision is using demographic and travel model data to assist with the planning of electric vehicle charging stations. In addition to this project, Vision has been working on exciting modeling and planning projects from Baltimore, MD to Miami, FL!

Port Covington

Vision develops innovative hybrid regional model/ITE traffic forecasting procedure in support of Port Covington in Baltimore, MD. Port Covington is one of the largest mixed use plans under development in the U.S with over 1.3 million square feet of retail, 4.3 million square feet of office space, 303,000 square feet of industrial space, over 200 hotel rooms, and over 5,000 residences.



Atlanta CTP

Vision provides modeling support to evaluate the future of the City of Atlanta with 800,000 additional residents and over 500,000 additional jobs by the year 2040. Vision used ARC Cube Activity Based model to develop inputs for MUG and TRIA models which were used to evaluate City of Atlanta travel shed mode shares with premium transit, complete streets, and mixed land use.

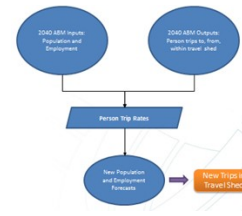

Birmingham CBD

Vision assists ALDOT shape the future of Downtown Birmingham by providing traffic forecasting services for the I-65/I-59/I-20 freeway reconstruction in Downtown Birmingham, AL. Vision used the Birmingham RPC Cube regional model and post processing procedures to develop forecasts for over 60 intersections in Downtown Birmingham.

Beraca Church

Vision develops Traffic Information Report for Beraca Haitian Church in Miami, FL. Vision's first contract in Miami was to develop a Traffic Information Report for the Beraca Haitian Church renovation. Vision used the ITE Trip Generation Manual to calculate daily and peak hour weekday and Sunday trips for the site.

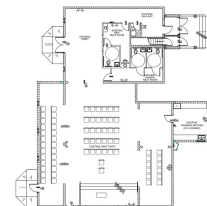

Contact Us

Mid-Atlantic Office- (540)-645-5703
Southeast Office- (404)-380-1292
Florida Office- (407)-745-0644
www.vision-ep.com

Celebrating 10 Years in Business!

CONTACT US

