

Meet Avion's Basement Models

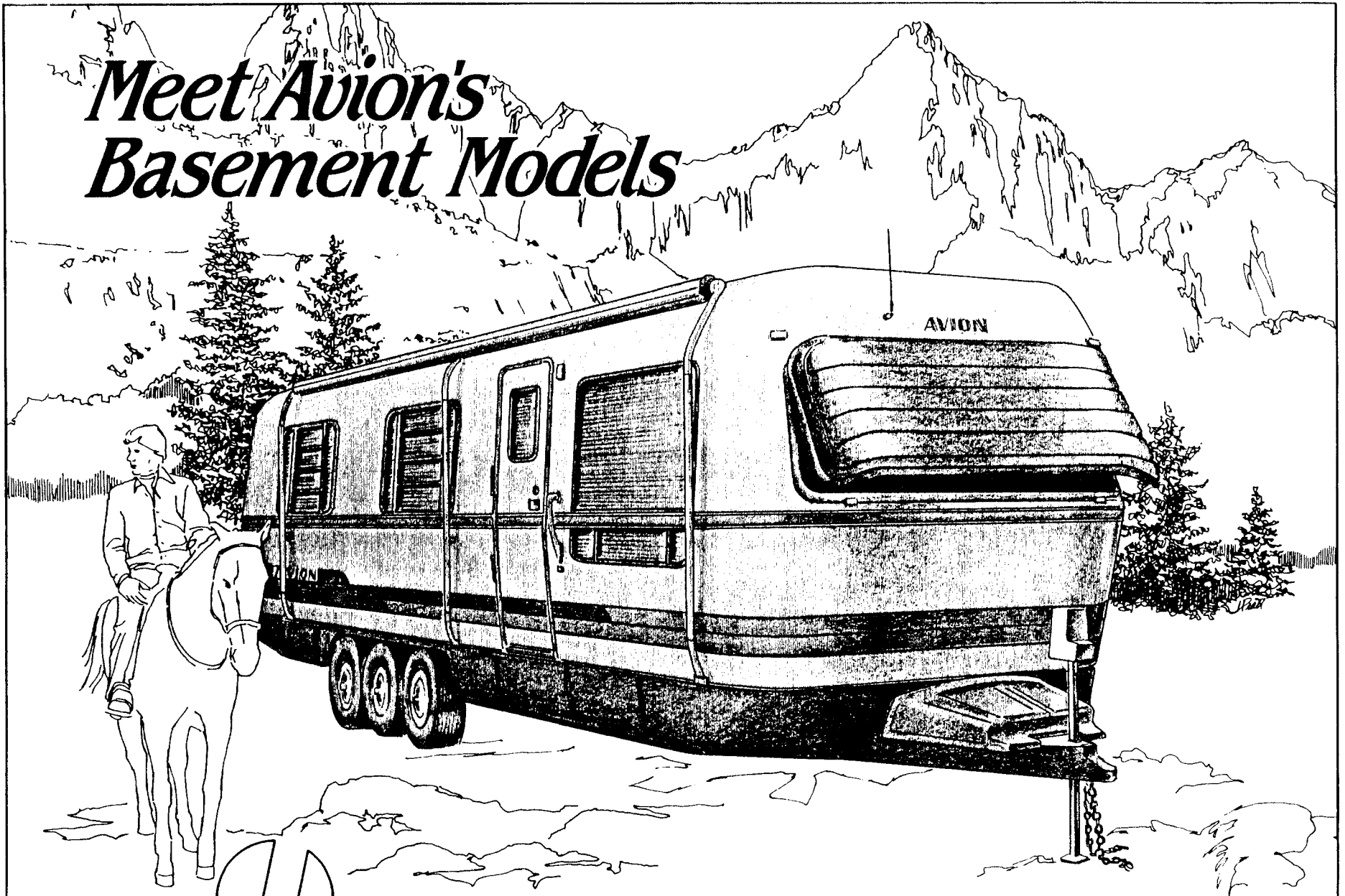



AVION

**CONVENTIONAL AVION CONSTRUCTION
UNCONVENTIONAL ABUNDANT STORAGE**

Meet Avion's two basement storage models. These have been designed for full timing or long term, seasonal vacation travel. Avion's basement models have these distinct differences:

- *Dual Furnaces — controlled heating*
- *Increased Fresh and Waste Water/Holding Capacity — greater range*
- *Triple Entry Steps — personal convenience*
- *Flat Inside Floor — no wheel well intrusion, more storage*
- *Central Utility Compartment — hookups protected*
- *Extra Capacity Exterior Compartments — great storage*
- *Concealed LP Tanks/Battery Compartment — security*

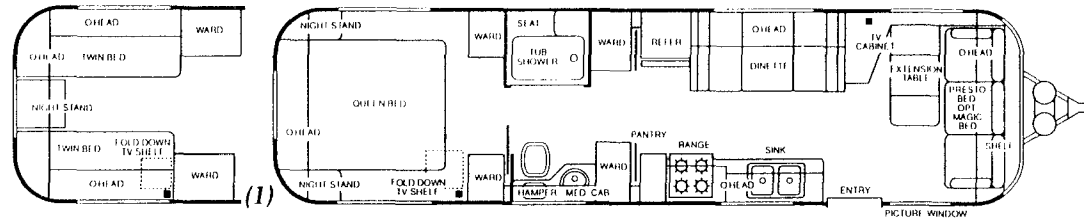
34XB



This new model has spacious living areas throughout. HIGHLIGHTS — intimate front living room and full walk-through bath with alternate privacy provisions; queen size bed. Options (1) twin beds (2) side Presto Bed® or Magic Bed®.

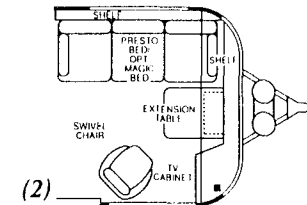

34VB

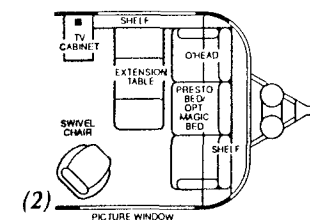
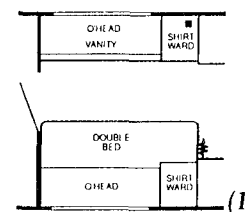
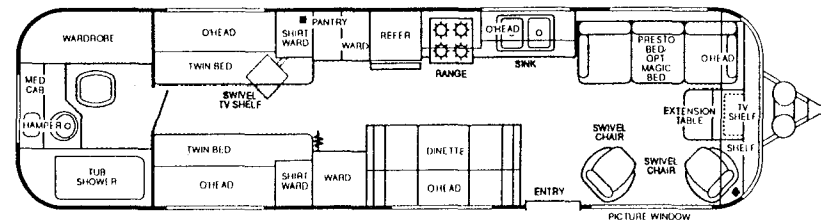

This traditional plan offers three distinct living areas. HIGHLIGHTS — the Presto Bed® converts for guest and family sleeping. The living room can be made night-time private with the folding wooden door. Abundant wardrobe storage is found throughout. Options (1) double bed, vanity (2) front Presto Bed® or Magic Bed®.

Avion Specifications & Equipment — Basement Models

	34VB	34XB
Weights, Measures		
Length, including hitch	34'10"	34'10"
Width	7'11"	7'11"
Height (including roof air)	10'4"	10'4"
GVWR — lbs.	10,600	10,600
Gross dry weight — lbs.	8,010	8,040
Hitch dry weight — lbs.	840	915
Radial Tires	•	•
Seating/Sleeping (Standard)		
Sleeping capacity	6	6
Dinette bed size — 38x72	•	•
Presto Bed® size — 46x76	•	•
Twin bed size — Sealy® — 32x76	•	—
Queen bed size — Sealy® (60x80)	—	•
Galley		
Refer w/2-way LP/110V (size)	Lge.	Lge.
Range — DLX 4 burner w/lge. oven & light	•	•
Electronic Touch Control Microwave Oven w/Browning	•	•
Range hood (power)	•	•
Sink — porcelain 18" x 32"	•	•
Single lever faucet	•	•
Galley top — laminate w/rolled edge	•	•
Water filter	•	•
Sink cover — hardwood (2)	•	•
Galley window w/mini blind	•	•
Spice cabinet	•	•
Pull-out towel bar	•	•
Spice rack (2)	•	•
Range cover — stainless steel	•	•
Bath		
Tub with seat	•	•
Large oval sink	•	•
Telephone shower head	•	•
Brass finished hardware	•	•
Marine toilet (w/water saver)	•	•
Lighted medicine cabinet	•	•
Mirrored wardrobe doors	•	•
Shower curtain	•	—

	34VB	34XB
Bath (Cont'd.)		
Towel bar and ring	•	•
Bath window w/mini blind	•	•
Hamper w/removable laundry bag	•	•
Folding Tub Enclosure	—	•
Storage		
Pantry (w/slide-out bins)	•	•
Cabinet doors — solid oak	•	•
Hinges w/struts (overhead)	•	•
Positive catches	•	•
Wooden drawers w/Accuride slides & friction travel lock	•	•
Dovetail drawer construction	•	•
Cedar lined wards	•	•
Wardrobe w/shelf	•	•
Dinette base storage area	•	•
Dinette magazine rack	•	•
Exterior trunk and door	•	—
Below floor storage (exterior)	•	•
Basement storage (exterior)	•	•
Sofa bed storage	•	•
Electrical		
Dual 12V battery container	•	•
50 amp power center — 110V/12V w/conv.	•	•
Utility compartment — 110V outlet	•	•
30' heavy duty 110V shore line	•	•
Switch controlled lighting	•	•
Monitor panel	•	•
Walkway night lights	•	•
Decorative lights — wall mount 12V	•	•
Braund T.V. antenna**	•	•
Park cable TV hookup	•	•
AM/FM stereo w/4 two-way speakers	•	•
Back-up lights	•	•
12V porch light	•	•
12V kill switch	•	•

	34VB	34XB
Electrical (Cont'd.)		
12V interior entry light	•	•
Ward lights	•	•
Telephone jack (LR, BR)	•	•
Water/Drain System		
Fresh water capacity (gals.)	70	70
Waste water capacity (gals.)	55	55
Grey water capacity (gals.)	55	55
12V demand water system	•	•
Electronic ignition water heater (gallons)	6	6
Water tank by-pass fill	•	•
Adjustable water regulator	•	•
Galley faucet w/hand sprayer	•	•
Heating/Ventilation		
Ducted furnace w/thermostat (BTU)	20M (2)	20M (2)
Radius torque windows — tinted safety glass	•	•
Hammond® power roof vents — 2-speed (3 ea.)	•	•
13.5M BTU Roof A/C w/heat strip	•	•
Picture window in living room	•	•
Safety		
Fire extinguisher	•	•
GFI protection	•	•
Emergency egress	•	•
Smoke detector	•	•
LPG leak detector	•	•
Center stop light	•	•
Radius corner countertops	•	•
Rockguard	•	•
Dead bolt lock	•	•
Flush door latch	•	•
Lighted entry assist handle	•	•
Interior		
Galley top side splash	•	•
Upholstered dinettes	•	•
Flex-O-Lator® dinette seating	•	•
Heavy vinyl walls	•	•
5' Dacron wrapped cushions	•	•
Lined drapery w/mini blind	•	•
Drapery valances	•	•

	34VB	34XB
Interior (Cont'd.)		
Carpet	•	•
All wood cabinets	•	•
Wall Clock	•	•
Folding room dividers (bedroom/hall only)	•	—
Free standing chair (qty)	2	—
Bedspreads & pillow shams	•	•
Exterior		
Dura-Brite® aluminum skin	•	•
AL-KO® suspension	•	•
Heavy duty rear bumper	•	•
"Mod" wheels w/trim rings	•	•
"Thermo-X" insulation	•	•
Electric brakes — all wheels	•	•
Insulated sandwich sub/floor	•	•
Stabilizing jacks front/rear	•	•
12V power hitch jack(s)	•	•
Dual LPG tanks w/sight gauge (80 lbs.)	•	•
LPG bottle cover	•	•
Open truss	•	•

**Jacks in bedroom and living room.

Options

	34VB	34XB
016 Front transit cover	•	•
021 Side awning	•	•
022 Window awning	•	•
121 Conv. microwave w/cooktop	•	•
130 6 gal. 110V DSI water heater	•	•
236 Dual A/C 13.5M	•	•
618 Storm windows	•	•
800 Magic Bed®	•	•
801 Side Magic Bed®	•	•
802 Front Presto Bed®	•	—
804 Side Presto Bed®	—	•
837 Twin beds — Sealy®	—	•
848 Double Bed	•	—

Option availability is subject to change without notice.

Prices and specifications are subject to change without notice. Selected decorator items shown in the photographs are not part of the product unless specified. All fuel and liquid capacities are approximate and dimensions are nominal.

Avion Hidden Features

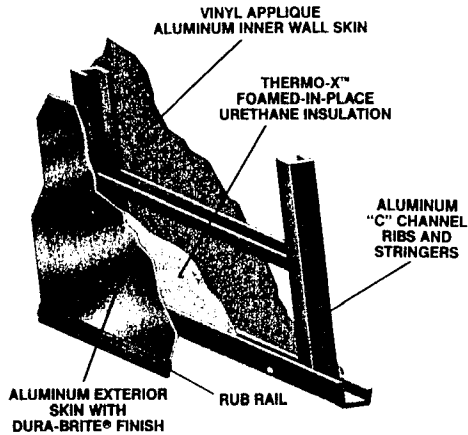

Wall Construction

In line with traditional aircraft construction, Avion's inner aluminum wall and outer aluminum skin is supported by aluminum ribs and stringers. The Thermo-X™ insulation is foamed in place and creates uniform thermal and sound insulation throughout. New Dura-Brite® exterior offers easy maintenance and superior finish.

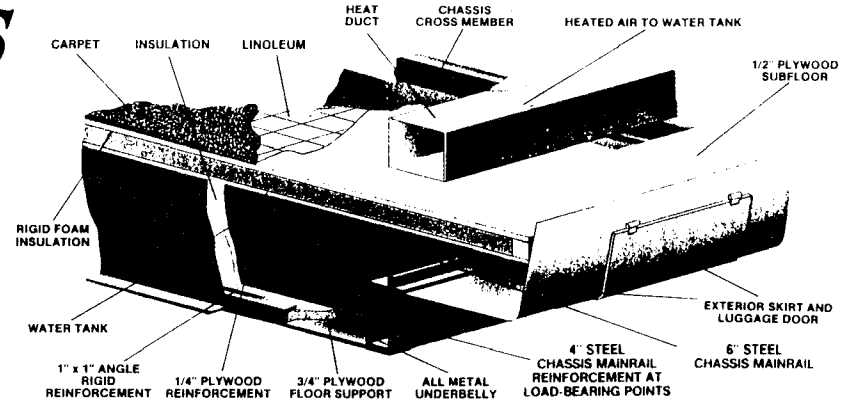

Floor Construction

Floor construction assures the strength, durability, and convenience you expect from Avion. All water and plumbing lines are contained within the floor and protected by the full length all metal underbelly. Basement floor construction differs somewhat.

AL-KO® Suspension

Tested on Europe's Auto Bahn, AL-KO® suspension provides incredibly smooth towing and handling — for your safety and protection of on-board personal goods.

Fully independent suspension • Patented hexagonal design for maximum shock absorption • Safe, smooth, quiet ride • Maintenance free, no metal to metal contact • Faster, easier installation • Lower center of gravity, improved stability • Capacities from 500 to 7,000 pounds • Manufactured in U.S.A.

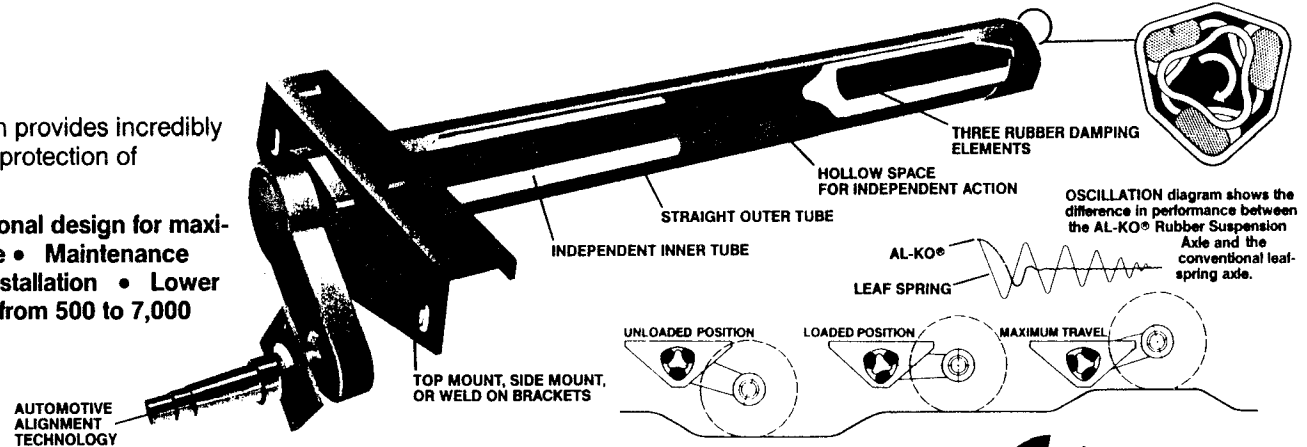

Avion Travel Trailers are manufactured by this subsidiary of Fleetwood Enterprises, Inc.

Avion Coach Corporation

1300 E. Empire Avenue
Benton Harbor, Michigan 49022

Your Local Avion Dealer Is:



AVION

FLEETWOOD®

FLEETWOOD ENTERPRISES, INC.

P.O. Box 7638
Riverside, California 92523

If It's Built By Fleetwood, It's Built For Fun!