

RUSTGO PARTS

Diagrams & Layouts

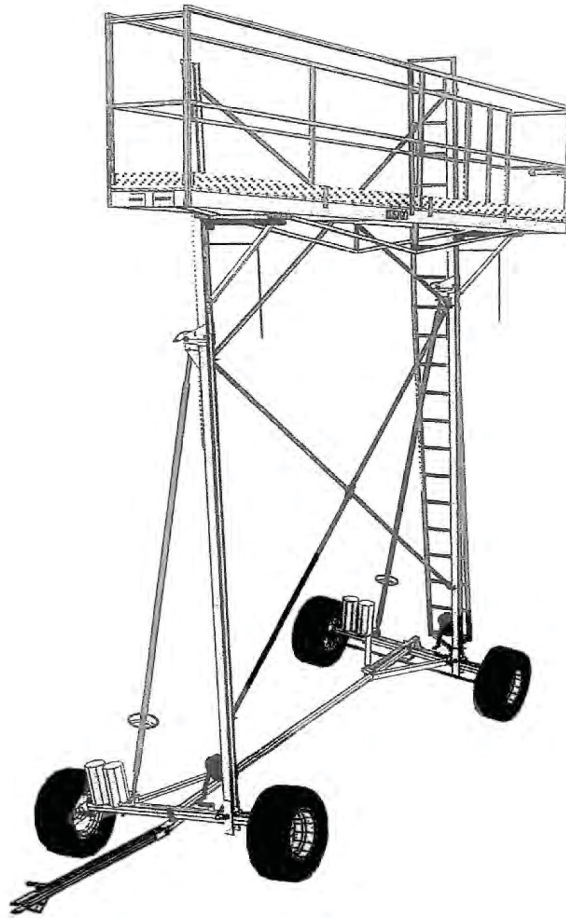

Unique Contractor Products, LLC

423 Valley Lake Drive

Birmingham, AL 35206

Toll Free: (800) 448-4077

Phone: (205) 238-8615

www.rustgo.com

William King- "RUSTGO Product Specialist"

wking@rustgo.com

RUSTGO®

BRAND
WORK PLATFORMS
RUSTGO CO.
SPENCER, NE
DISTRIBUTED BY
Nelson King, Inc.
5014 FIRST AVE. NO.
BIRMINGHAM, AL 35212
Ph. (205) 591-6875
Toll Free 800-448-4077



LOOK UP

ELECTROCUTION HAZARD



#799-170

WARNING

OVERLOADING MAY RESULT IN COLLAPSE OR OVERTURNING OF MACHINE
MAX. RATED WORK LOAD 750 LBS./340K
MAX. RATED NUMBER OF OCCUPANTS 3 MP 1092

CAUTION

THIS IS NOT A MATERIAL LIFT

- ▶ READ, UNDERSTAND & COMPLY WITH ALL ASPECTS OF THE DECALS AND INSTRUCTION MANUAL BEFORE USING THE EQUIPMENT. THE RUSTGO INSTRUCTION MANUAL SHALL BE KEPT WITH THIS UNIT AT ALL TIMES.
- ▶ ALL COUNTER WEIGHTS SHALL BE IN PLACE AND ALL 4 BRAKES SHALL BE LOCKED.
- ▶ INSPECTION & MAINTENANCE OF THIS UNIT SHALL BE DONE ON A TIMELY BASIS AS SPECIFIED IN THE RUSTGO INSTRUCTION MANUAL.
- ▶ RAISE PLATFORM TO DESIRED HEIGHT, LEVEL IN BOTH DIRECTIONS USING WINCHES AND ADJUSTING ARMS
- ▶ OWNER/USER SHALL NOT REPLACE ANY CRITICAL COMPONENTS OF UNIT WITHOUT MANUFACTURERS CONSENT
- ▶ WORKPLATFORM SHALL NOT BE RAISED, LOWERED OR MOVED WITH WORKMEN ON IT.

MAX. PLATFORM HEIGHT: MODEL 138 19'6"	MODEL 195 25'6"
MAX. OVERALL HEIGHT: MODEL 139 23'2"	MODEL 195 29'3"



INSTRUCTION MANUAL
Part#700-001

RUSTGO Mobile Work Platforms
Meet ANSI Standard A92.3
for Manually Propelled Elevating
Aerial Platforms
Part#700-002

DANGER

TOWING HAZARD

Rear Steering Tongue
MUST BE LOCKED
DOWN for towing.

Failure to do so shall
result in damage or
serious injury.

Manufacturer certifies conformance to
OSHA
Sec. 1926.452(w) mobile scaffolds
& (Non-mandatory) Appendix A
to Subpart L - (w) Mobile Scaffolds
#799-140

MAINTENANCE

GREASE PLATFORM SLIDE BRACKET.
PERIODICALLY GREASE INSIDE LIPS OF UPRIGHT
POSTS TO PREVENT LIFTARMS FROM DRAGGING.

WARNING

OVERLOADING MAY RESULT IN COLLAPSE OR OVERTURNING OF MACHINE
MAX. RATED WORK LOAD 500 LBS./225K
MAX. RATED NUMBER OF OCCUPANTS 2 JL 1092

WARNING!

MODEL 139 LOAD LIMITS

Model 139 has a maximum combined load limit of 750 lbs. /340 K.

DO NOT EXCEED

a 7 degree negative slope. (approx. 10"/.26m)



in combination with

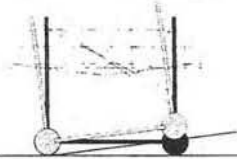

a 7 degree longitudinal slope.(approx. 19" / .48m)

Part #700-003

WARNING!

MODEL 195 LOAD LIMITS

Model 195 has a maximum combined load limit of 1000 lbs. /454 K.

DO NOT EXCEED

a 7 degree negative slope. (approx. 14"/.35m)

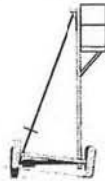

in combination with

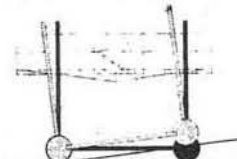

a 7 degree longitudinal slope.(approx. 19" / .48m)

Part #700-004

WARNING

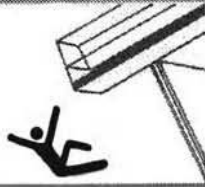

Before using, pulling up, or taking down this mobile work platform CHECK WITH YOUR BOSS AS TO ITS SAFE USE

There are many ways YOU CAN BE hurt or even KILLED using mobile work platforms

REVIEW THE SAFETY GUIDELINES WITH YOUR BOSS

Read & understand the operators manual. Be familiar with the operation and limitations of the equipment.

WARNING

CAUTION

FREE SPOOLING WINCH

MAINTAIN FIRM GRIP ON HANDLE. BE SURE PAWL IS ENGAGED IN NOTCH SYSTEM BEFORE RELEASING HANDLE.

393A

LOOK UP

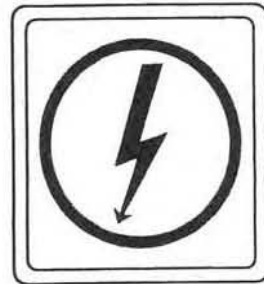

DANGER

ELECTROCUTION HAZARD
This machine is NOT electrically insulated. Maintain safe clearances from electrical lines & apparatus.

DEATH OR SERIOUS INJURY will result from contact or inadequate clearance.



#799-136

TO PLUMB UPRIGHTS

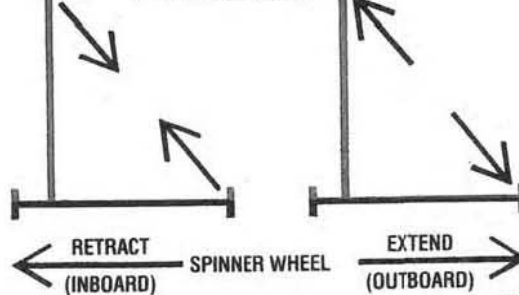

3938



CAUTION



KEEP TOGGLE FREE & NONBINDING
FAILURE TO KEEP TOGGLE FREE & NONBINDING COULD RESULT IN THE DISLODGING OF THE LADDER EXTENSION DURING NORMAL USE, CAUSING SERIOUS INJURY.

590

EXTEND AXLE

EXTEND AXLE & TIE ROD 30" & PIN BEFORE SETTING UP UNIT. RETRACT AFTER DISASSEMBLY FOR HIGHWAY TOW.

1090

TOEBOARD MATERIAL REQUIREMENTS

MAIN PLATFORM:

TREATED 1" X 4" BOARDS CUT TO:

2	119-1/4"	(OUTBOARD EDGE OF PLATFORM)	(A)
1	107"	(INBOARD EDGE OF PLATFORM)	(B)
1	95"	(INBOARD EDGE OF PLATFORM)	(C)
1	22-3/4"	(REAR GATE END OF PLATFORM)	(D)
1	22-3/4"	(FRONT END OF PLATFORM)	(E)
1	16-3/4"	(INBOARD EDGE OF PLATFORM BY GATE)	(F)

BOLTS: 24 - 1/4" X 1" W/TEE NUTS Part # 199-125

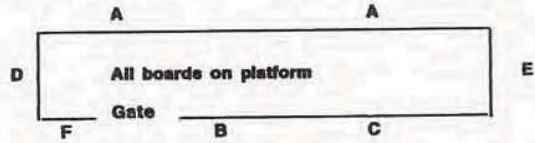

INTERMEDIATE LEVEL PLATFORM:

TREATED 1" X 4" BOARDS CUT TO:

2	108-1/2"	(OUTBOARD EDGE OF PLATFORM)	(A)
2	99-1/2"	(INBOARD EDGE OF PLATFORM)	(B)
1	18"	(REAR GATE END OF PLATFORM)	(C)
1	17"	(FRONT END OF PLATFORM)	(D)

BOLTS: 17 - 1/4" X 1" W/TEE NUTS Part # 199-125
5 - 1/4" X 1-1/2" W/TEE NUTS Part # 199-126

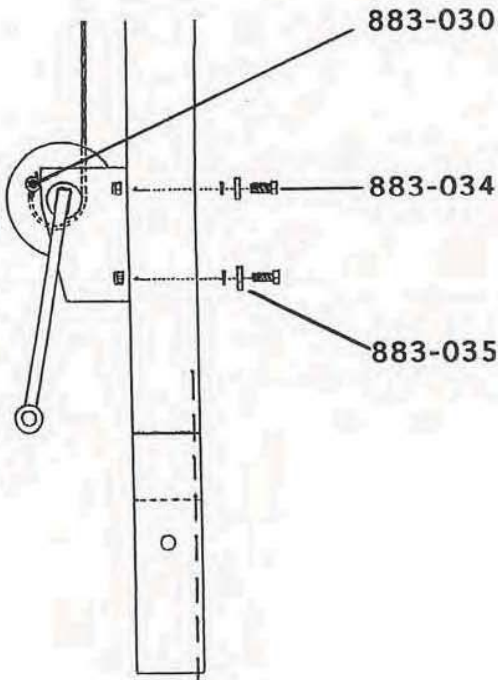
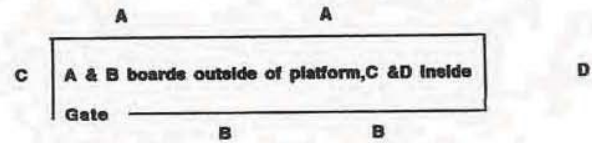

Main Platform Lift Arm
486-302(Complete)
DETAIL AT RIGHT

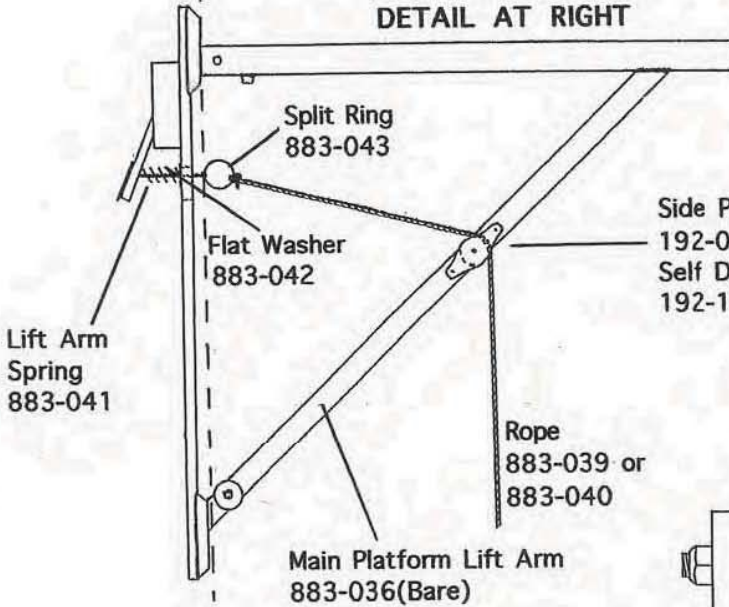

DETAIL AT RIGHT

Main Winch Cable

Cable Clevis
883-033

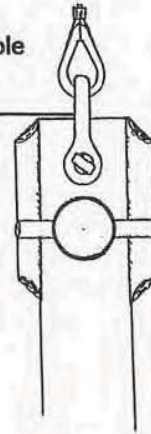

Roller Bearing
883-038

Bolt, 3/8"x3"
w/Locknut
883-024

Thick Washer
883-035

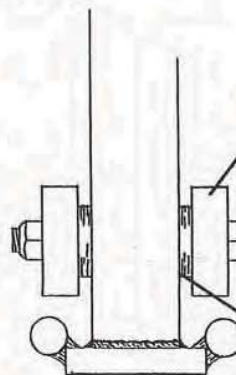

Decals on Uprights

- A - Danger Electrocutation #799-136
- B - Warning, Check w/Boss #799-171
- C - Load Limits: Model 139 #700-003
Model 195 #700-004
- D - Maintenance #883-132

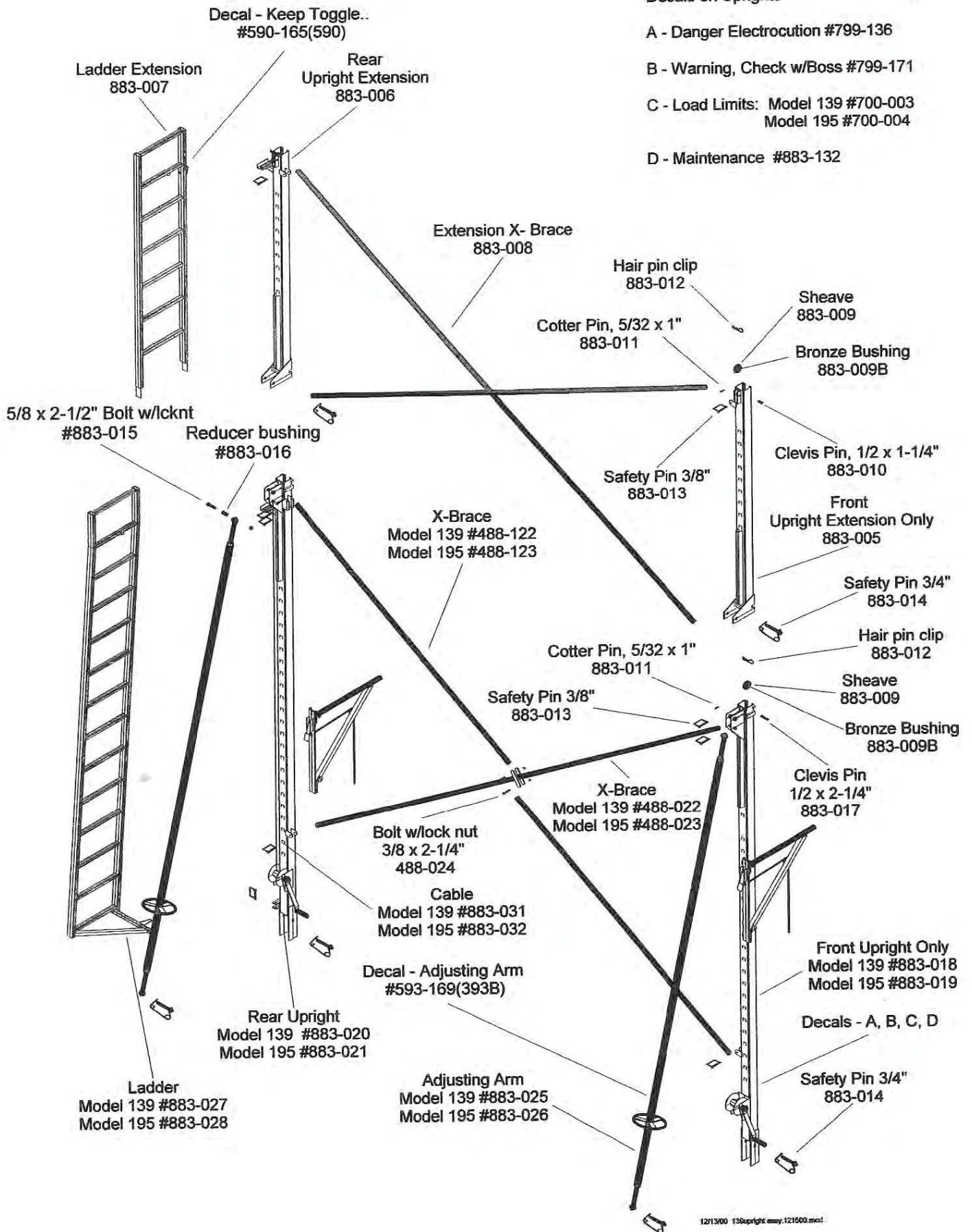

12/13/00 130upright Assy.121500.mcd

RUSTGO Winch Complete 200-500

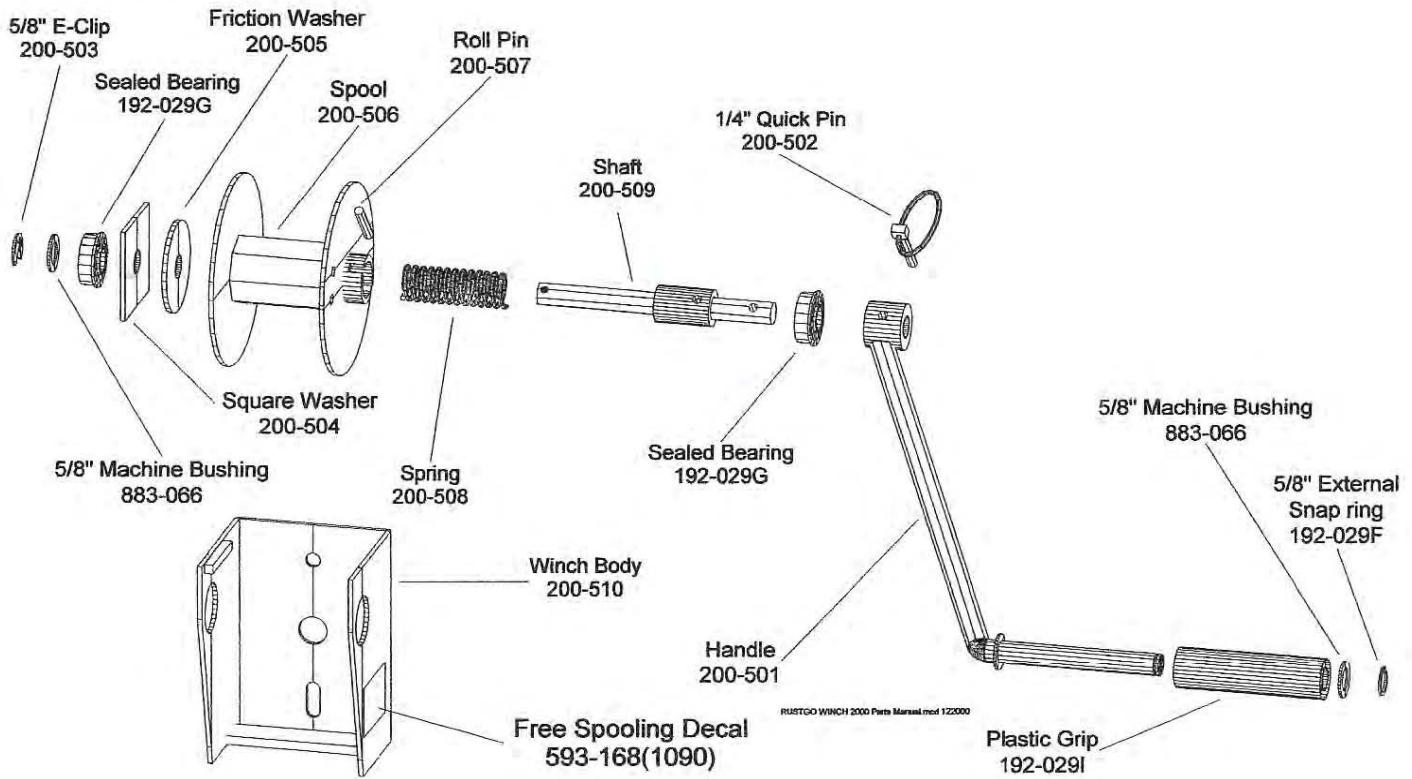

RUSTGO INTERMEDIATE LEVEL WINCH Complete 600-600

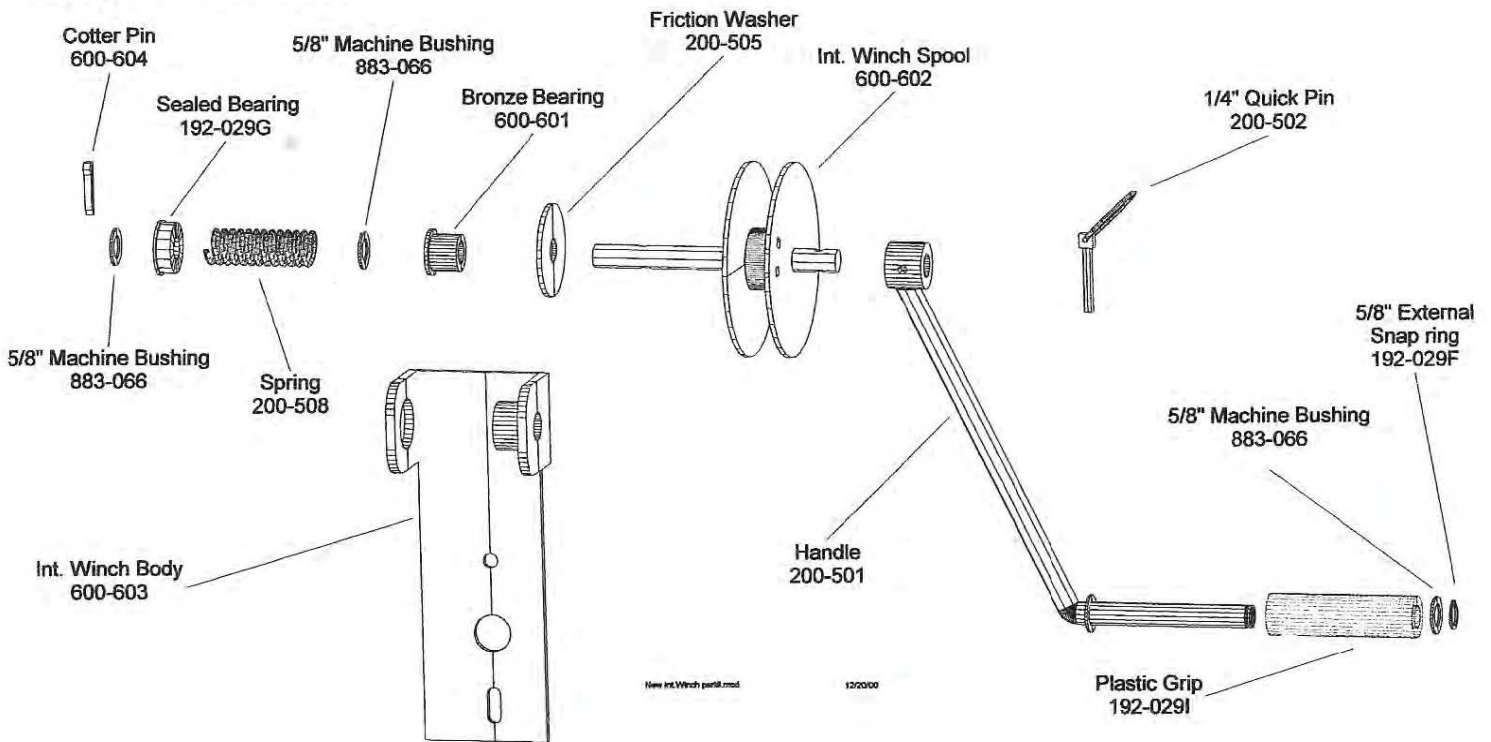

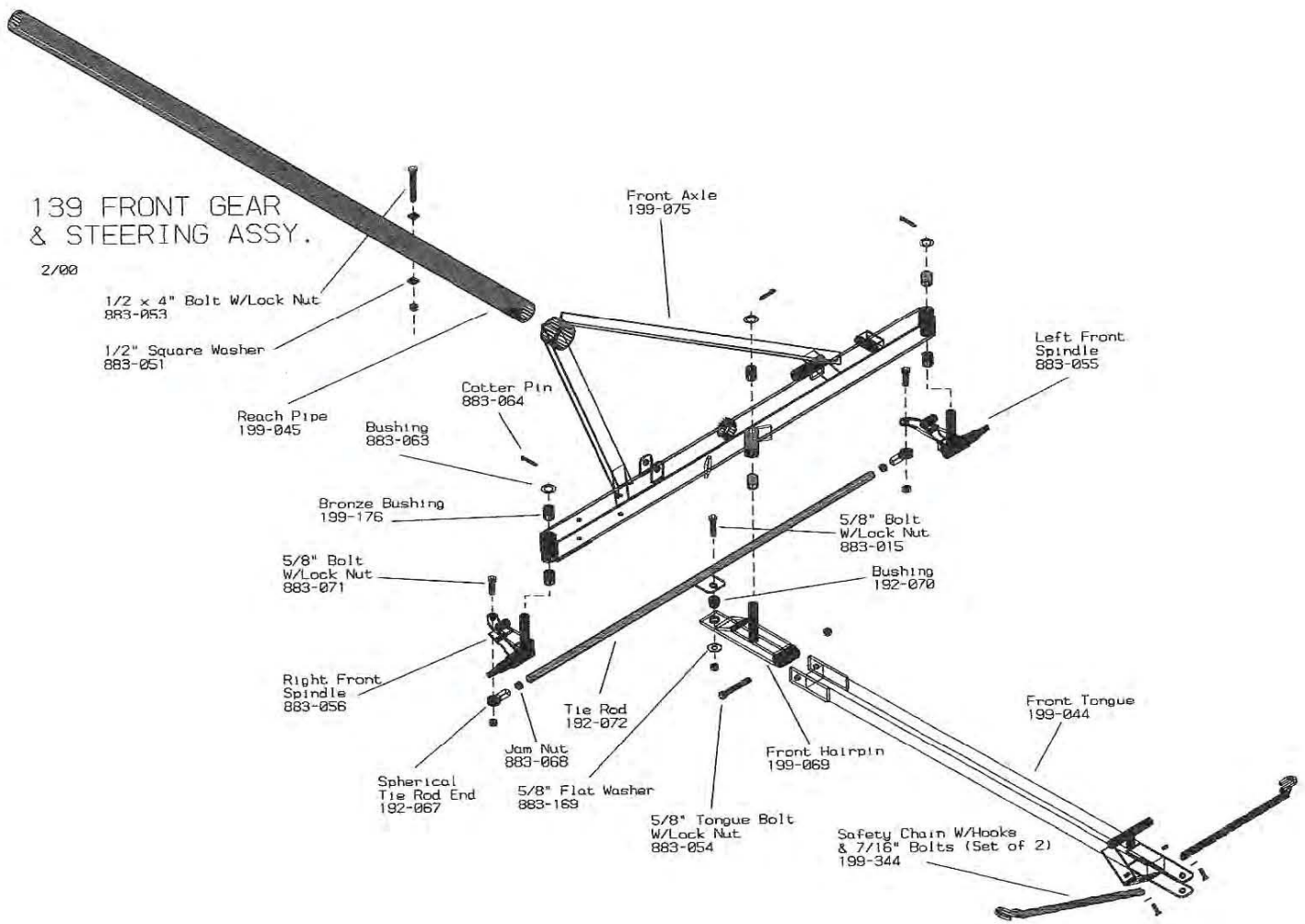

139 Rear Gear & Steering Assy.

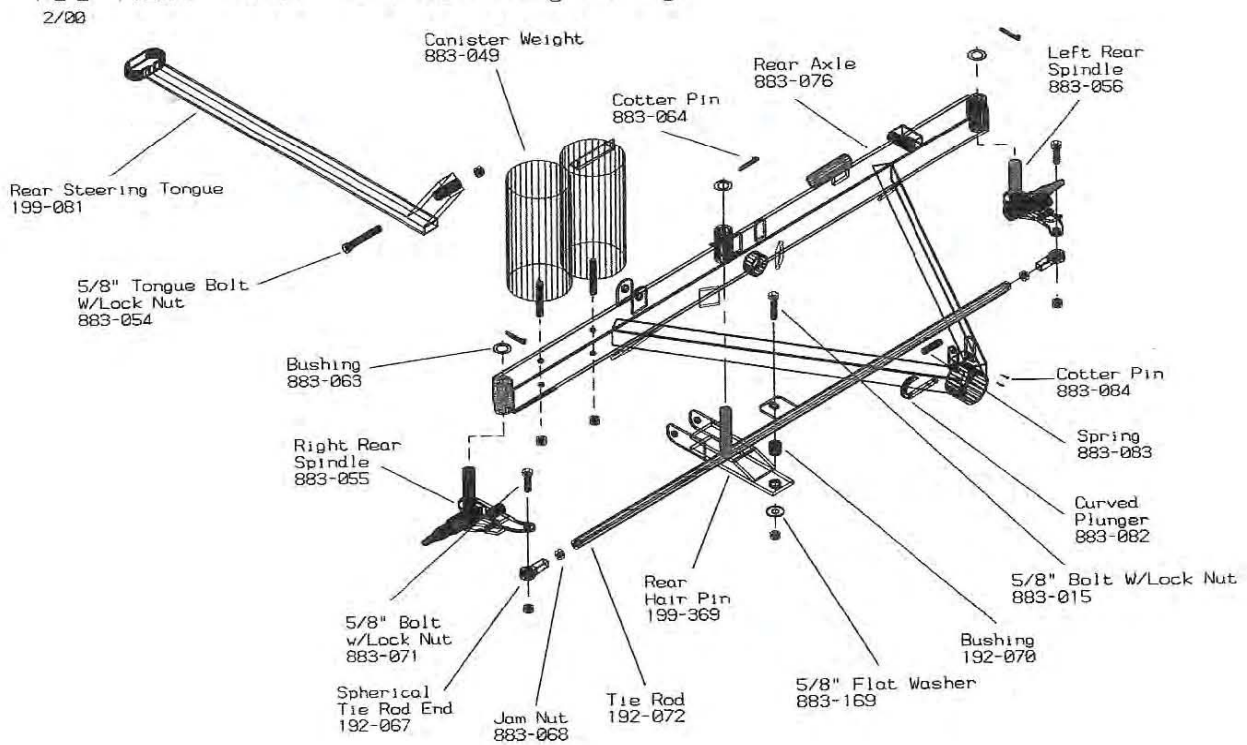

195 FRONT GEAR & STEERING ASSY.

2/00

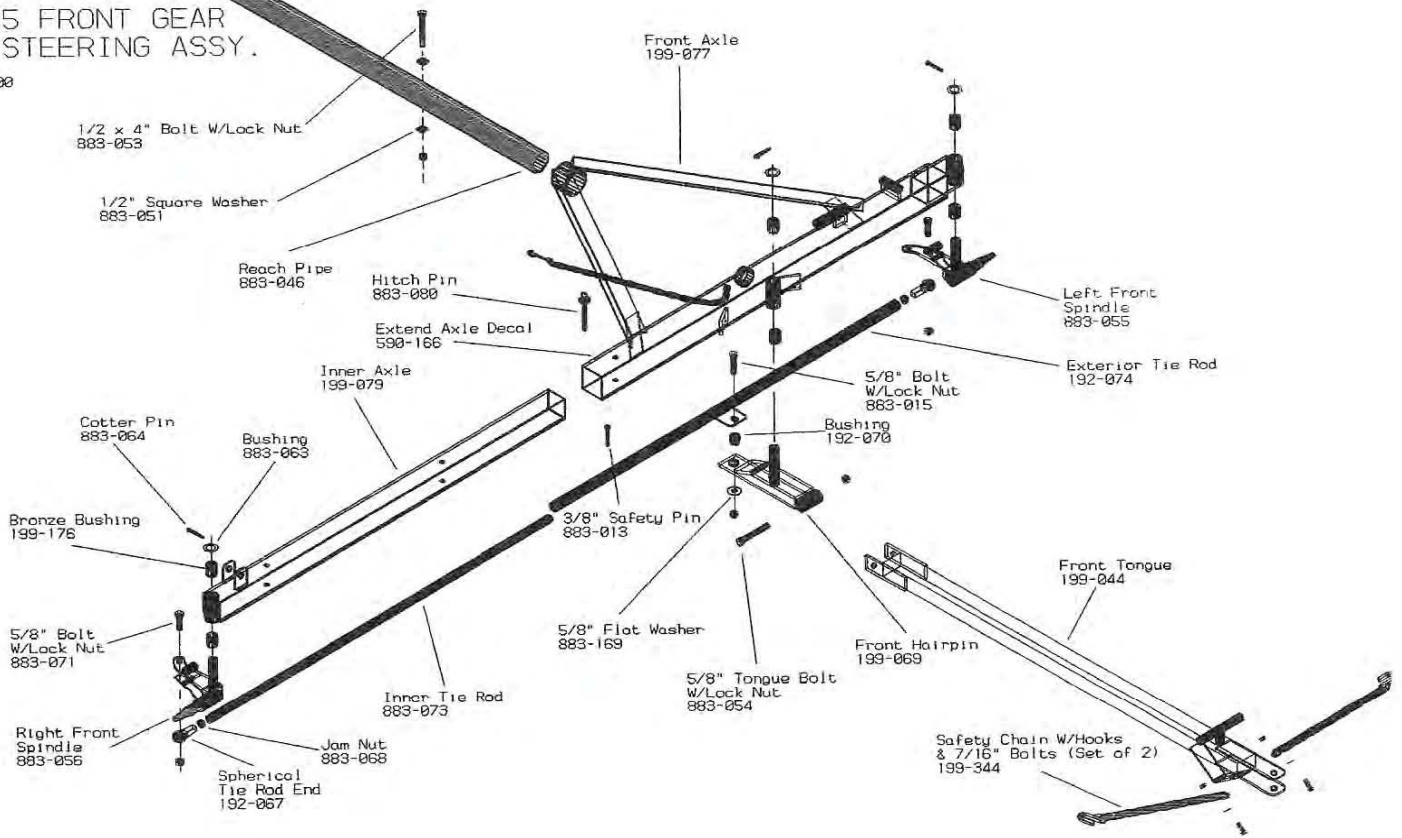

195 Rear Gear & Steering Assy.

2/00

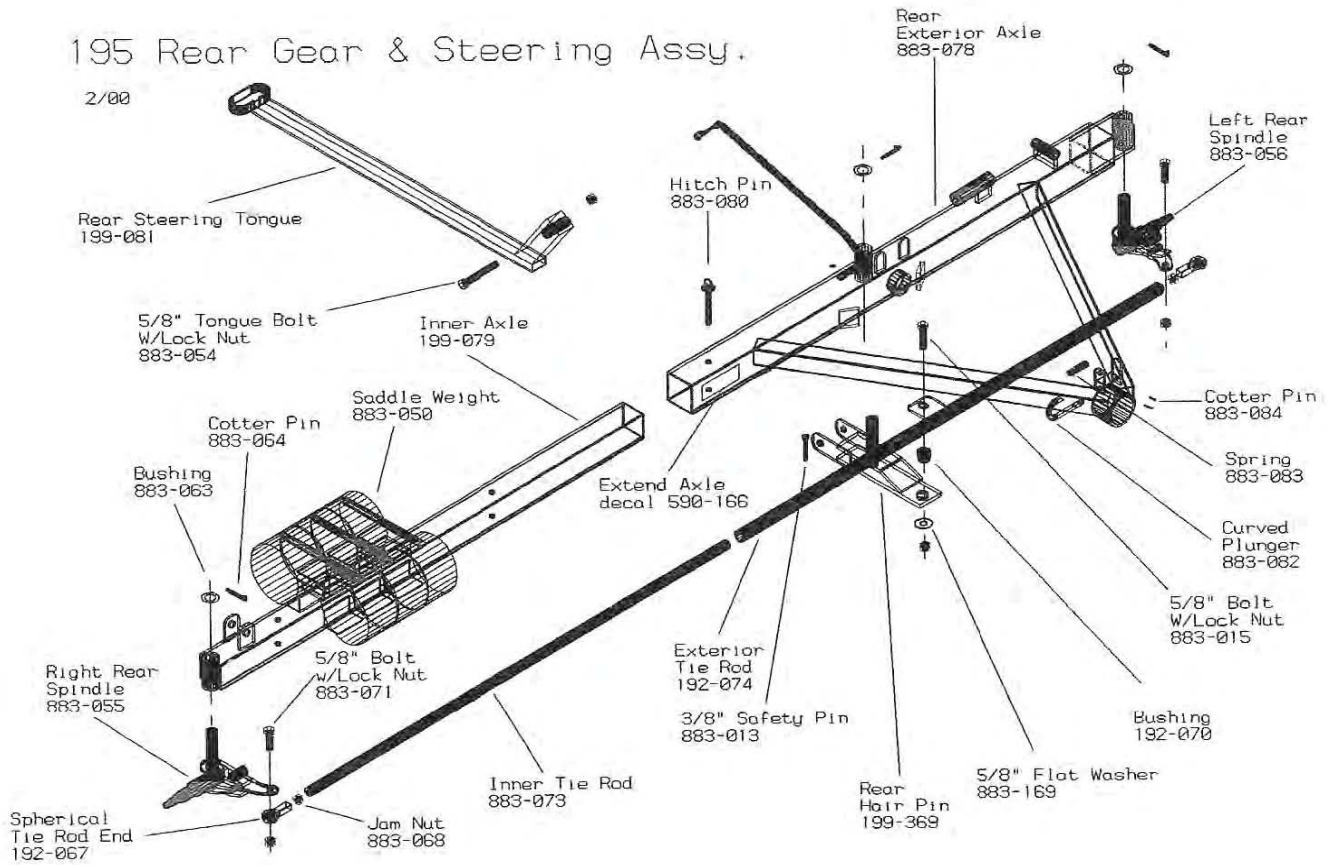

TOWING OPTIONS

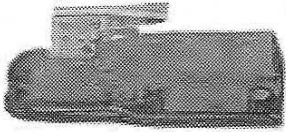

2" Ball Hitch Coupler, Part # 192-244

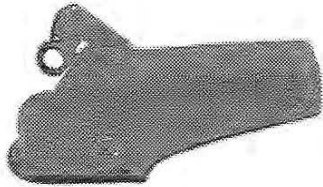

2-5/16" Ball Hitch Coupler, Part # 192-245

×

RUSTGO CO.

HUB, BRAKE & SPINDLE ASSY.

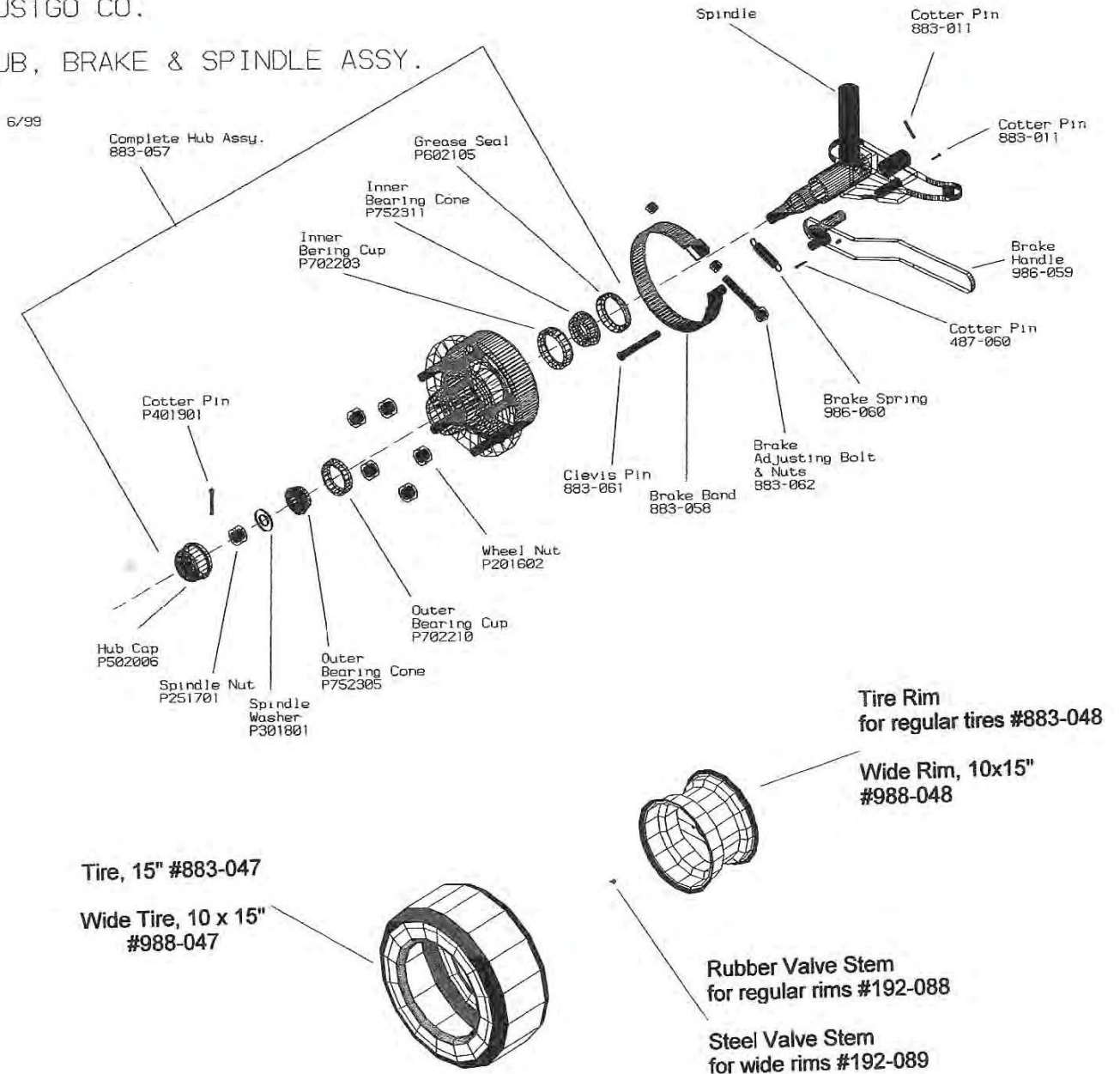

Rustgo Int. Level Winch & Lift Arm Assy.

Models 139 & 195

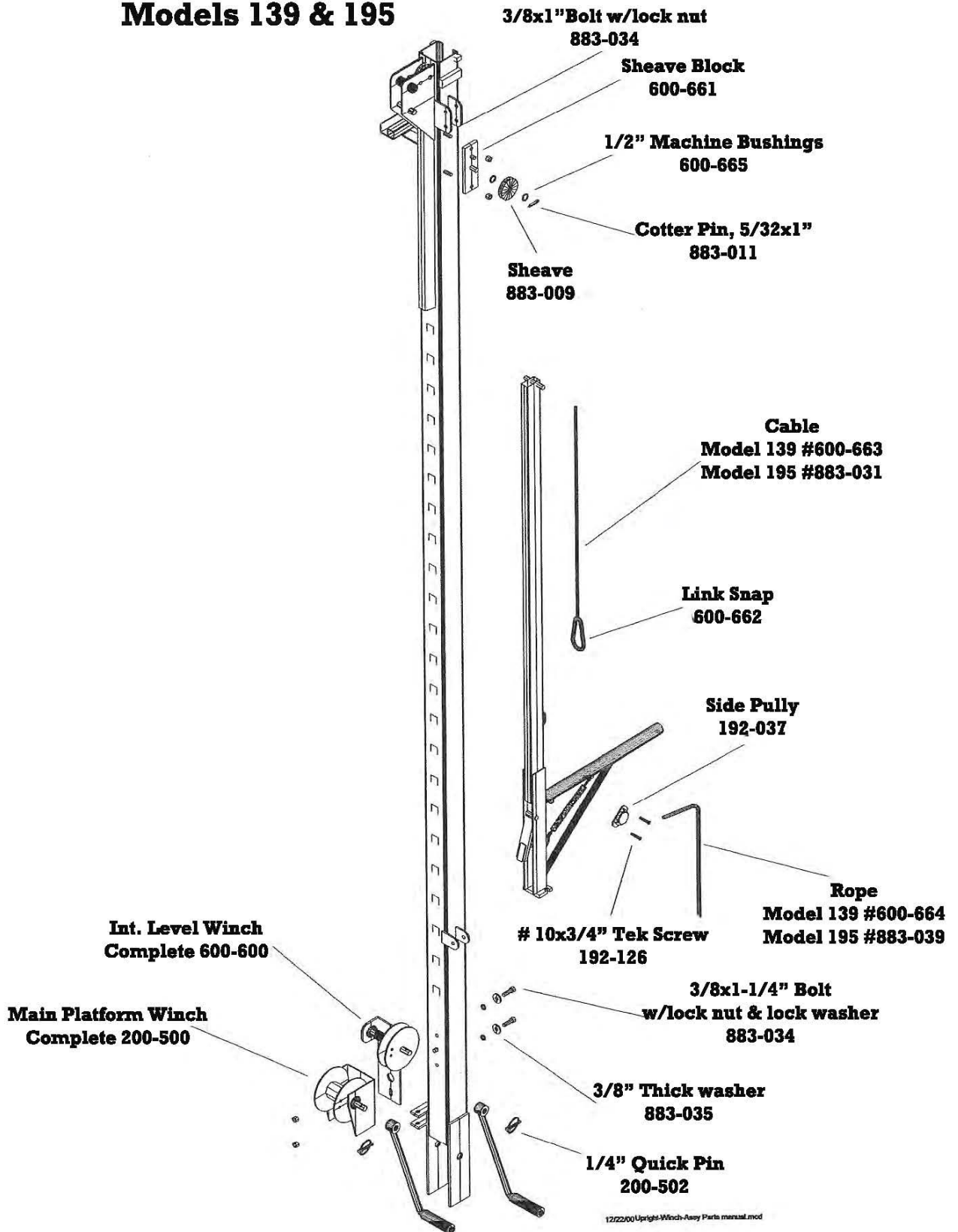

TRANSPORTING YOUR WORK PLATFORM

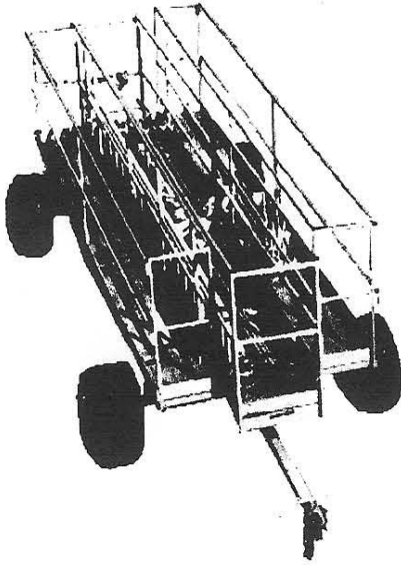

MODEL 195 TRAIL POSITION

Shown above is an example of a Model 195 in trail position for highway tow. The example consists of a Model 195 with optional wide tires, 2" ball hitch, and 2 Intermediate Levels. Saddle weights are not to be lift on unit when towing and should not be transported separately.

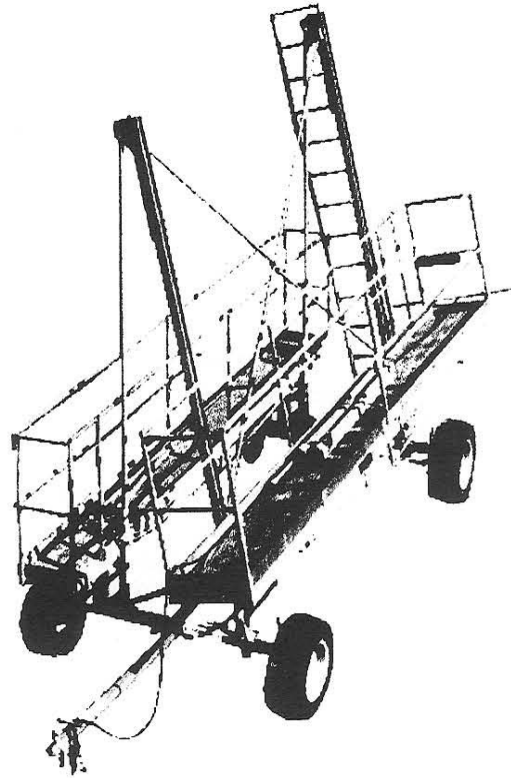

MODEL 139 IN TRAIL POSITION

Shown above is an example of a Model 139. in trail position for highway tow. The example consists of a Model 139 with optional wide tires, 2" ball hitch, 1 Intermediate Level, and a Light Bar. To tow, in trail position, adjusting arm threads Must be screwed completely in to give a clearance of approximately 13ft. 5in.

When readying for tow behind a vehicle, be sure REAR STEERING TONGUE IS LOCKED DOWN IN PLACE

ADDITIONAL WINCH OPERATING INSTRUCTIONS

WHEN LOWERING THE PLATFORM(S) ONLY 1 PERSON SHOULD BE OPERATING THE WINCH AND RELEASE ROPE FOR EACH WINCH. THE OPERATOR SHOULD **NOT** BE UNDER THE PLATFORM. THE OPERATOR SHOULD FIRMLY GRAB THE WINCH IN ONE HAND AND THE ROPE IN THE OTHER.

IF YOU LOSE YOUR GRIP ON THE WINCH, RELEASE THE ROPE.

DO NOT ALLOW ANYONE EXCEPT THE WINCH OPERATOR TO HOLD THE ROPE.

SPECIFICATIONS

MODEL 139

Maximum Overall Height: 23' 2" / 7.1m (+or- 2")
 Maximum Deck Height: 19' 6" / 6 m
 Minimum Deck Height: 4' / 1.2 m
 Height Adjustment at: 4" / 10 cm intervals
 Wheelbase: Length: 13' / 4 m C to C
 Width: 6' 10" / 2.1 m

Add 10" / .3m Overall width if equipped with Wide Tires

Overall Weight: 1,860 lbs. / 844K
 Overall Length: 23' / 7 m
 Standard 2'x20'
 Platform Workload Rating: 750 lbs. / 340 K
 Guard rail Height: 42" / 1.07m

MODEL 195

Maximum Overall Height: 29' 3" / 8.9 m (+or- 2")
 Maximum Deck Height: 25' 6" / 7.8 m
 Minimum Deck Height: 4' / 1.2 m
 Height Adjustment at: 4" / 10 cm intervals
 Wheelbase: Length: 13' / 4 m C to C
 Width: 6' 10" / 2.1 m

Axle Extended Width: 9' 4" / 2.9 m

Add 10" / .3m Overall width if equipped with Wide Tires

Overall Weight: 2,090 lbs. / 948K
 Overall Length: 23' / 7 m
 Standard 2'x20'
 Platform Workload Rating: 750 lbs. / 340 K
 Guard rail Height: 42" / 1.07m

OPTIONAL INTERMEDIATE LEVEL PLATFORM:

18" X 18" I/Level Workload Rating: 500 lbs. / 227K
 Weight: 330 lbs. / 150K

FOR YOUR RECORDS:

MODEL NUMBER: _____ SERIAL NUMBER: _____

NO. OF INTERMEDIATE LEVELS: _____

STYLE OF HITCH: PIN 2" BALL 2-5/16" BALL PINTLE

DATE OF PURCHASE: _____

PURCHASED FROM: _____

ADDRESS: _____

CITY: _____ STATE: _____ ZIP: _____

PHONE: _____

PRINTED IN USA

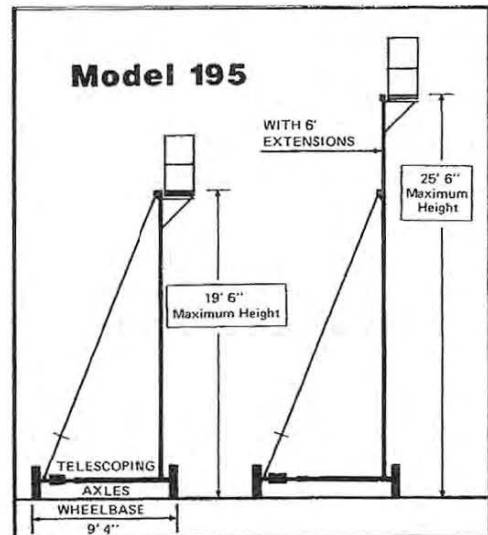
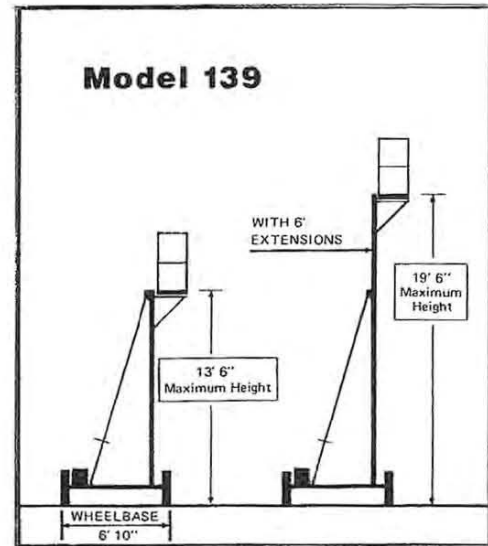

PART # 193-003