

Soils Map

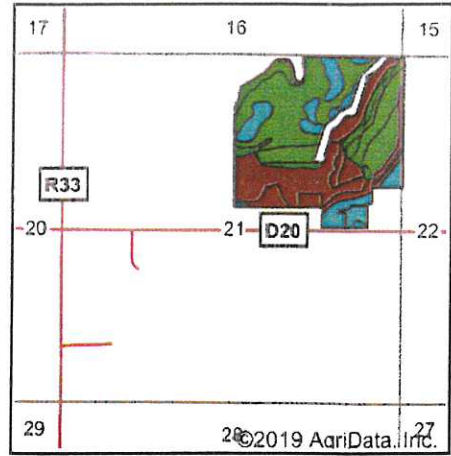

State: **Iowa**
 County: **Hamilton**
 Location: **21-89N-25W**
 Township: **Cass**
 Acres: **128.91**
 Date: **11/21/2019**

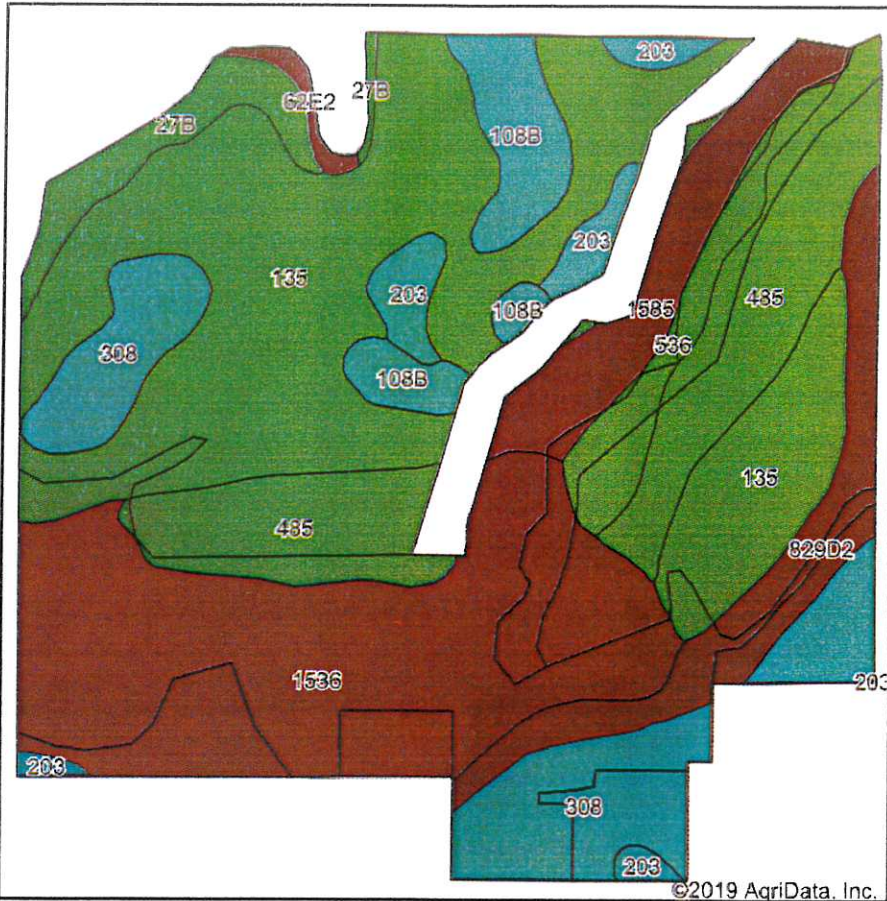

Soils data provided by USDA and NRCS.

Area Symbol: IA079, Soil Area Version: 23

Code	Soil Description	Acres	Percent of field	CSR2 Legend	Water Table	Restrictive Layer	Septic Limits	Foundation Limits	Non-Irr Class *c	CSR2**	CSR	Oats	Spring wheat	*n NCCPI Soybeans
135	Coland clay loam, 0 to 2 percent slopes, occasionally flooded	39.06	30.3%		0ft.	> 6.5ft.	very limited	very limited	Ilw	76	80			78
1536	Hanlon fine sandy loam, channeled, 0 to 2 percent slopes	29.96	23.2%		4ft.	> 6.5ft.	very limited	very limited	Vw	37	25			47
485	Spillville loam, 0 to 2 percent slopes, occasionally flooded	15.74	12.2%		3.7ft.	> 6.5ft.	very limited	very limited	Ilw	88	92			81
308	Wadena loam, 0 to 2 percent slopes	12.83	10.0%		> 6.5ft.	> 6.5ft.	very limited	not limited	Ils	56	71			52
829D2	Zenor-Storden complex, 9 to 14 percent slopes, moderately erode	7.49	5.8%		> 6.5ft.	> 6.5ft.	very limited	somewhat limited	IVe	31	26			37
1585	Spillville-Coland complex, channeled, 0 to 2 percent slopes	6.39	5.0%		5.5ft.	> 6.5ft.	very limited	very limited	Vw	30	25			51
108B	Wadena loam, 2 to 6 percent slopes	5.42	4.2%		> 6.5ft.	> 6.5ft.	very limited	not limited	Ile	52	50	4	2	52
536	Hanlon fine sandy loam, 0 to 2 percent slopes	4.03	3.1%		4ft.	> 6.5ft.	very limited	very limited	Ils	80	70			71
203	Cylinder loam, 0 to 2 percent slopes	3.70	2.9%		2.6ft.	> 6.5ft.	very limited	very limited	Ils	58	78			61
27B	Terril loam, 2 to 6 percent slopes	3.65	2.8%		3.6ft.	> 6.5ft.	very limited	somewhat limited	Ile	87	82			81
62E2	Storden loam, 10 to 22 percent slopes, moderately eroded	0.64	0.5%		> 6.5ft.	> 6.5ft.	very limited	very limited	IVe	32	32			53
Weighted Average										60.2	60.1	0.2	0.1	*n 63

**IA has updated the CSR values for each county to CSR2.

*n: The aggregation method is "Weighted Average using major components"

*c: Using Capabilities Class Dominant Condition Aggregation Method

Soils data provided by USDA and NRCS.