

RYERSON REALTY LLC

2761 Country Lane Circle
Eagle Grove, IA 50533-0877

Phone 515-448-3079

Fax 515-448-5028

ryerson@goldfielddaccess.net

www.ryersonauctionrealtyltd.com



Deborah D Vance, Broker | Michael Ryerson, Sales | Todd Swalin, Sales

515-689-3715

515-689-3728

515-689-8987

Property Location: 203 N Eskridge, Dows
Legal Description: S 1/2 of Lot 16 Lot 17 NE NE
Price: \$189,900
Approximate Age: 1977
Style: 1 Story Ranch Walkout Basement
Bedrooms: 3 Br primary w/bath +craft
21'x9'/16'x12'/11'x10'
Siding: Masonite Painted 2017, Alum. Soffits
Roof Age: 2017
Lot Size: 115' X 227'
House Sq. Ft: 1,680
Garage: 2 Car Attached heated & 1 car det/No Garage Sink
Living Room Flooring: Carpet
Bathroom: Main: 1 Full & 3/4 w/ shower Basement: 3/4
Basement: Finished Family room/w gas firpl. w/ full Oak Kit. w/
Elec. Avg Aliant Energy \$150
Central Air: Yes Furnace: Geo Thermal
Fireplace: Gas
Deck: Patio with arbor & stamped concrete
Terms of Sale/Possession: Cash/Upon Final Settlement

Kitchen Details: 2 Full w/ appliances
Cabinets: Oak
Frig: Yes
Stove: Yes - Electric
Dishwasher: Yes
Garbage Disposal: Yes
Dining Space: Yes
Flooring: vinyl
Dining Room: Yes
Laundry Location: Main W&D w/ sink & freezer
Washer/Dryer: Yes Electric
Closet Pantry
Water Heater: 2010 80 Gal Electric
Water Softener: Yes - Kinetico stays
Appliances, sm office/BR, storage room
Vinyl Windows 2010
LP Tank Rented W&H
Elec. Panel: 200 Amp Breakers
Oak China Negotiable
Net Taxes: 2022-23 \$1,796

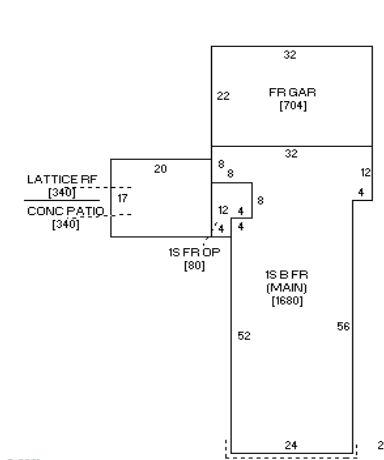

The following information, although believed to be accurate, is not guaranteed to be so. Buyer should do his own inspections. We assume no liability. The measurements are estimates only. This info is subject to change without notice. The seller does not warrant appliances past day of listing. The greatest compliment we can receive is a personal referral, please tell your friends about us.