

**RH Mounting View**

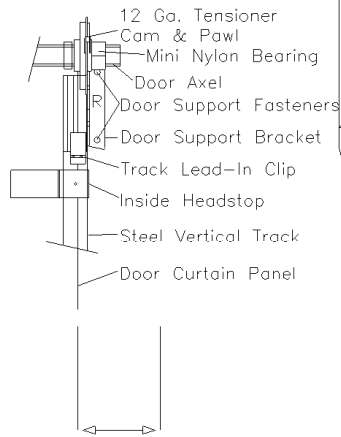

**Side Room Step Plate**

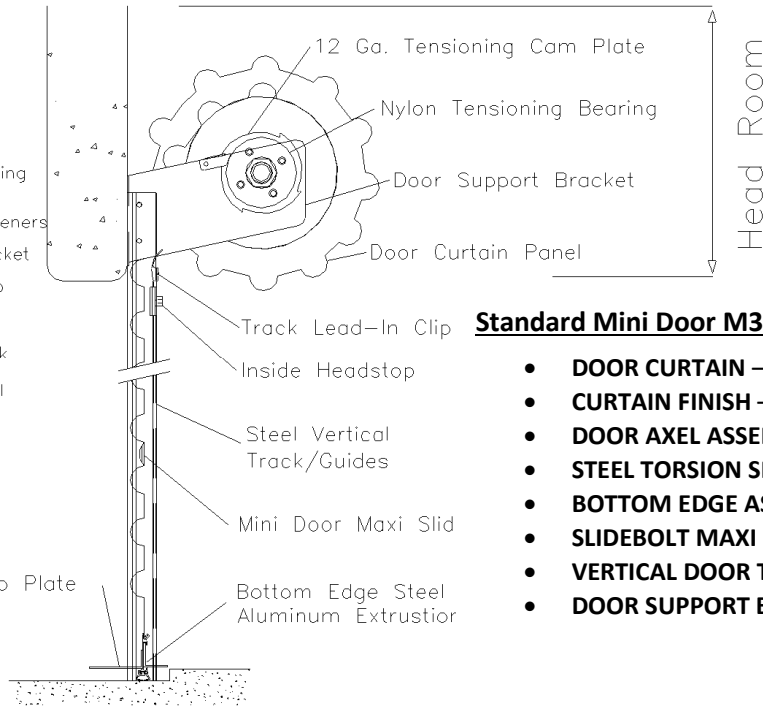

**Head Room & Side Room Clearance Requirements:**

Door Height	Minimum Head Room	Minimum Side Room L&R
Up to 7'-0"	15"	4" (6" Rec.)
Up to 8'-0"	16"	4" (6" Rec.)
Up to 10'-0"	17"	4" (6" Rec.)

**Standard Mini Door M3 Series Specifications:**

- **DOOR CURTAIN** – 26 gauge hot dip galvanized steel. Grade 80 Hardness.
- **CURTAIN FINISH** – Super durable polyester; 40 year adhesion & 25 year chalk and fade warranty.
- **DOOR AXEL ASSEMBLY** – Heavy wall steel tube with welded on galvanized steel drums.
- **STEEL TORSION SPRING** – Formed and stress relieved, engineered, oil tempered class II spring wire.
- **BOTTOM EDGE ASSEMBLY** – Heavy duty aluminum extrusion with 14 ga. x 1 1/2" x 1 1/2" steel angle.
- **SLIDEBOLT MAXI SLIDE YZ** – 12 gauge steel, zinc plated with dual padlock capacity for overlocking.
- **VERTICAL DOOR TRACKS** – 18 gauge hot dip galvanized steel with plastic alloy wear strips.
- **DOOR SUPPORT BRACKETS** – Heavy duty 12 gauge steel construction. (Pre-installed at Factory.)

**Standard Mini Roll-Up Door M3 Series Details**

**Steel and Wood Jamb Track Mounting**

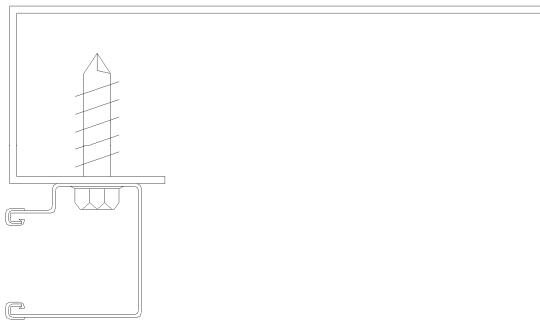

**Block Jamb with Z-Clip Track Mounting**

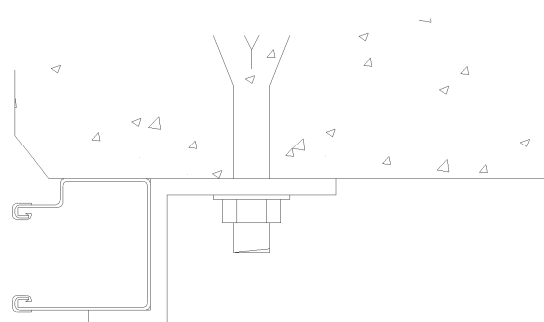

**Rough Opening Measurement:** Width (7'-0") x Height (8'-0")

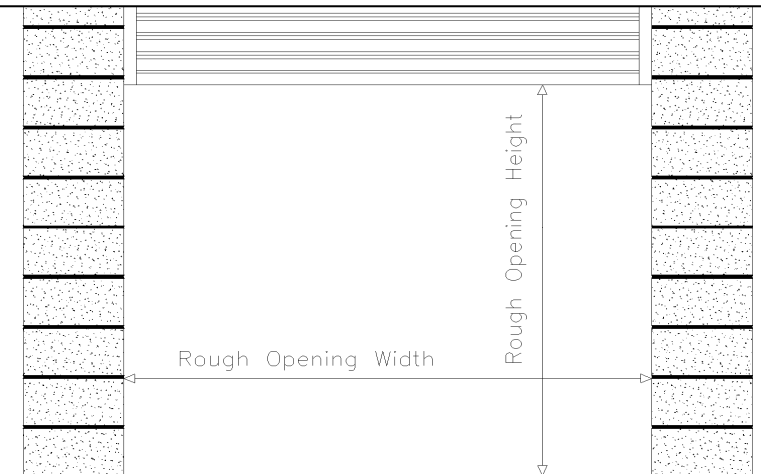

Pilot Door Systems, Inc.  
406 W. Industrial Drive #2  
Pleasant Grove, UT 84062

Phone: (801) 796-5933  
Fax: (801) 796-5935  
Email: sales@pilotdoorsystems.com

*Distributed by:*