

5,500 sq. ft For Lease

12250 Universal, Taylor, MI 48180



Listing ID: 30277598
 Status: Active
 Property Type: Industrial For Lease
 Industrial Type: Flex Space, Industrial-Business Park
 Contiguous Space: 5,500 SF
 Total Available: 5,500 SF
 Lease Rate: \$6.25 PSF (Annual)
 Base Monthly Rent: \$2,864
 Lease Type: Modified Gross
 Ceiling: 18 - 20 ft.
 Office SF: 800 SF
 Drive-In Bays: 1 Bay



Overview/Comments

For lease by owner. 5,500 sq.ft. of light industrial. 12250 Universal Dr. Taylor Mi. Heavy power. 480.

1 grade level overhead door. Metal halide lighting. Radiant heat. Call REA Construction for a tour at 743-946-8730. Visit our website at <http://www.rea-construction.net>.

West of Telegraph north of Northline.

QR Code

Scan this image with your mobile device:



General Information

| | | | |
|------------------|---|---------------------------|------------|
| Tax ID/APN: | 263960770 | Gross Building Area: | 36,300 SF |
| Industrial Type: | Flex Space, Industrial-Business Park, Manufacturing, Light Industrial | Building/Unit Size (RSF): | 5,500 SF |
| Zoning: | LIGHT INDUSTRIAL | Usable Size (USF): | 5,500 SF |
| Building Name: | Universal Trade Center 3 | Land Area: | 2.37 Acres |

Available Space

| | | | |
|---------------------|---------------------|------------------|-------------|
| Suite/Unit Number: | 12250 | Rent Escalators: | Fixed Lease |
| Space Available: | 5,500 SF | Offices: | 2 |
| Minimum Divisible: | 5,500 SF | Office SF: | 800 SF |
| Maximum Contiguous: | 5,500 SF | Parking Spaces: | 8 |
| Space Type: | Relet | Loading Docks: | 0 |
| Date Available: | 06/01/2018 | Drive In Bays: | 1 |
| Lease Rate: | \$6.25 PSF (Annual) | Ceiling Height: | 20 |
| Lease Type: | Modified Gross | Clear Height: | 18 |

Area & Location

| | |
|---------------------------|---------------------------------------|
| Property Located Between: | West of Telegraph north of Northline. |
| Highway Access: | I94 |
| Airports: | Detroit Metropolitan |

Building Related

| | | | |
|----------------------------|------------------|-----------------------|-------------------|
| Tenancy: | Multiple Tenants | Parking Ratio: | 1.4 (per 1000 SF) |
| Total Number of Buildings: | 1 | Parking Type: | Surface |
| Number of Stories: | 1 | Parking Description: | asphalt |
| Office Space SF: | 800 SF | Total Parking Spaces: | 8 |
| Property Condition: | Good | Column Spacing: | 50 |
| Year Built: | 1988 | Passenger Elevators: | 0 |
| Roof Type: | Flat | Freight Elevators: | 0 |
| Construction/Siding: | Block | Sprinklers: | None |

Volts: 408
X-Phase: 3
Heat Type: Natural Gas

Heat Source: Radiant
Lighting: Metal Halide
Internet Access: Cable

Land Related

Water Service: Municipal
Sewer Type: Municipal
Legal Description: 60-056-02-0022-000

Location

Address: 12250 Universal, Taylor, MI 48180
County: Wayne
MSA: Detroit-Warren-Dearborn
Submarket: Airport District



Property Images



IMG_2560



12267 Universal (11)



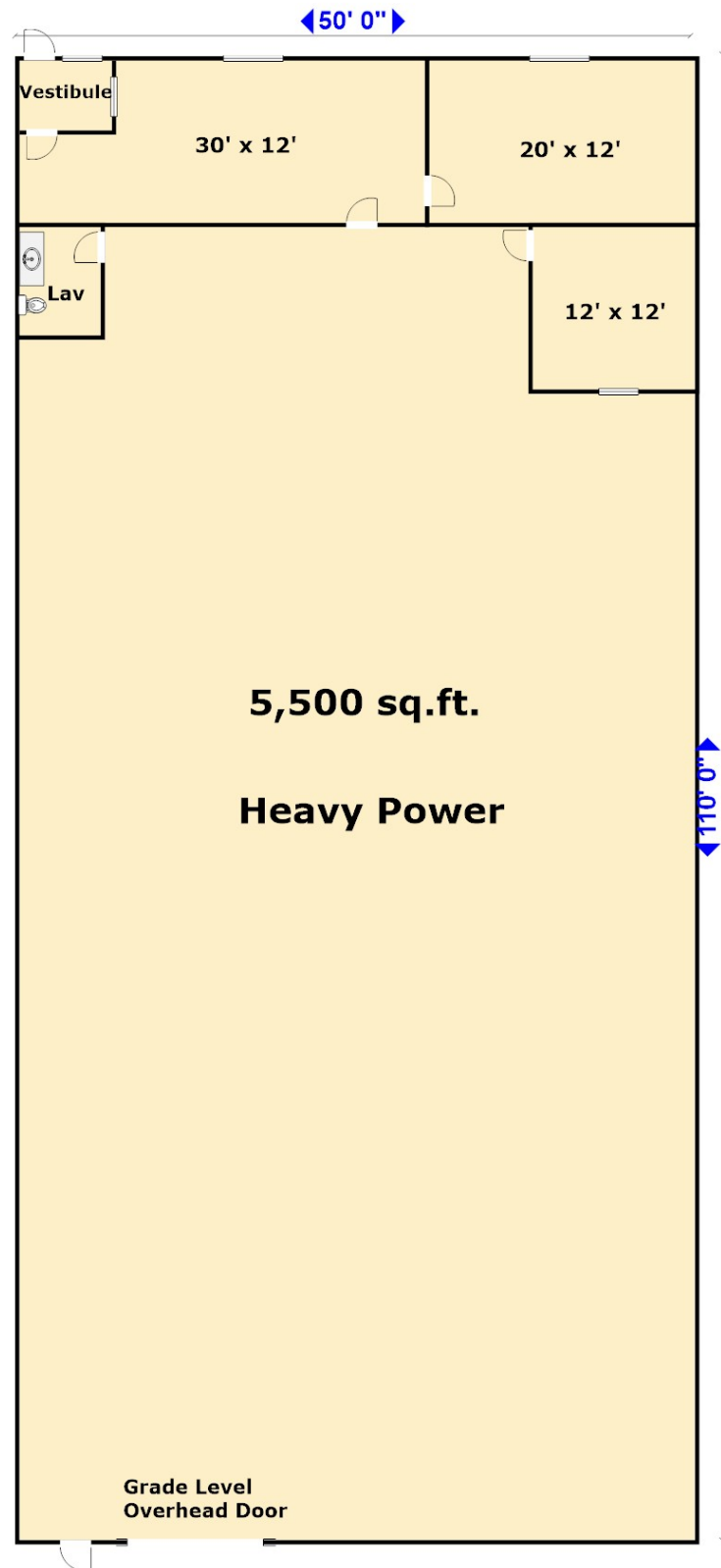

Property Contacts



Yvon Rea

Rea Construction

248-217-0482 [M]

734-946-8730 [O]

darren@reaconstruction.net