

PARTS ORDERING INFORMATION

In order for us to promptly fill parts orders it is important that you supply us correct information as indicated to the right. DO NOT ORDER BY THE ITEM #. Item numbers are for your reference ONLY and the correct parts CAN NOT be furnished from them. Money order or check MUST accompany all parts orders. Shipments WILL NOT be made prior to receipt of payment. All items require 50c additional to cover postage and handling. Minimum parts order (exclusive of handling) \$1.00. All prices subject to change without notice. Allow 2 to 3 weeks for delivery.

YOUR NAME
STREET ADDRESS
CITY, STATE
ZIP CODE NO.
PART NO. REQUIRED
QUANTITY
PART NAME
DESCRIPTION

Send Order to: General Parts Co. - P.O. Box 429 - Omaha, Nebr. 68101

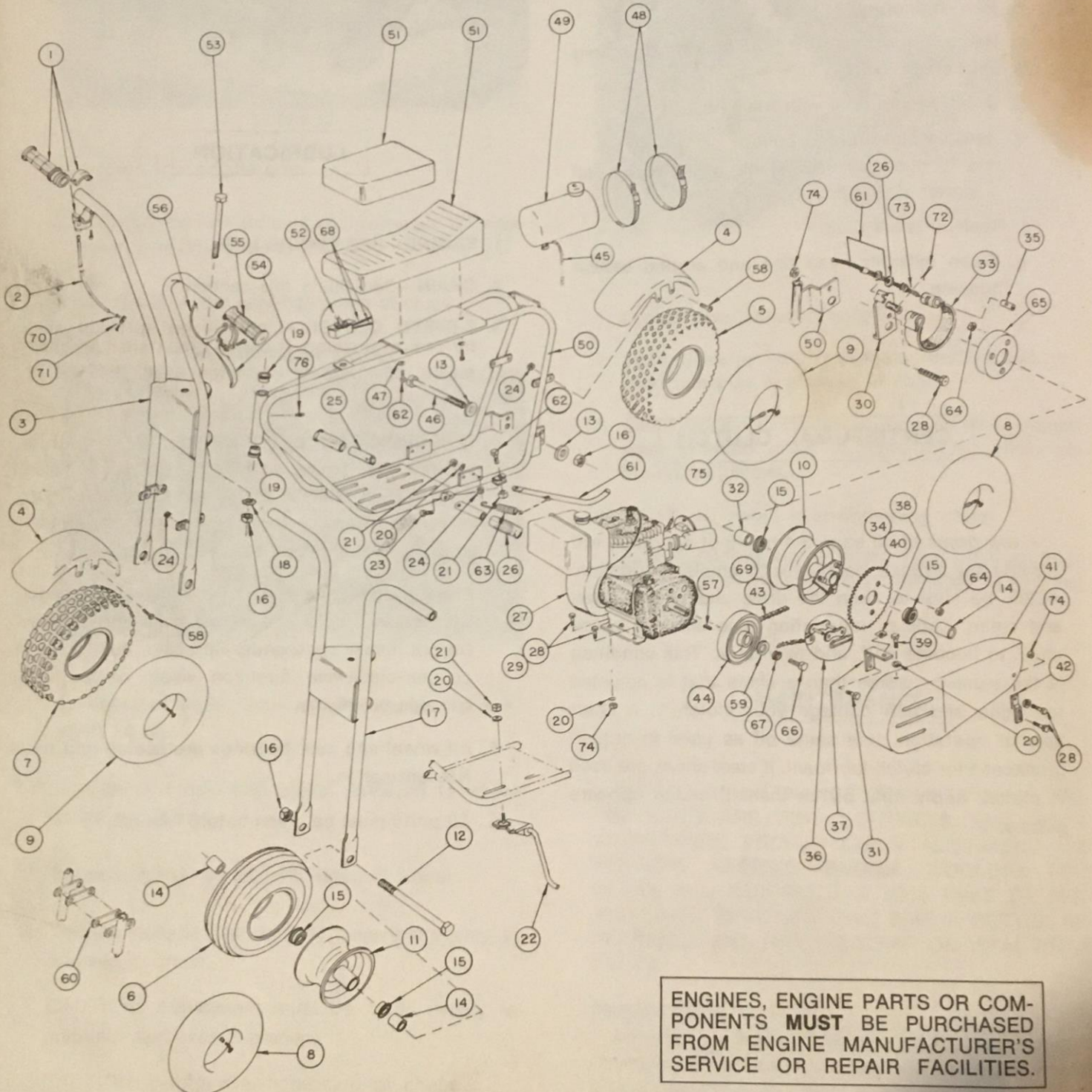

ENGINES, ENGINE PARTS OR COMPONENTS **MUST** BE PURCHASED FROM ENGINE MANUFACTURER'S SERVICE OR REPAIR FACILITIES.

Quantity Used on Model

Item No.	Part No.	Description	Quantity Used on Model				Price Each
			GTO 100	GTO 200	GTO 300	GTO 500	
1	57-012-0003	Throttle Control	1	1	1	1	4.75
2	57-076-0001	Cable Throttle Control	1	1	1	1	2.45
3	42-057-0008	Fork Ass'y, Bent	—	—	1	1	12.75
4	51-071-0001	Fender (Specify Color)	—	—	2	2	3.95
5	53-049-0003	Tire 410/350 x 4 Stud Tread	1	1	—	—	* 6.95
5	53-049-0004	Tire—410/350 x 6 Stud Tread	—	—	1	1	* 8.50
6	53-049-0005	Tire—410/350 x 4 Sawtooth Tread	1	1	—	—	* 6.95
7	53-049-0006	Tire—410/350 x 6 Universal Tread	—	—	1	1	* 8.50
8	55-049-0001	Tube—410/350 x 4	2	2	—	—	* 2.95
9	55-049-0002	Tube 410/350 x 6	—	—	2	2	* 3.50
10	42-052-0007	Wheel Rear Steel - 4"	1	1	—	—	8.15
10	42-052-0008	Wheel Rear Steel - 6"	—	—	1	1	9.40
11	42-052-0003	Wheel Front Steel 4"	1	1	—	—	6.75
11	42-052-0005	Wheel Front Steel 6"	—	—	1	1	8.90
12	81-171-0002	Front Axle 5/8 - 18 x 8	1	1	1	1	1.85
13	84-173-0001	Washer 5/8"	2	2	2	2	.20
14	51-046-0010	Spacer 5/8" I.D. x 7/8" O.D. x 1/2" Lg.	3	3	3	3	.35
15	57-003-0002	Bearing	4	4	4	4	1.75
16	83-174-0001	Lock Nut 5/8" - 18	3	3	3	3	.20
17	42-057-0007	Fork Ass'y Straight	1	1	—	—	11.75
18	84-074-0001	Lock Washer	1	1	1	1	.20
19	52-008-0006	Bushing	2	2	2	2	.40
20	84-122-0001	Washer 5/16"	7	7	7	7	.20
21	83-123-0001	Lock Nut 5/16" - 18	3	3	3	3	.20
22	57-061-0001	Kick Stand * * *	1	1	1	1	2.40
23	81-111-0006	Hex Hd. Scr. 1/4" x 11/2"	2	2	2	2	.20
24	83-113-0001	Hex Lock Nut 1/4" - 20	2	2	6	2	.20
25	51-061-0016	Foot Rest - Long	—	—	1	1	.65
25	51-061-0017	Foot Rest - Short	1	1	—	—	.55
26	53-026-0001	Cover - Foot Rest - Black	2	2	2	2	.25
27	Tecumseh Engine	2 1/2 H.P. With Tank	1	—	—	—	***
27	Tecumseh Engine	3 H.P. With Tank	—	1	—	—	***
27	Tecumseh Engine	3 1/2 H.P. With Tank	—	—	1	—	***
27	Tecumseh Engine	4 H.P. Engine With Tank	—	—	—	1	***
27	Tecumseh Engine	5 H.P. Remote Tank	—	—	—	1	***
28	81-121-0017	Hex Hd. Scr. 5/16 - 24 x 3/4"	3	3	3	7	.20
29	81-121-0011	Hex Hd. Scr. 5/16 - 24 x 1 1/2"	5	5	5	5	.20
30	42-056-0019	Brake Bracket W. A.	1	1	1	1	1.75
31	81-121-0012	Hex Hd. Scr. 5/16" - 24 x 1/2"	1	1	1	1	.20
32	51-046-0050	Spacer Axle (Rear)	1	1	1	1	.50
33	51-059-0002	Brake Band 4 1/8" Dia.	1	1	1	1	4.75
34	51-048-0024	Sprocket (72-tooth)	1	1	1	1	5.00
35	51-039-0002	Brake Pin	1	1	1	1	.25
36	50-009-0012	Connecting Link No. 35 Chain	1	1	1	1	.20
37	51-056-0023	Brk't Chain Guard Front	1	1	1	1	.25
38	83-026-0001	Speed Nut 5/16" - 18	1	1	1	1	.20
39	81-121-0001	Hex Hd. Scr. 5/16" - 18 x 1/2"	1	1	1	1	.20
40	51-048-0007	Sprk't Steel Whl. 60 T	1	1	1	1	4.25
41	53-025-0001	Chain Guard	1	1	—	—	3.95
42	51-056-0032	Brk't Chain Guard Rear	1	1	1	1	.20
43	50-009-0010	Chain No. 35 x 123 Pitches	1	1	—	—	6.50
44	50-011-0002	Clutch Double Spkt. Comet * * *	1	1	1	1	* 16.10
44	50-011-0004	Clutch Single Spkt. Max Torque * * *	1	1	1	1	* 16.10
45	55-064-0001	Fuel Line	1	1	1	1	1.15
46	81-171-0003	Axle Rear 5/8" - 18 x 8 1/2"	1	1	1	1	1.85
47	84-223-0001	5/16" Split Lk. Washer	2	2	2	2	.20
48	57-066-0001	Clamp—Fuel Tank	1	1	1	1	1.15
49	50-021-0002	Tank—Fuel	—	—	—	2	7.35
50	42-057-0004	Frame W. A. (Fixed Axle)	1	1	—	—	29.60
50	42-057-0006	Frame W. A. (Fixed Axle w/Brkts.)	—	—	1	1	29.60
51	50-062-0004	Seat 12" Smooth (Blk.)	1	1	—	—	6.85
51	50-062-0005	Seat 12" Raised Back (Blk.)	—	—	1	1	7.30
51	50-062-0008	Seat 16" Ribbed Raised Back (Blk.)	1	1	—	—	9.50
52	57-072-0009	Toggle Switch	1	1	1	1	1.80
53	81-171-0001	Pivot Screw 5/8" - 18 x 6 1/2"	1	1	1	1	1.10
54	57-012-0004	Brake Control	1	1	1	1	3.50
55	53-026-0002	Hand Grip (Blk.)	1	1	1	1	.50
56	57-076-0008	Brake Cable	1	1	1	1	3.50
57	87-254-0001	Key 3/16" Sq. x 9/16" * * *	1	1	1	1	.20
58	81-215-0001	1/4" x 20 x 1/2" Rd. Hd. Mach. Sc.	1	1	1	1	.20
59	84-133-0002	Washer 3/8" I.D.	1	1	8	8	.20
60	51-046-0021	Fender Spacer * * *	1	1	1	1	.20
61	57-042-0067	Kickstand Rod * * *	1	—	2	2	.50
62	81-121-0003	Bolt	3	3	3	3	1.00
63	51-047-0021	Spring * * *	1	1	1	1	.20
64	83-133-0001	Rear Wheel Nuts 3/8 x 16	6	6	6	6	1.05
65	51-060-0003	Brake Drum (steel only) * * *	1	1	1	1	.20
66	81-131-0015	Engine Shaft Hardware - Bolt	1	1	1	1	3.95
67	83-223-0001	Engine Shaft Hardware - Split Lock	1	1	1	1	.20
68	21-053-0001	15" Kill Wire	1	1	1	1	.20
69	50-009-0011	131 Link Chain for 72 T Sprocket	—	—	1	1	.50
70	51-067-0005	Eyelet	1	1	1	1	6.50
71	88-000-0002	Wire Stop	1	1	1	1	.20
72	86-324-0001	Cotter Key	1	1	1	1	.20
73	51-047-0014	Brake Spring	1	1	1	1	.20
74	83-123-0002	Hex Nut, 5/16 x 24	3	3	3	7	.50
75	51-082-0002	Valve Ext.	1	1	—	—	.20
76	51-033-0001	Grease Zerk	1	1	1	1	.30

* Dealers Contact factory. Items are NET Priced.

* * * If Applicable.

* * * * Engine Parts Contact Local Engine Mfg.'s. Service Facilities.

Prices Are Approximate and Subject To Change Without Notice.