

VICINITY MAP



LOCATION MAP



HERITAGE OAK PARK COMMUNITY DEVELOPMENT DISTRICT POOL IMPROVEMENTS

PORT CHARLOTTE, FLORIDA
SECTION 08 , TOWNSHIP 40, RANGE 22

PRELIMINARY CONSTRUCTION PLANS

PLAN INDEX

- 1 COVER SHEET
- 2 PLAN SHEET
- 3 ARCHIVED POOL PLAN

SITE DATA

ADDRESS : PORT CHARLOTTE, FL
EXISTING SITE USE : RESIDENTIAL SUBDIVISION
PROPOSED SITE USE : RESIDENTIAL SUBDIVISION

PREPARED FOR:
HERITAGE OAK PARK CDD

PREPARED BY:



CA 5917

DEVELOPMENT TEAM

OWNER/ DEVELOPER

HERITAGE OAK PARK
COMMUNITY DEVELOPMENT DISTRICT
1620 HERITAGE OAK BLVD
PORT CHARLOTTE, FL 33948

CIVIL ENGINEER

JMT
2000 EAST 11TH AVENUE
SUITE 300
TAMPA, FLORIDA 33605-3830
CONTACT : STEPHEN BRLETIC, PE
PHONE : 813.868.6508

SURVEYOR

JMT
2000 EAST 11TH AVENUE
SUITE 300
TAMPA, FLORIDA 33605-3830
CONTACT : DAVID PURDOMENECH, PSM
PHONE : 813.314.0314

GENERAL CONTRACTOR

(TO BE DETERMINED)

GENERAL SITE NOTES

1. THE CONTRACTOR SHALL PERFORM ALL CONSTRUCTION IN ACCORDANCE WITH THE LINES AND GRADES SHOWN ON THE PLANS AND TO TOLERANCES STATED HEREIN OR IN THE SPECIFICATIONS. REFER TO ARCHITECTURAL SITE PLANS FOR HORIZONTAL DIMENSIONS AND CONTROL, FOR BUILDINGS, PAVEMENT, ETC. HORIZONTAL LOCATIONS FOR UTILITIES, ETC. ARE PROVIDED IN THE CIVIL DRAWINGS.
2. THE CONTRACTOR SHALL BE RESPONSIBLE FOR MAINTAINING ALL HORIZONTAL AND VERTICAL CONTROL MARKERS AND PROPERTY CORNERS (MONUMENTS, PIPES, ETC.) FOR THE DURATION OF CONSTRUCTION. MARKERS SHALL BE CONTINUOUSLY FLAGGED AND SHALL BE RESET IMMEDIATELY BY A FLORIDA LICENSED LAND SURVEYOR IF ANY SHOULD BECOME DISTURBED.
3. LOCATIONS, ELEVATIONS AND DIMENSIONS OF EXISTING UTILITIES, STRUCTURES, AND OTHER FEATURES ARE SHOWN ACCORDING TO THE BEST INFORMATION AVAILABLE AT THE TIME OF THE PREPARATION OF THESE DRAWINGS AND DO NOT PURPORT TO BE ABSOLUTELY CORRECT. THE CONTRACTOR SHALL VERIFY THE LOCATIONS, ELEVATIONS AND DIMENSIONS OF ALL EXISTING UTILITIES, STRUCTURES, ETC. AFFECTING THE WORK PRIOR TO CONSTRUCTION.
4. IF UTILITY FIELD LOCATIONS ARE REQUIRED, THE CONTRACTOR SHALL COORDINATE THE CONSTRUCTION SCHEDULE WITH ALL UTILITY COMPANIES AS WELL AS ANY AFFECTED CITY AND COUNTY DEPARTMENTS BY PROVIDING A MINIMUM OF 48 HOURS NOTICE OF WHEN CONSTRUCTION WILL COMMENCE IN AN AREA IN ORDER TO PERMIT FIELD LOCATION OF UTILITY LINES PRIOR TO CONSTRUCTION. A TOLL-FREE NUMBER, 1-800-432-4770 IS AVAILABLE TO ASSIST IN SUCH COORDINATION EFFORTS. THIS NUMBER IS PART OF THE UTILITY NOTIFICATION PROGRAM PROVIDED BY SUNSHINE STATE ONE-CALL OF FLORIDA, INC. BUT DOES NOT NECESSARILY REPRESENT ALL UTILITY COMPANIES IN THE AREA.
5. ALL UTILITIES SHALL BE KEPT IN OPERATION EXCEPT WITH THE EXPRESS WRITTEN CONSENT OF THE UTILITY OWNER. IT SHALL BE THE CONTRACTOR'S RESPONSIBILITY TO PRESERVE EXISTING UTILITIES AND ANY AND ALL DAMAGE TO EXISTING UTILITIES AS A RESULT OF THE CONTRACTOR'S ACTIONS SHALL BE REPAIRED AT THE CONTRACTOR'S EXPENSE.
6. THE CONTRACTOR SHALL REPLACE ALL PAVING, STABILIZED EARTH, DRIVEWAYS, SIDEWALKS, FENCES, RETAINING WALLS, ETC. REMOVED OR DAMAGED DURING CONSTRUCTION WITH THE SAME MATERIAL, REMOVED OR DAMAGED OR AS DIRECTED BY THE ARCHITECT/ENGINEER.
7. THE CONTRACTOR SHALL CONTACT THE ENGINEER PRIOR TO PROCEEDING WITH ANY SITE WORK WITH WHICH A CONFLICT HAS ARISEN DURING THE CONSTRUCTION OF ANY IMPROVEMENTS SHOWN ON THESE DRAWINGS.
8. ALL FUGITIVE DUST SHALL BE CONTROLLED ON SITE. ONLY AREAS SCHEDULED FOR IMMEDIATE CONSTRUCTION SHALL BE CLEARED OR STRIPPED OF VEGETATION. WATERING, APPLICATION OF CALCIUM CHLORIDE OR OTHER PRIOR APPROVED MEANS OF DUST CONTROL SHALL BE EMPLOYED TO PREVENT THE EMANATION OF DUST FROM THE SITE. PERMANENT GRASSING, LANDSCAPING AND OTHER SITE WORK SHALL BE INCORPORATED AS SOON AS POSSIBLE.
9. CONSTRUCTION SHALL BE CARRIED OUT "IN THE DRY". THE CONTRACTOR SHALL REVIEW SITE CONDITIONS AND DETERMINE METHODS AND EXTENT OF DEWATERING NECESSARY AND SHALL INCLUDE COSTS OF DEWATERING IN THE BID. NO ADDITIONAL COMPENSATION SHALL BE PROVIDED FOR CONTROL OF GROUND OR SURFACE WATER OR FOR ADDITIONAL MATERIALS OR REWORK REQUIRED AS A RESULT OF INADEQUATE OR INSUFFICIENT DEWATERING.
10. ALL WORK TO BE PERFORMED FOR THE COMPLETION OF THIS PROJECT SHALL BE CONSTRUCTED ACCORDING TO THE BEST PRACTICES OF THE INDUSTRY AND IN ACCORDANCE WITH THE SPECIFICATIONS, AND ALL APPLICABLE FEDERAL, STATE, COUNTY AND/OR CITY CODES, ORDINANCES, STANDARDS AND PERMIT CONDITIONS.
11. REFER TO DETAILS FOR TREE PROTECTION REQUIREMENTS. THE CONTRACTOR SHALL NOT REMOVE ANY TREES OTHER THAN THOSE SPECIFICALLY SHOWN TO BE REMOVED.
12. CONTRACTOR IS RESPONSIBLE FOR CONTROLLING SITE EROSION AND SHALL PROVIDE ADDITIONAL SOG, AS NECESSARY, TO ACHIEVE A FULLY GRASSED SITE FREE FROM RUTTING, ETC. TO THE LINES & GRADES SHOWN HEREIN UPON FINAL ACCEPTANCE.
13. SOG ALL DISTURBED AREAS WITH MATCHING VARIETY.
14. CONTRACTOR TO PROVIDE CLEAN FILL FREE OF ROOTS, WIRE, CONCRETE AND ALL OTHER CONSTRUCTION DEBRIS.

ENVIRONMENTAL PROTECTION NOTES

1. CONSTRUCTION EQUIPMENT SHALL NOT BE OPERATED IN WETLAND AREAS UNLESS SUCH CONSTRUCTION PRACTICES ARE APPROVED IN A PLAN OF OPERATION SUBMITTED TO THE ENGINEER & THE APPROPRIATE REGULATORY AUTHORITIES.

ROBERT E DVORAK, P.E. SEAL NO. #: 40962

GENERAL PROJECT TASKS

1. CLUBHOUSE PROPERTY OUTSIDE CONSTRUCTION ZONE SHALL BE MAINTAINED AND UNOBSTRUCTED SO THAT ALL OTHER AMENITIES ARE USABLE
2. CONTRACTOR SHALL SECURE SITE AND PROVIDE SIGNAGE FOR THE DURATION OF THE PROJECT
3. STAGING AREAS TO BE DETERMINED AT PRE-CONSTRUCTION MEETING
4. PROPERLY DRAIN THE POOL
5. PLACE SILT FENCE AROUND EXCAVATION LIMITS AS SHOWN ON THE PLAN
6. PLACE INLET FILTER BAG IN THE EXISTING INLETS UNTIL ALL EARTHWORK HAS BEEN COMPLETED
7. SHOOT EXISTING CORNERS OF THE POOL PRIOR TO DISTURBANCE TO OBTAIN EXISTING ELEVATIONS (TO BE MATCHED UPON COMPLETION) AND PATCH POOL DECK SURFACE
8. EXCAVATE AND INSTALL THE 8" HDPE PIPE, ENSURING THE PIPE HAS 1 FOOT OF COVER AND A MINIMUM SLOPE OF 0.5%
9. TIE THE 12" HDPE PIPE TO THE EXISTING INLET BOX USING A CONCRETE COLLAR
10. EXCAVATE AND INSTALL THE TRENCH DRAINS AT THE SOUTHWEST CORNER OF THE POOL AS SHOWN ON THE PLAN
- 10.1. EXCAVATION OF THE PAVERS 10 FEET FROM THE EDGE OF THE POOL TO THE EDGE OF THE POOL MAY BEGIN SIMULTANEOUSLY TO THE INSTALLATION OF THE TRENCH DRAINS
- 10.2. ENSURE ALL UTILITIES UNCOVERED DURING EXCAVATION ARE PROTECTED AND/OR REPLACED BACK TO THE EXISTING CONDITIONS WHEN FILLING BACK IN
11. TRENCH DRAINS ARE TO BE PROTECTED USING INLET PROTECTION AS SOON AS INSTALLATION IS COMPLETE AND REMAIN UNTIL ALL EARTHWORK HAS BEEN COMPLETED
12. EXCAVATION IS TO BE LIMITED TO ONE EDGE OF THE POOL AT A TIME
13. ALL PAVERS WITHIN 10 FEET OF THE EDGE OF THE POOL ARE TO BE CAREFULLY REMOVED IN ORDER TO REUSE AS MANY PAVERS AS POSSIBLE
- 13.1. REPLACE ALL BROKEN PAVERS WITH MATCHING
14. THE EXISTING EARTH IS TO BE EXCAVATED TO A DEPTH EQUAL TO THE ELEVATION OF THE BOTTOM OF THE POOL, WHICH VARIES FROM 3 TO 6 FEET
- 14.1. PROPERLY DISPOSE OF ALL MATERIALS REMOVED FROM THE SITE
15. EXCAVATED AREAS ARE TO BE FILLED BACK TO MATCH THE EXISTING GRADE USING CLEAN FILL
- 15.1. CLEAN FILL SHOULD BE COMPACTED TO 95% OF THE MAXIMUM DRY DENSITY AS DETERMINED BY THE GEOTECHNICAL ENGINEER
- 15.2. CLEAN FILL SHOULD BE PLACED IN LOOSE LIFTS NOT EXCEEDING 8 INCHES IN THICKNESS
- 15.3. CLEAN FILL SHOULD BE A SELECT STRUCTURAL FILL, FREE OF ROOTS AND ORGANICS
16. RESET PAVERS TO MATCH EXISTING GRADE AND REPLACE BROKEN PAVERS TO MATCH
17. BROKEN POOL TILE IS TO BE REMOVED AND REPLACED
18. REMOVE E&S CONTROLS (SILT FENCE AND INLET PROTECTION)
19. REFILL THE POOL

NOTES:

1. WORK SHALL BE PERFORMED SO THAT NO MORE THAN ONE SIDE OF THE POOL IS EXCAVATED AT A TIME
2. SOD ALL DISTURBED AREAS (MATCH EXISTING)
3. DEPTH MARKERS AND NO DIVING SIGNAGE TO REMAIN IN PLACE OR BE RESTORED
4. HAND RAILS TO REMAIN OR BE RESTORED
5. CONTRACTOR SHALL HAVE A SUPERVISOR RESPONSIBLE FOR THE WORK FOR THE DURATION OF THE PROJECT
6. CONTRACTOR SHALL BE RESPONSIBLE FOR THE SURVIVABILITY OF SOD FOR 30 DAYS AFTER ACCEPTANCE
7. CONTRACTOR TO CONTACT ENGINEER FOR APPROVAL OF ANY DEVIATION NECESSARY AFTER VERIFICATION OF ALL EXISTING DATA PRIOR TO CONSTRUCTION
8. UTILITY CONFLICTS AND DAMAGED UTILITIES TO BE RESOLVED OR RESTORED BY CONTRACTOR. SEE ARCHIVED POOL SCHEMATIC (BY OTHERS).

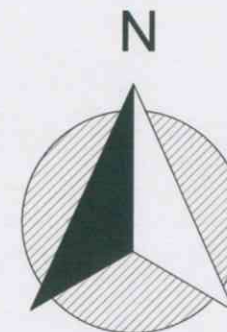
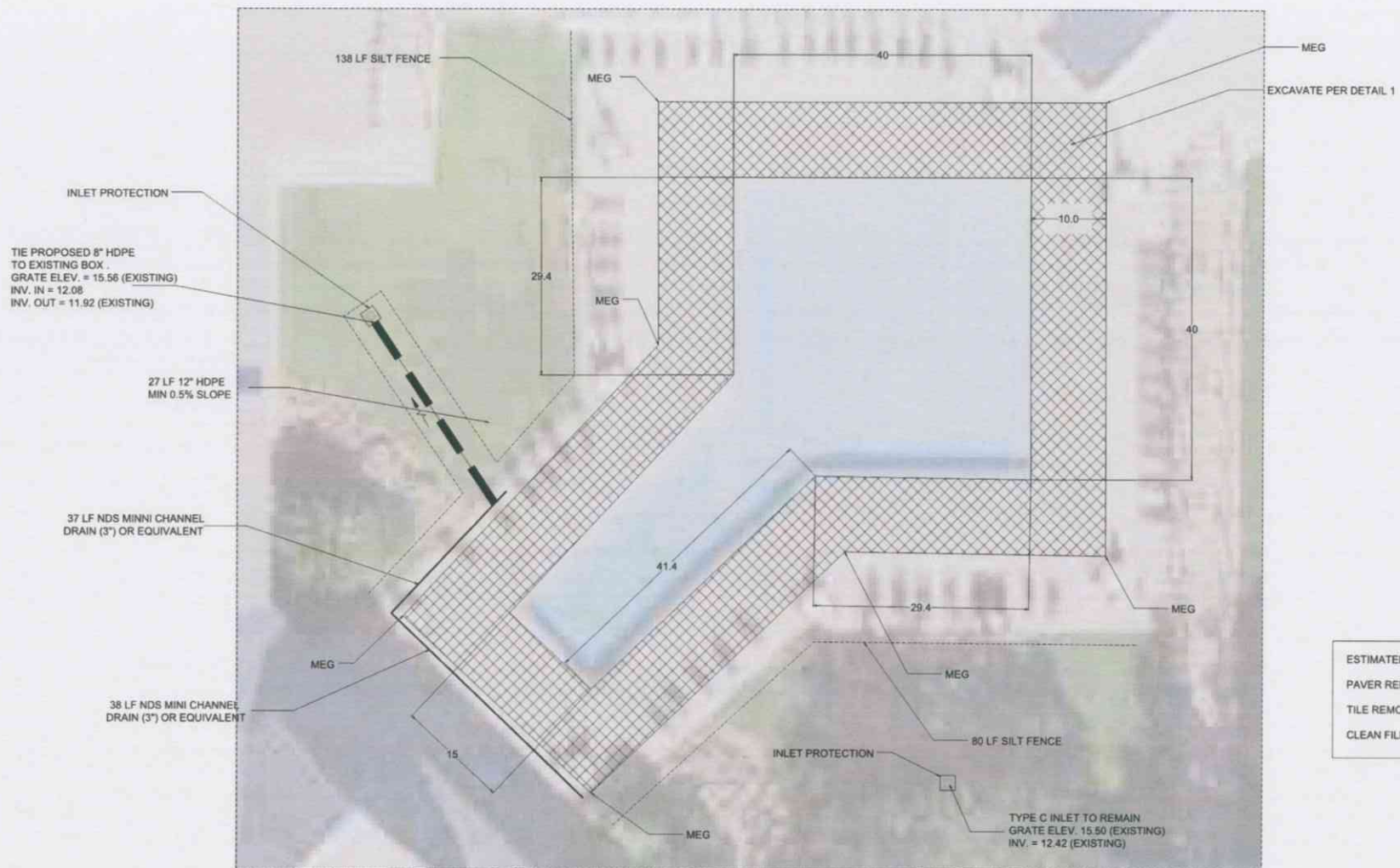

Scale: 1" = 10'



ESTIMATED QUANTITIES	
PAVER REMOVAL/ REPLACEMENT:	2763 SF
TILE REMOVAL/REPLACEMENT:	237 LF
CLEAN FILL:	443 CY



Stephen D. Baker, P.E.
Florida P.E. NO. 11271



NO.	REVISIONS	DATE
1	ORIGINAL	11/02/2020
2		
3		
4		
5		
6		

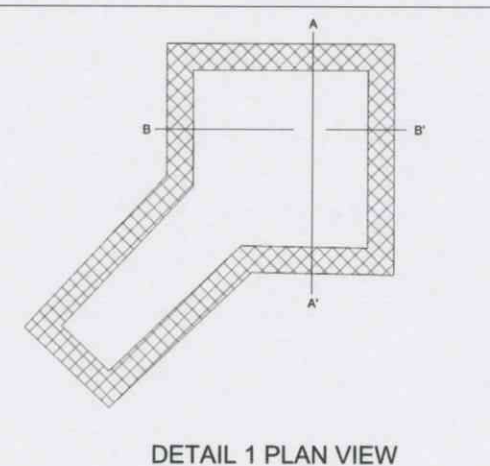
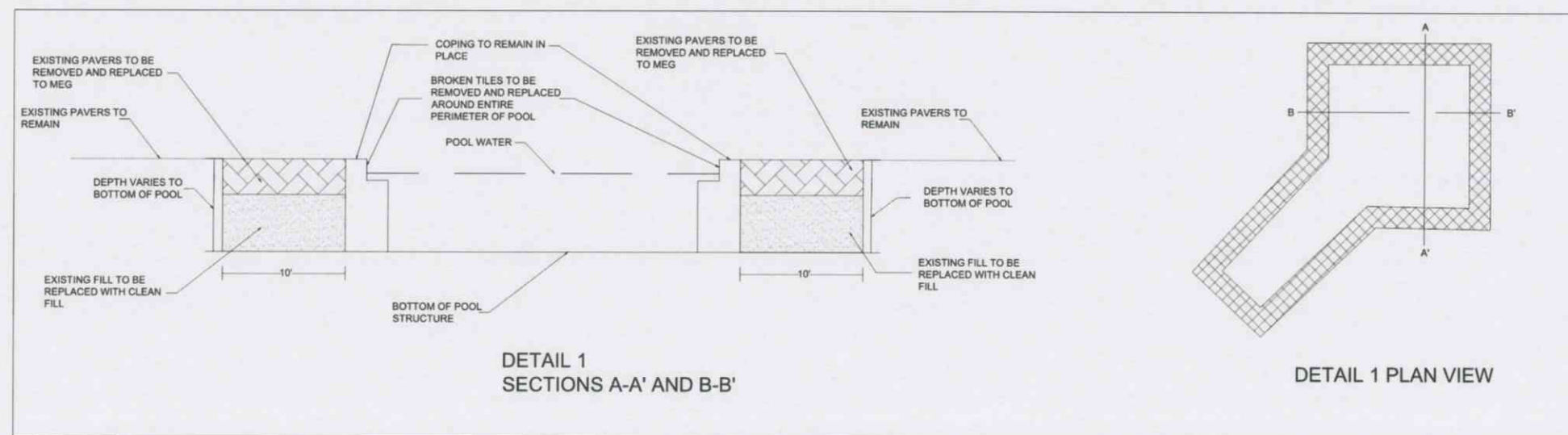
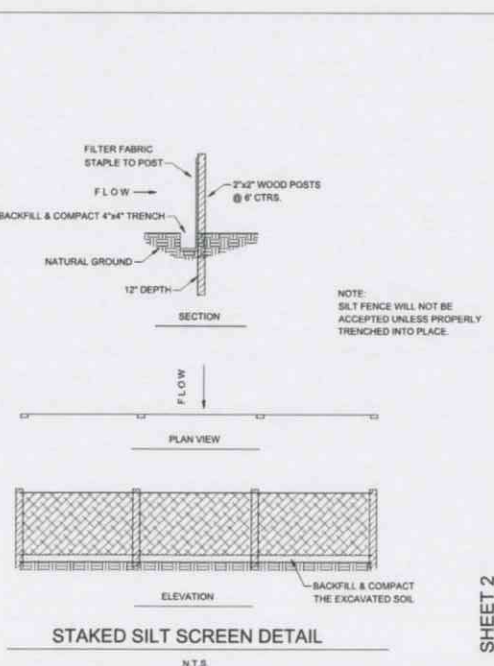

POOL IMPROVEMENTS

HERITAGE OAKS CDD

SHEET 2

PRELIMINARY
CONSTRUCTION SET



JOB NO.	19-01826-001
DRAWN	SRE
DESIGNED	SRE
CHECKED	RED
QC	RED
SHEET	

THE FLOW RATE THROUGH EACH INLET SHALL NOT EXCEED 18 G.P.M. AND ARE FLOW ADJUSTABLE.

POOLS GREATER THAN 20 FEET MAY HAVE A COMBINATION OF WALL AND FLOOR INLETS PROVIDED THE NUMBER OF WALL INLETS IS SUCH THAT THE MAXIMUM SPACING BETWEEN WALL INLETS IS 20 FEET AND THE FLOOR INLETS ARE PROVIDED FOR THE POOL WATER AREA BEYOND A 10 FOOT PERPENDICULAR DISTANCE FROM ALL WALLS. THE NUMBER OF FLOOR INLETS SHALL BE SUCH THAT THE SPACING BETWEEN ADJACENT INLETS DOES NOT EXCEED 20 FEET AND THE DISTANCE FROM A FLOOR INLET AND AN ADJACENT WALL DOES NOT EXCEED 24 FEET. FLOOR INLETS SHALL BE DESIGNED AND INSTALLED SUCH THAT THEY DO NOT PROTRUDE MORE THAN FIVE-EIGHTHS INCHES ABOVE THE POOL FLOOR AND NOT TO CONSTITUTE SHARP EDGES OR PROTRUSIONS HAZARDOUS TO THE POOL BATHERS

NOTES:
 ALL PLUMBING SHOWN IS SCHEMATIC AND SCHEDULE 40Pw RIGID PVC, NSF APPROVED.
 ALL PIPE SIZE SHOWN IS MIN. SIZE REQUIRED.
 PIPE FITTING SIZE IS THE SAME SIZE OF THE LARGEST PIPE CONNECTED TO THE FITTING.
 FLEX PIPE MAY BE USED IF PIPE IS TOTALLY ENCASED IN CONCRETE.

POOL DATA	
SURFACE AREA	2166.25 SQ. FT.
PERIMETER	236.79 LIN. FT.
POOL VOLUME	66,600 GAL.
TURNOVER RATE	250 GPM MIN.
RATE OF FLOW	4.44 HOURS
BATHING LOAD	50 PEOPLE MAX.

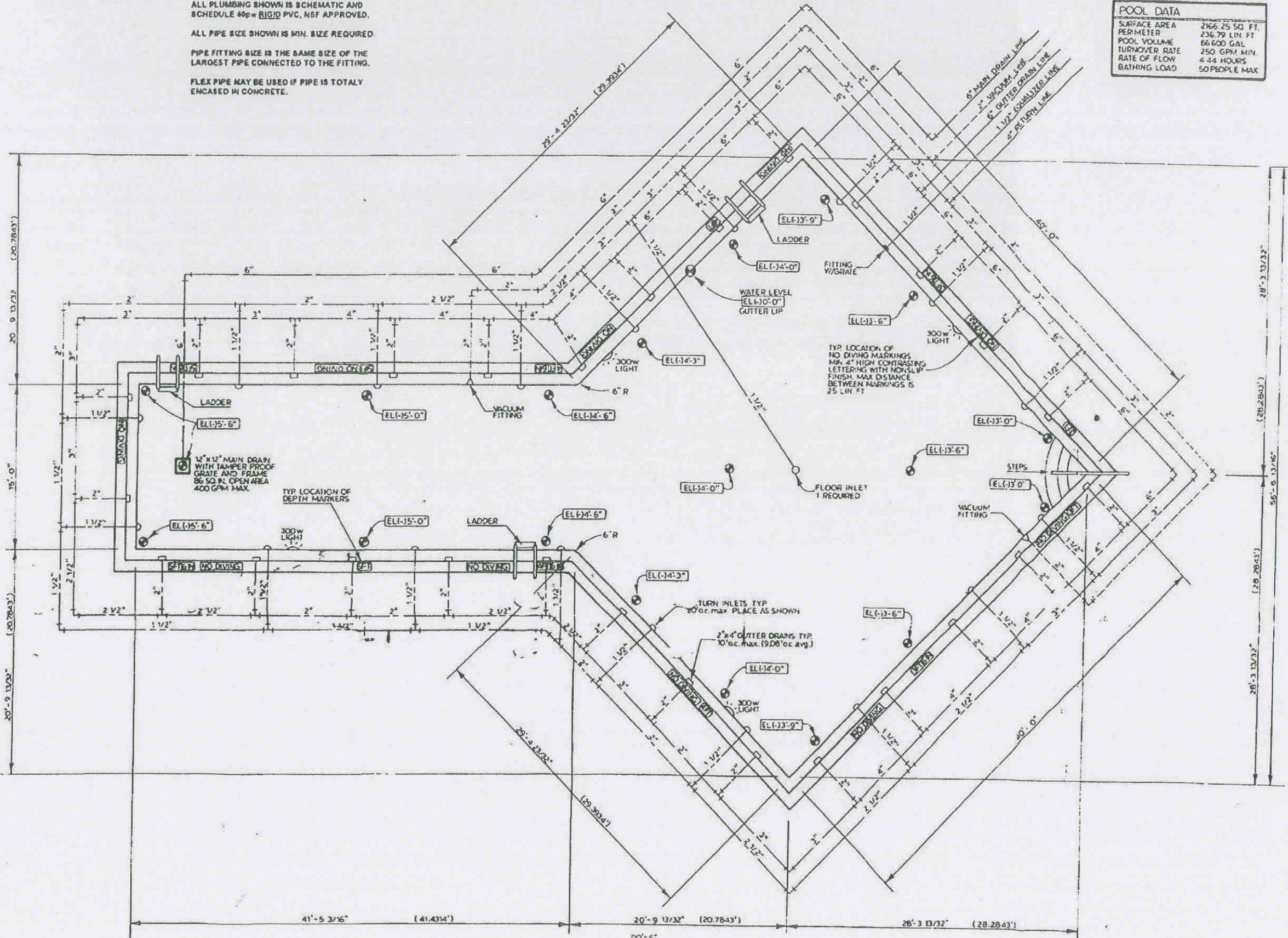

THE POOL RULES SIGN MUST HAVE A MINIMUM OF ONE INCH HIGH LETTERING, EXCEPT THE "NO DIVING" LETTERING MUST BE A MINIMUM OF FOUR INCHES IN HEIGHT.
 ADDITIONAL RULES RELATING TO POOL OPERATION AND PATRON BEHAVIOR MAY BE POSTED.

CONSTRUCTION SOUTHERN SOUTHERN E-4, AND ANY
 BY BUILDING NS AND TS PRIOR TO
 ANY DEVIATIONS RED BY THE
 SPECIFICATIONS THESE PLANS THIS OF SUCH RESULTS AND
 FOR SUPERVISION STANDARD DEPARTMENT