

THIS AREA OF THE COMMUNITY SHOWN
AS INSET A ON PAGE 02

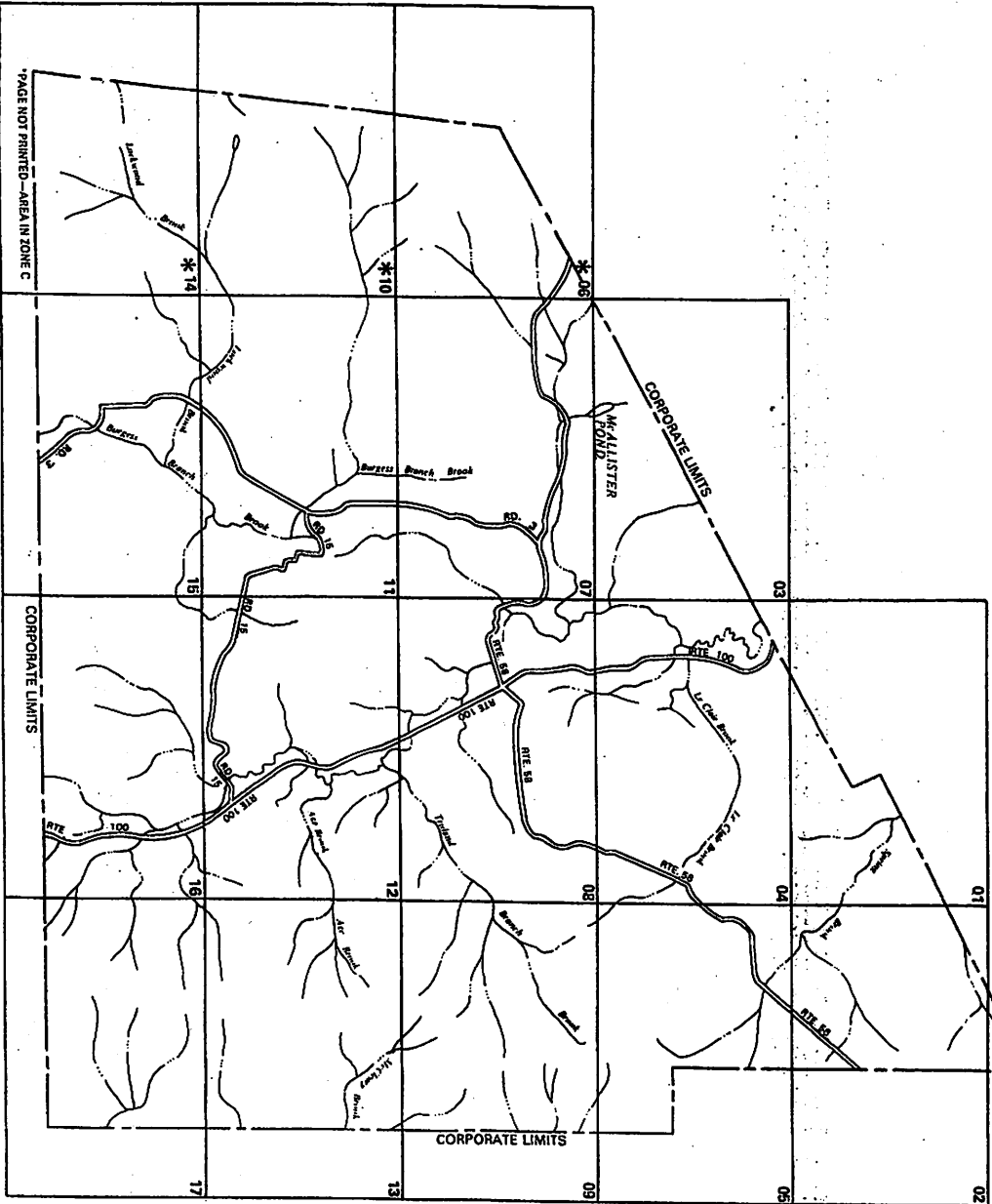

*PAGE NOT PRINTED—AREA IN ZONE C

KEY TO SYMBOLS

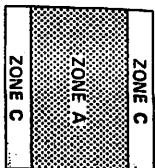

ZONE DESIGNATIONS*

Base Flood Elevation Line with elevation in feet
 Base Flood Elevation where uniform within zone
 Elevation Reference Mark
 River Mile
 * 51.3
 (EL. 89.7)
 RM 7.5
 * M.T.S.

***EXPLANATION OF ZONE DESIGNATIONS**

A flood insurance map displays the zone designations by determining, according to areas of designated flood hazards. The zone designations used are:

- Zone**
- A** Areas of 100-year flood, base flood elevations and flood hazard factors not determined.
- AD** Areas of 100-year ordinary flooding, flood depth 1 to 2 feet, product of flood depth (feet) and velocity (feet per second) less than 15.
- AH** Areas of 100-year ordinary flooding where depths are between one (1) and three (3) feet, water-logged elevations are shown, but no flood hazard factors are determined.
- A1, A2, A3** Areas of 100-year flood, base flood elevations and flood hazard factors determined.
- A19** Areas of 100-year flood to be protected by a flood protection system under construction that flood elevations and flood hazard factors not determined.
- B** Areas between limits of 100-year flood and 500-year flood, areas of 100-year shallow flooding where depths less than 1 foot.
- C** Areas outside 500-year flood.
- D** Areas of undetermined, but possible, flood hazards.
- V** Areas of 100-year coastal flood with velocity (wave action), base flood elevations and flood hazard factors not determined.
- V1, V2** Areas of 100-year coastal flood with velocity (wave action), base flood elevations and flood hazard factors determined.

NOTES TO USER

Certain areas not in the Special Flood Hazard areas (zones A and V) may be protected by flood control structures.

This map is for flood insurance purposes only, and not necessarily show all areas subject to flooding in the community or all flood insurance hazards. It does not show special flood hazard areas. Refer to the FLOOD INSURANCE RATE MAP EFFECTIVE date shown on this map to determine when actual rates apply to structures in the zones where elevations or depths have been established. To determine if flood insurance is available in his community, contact your insurance agent, or call the National Flood Insurance Program, at (800) 638-6820.

INITIAL IDENTIFICATION: SEPTEMBER 22, 1974.
FLOOD HAZARD BOUNDARY MAP REVISIONS: SEPTEMBER 17, 1974
FLOOD INSURANCE RATE MAP EFFECTIVE: DECEMBER 4, 1985
FLOOD INSURANCE RATE MAP REVISIONS:



federal emergency management agency

FIRM

FLOOD INSURANCE RATE MAP 01-17
MAP INDEX

TOWN OF LOWELL, VT
ORLEANS COUNTY

COMMUNITY NUMBER 500254 B

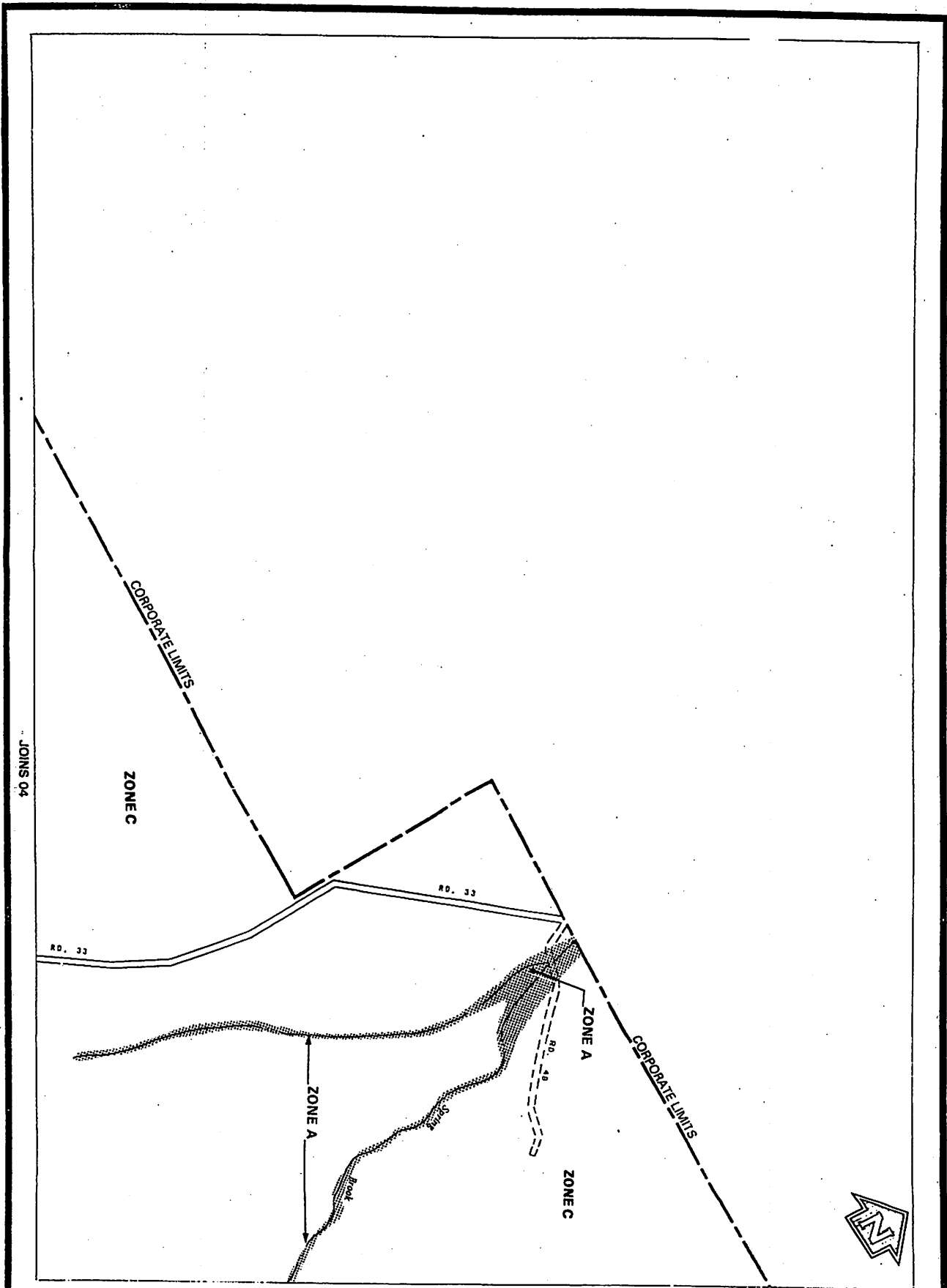

01

federal emergency management agency

TOWN OF LOWELL, VT
ORLEANS COUNTY

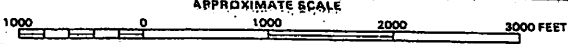

FLOOD INSURANCE RATE MAP
COMMUNITY NUMBER 500254

EFFECTIVE DATE
DECEMBER 4, 1985

JOINS 01

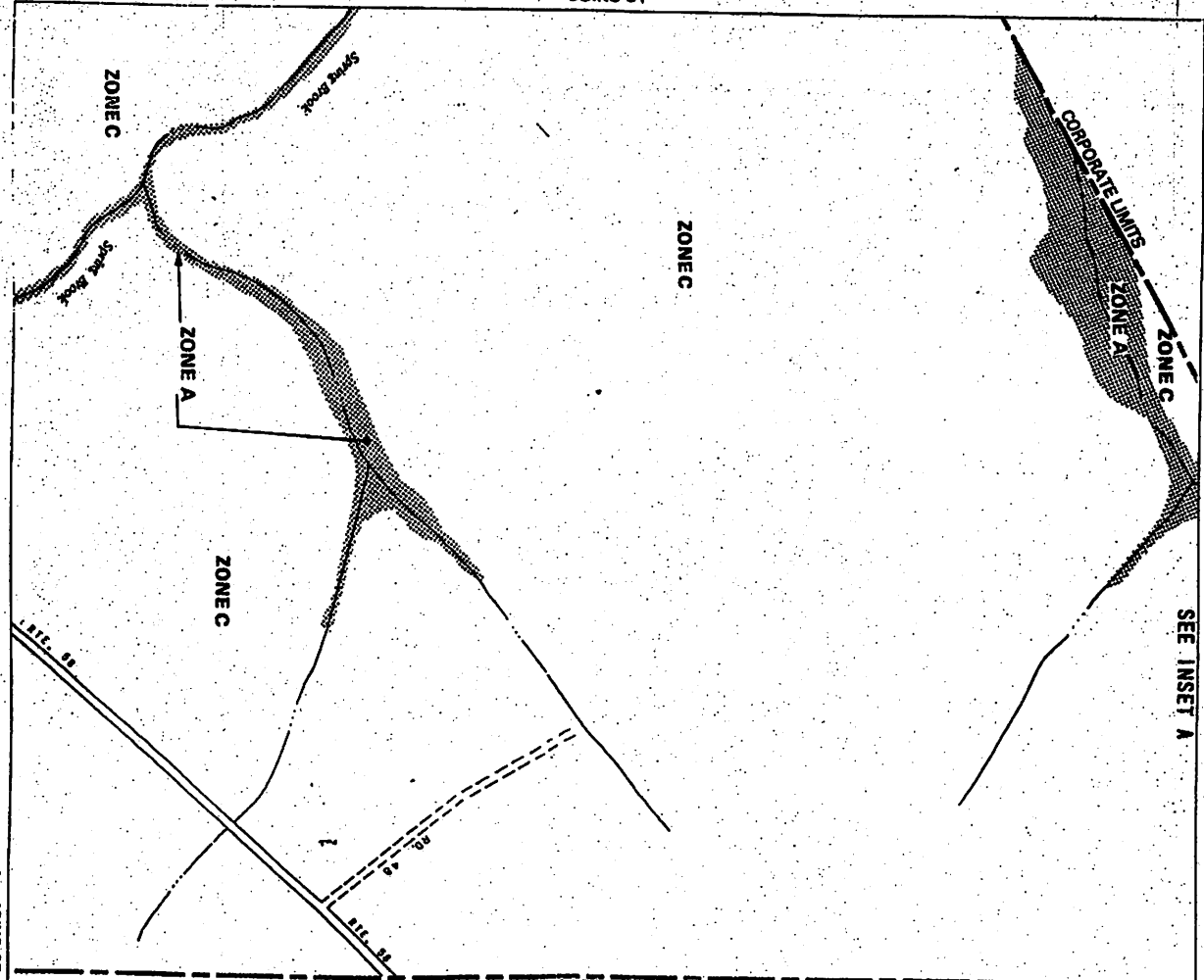

JOINS 06

CORPORATE LIMITS

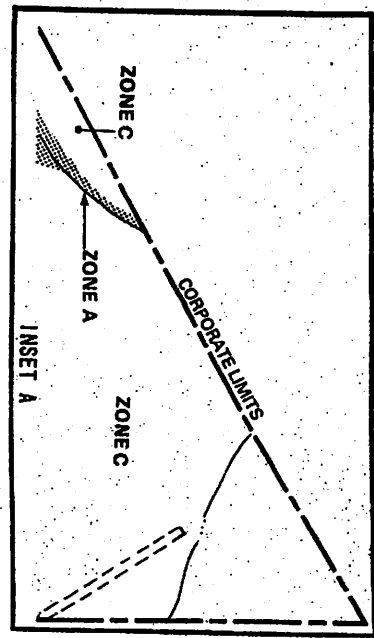

federal emergency management agency

TOWN OF LOWELL, VT
ORLEANS COUNTY

APPROXIMATE SCALE

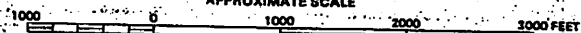

FLOOD INSURANCE RATE MAP
COMMUNITY NUMBER 500264

EFFECTIVE DATE

DECEMBER 1, 1985

02

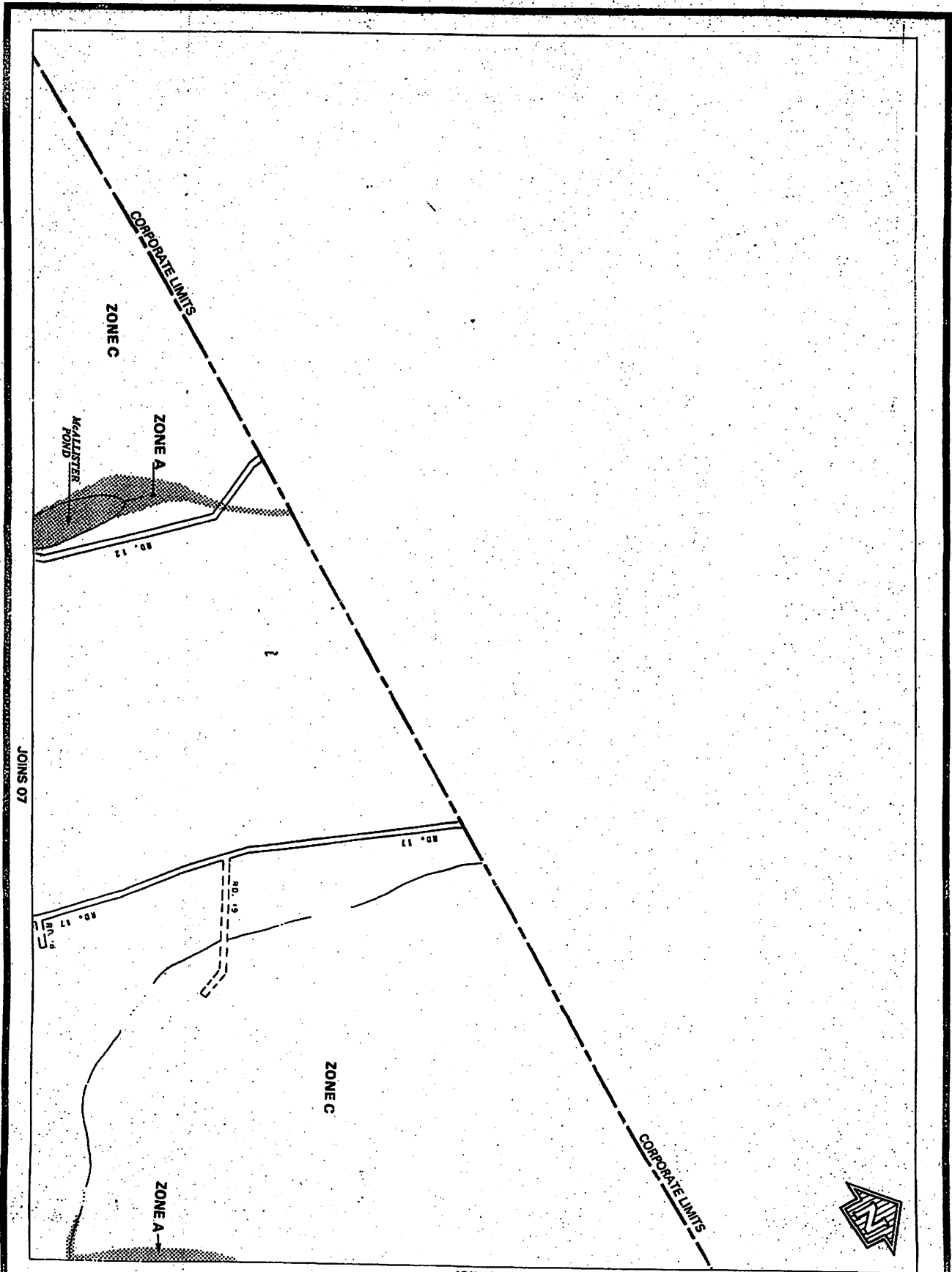

03

federal emergency management agency

TOWN OF LOWELL, VT
ORLEANS COUNTY

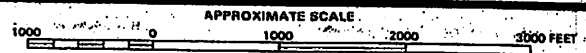

FLOOD INSURANCE RATE MAP
COMMUNITY NUMBER 600264

EFFECTIVE DATE
DECEMBER 1, 1992

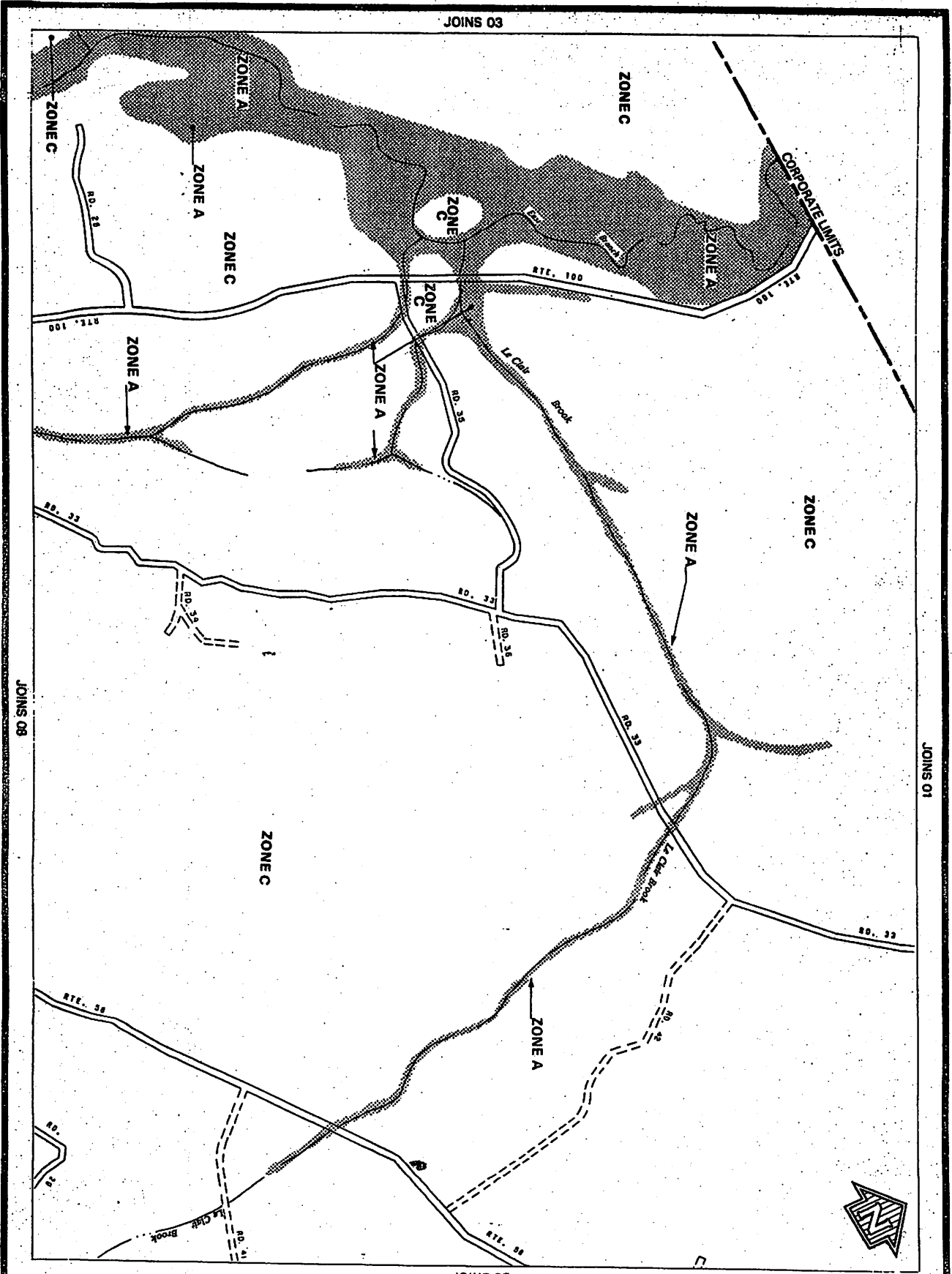

JOINS 08

JOINS 01

04

federal emergency management agency

TOWN OF LOWELL, VT
ORLEANS COUNTY



FLOOD INSURANCE RATE MAP
COMMUNITY NUMBER 500264

EFFECTIVE DATE
DECEMBER 1, 1984

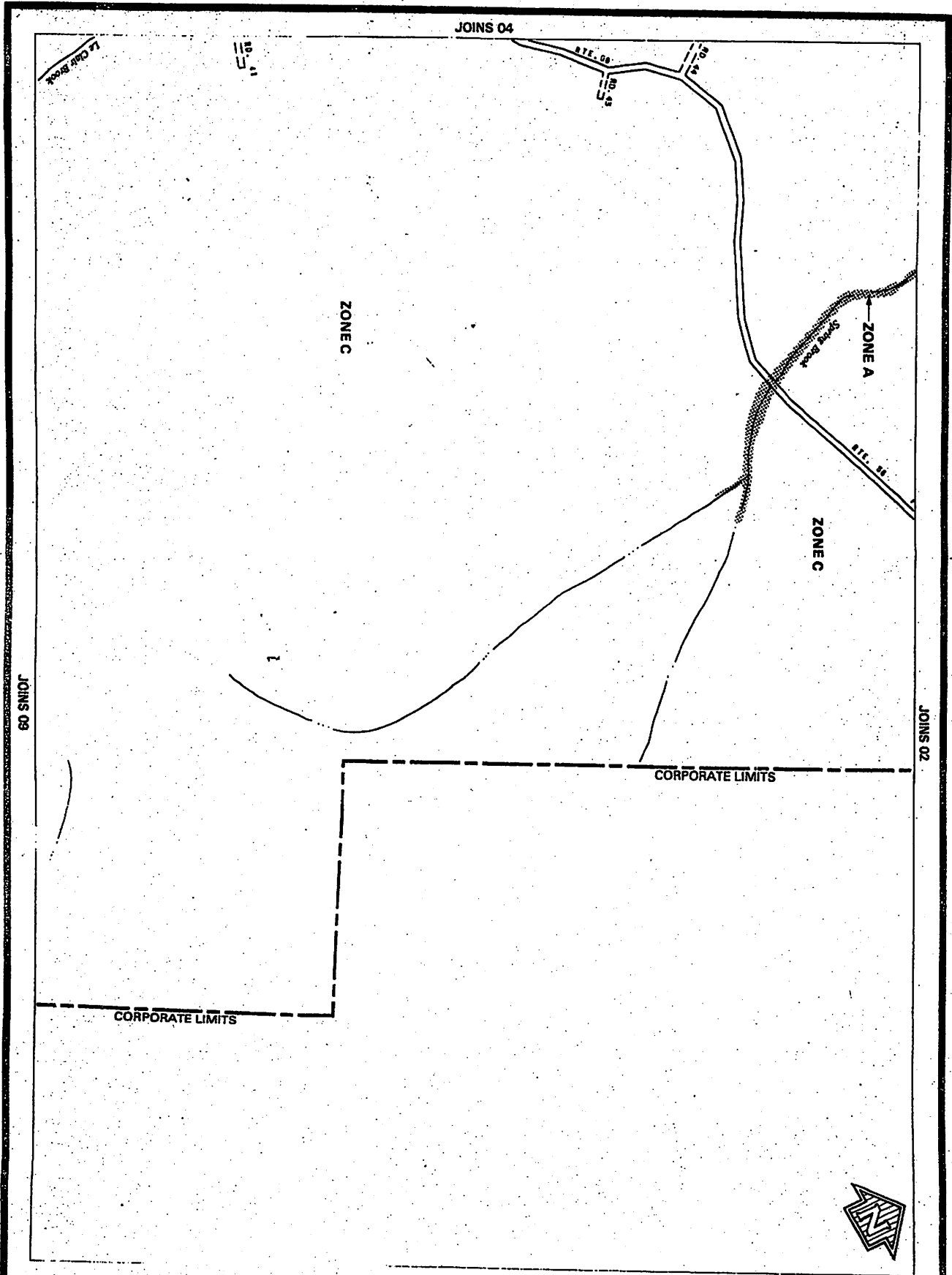

05

federal emergency management agency
TOWN OF LOWELL, VT
 ORLEANS COUNTY

APPROXIMATE SCALE
 1000 0 1000 2000 3000 FEET

FLOOD INSURANCE RATE MAP
 COMMUNITY NUMBER 500264

EFFECTIVE DATE
 DECEMBER 4, 1995

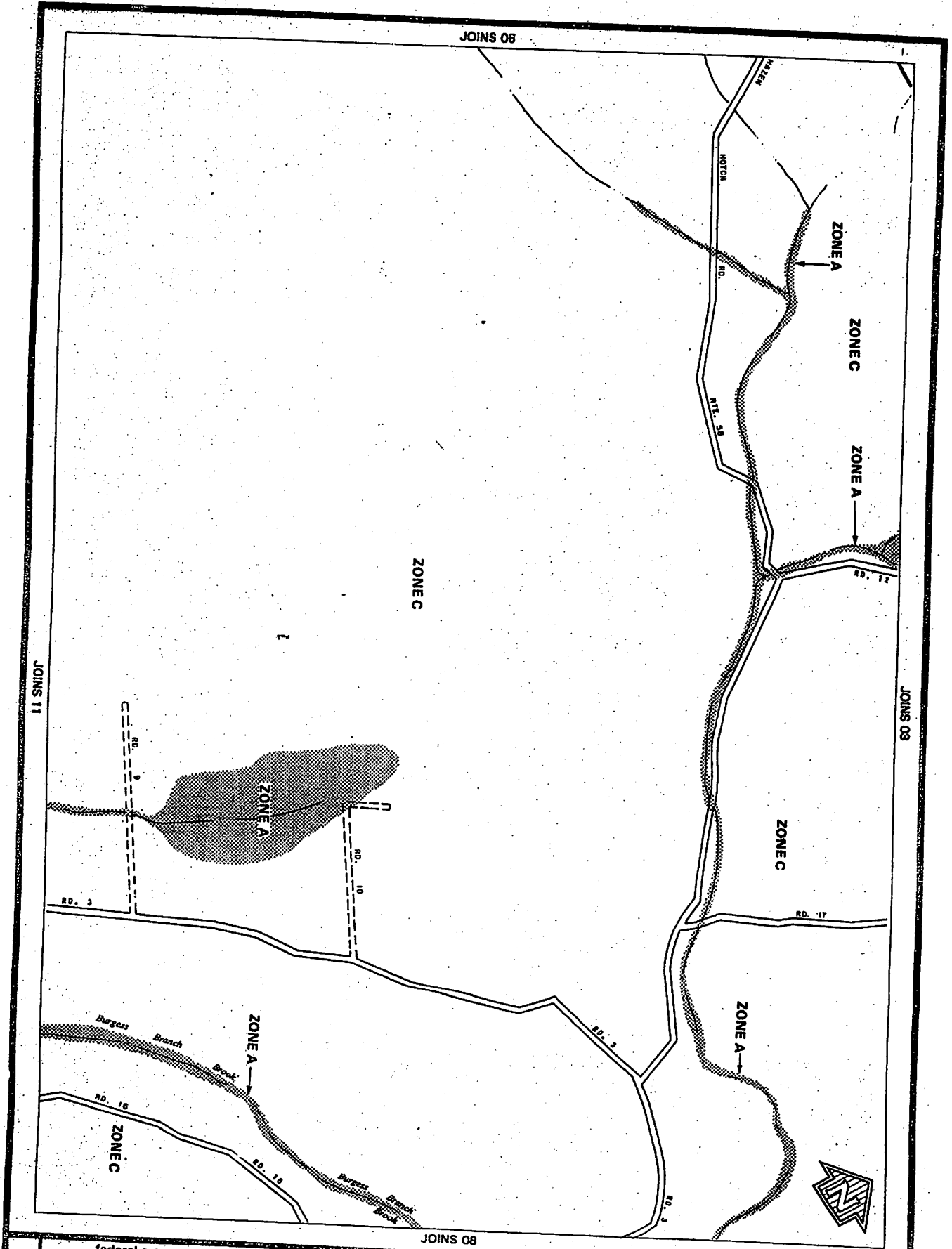

07
 federal emergency management agency
TOWN OF LOWELL, VT
 ORLEANS COUNTY

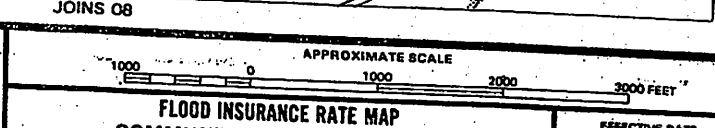

FLOOD INSURANCE RATE MAP
 COMMUNITY NUMBER 500254

EFFECTIVE DATE
DECEMBER 4, 1988

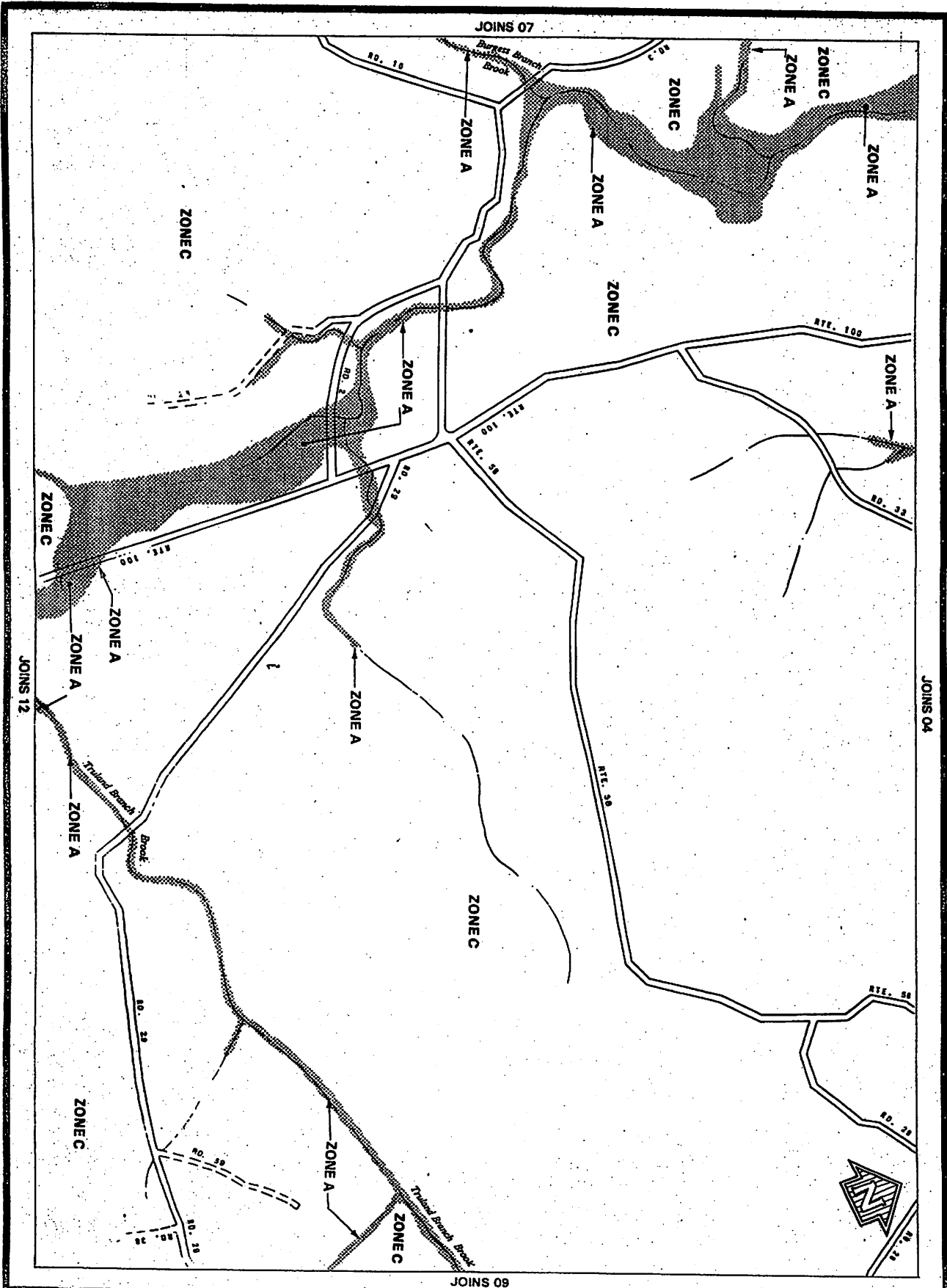

06 federal emergency management agency
TOWN OF LOWELL, VT
 ORLEANS COUNTY

APPROXIMATE SCALE
 1000 0 1000 2000 3000 FEET

FLOOD INSURANCE RATE MAP
 COMMUNITY NUMBER 500254

EFFECTIVE DATE
DECEMBER 4, 1985

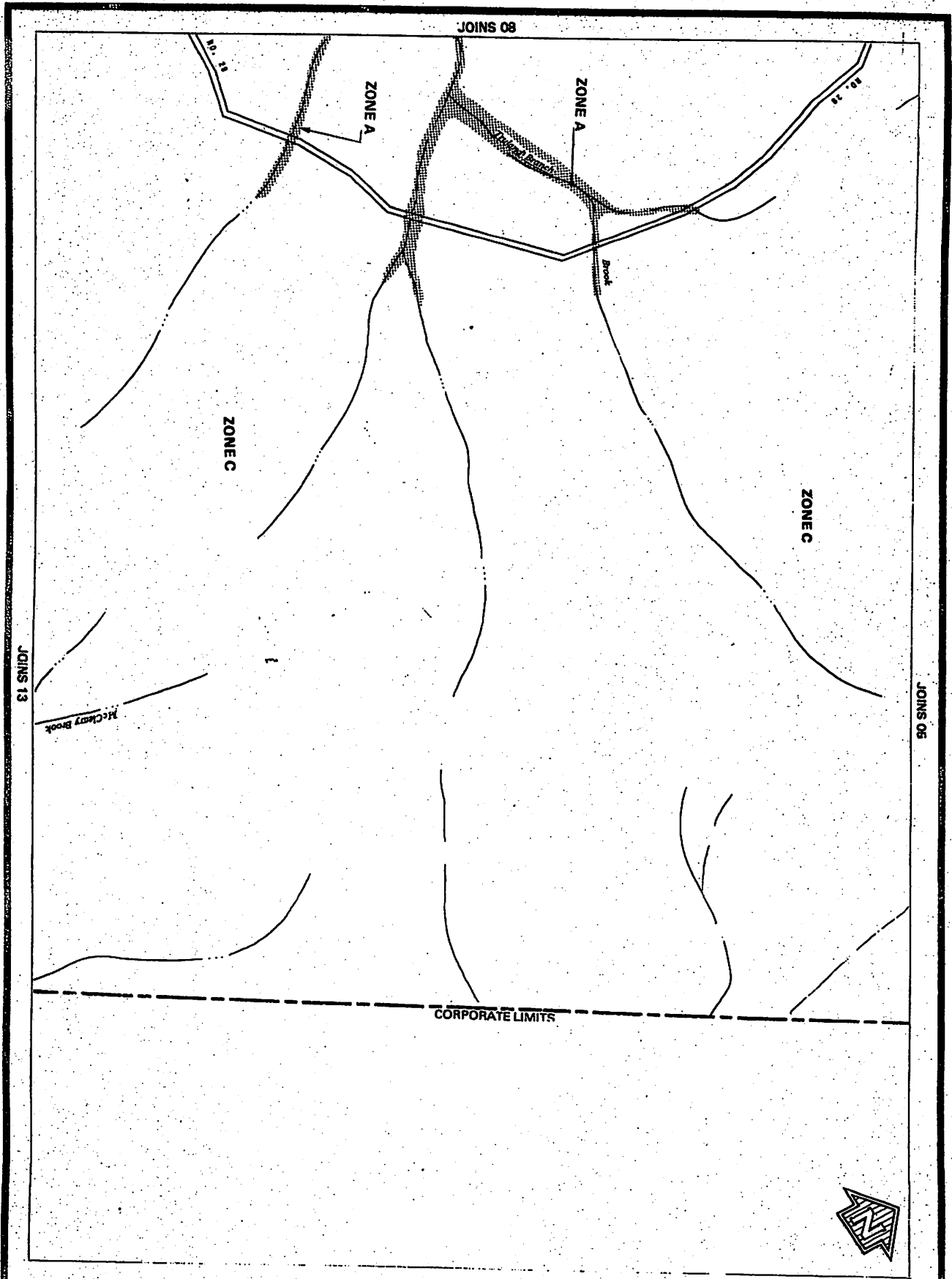

09
 federal emergency management agency
TOWN OF LOWELL, VT
 ORLEANS COUNTY

APPROXIMATE SCALE
 1000 0 1000 2000 3000 FEET
FLOOD INSURANCE RATE MAP
 COMMUNITY NUMBER 800264

EFFECTIVE DATE
DECEMBER 4, 1985

JOINS 10

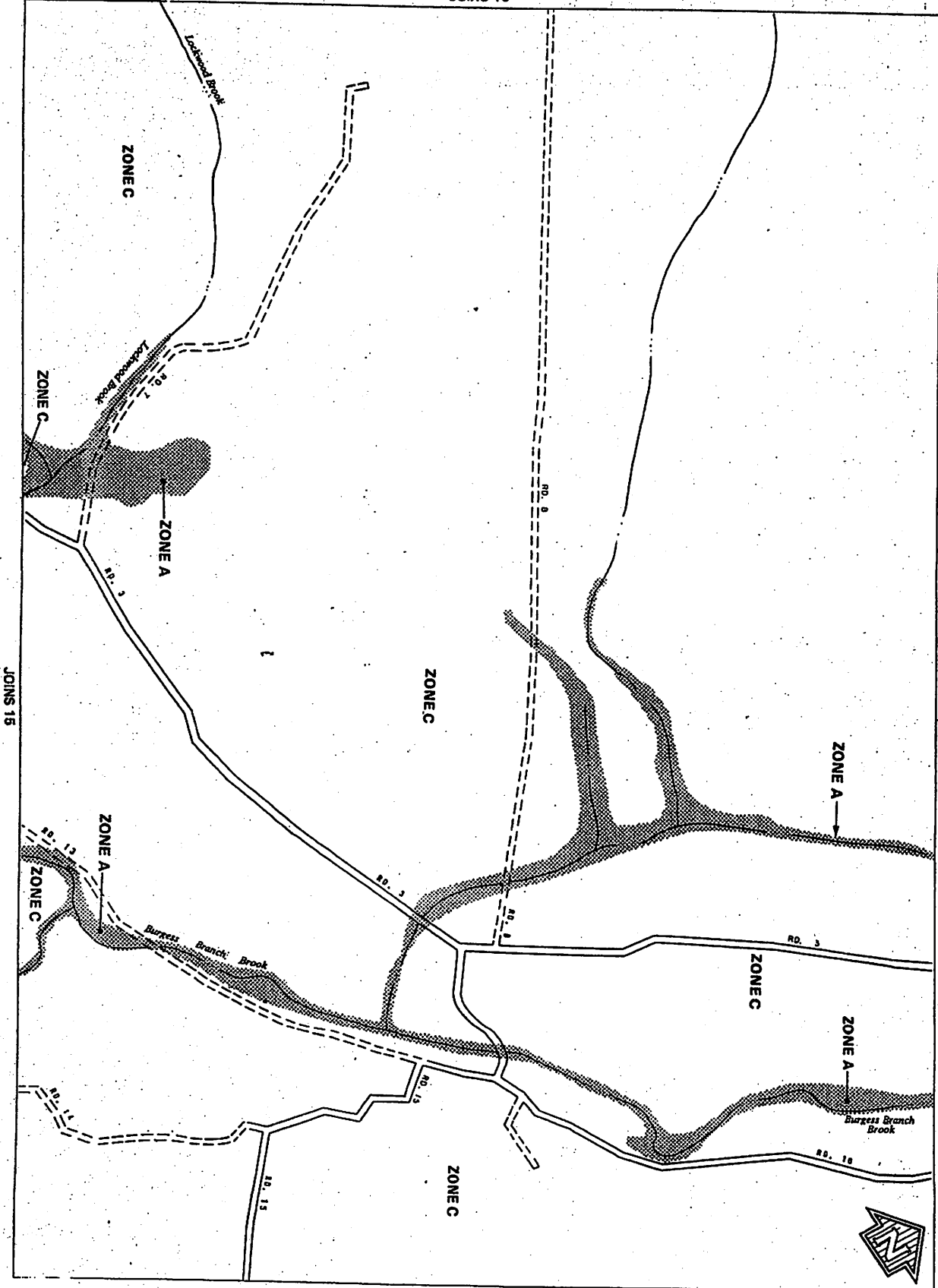

JOINS 15

JOINS 07

JOINS 12

11

federal emergency management agency

TOWN OF LOWELL, VT
ORLEANS COUNTY

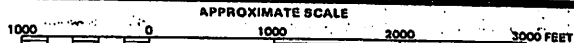

FLOOD INSURANCE RATE MAP
COMMUNITY NUMBER 500254

EFFECTIVE DATE
DECEMBER 4, 1984

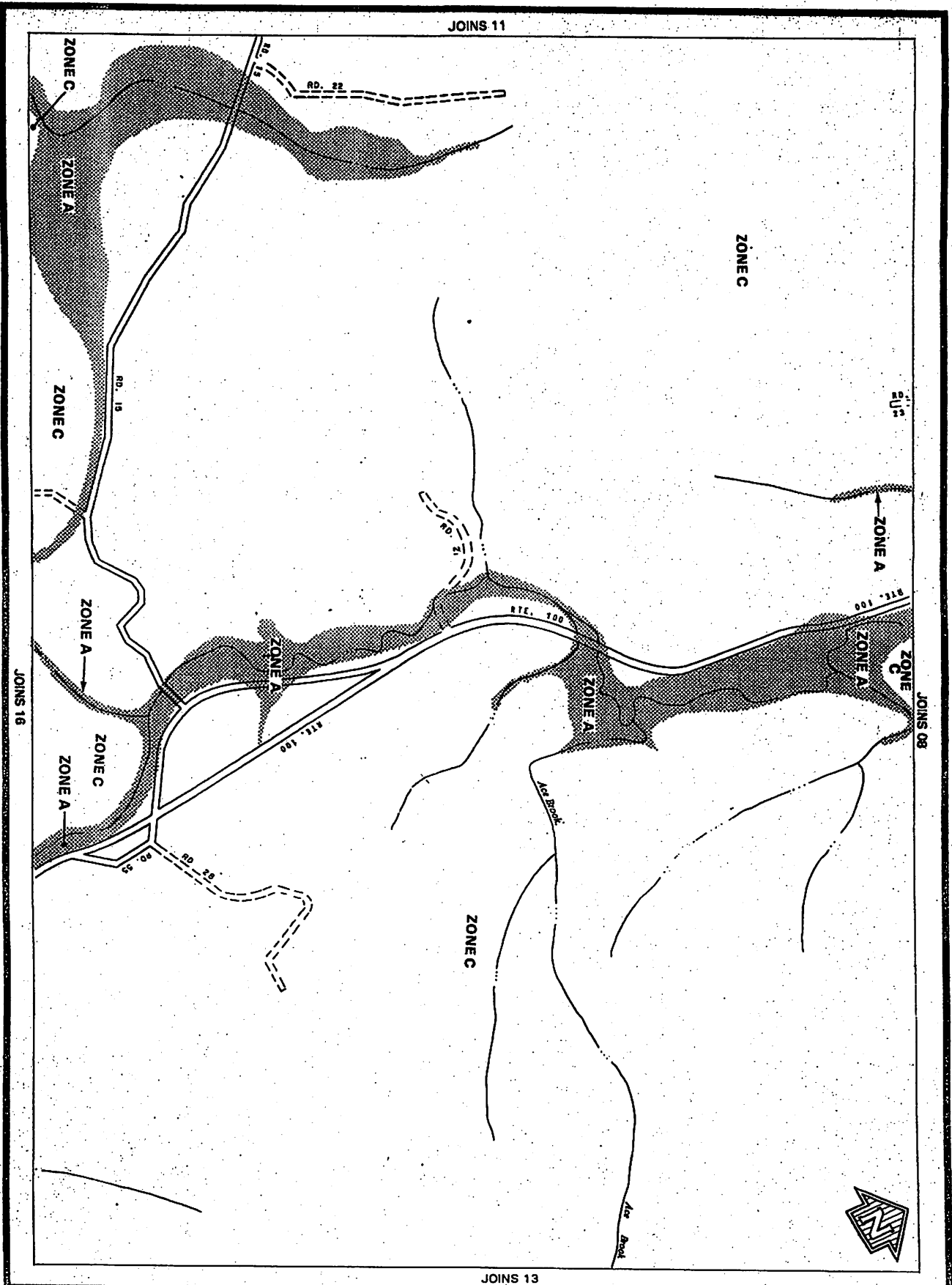

12

federal emergency management agency

TOWN OF LOWELL, VT
ORLEANS COUNTY

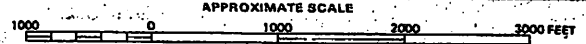

FLOOD INSURANCE RATE MAP
COMMUNITY NUMBER 500254

EFFECTIVE DATE
DECEMBER 4, 1983

JOINS 12

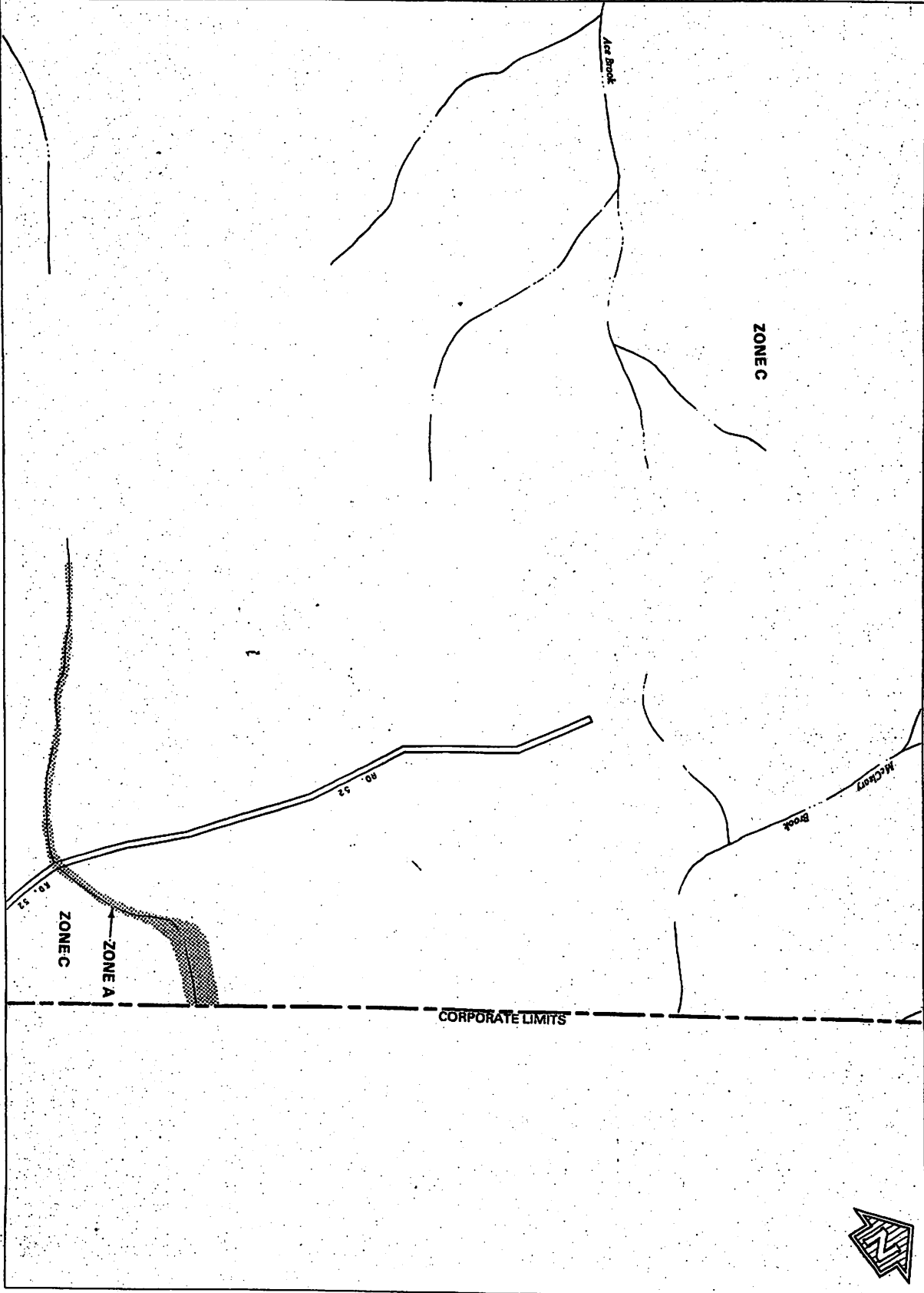

JOINS 17

JOINS 13

13

federal emergency management agency

TOWN OF LOWELL, VT
ORLEANS COUNTY



FLOOD INSURANCE RATE MAP
COMMUNITY NUMBER 500254

EFFECTIVE DATE
DECEMBER 6, 1998

JOINS 14

CORPORATE LIMITS

ZONE C

ZONE A

ZONE A

ZONE C

ZONE A

ZONE C

ZONE C

ZONE A

JOINS 11

JOINS 16

federal emergency management agency
TOWN OF LOWELL, VT
ORLEANS COUNTY

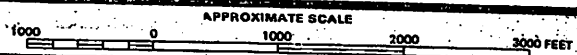

FLOOD INSURANCE RATE MAP
COMMUNITY NUMBER 500254

EFFECTIVE DATE:
DECEMBER 4, 1998

15

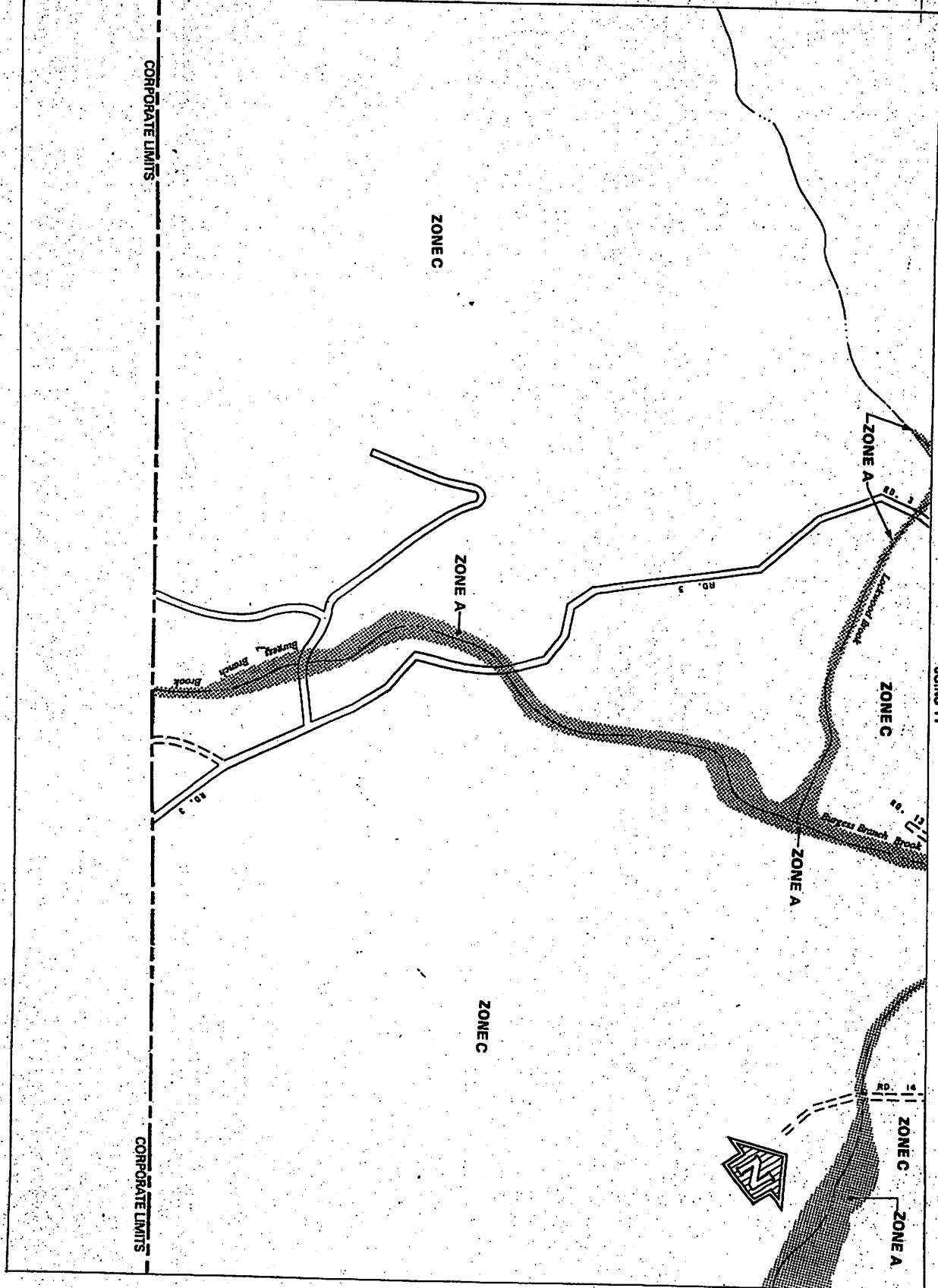

JOINS 15

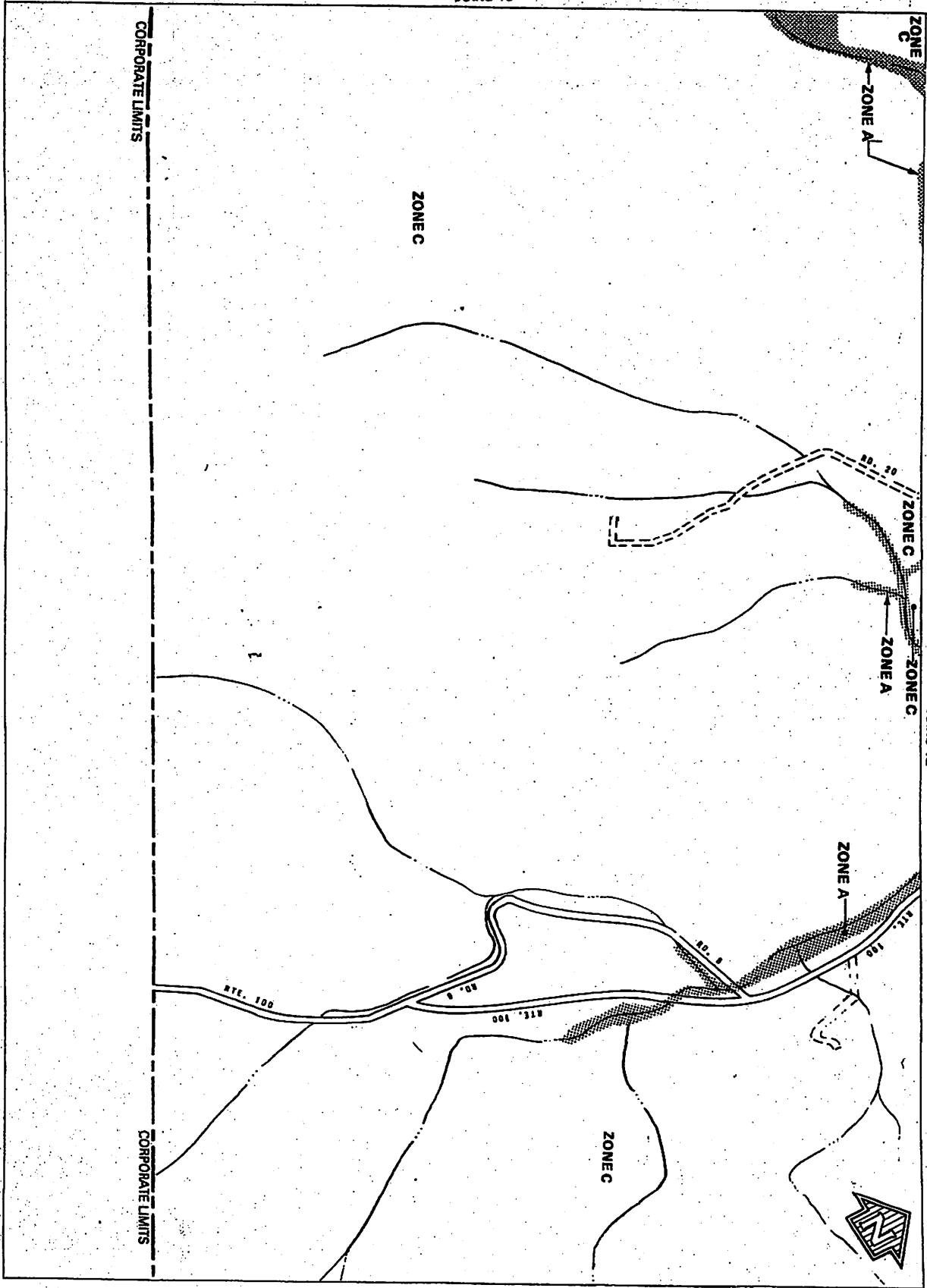

ZONE C

ZONE A

ZONE C

ZONE C

ZONE A

ZONE C

JOINS 12

ZONE A

ZONE C

JOINS 17

federal emergency management agency

TOWN OF LOWELL, VT
ORLEANS COUNTY

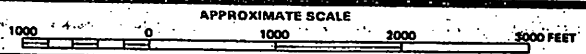

FLOOD INSURANCE RATE MAP
COMMUNITY NUMBER 500254

EFFECTIVE DATE
DECEMBER 4, 1988

JOINS 16

JOINS 13

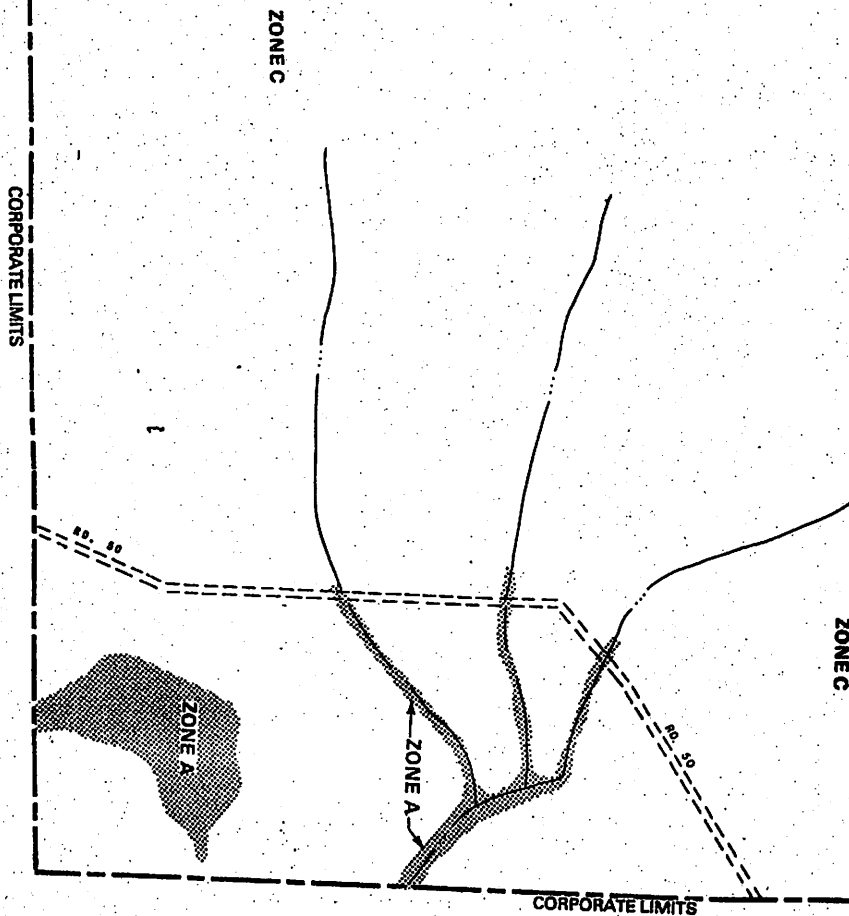

federal emergency management agency

TOWN OF LOWELL, VT
ORLEANS COUNTY

APPROXIMATE SCALE



FLOOD INSURANCE RATE MAP
COMMUNITY NUMBER 500254

EFFECTIVE DATE

DECEMBER 4, 1984