

Drawing on my
 experience



This drawing has been produced for the specific client and project identified below and is not intended for use by any other person or purpose. To scale site representation.

Easting 398247
 Northing 281767

Do not scale from this drawing

Key

	Traffic light head		Pedestrian Crossing
	Works Area		Min 750 mm road sign aspect
	Cones		No waiting cones

Date	20-20-20	Survey by	EG
Drawn by	CR	Checked by	JT
Draw No	007	Phase No	1
Page No	1		
Project Name			

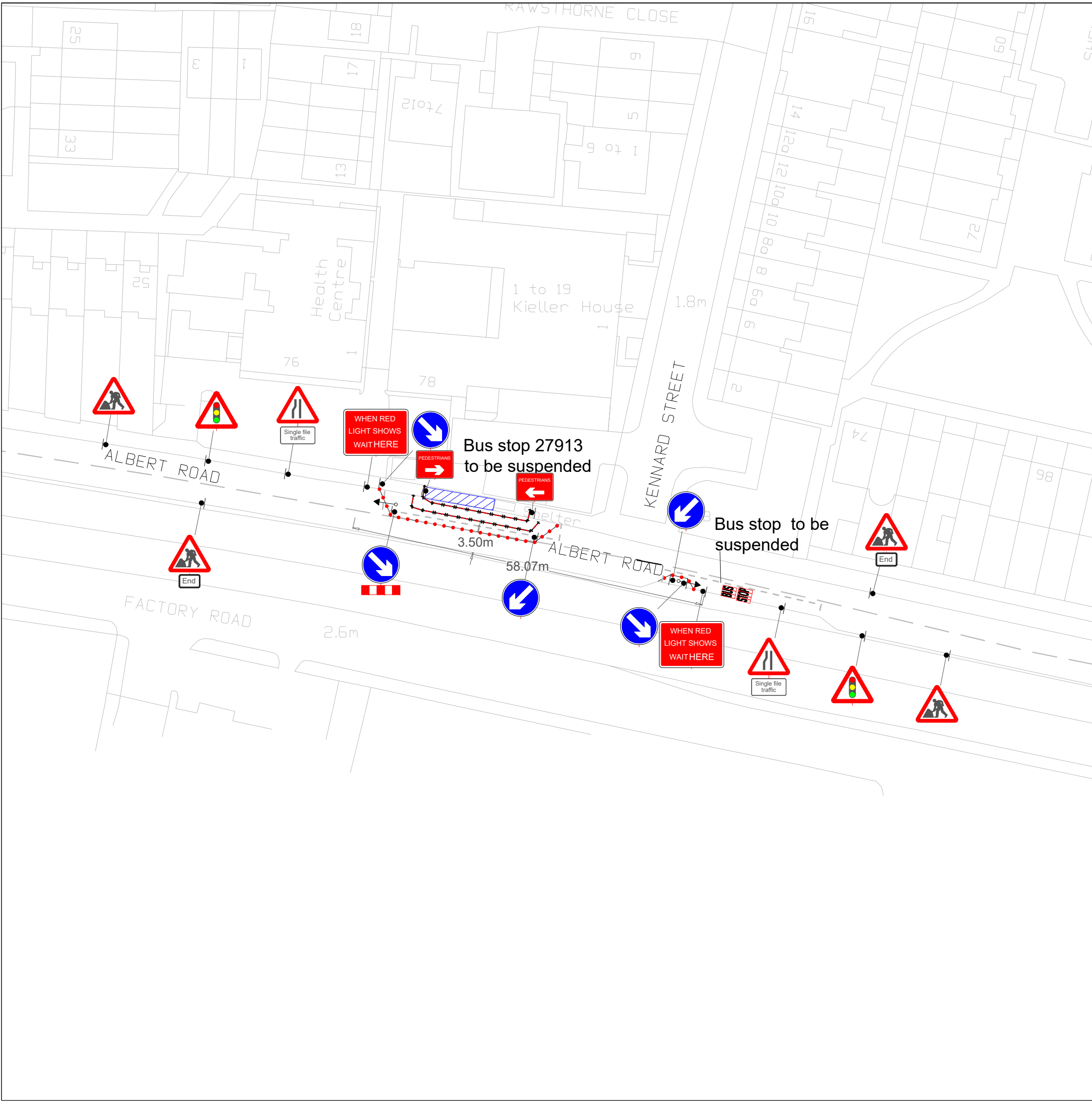

QTY: 2 REF: 7011 When Red Light Shows Wait Here	
QTY: 2 REF: 518 Single file traffic	
QTY: 2 REF: 517 Road narrows on one side only ahead	
QTY: 2 REF: 543 Traffic signals ahead	
QTY: 4 REF: 7001 Road works ahead	
QTY: 3 REF: 610 Keep right	
QTY: 1 REF: 7018 Pedestrian diversion sign-Left	
QTY: 1 REF: 7018 Pedestrian diversion sign-Right	
QTY: 2 REF: 645 End plate	
QTY: 2 REF: 610 Keep left	
QTY: 1 REF: 7105 Lane closure barrier	