

8,000 sq.ft. For Lease

12625 Universal Dr, Taylor, MI 48180



Listing ID: 30458719
 Status: Active
 Property Type: Industrial For Lease
 Industrial Type: Flex Space, Manufacturing
 Contiguous Space: 8,000 SF
 Total Available: 8,000 SF
 Lease Rate: \$6.25 - 6.50 PSF (Annual)
 Base Monthly Rent: \$4,166 - 4,333
 Lease Type: Modified Gross
 Ceiling: 16 - 18 ft.
 Office SF: 1,100 SF
 Drive-In Bays: 2 Bays



Overview/Comments

8,000 sq.ft. of light industrial for lease in Metro- Telegraph Industrial Park.
 1100 sq.ft. of office with mezzanine for storage.
 Two grade level overhead doors and T8 instant on lighting. Call REA Construction at 734-946-8730 for a tour.

More Information Online

<http://www.catylist.com/listing/30458719>

QR Code

Scan this image with your mobile device:



General Information

Tax ID/APN:	263960770	Gross Building Area:	36,000 SF
Industrial Type:	Flex Space, Manufacturing, Light Industrial	Building/Unit Size (RSF):	8,000 SF
Zoning:	LIGHT INDUSTRIAL	Usable Size (USF):	8,000 SF
Building Name:	Universal Trade Center 1	Land Area:	2.61 Acres

Available Space

Suite/Unit Number:	12625-12629	Offices:	3
Space Available:	8,000 SF	Office SF:	1,100 SF
Minimum Divisible:	8,000 SF	Parking Spaces:	16
Maximum Contiguous:	8,000 SF	Loading Docks:	0
Space Type:	Relet	Loading Doors:	0
Date Available:	07/15/2019	Drive In Bays:	2
Lease Rate:	\$6.25 - 6.50 PSF (Annual)	Ceiling Height:	18
Lease Type:	Modified Gross	Clear Height:	16
Rent Escalators:	Fixed Lease		

Area & Location

Property Located Between: Telegraph and Beech Daly
 Highway Access: I94
 Airports: Detroit Metropolitan

Building Related

Tenancy:	Multiple Tenants	Parking Ratio:	1.4 (per 1000 SF)
Total Number of Buildings:	2	Parking Type:	Surface
Number of Stories:	1	Total Parking Spaces:	16
Office Space SF:	1,100 SF	Column Spacing:	50
Property Condition:	Excellent	Passenger Elevators:	0
Year Built:	1986	Freight Elevators:	0
Year Renovated:	2014	Amps:	200
Roof Type:	Flat	Volts:	208
Construction/Siding:	Block	X-Phase:	3

Heat Type: Natural Gas
 Lighting: Other
 Internet Access: Cable

Land Related

Zoning Description: Light Industrial
 Water Service: Municipal
 Sewer Type: Municipal
 Legal Description: 60-056-02-0009-302 Parcel #

Location

Address: 12625 Universal Dr, Taylor, MI 48180
 County: Wayne
 MSA: Detroit-Warren-Dearborn
 Submarket: Airport District



Property Images

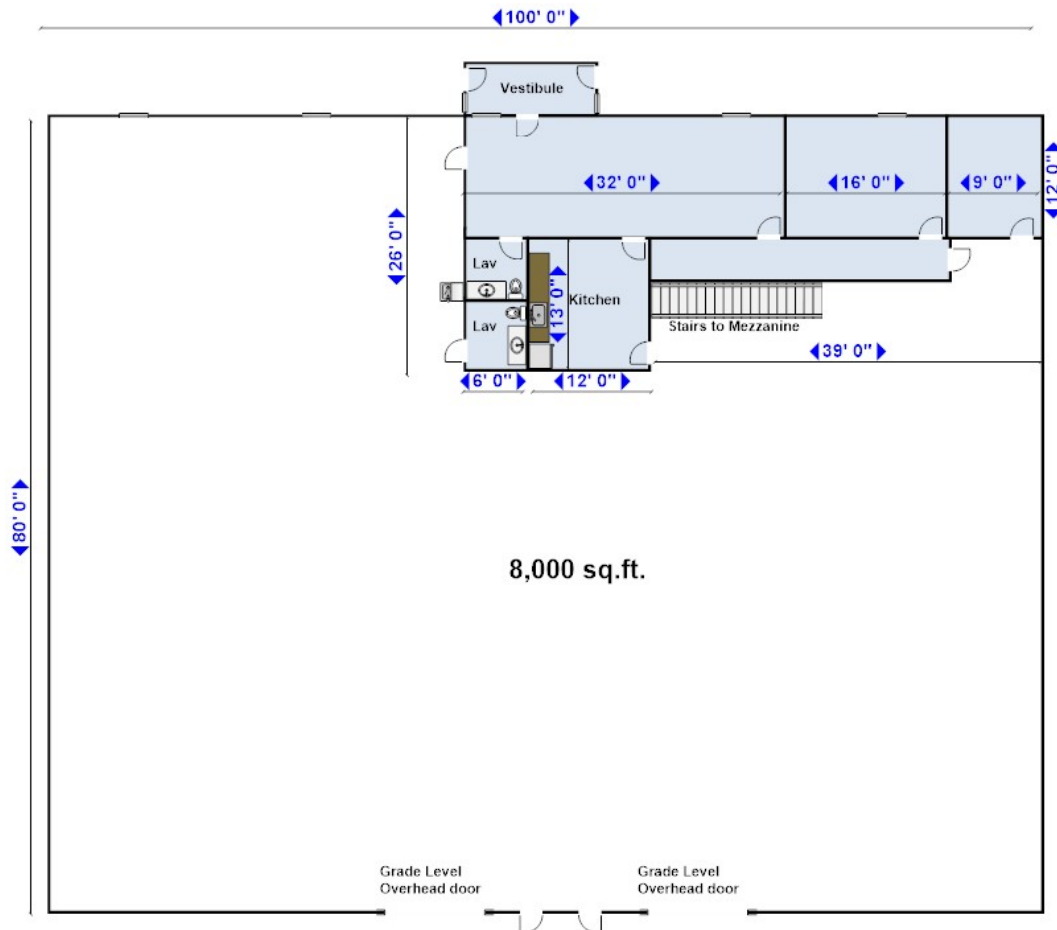

12625 - 12629
 Universal



12525-12629 1



12525-12629 4

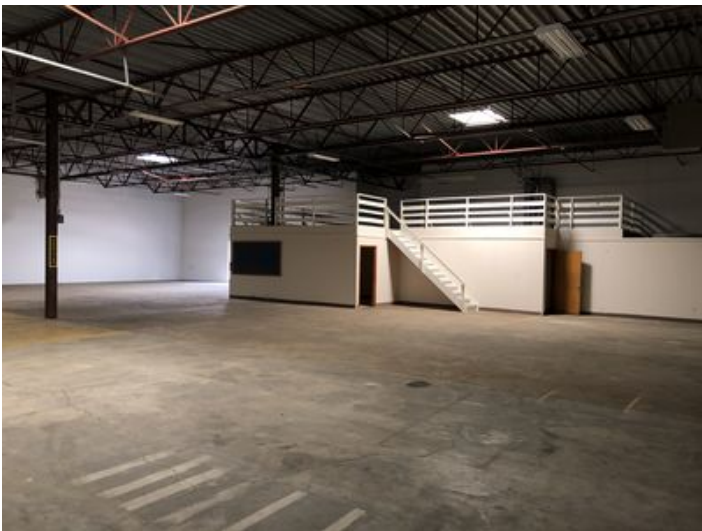

12525-12629 2



12525-12629 5



12525-12629 3



12525-12629

Property Contacts



Yvon Rea

Rea Construction

734-946-8730 [0]

darren@reaconstruction.net