

RYERSON REALTY LLC

2761 Country Lane Circle
Eagle Grove, IA 50533-0877

Phone 515-448-3079

Fax 515-448-5028

ryerson@goldfieldaccess.net

www.ryersonauctionrealtyltd.com



Deborah D Vance, Broker | Michael Ryerson, Sales | Todd Swalin, Sales

515-689-3715

515-689-3728

515-689-8987

Property Location: 222 S Lucas Ave
Legal Description: Lot 7 Block 13 Orig Town
Price: \$155,000
Approximate Age: 1997
Style: 1 Story Ranch

Bedrooms: 3 up / 3 egress window down
Siding: Vinyl
Roof Age: Approx 12 Years
Lot Size: 50' X 140'
House Sq. Ft: 1,288
Garage: 2 Car Attached/2021 Insulated Door

Living Room Flooring:
Bathroom: 1 & 1/2 Up
Basement: Full
Furnace: Forced Air
Central Air: Yes
Deck: Yes
Terms of Sale/Possession: Cash/Upon Final Settlement

Kitchen Details:
Cabinets: Oak
Frig: No
Stove: No - Electric
Dishwasher: Yes
Garbage Disposal: Yes
Dining Space: Yes
Flooring: Vinyl Plank 2022

Dining Room: Yes
Laundry Location: Basement
Washer/Dryer: No - Electric
Water Heater: 2021 Electric
Elec. Panel: 2021 Breakers
Net Taxes: No Determined Yet

Carpet & Appliance Allowance 10,000.00

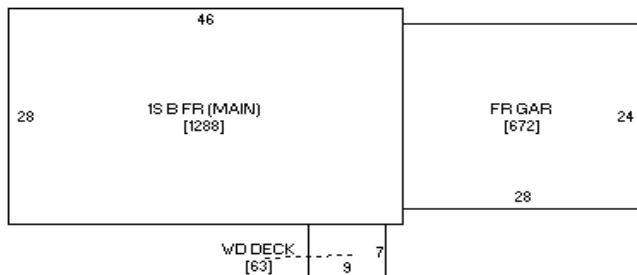

The following information, although believed to be accurate, is not guaranteed to be so. Buyer should do his own inspections. We assume no liability. The measurements are estimates only. This info is subject to change without notice. The seller does not warrant appliances past day of listing. The greatest compliment we can receive is a personal referral, please tell your friends about us.