

# Drive System

---



Part Name: Front Differential Housing  
Part No.: HLP-220001  
Remark: 4X4, CLX



Part Name: Transfer Case  
Part No.: HLP-220002



Part Name: Seal for front half shaft  
Part No.: HLP-220104  
Spec: 38\*24\*7/11.5



Part Name: Front Left Half Shaft  
Part No.: HLP-220005L



Part Name: Steel Wire Retainer for Front Left Half  
Shaft  
Part No.: 10+1+22+00201  
Remark: For Front Left Half Shaft

Part Name: Front Right Half Shaft  
Part No.: HLP-220005R



Part Name: Steel Wire Retainer for Front Right Half Shaft

Part No.: 10+1+22+00301

Remark: For Front Right Half Shaft



Part Name: Front Short Shaft

Part No.: 03.01.041802

Remark: CLX



Part Name: Rear Differential Drive Housing

Part No.: 10+1+22+00400 ( 19teeth ) 09

Part No.:10+1+22+00400A ( 24teeth ) 08

Remark: 4X4, CLX



Part Name: Rear half shaft seal

Part No.: Seal35x62x12





Part Name: Seal for drive shaft  
Part No.: Seal60x80x8

\



Part Name: Speed Sensor  
Part No.: 10+1+22+00400S  
Remark: Mounts on the Rear differential



Part Name: Steel Wire Retainer for Drive  
Shaft  
Part No.: 10+1+22+00404  
Remark: For Drive Shaft



Part Name: Rear Left Half Shaft  
Part No.: HLP-220007L



Part Name: Rear Right Half Shaft  
Part No.: HLP-220007R



Part Name: Steel Wire Retainer for Rear Half Shaft

Part No.: 10+1+22+00501

Remark: For Rear Half Shaft



Part Name: Drive Shaft Assembly

Part No.: HLP-220008

Remark: 4X4, CLX



Part Name: Center Support Bearing

Part No.: HLP-220009

Remark: Bearing in the middle of the drive shaft

Center Support Bracket Part No: HLP-220009B

Bearing Part No: 6205



Part Name: Boot seal for front end of the drive shaft

Part No.: HLP-BT-2075

Spec: BT-2075 (does not include clamps)



Part Name: Boot seal for rear end of the drive shaft

Part No.: HLP-BT-2069

Spec: BT-2069 (does not include clamps)



Part Name: Half shaft inner boot seal

Part No.: HLP-BT-23

Spec: BT-23 (does not include clamps)

Remark: Front half shaft inner large clamp  
HLP-220005-0720

Front half shaft inner small clamp HLP-220005-0290

Rear half shaft inner large clamp HLP-22005-0720

Rear half shaft inner small clamp HLP-220005-0265



Part Name: Half shaft outer boot seal

Part No.: HLP-BT-2047

Spec: BT-2047 (does not include clamps)

Remark: Front half shaft outer large clamp  
HLP-220005-0730

Front half shaft outer small clamp HLP-220005-0265

Rear half shaft outer large clamp HLP-220005-0730

Rear half shaft outer small clamp HLP-220005-0265

# Electric System

---



Part Name: License Plate Light  
Part No.: HLP-370001  
Spec: 12V



Part Name: Horn  
Part No.: HEL2-3760210  
Spec: 12V



Part Name: Ignition Switch  
Part No.: HEL2-3440000



Part Name: Brush Socket  
Part No.: HEL2-3400061  
Remark: Assembled between Steering Wheel and Steering Column. Horn Wire is assembled on it



Part Name: Right Taillight  
Part No.: HEL2-3760200  
Spec: 12V  
Wiring Harness: HEL2-3760EC-WIR



Part Name: Right Taillight  
Part No.: HEL2-3760100  
Spec:12V  
Wiring Harness: HEL2-3760EC-WIR



Part Name: Left Headlight  
Part No.: HEL2-3755100  
Spec: 12v110w  
Head Light Blub HEL2-3755HBLUB  
Wiring Harness: HEL2-3755EC-WIR



Part Name: Right Headlight  
Part No.: HEL2-3755200  
Head Light Blub HEL2-3755HBLUB  
Wiring Harness: HEL2-3755EC-WIR



Part Name: Storage Box Lock  
Part No.: HEL2-5300210



Part Name: Micro switch for Brake Light  
Part No.: HEL2-3730600  
Remark: Assembled under Brake Pedal Assembly



Part Name: Flasher  
Part No.: HEL2-3760460  
Remark: Electric Flashing device for turning lights



Part Name: Turn Signal Switch  
Part No.: HEL2-3440010



Part Name: FUSE  
Part No.:HLP-370012  
Spec:250V400A



Part Name: EDS Button SLA42-21BNZS-Red  
Part No.: HLP-370013  
Color: red



Part Name: 4WD Button A42-12BNZS-green  
Part No.: HLP-370014  
Color: green





Part Name: Forward/Reverse Switch

Part No.: HEL2-3730700



Part Name: Rocker Switch KCD1-106

Part No.: HEL2-3730510



Part Name: Windshield Wiper Switch

Part No.: HLP-370017



Part Name: Headlight Switch

Part No.: HLP-370018



Part Name: 4WD Switch Panel

Part No.: 10+1+37+11010



Part Name: 2WD Switch Panel  
Part No.: 10+2+37+11010



Part Name: Charge Meter  
Part No.: HEL2-3760310



Part Name: Speedometer  
Part No.: 10-000-00602



Part Name: Speedometer Panel Ø85  
Part No.: 10-000-0601



Part Name: 12Volt Receptacle  
Part No.: HEL2-3760470  
Spec: 12V



Part Name: cap for Receptacle

Part No.: HEL2-3760470C



Part Name: Main Solenoid 2009

Part No.: 10+1B+37+03200

Spec:48V400A

Remark : separated excitation system



Part Name: Solenoid ZJ50A 48V

Part No.: 10+2B+37+03300

Spec:48V150A

Remark : separated excitation system



Part Name: Main Solenoid

Part No.: HLP-370023

Spec: 48V200A

Main Material:

Color: White

Remark:



Part Name: Solenoid  
Part No.: HLP-370024  
Spec: 48V150A  
Main Material:  
Color:  
Remark:



Part Name: Main Solenoid Diode  
Part No.: HEL2-3760410



Part Name: Converter 48/12V250W  
Part No.: HLP-370027  
Spec:48/12V 250W



Part Name: Converter fuse 25A  
Part No.: HLP-370034  
Spec:48/12V 250W



Part Name: Separately Excited Controller

Part No.: 1268-5502

Remark : 2009 4x4, CLX



Part Name: 4x4 Series Excitation Controller

Part No.: HLP-390028

Spec:48V650A

Remark : 2008 4x4



Part Name: Series Excitation Motor

PartNo.:HLP-370029

Specs: 24 tooth

Remarks: 2008 4x4 CLX



Part Name: Separately Excited Motor

Part No.:10+2B+37+02100

Specs: 19 Tooth

Remarks: 2009 4x4, CLX



Part Name: Fuse 20A

Part No.: HLP-370033

Spec:20A

Part Name: Protective Diode  
Part No.: HLP-370035  
Spec:20A



Part Name: Controller Heat Sink  
PartNo.:HLP-370037(Series)  
Part No.: 5+10+2B+37+03500(separated)



Part Name: Hold Down Bolt 370  
Part No.: HLP-370038



Remark : applied to 210AH battery



Part Name: Accelerator ASSY  
Part No.: HEL2-3750130 ( Series )  
Part No.: 10+2B+37+12000 ( 0-5V )



Part Name: Inductive Throttle Sensor  
Part No.: HLP-370040 ( Series )



Part Name: Micro Switch  
Part No.: HEL2-3750110  
Spec:V-16G-1C25



Part Name: inductive Plunger  
Part No.: HEL2-3750150



Part Name: Accelerator Pedal Pad  
Part No.: HEL2-2001013



Part Name: Accelerator ASSY Pad  
Part No.: HLP-370044



Part Name: Solenoid Bracket  
Part No.: HLP-370045

Part Name: Battery Bracket  
Part No.: HLP-370048



Part Name: Controller Cover  
Part No.: HLP-370056



Part Name: Relay 708-12V30A  
Part No.: HLP-370057

Remark : Assembled under the Front

Cowl, Controls the Transfer Case





# Suspension Assembly

---



Part Name: Rear Left Lower Arm

Part No.: HLP-290001L

Remark: for 4x4, CLX



Part Name: Rear Right Lower Arm

Part No.: HLP-290001R

Remark: 4x4, CLX



Part Name: Rear Left Upper Arm

Part No.: HLP-290002L

Remark: 4x4, CLX



Part Name: Rear Right Upper Arm

Part No.: HLP-290002R

Remark: 4X4, CLX



Part Name: Rear Shock Absorber

Part No.: HLP-290003

Remark: 4x4, CLX



Part Name: Front Shock Absorber  
Part No.: RTEV+0+10+1+29+00110  
Remark: 4x4, CLX



Part Name: Sway Bar  
Part No.: HLP-290004  
Remark: 4x4, CLX  
Sway Bar Joint StabLizer HLP-290004J



Part Name: Front Left Upper Arm  
Part No.:HLP-290005L  
Spec:  
Main Material:Q235  
Color: black  
Remark: 4X4, CLX



Part Name: Front Right Left Upper Arm  
Part No.: HLP-290005R



Part Name: Front Left Lower Arm  
Part No.: HLP-290006L  
Remark:4X4, CLX



Part Name: Front Right Lower Arm  
Part No.: HLP-290006R  
Remark:4X4, CLX



Part Name: Rubber Bushing

Part No.: HLP-290007

Remark: Applied to both Front and Rear Swing Arms



Part Name: Rubber Bushing Cover

Part No.: HLP-290008

Remark: Assembled on both sides of Rubber Bushing



Part Name: Ball Joint

Part No.: HLP-290009

Remark: CCVI, Assembled on between Swing Arm and Spindle



Part Name:摆臂球销挡圈 Washer

Part No.: RTEV+ 0+30+431+34

Remark: for Ball Joint

# Body

---



Part Name: Rear Sub-frame  
Part No.: HLP-290011  
Remark :for 4X4, CLX



Part Name: Front Sub-frame  
Part No.: HLP-290012  
Remark: for 4X4, CLX



Part Name: Center Floor Sheet  
Part No.: HEL2A-2101001  
Remark: 4X4, CLX



Part Name: Front Floor Sheet  
Part No.: HLP-290014  
Remark: 4X4, CLX



Part Name: Front Cowl Bracket  
Part No.: HLP-290015  
Remark: for 4X4, CLX support the front  
cowl

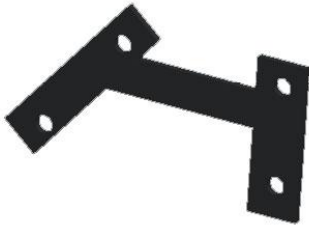

Part Name: Chassis Guard Mount Bracket

Part No.:HLP-290050

Remark: for 4X4, CLX



Part Name: Chassis Guard

Part No.:HLP-290051

Remark: 4X4, CLX



Part Name: Battery and controller holder

Part No.: HLP-370046 ( 串励 )

Part No.: 10+2B+28+00400 ( 他励 )



Part Name: Battery Sub-bracket

Part No.: HLP-370047

Remark: 4X4, CLX

# Brake System

---



Part Name: Foot Park Brake ASSY

Part No.: 10-700-13500

Remark: include the switch



Part Name: Park brake upper cover

Part No.: HLP-350003U



Part Name :Park brake lower cover

Part No.: HLP-350003L



Part Name: 2P park Brake Cable

Part No.: HLP-350004



Part Name: Spring for brake cable

Part No.: 10+1+35+00601



Part Name: Plastic ring for brake cable  
Part No.: 10+1+35+00604



Part Name: Brake Master Cylinder  
Part No.: HLP-350006



Part Name: Copper Washer  
Part No: 10+1+35+00008



Part Name: Banjo Bolt M10-1x22  
Part No.: 10+1+35+00006



Part Name: Banjo Bolt M10-1.25x24  
Part No: 10+1+35+00005

# Cover and Accessories

---

Part Name: 2p Guard Plate left side

Part No.: HLP-290016L

( stainless steel )



Part No.: HEL2-0000002L

( Chrome )

Part Name: 2p Guard Plate right side

Part No.: HLP-290016L

( stainless steel )



Part No.: HEL2-0000002L

( Chrome )

:

Part Name: Seat Back

Part No.: 10-000-51002 ( Tan )



Part Name: Seat Cushion

Part No.: 10-000-51001 ( Tan )



Part Name: Left Hip Restraint

Part No.: HEL2-71000013







Part Name: Right Hip Restraint  
Part No.: HEL2-71000012



Part Name: Front cowl  
Part No.: ARMOFC02 ( Mossy oak obsession )  
Part No.: ARMOFC01 ( Mossy oak breakup )  
Part No.: ARMOFC03 ( Mossy oak brush )



Part Name: Front Cowl Inner Part  
Part No.: HLP-290023



Part Name: Left Storage Box Door  
Part No.: HLP-5300201



Part Name: Right Storage Box Door  
Part No.: HLP-5300201



Part Name: Storage Box Door Hinge  
Part No.: HLP-290026  
Remark: Connecting Storage Box Door to  
Storage Box



Part Name: Folding Windshield  
Part No.: 1019B64 (clear)  
Part No.: 1019C64 (tinted)  
Remark: Accessory



Part Name:4\*4 Sun Top  
Part No.:2.03.250009 ( Black



Part Name:2P Sun Top Frame  
Part No.:HLP-290032



Part Name:2P Floor Mat  
Part No.:HLP-290033



Part Name: Rear Bumper  
Part No.:HEL2-0000040



Part Name: Access Panel  
Part No.: HEL2-5600004



Part Name: Upper Lock Cover  
Part No.:HEL2-3400003  
Remark: Assembled on Steering Column,  
Covering Group Switch



Part Name: Lower Lock Cover  
Part No.:HEL2-3400002  
Remark: Assembled on Steering Column,  
Covering Group Switch



Part Name: Rear Right Wheel House  
Part No.:HEL2-3102002



Part Name: Rear Left Wheel House  
Part No.: HEL2-3102001



Part Name: Motor Protective Cover  
Part No.: HLP-290039



Part Name: Rear Cowl

Part No.: ARMORC02 ( Mossy oak Obsession )

Part No.: ARMORC01 ( Mossy oak breakup )

Part No.: ARMORC03 ( Mossy oak brush )



Part Name: Seat Hinge

Part No.: HEL2-7100103

Remark: Assembled on Seat Bottom



Part Name: Seat Hinge Plate

Part No.: HEL2-0000007

Remark: Assembled on Rear Cowl



Part Name: Rear View Mirror SL-1651A

Part No.: RV MIRROR

Remark: include the mounting plate



Part Name: Front Strut for Sun Top  
Part No.: HLP-290044



Part Name: Rear Left Strut for Sun Top  
Part No.: HLP-290045L



Part Name: Rear Right Strut for Sun Top  
Part No.: HLP-29004R



Part Name: Seat Back Support (left)  
Part No.: HEG6-6800420



Part Name: Seat Back Support (Right)  
Part No.: HEG6-6800410



Part Name: Plastic rivet  
Part No.: 10+1+50+00011



Part Name: big head rivet 4.8\*18  
Part No.: 30+442+F1+4.8+18  
Remark: riveting the front cowl

# Steering System

---



Part Name: Steering Wheel  
Part No.: HEL2-3400200  
Remark: 4x4, CLX  
Steering Wheel Screw  
HEL2-3400231



Part Name: steering wheel lid  
Part No.: HEL2A-3402011



Part Name: Steering wheel nut  
Part No.: 10+1+50+00017



Part Name: Brush linker  
Part No. HEL2-3400071  
Remark: Assembled on under the Steering Wheel





Part Name: Horn Wire  
Part No.: HLP-370006



Part Name: Left Front Spindle Carrier  
Part No.: HLP-340002  
Remark: Bearing Part No: DAC30600037



Part Name: Right Front Spindle Carrier  
Part No.: HLP-340003  
Remark: Bearing Part No: DAC30600037



Part Name: Steering Box ASSY  
Part No.: HLP-340004  
Remark: 4X4, CLX



Part Name: Seal for Steering Box ASSY  
Part No.: HLP-340004BT  
Remark: 4X4, CLX



Part Name: Steering Column and Shaft

Part No.: HLP-340009

Remark: 4X4, CLX



Part Name: Knuckle/Converter Setting

Part No.: HLP-340005



Part Name: Knuckle Converter

Part No.: 10+1+34+00204

Remark: Knuckle/Converter Setting



Part Name: Seal Ø42x25x8

Part No.: HLP-340006

Remark: For Knuckle/Converter Setting



Part Name: Bearing 6004RS

Part No.: HLP-340007

Remark: Knuckle Converter Setting



Part Name: Tie Rod Assembly

Part No.: HLP-340008

Remark: for 4X4, CLX