

SLIP MOUNT SYSTEM™ DIGLESS FENCE INSTALLATION

#1 Rated professional vinyl fence installation system, using 2-3/8" pipe, Slip Mount post adjusters & Rail Locks

Safety Equipment & Tools Required:

Safety glasses, ear plugs, gloves, safety work shoes, manual or gas powered pipe driver, drill with 5/16" (#10) hex head driver bit, rubber mallet, tape measure, 4 Ft long level, string line, shovel, optional center set measuring jig.



2-3/8" x 96" PIPE SLIP MOUNTS TOP RAIL LOCK



**SAFETY 1st CALL
BEFORE YOU DIG!**

Step 1: Slide on Slip Mounts. Slide (2) Slip Mounts on pipe, place so smooth surface and the SLIPMOUNT name is facing up when installed. Use a rubber mallet to assist when doing this. Temporarily slide the upper Slip Mount down pipe 10" from top, it will be repositioned in **STEP 5**.

Step 2: Starting Point. Choose a starting point, property corner pin or ending post these pipe/posts are known as *Key Pipe*. Install the 1st pipe using a power pipe driver or manual post pounder, install the pipe to a depth of approximately 4ft below the ground, with the remaining 4 ft of pipe above.

Step 3: Set the Key Pipe. Install all *Key Pipe* they are the pipe/posts that identify corners, ends, and gate areas and will set the overall fence layout. The *Key Pipe* will become the beginning points of all fence line/run during fence installation.

Note: If installing a privacy gate kit the gate hinge side post may require an internal post insert or this pipe may be recommended to cement into ground rather than power driven in. Please refer to your gate manufactures instruction guide for information on "Gate Hinge Side Post Install"

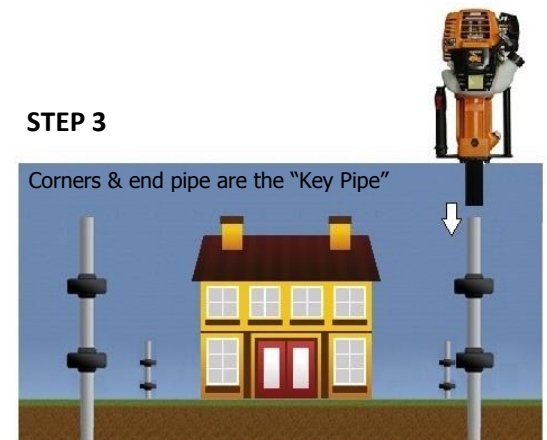
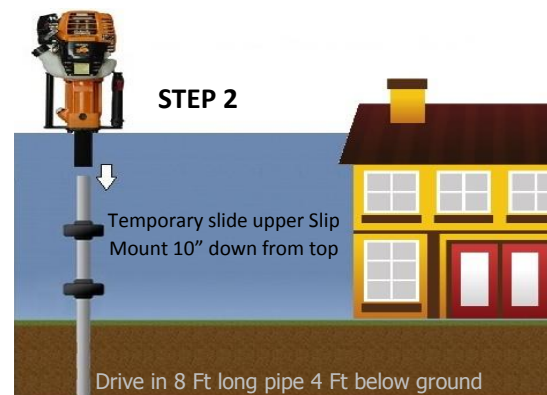

SLIP MOUNT SYSTEM™ (Continued)

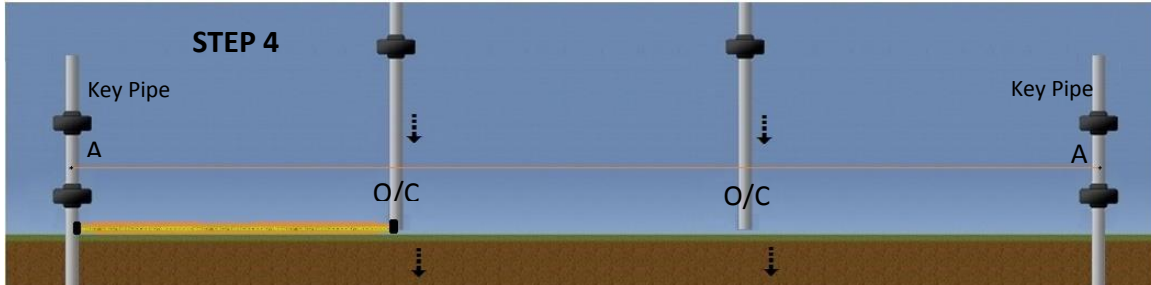

STEP 4: Run a string line 24" above ground, fasten only to the *Key Pipe* i.e. End/Corner see (A) determine the *On center (O/C)* measurements between. Use a tape measure or a *Center set Jig* to mark pipe placement. Remember not to exceed the manufactures "*On center post measurement*"

STEP 5: Adjusting height of Slip Mounts. 1st Starting at the *Key Pipes*, end/corner pipes reposition top Slip Mount to approximately 47" height, the lower Slip Mount at 12" above the ground. Using a 4 Ft long level plum and level the Slip Mounts, fasten with (2) screws.

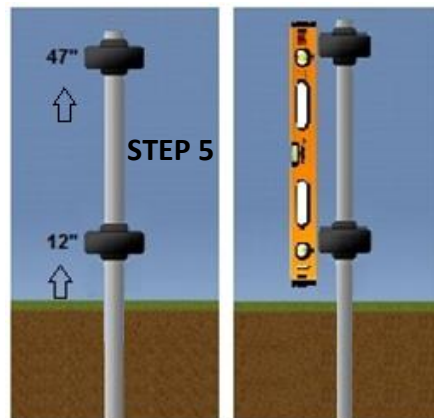

STEP 6: Screw Locations. Using (2) #10 x 1" Self-tapping screws fasten (1) screw into the upper lip of the Slip Mount and (1) opposite side at the lower lip.

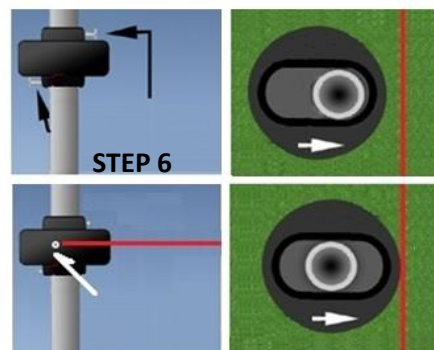

Step 7: Adjusting the in-line Slip Mounts. Relocate the string line, to the side of the upper Slip Mounts on only the *Key Pipes* end/ corners fasten using a screw to the side of Slip Mount. With all remaining in-line pipe Slip Mounts, slide the oval shape so it positions left to right, sliding towards or away from string line until string is just touching the side of the Slip Mount, repeat with the lower Slip Mounts. Re check with a level. Using (2) self-tap screws fasten each Slip Mount to pipe, once complete remove the string line and screw form side of the *Key pipe* Slip Mounts.

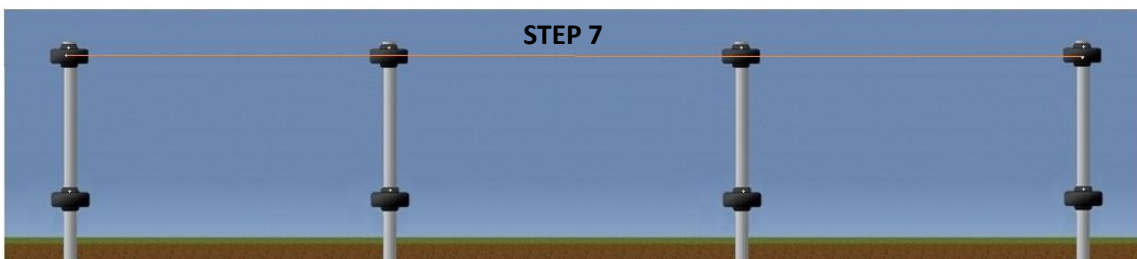

SLIP MOUNT SYSTEM™ (Continued)

A professional installation technique for privacy vinyl fence styles

STEP 1a: Sleeve vinyl posts over pipe. Place all vinyl posts over each pipe according to layout.

NOTE: The Slip Mount System requires shorter vinyl posts approximately only 2-3" of the lower vinyl post is buried in the ground. i.e. a 6 Ft privacy style requires 78" long 5" x 5" post.

STEP 2a: Measure and Install bottom rails.

Choose a *Key Pipe Post* corner/end to start, using a tape measure insert the tip into the lower post hole cut-out, measure from pipe to pipe, subtract ¼" less from this measurement. i.e. If between pipe measurement is 93-1/2" less -¼" = 93-1/4" is the lower vinyl rail cut length. Now insert rail end into the lower starting *Key vinyl post* hole, at the opposite end using a twisting motion slip the rail end into the side of the open hole, twisting vinyl post back to realignment with using slight pressure on the rail end, rail will snap into the post hole as its twisted back into its in-line position.

STEP 3a: Set fence & post height & level. Starting at *Key Posts* corner/end attach string line to top. Note: Use a screw positioned in the top ¼" area of vinyl *Key posts* end/corners when the post cap is installed this will cover the hole made, repeat at opposite end post attach and pull string line tight.

STEP 4a: Digging around base of posts. It may be necessary to dig a small hole (*Divot*) around base of pipe to allow for lowering the vinyl post height if the installation occurs on finished lawn surface.

Note: If working with non-level ground, to assist in post height adjustment of between inline post heights you may raise and lower the End/Corner *Key vinyl posts*, this will re adjust the top string line height to achieve the proper in-line vinyl post heights to the string line.

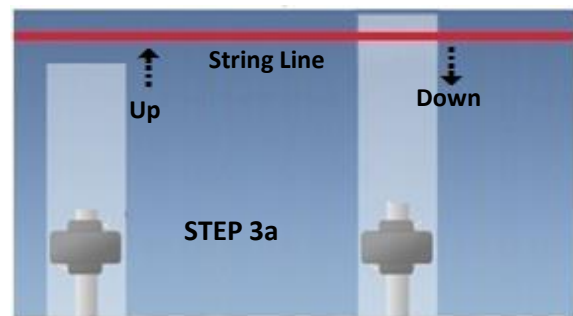
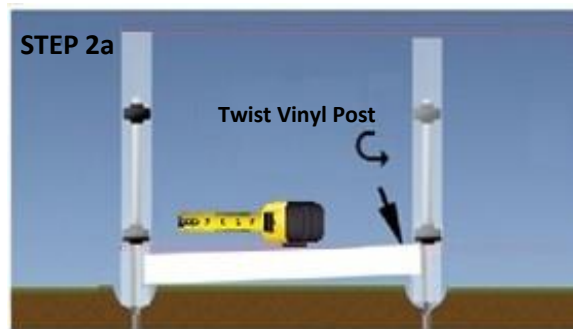
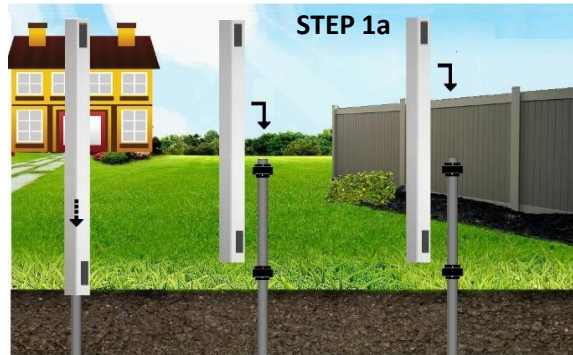

SLIP MOUNT SYSTEM™ (Continued)



STEP 5a: Fastening on U-Channels. Screw U-Channel to vinyl posts using (4) #10 x 1" screws.

Very Important Note: (2) of the screws are placed at the *Slip Mount* locations, screw through the post wall and into Slip Mount. This will also secure the vinyl post to the internal pipe preventing any future vinyl post movement.

STEP 6a: Insert Vertical T&G Tongue & Groove Slats

Insert slats in bottom rail one at a time, use of a rubber mallet lightly tapping along the side of the T&G slat this will ensure a tight fit between each slat. The last T&G slat is cut to fit and between the U-Channel and the adjoining T&G vertical slat. Fitment of the last vertical slat should be just snug, if tightness occurs re-trim and insert.

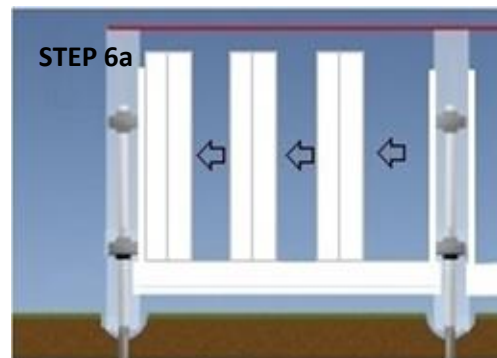

STEP 7a: Insert Top Rail &

Rail Locks. Measure and cut top rail, ensure minimum of 1-1/2" to 2" of top rail is inserted inside the vinyl post. Place "**Rail Lock**" into the top of the post and fasten with #10 x 1" screw(s) in pre-set hole.

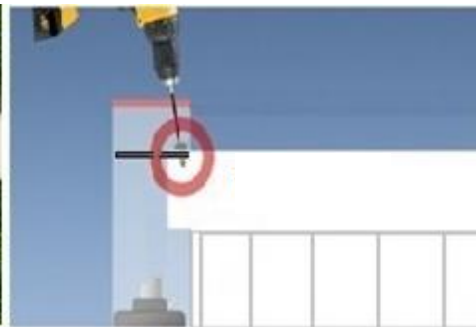

STEP 8a: Using a small amount of silicone or PVC glue, apply to the inside of cap, set caps on posts to complete.

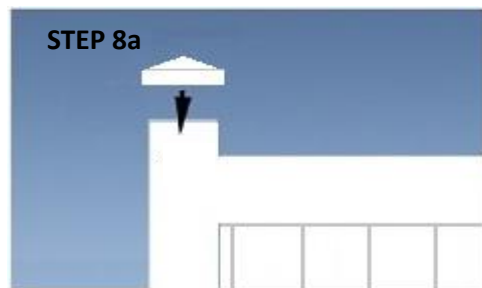

SLIP MOUNT  SYSTEM™

www.slipmount.com

Toll free help assistance line call **1.877.295.4530**