

May 16, 2012 - 2:45pm \\Projects\Hampton_Twp\Master Plan\Hampt-Zone.dwg (RCourtright) HAROLD E. PELLOW & ASSOCIATES, INC.

3	REVISED PLOT COLORS	02/27/01	6	REMOVED NEIGHBORHOOD COMMERCIAL DISTRICT AS PER ORDINANCE #2008-03	03/19/08
2	ADDED FIRE DEPARTMENT LOCATION	03/20/00	5	REVISED PROPERTY LINES AS PER CURRENT TAX MAPS	09/20/07
1	MISCELLANEOUS REVISIONS	11/29/99	4	REVISED ZONE BOUNDARIES AS PER ORDINANCE	09/10/07
			8	ADDED DOE RUN	05/16/12
			7	ADDED GARRETT DR., LOGAN WAY AND TANNER CT.	02/07/12

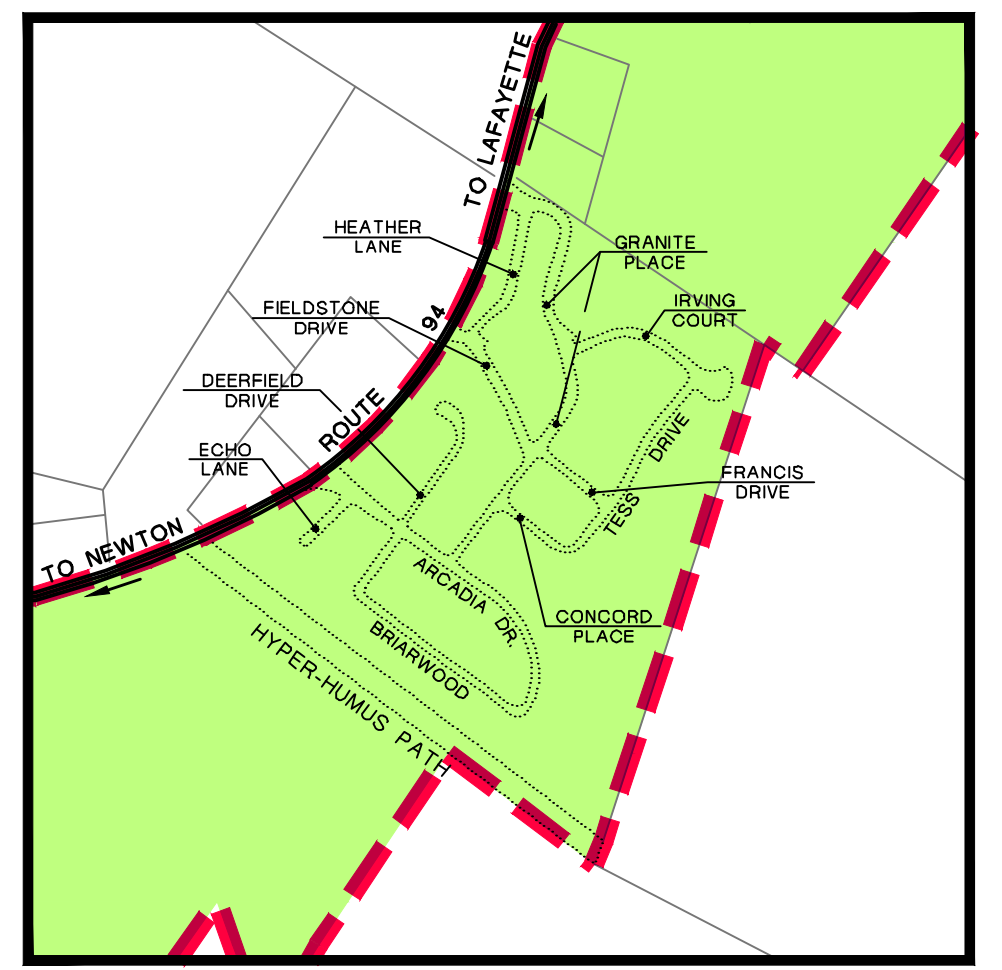
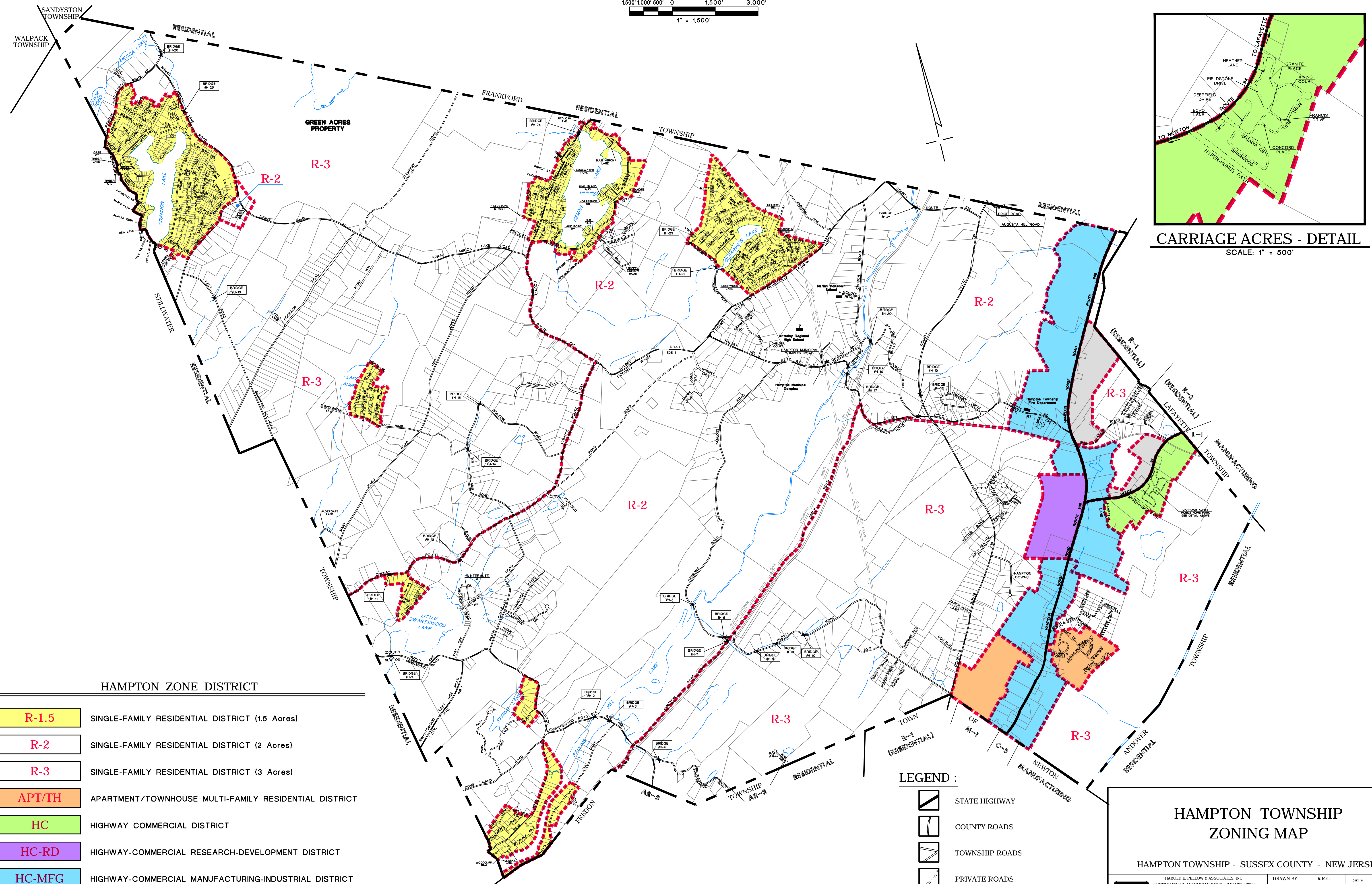
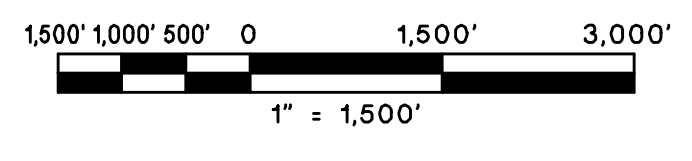

HAMPTON ZONE DISTRICT

R-1.5	SINGLE-FAMILY RESIDENTIAL DISTRICT (1.5 Acres)
R-2	SINGLE-FAMILY RESIDENTIAL DISTRICT (2 Acres)
R-3	SINGLE-FAMILY RESIDENTIAL DISTRICT (3 Acres)
APT/TH	APARTMENT/TOWNHOUSE MULTI-FAMILY RESIDENTIAL DISTRICT
HC	HIGHWAY COMMERCIAL DISTRICT
HC-RD	HIGHWAY-COMMERCIAL RESEARCH-DEVELOPMENT DISTRICT
HC-MFG	HIGHWAY-COMMERCIAL MANUFACTURING-INDUSTRIAL DISTRICT
HC-R	HIGHWAY-COMMERCIAL - RESIDENTIAL DISTRICT
M-1	ZONE DESIGNATION IN ADJOINING MUNICIPALITIES

LEGEND :

	STATE HIGHWAY
	COUNTY ROADS
	TOWNSHIP ROADS
	PRIVATE ROADS
	UNIMPROVED ROADS
	SUSSEX COUNTY BRIDGE

**HAMPTON TOWNSHIP
ZONING MAP**

HAMPTON TOWNSHIP - SUSSEX COUNTY - NEW JERSEY

	HAROLD E. PELLOW & ASSOCIATES, INC. CONSULTING ENGINEERS 17 PLAINS ROAD - AUGUSTA - N.J. 07822 ph. (973) 948-6403 fax. (973) 948-2916	DRAWN BY: R.R.C. CHECKED BY: D.B.S., Jr. FIELD BOOK: N/A FILE No. 98-304	DATE: DEC. 23, 1998 SCALE: 1" = 1,500' SHEET No. 1 of 1
	HAROLD E. PELLOW, P.E. & L.S. PROFESSIONAL ENGINEER & LAND SURVEYOR N.J. Lic. No. 13229		
	DATE _____		