

ALBERTA SNOWMOBILE ATV & OFF ROAD SHOW

OCT. 14-15, 2022

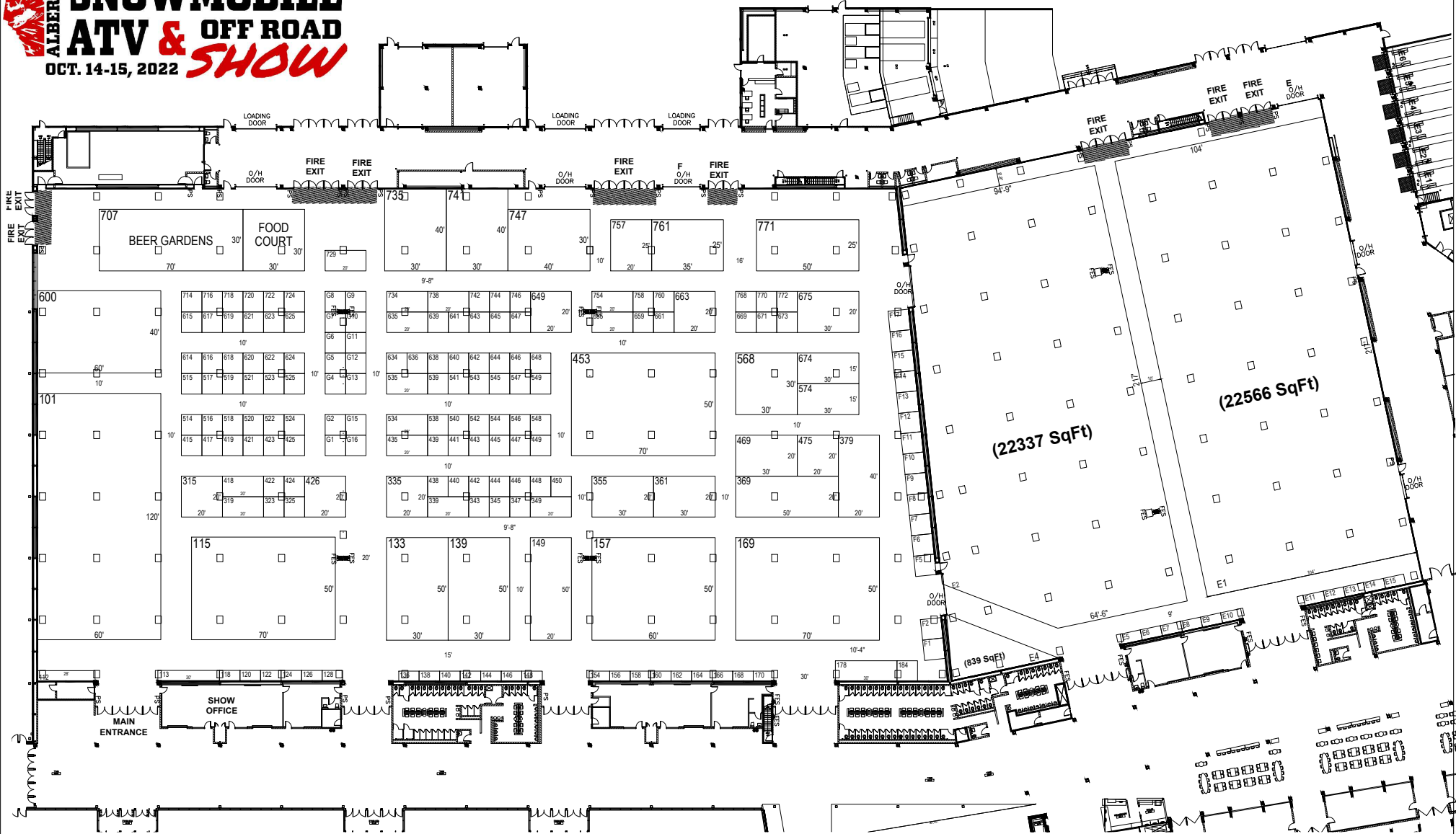

FES - FIRE EXTINGUISHER
PS - FIRE PULL STATION



COPYRIGHT © 2009 GES CANADA.
All Rights Reserved. No part of this publication may be reproduced, stored in any retrieval system, or transmitted in any form or by any means - electronic, mechanical, photocopying, recording, or otherwise - without the express written consent of GES CANADA.
Every effort has been made to insure the accuracy of all information contained on this floor plan. However, no warranties, either expressed or implied, are made with respect to this floor plan. If the location of building columns, utilities, or other architectural components of the facility is a consideration in the construction or usage of an exhibit, it is the sole responsibility of the exhibitor to physically inspect the facility to verify all dimensions and locations.

2022 ALBERTA SNOWMOBILE ATV & OFFROAD SHOW

OCTOBER 14-15, 2022
Edmonton Expo Centre, Edmonton
Halls E-F-G-H

Confidential Property Of GES CANADA
File: snow_2022.dwg
Layout: GUIDE
Plotted: May 20, 2022, 9:37:52 PM
By: Pucci, Tammy