

Converting Split Draw to One-Way

Superfine® & 1 3/8" Designer Metals™

Split Draw to One-Way Left Control & Stack

- Lay rod face down.
- Pull inner and outer rod sections apart.
- Free cord from secondary master (master without knots). Remove it and discard.

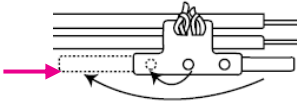

- Flip master arm in primary master and reattach to left screw hole position. Slide master out of rod but **do not untie**.

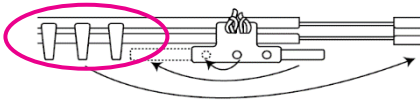

- Move all slides/carriers to smaller inner rod section. Place master carrier back in rod and rejoin.

Remove tension guide from cord.

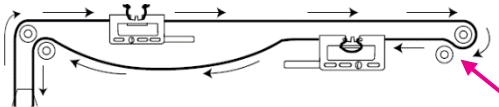

- Pull cord in between the pulley wheels on the left side until all slack is taken out. Note: Use lacing hook to pull cord. (part #9999061)
- Reattach tension guide to left side control.

Split Draw to One-Way Left Control & Stack

- Lay rod face down.
- Pull inner and outer rod sections apart.
- Free cord from secondary master (master without knots). Remove it and discard.

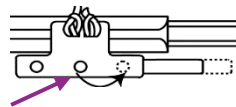

- Move master arm in primary master to right screw hole. Slide master out of rod but **do not untie**.

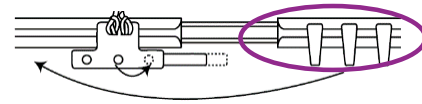

- Move all slides/carriers to larger outer rod section. Place master carrier back in rod and rejoin.

There is no need to remove tension guide. Kirsch® traverse rods always come with control on right.

Tips for adjusting control length

- First, install the rod on the wall.
- Install the tension guide to the wall.
- Pull knot closest to slides on master carrier to remove slack.
- Tie new knot before cutting off excess cord and old knot.

