

ELM GROVE

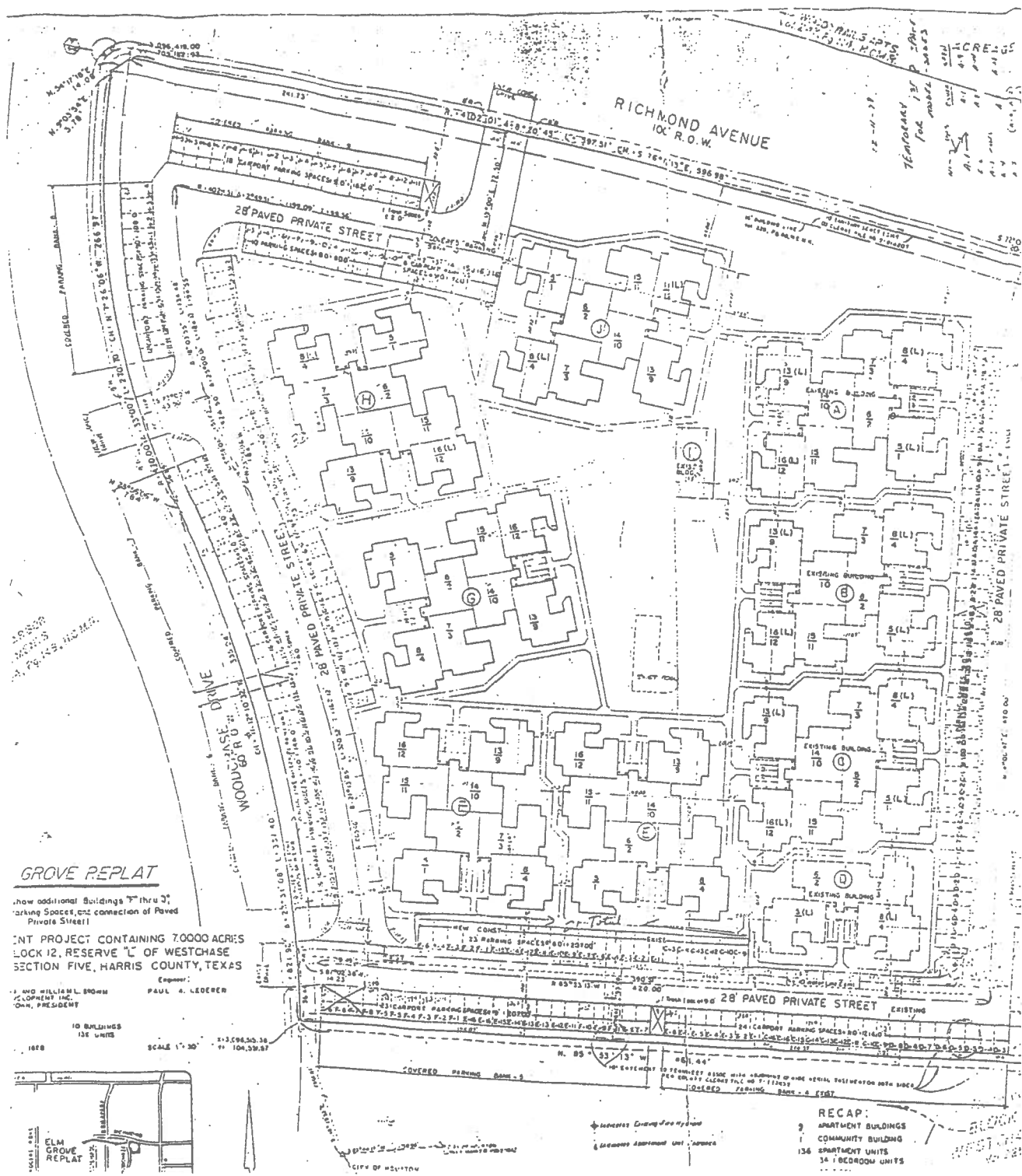

GROVE REPLAT

show additional buildings thru 37,
parking spaces, and connection of Paved
Private Street!

PLAT PROJECT CONTAINING 7.0000 ACRES
LOCK 12, RESERVE "C" OF WESTCHASE
SECTION FIVE, HARRIS COUNTY, TEXAS

Engineer:
J. AND WILLIAM L. BROWN
K. FOREST INC.
CH. PRESIDENT

PAUL A. LEDERER

10 BUILDINGS
136 UNITS
SCALE 1" = 30'
3-3,096.50.36
11-104,520.57

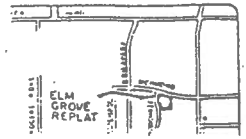

RECAP:
9 APARTMENT BUILDINGS
1 COMMUNITY BUILDING
136 APARTMENT UNITS
16 BEDROOM UNITS