

Soils Map

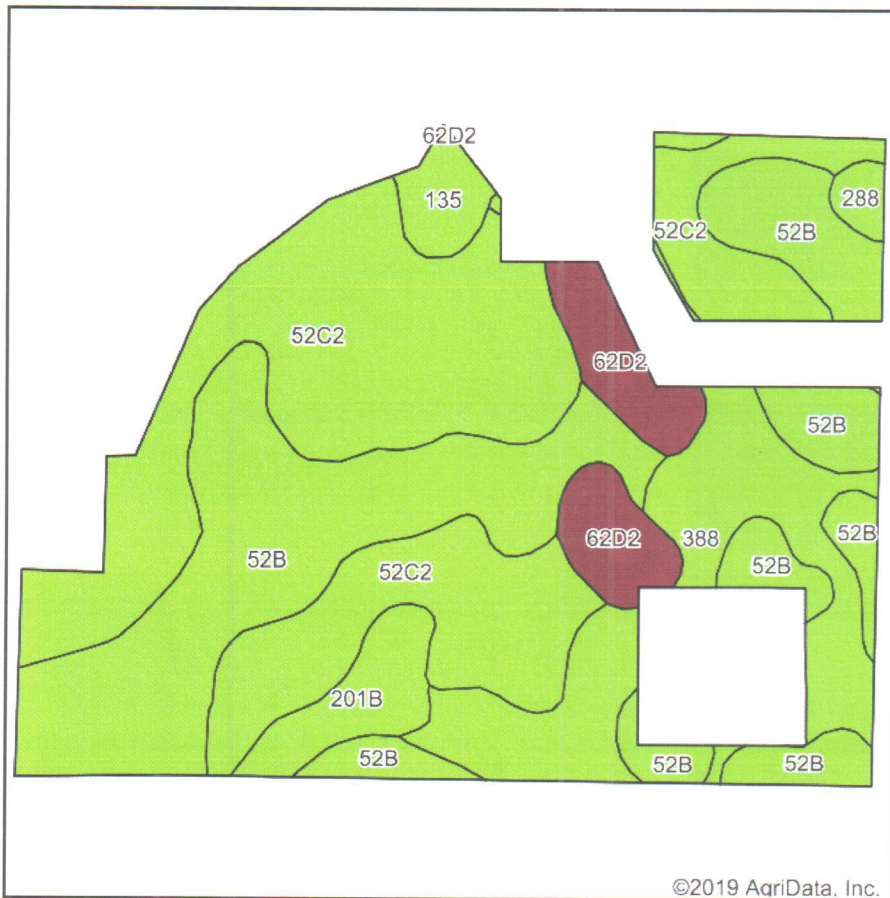

Soils data provided by USDA and NRCS.

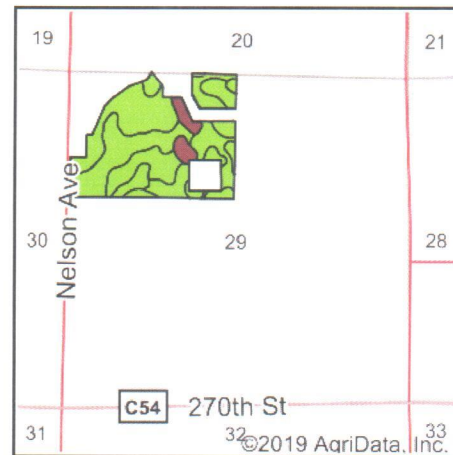

State: **Iowa**
 County: **Wright**
 Location: **29-91N-24W**
 Township: **Lincoln**
 Acres: **85.27**
 Date: **2/6/2019**



Area Symbol: IA197, Soil Area Version: 25

Code	Soil Description	Acres	Percent of field	CSR2 Legend	Water Table	Restrictive Layer	Septic Limits	Foundation Limits	Non-Irr Class *c	CSR2**	CSR	*n NCCPI Soybeans
52C2	Bode clay loam, 6 to 10 percent slopes, moderately eroded	33.29	39.0%		3.6ft.	> 6.5ft.	very limited	somewhat limited	IIle	82	62	66
52B	Bode clay loam, 2 to 6 percent slopes	29.37	34.4%		3.6ft.	> 6.5ft.	very limited	somewhat limited	Ile	91	78	79
388	Kossuth silty clay loam, 0 to 2 percent slopes	11.86	13.9%		0ft.	> 6.5ft.	very limited	very limited	IIlw	86	77	90
62D2	Storden loam, 10 to 16 percent slopes, moderately eroded	5.22	6.1%		5.5ft.	> 6.5ft.	somewhat limited	somewhat limited	IVe	41	41	61
201B	Coland-Terril complex, 1 to 5 percent slopes	3.16	3.7%		1.5ft.	> 6.5ft.	very limited	very limited	Ile	80	63	87
135	Coland clay loam, 0 to 2 percent slopes, occasionally flooded	1.67	2.0%		0ft.	> 6.5ft.	very limited	very limited	IIlw	76	78	78
288	Ottosen clay loam, 1 to 3 percent slopes	0.70	0.8%		1.5ft.	> 6.5ft.	very limited	very limited	Iw	91	84	81
Weighted Average										83	68.8	*n 74.6

**IA has updated the CSR values for each county to CSR2.

*n: The aggregation method is "Weighted Average using major components"

*c: Using Capabilities Class Dominant Condition Aggregation Method

Soils data provided by USDA and NRCS.